

WAKE COUNTY, NC 72
LAURA M RIDDICK
REGISTER OF DEEDS
PRESENTED & RECORDED ON
07/14/2014 AT 10:53:49

Mail to: City Clerk's Office
City of Raleigh
PO Box 590

BOOK:015718 PAGE:02317 - 02322

Raleigh, NC 27602-0590

ORDINANCE NO. (2014) 326

AN ORDINANCE DESIGNATING THE **ST MATTHEWS SCHOOL** IN THE PLANNING JURISDICTION OF THE CITY OF RALEIGH, NORTH CAROLINA, A HISTORIC LANDMARK

WHEREAS, the property located at 5410 Louisburg Road, Raleigh, NC, is owned by St Matthew Baptist Church; and

WHEREAS, the General Assembly of the State of North Carolina authorized the creation of the Raleigh Historic Development Commission for the City of Raleigh and otherwise provided for the preservation of certain historic sites and buildings by the passage of Part 3C, Chapter 160A, Article 19 of the North Carolina General Statutes; and

WHEREAS, the Raleigh Historic Development Commission has made an investigation and recommended the following property be designated a historic landmark; and

WHEREAS, the North Carolina Department of Cultural Resources has made an analysis and recommendation that the following property be designated a historic landmark; and

WHEREAS, on the 3rd day of June 2014, a joint public hearing was held in the Council Chamber of the Avery C. Upchurch Municipal Complex, Raleigh, before the City Council of the City of Raleigh and the Raleigh Historic Development Commission to determine whether the hereinafter described property should be designated a historic landmark; and

WHEREAS, all requirements of Part 3C, Chapter 160A, Article 19 of the North Carolina General Statutes, preceding the adoption of this ordinance, have been complied with.

NOW, THEREFORE, BE IT ORDAINED BY THE CITY COUNCIL OF THE CITY OF RALEIGH, NORTH CAROLINA THAT:

Section 1. The property designated as St Matthews School, in the planning jurisdiction of the City of Raleigh, North Carolina, be and is declared a Raleigh Historic Landmark. Said property being more particularly described as follows:

A portion of the property located at 5410 Louisburg Road, Raleigh, NC, owned by St Matthew Baptist Church, that property described in deed book 7118, page 0057 recorded in Wake County Registry, comprising approximately .71 acres of the parcel and with approximate dimensions of 199 feet x 168 feet x 195 feet x 148 feet starting at the southwest corner. A map is included in the designation report.

Section 2. Those elements of the property that are integral to its historical, prehistorical, architectural, archaeological and/or cultural significance or any combination thereof are as follows:

The 1922 one story building and the approximately .71 acre upon which it sits. The property is architecturally and historically significant as one of only five remaining Rosenwald Schools in Wake County. St. Matthews School stands as a physical reminder of the strong, vital, historic African American community founded around the St. Matthews Baptist Church shortly after the Civil War.

The one-story, white frame building stands on a continuous concrete block foundation. The hip roof has exposed rafter ends. The building retains its weatherboarding and large, nine-over-nine wood sash windows arranged in a group of four on the front gable ell and in two groups of five on the rear elevation. The school has experienced some renovation; the building retains its original plan, form, siding, and windows and is clearly recognizable as a Rosenwald School.

The school was built in 1922 with funds from the Julius Rosenwald Foundation, with contributions from the local African American community, and support from the Wake County School Board. During the late 1920s, 1930s, and 1940s, the school served as an educational and social center for the African American community, hosting plays, glee club performances, adult education classes, vaccination clinics, home demonstrations, and meetings between the county extension agent and farmers.

A detailed architectural description and history is found in the 2014 Raleigh Historic Landmark designation application and report and the 2001 National Register nomination form which are hereby referenced.

Section 3. No portion of the exterior features of any building, site, structure, or object (including windows, doors, walls, fences, light fixtures, signs, steps, pavement, paths, or any other appurtenant features), trees, nor above ground utility structure located on the hereinbefore described property that is designated in this ordinance may be altered, restored, moved, remodeled, or reconstructed so that a change in design, material or outer appearance occurs unless and until a certificate of appropriateness is obtained from the Raleigh Historic Development Commission or its successors; provided however that the Raleigh Planning Director or designee may approve certificates of appropriateness for minor works as listed in the Bylaws and Rules of Procedure of the Raleigh Historic Development Commission.

Section 4. No building, site, structure, or object (including windows, doors, walls, fences, light fixtures, steps, pavement, paths, signs, or any other appurtenant features), trees, nor above ground utility structure located on the hereinbefore described property that is designated in this ordinance may be demolished unless and until either approval of demolition is obtained from the Raleigh Historic Development Commission or a period of three hundred sixty-five (365) days has elapsed following final review by the Commission of a request for demolition (or any longer period of time required by N.C.G.S. 160A-400.14 as it maybe amended hereafter); provided however, that demolition may be denied by the Raleigh Historic Development Commission in the event that the State Historic Preservation Officer determines that the building, site, or structure has statewide significance as provided by N.C.G.S. 160A-400.14.

Section 5. The Raleigh Historic Development Commission shall have no jurisdiction over the interior features of the property.

Section 6. All owners and occupants of the property hereinabove described, whose identity and addresses can be ascertained by the exercise of due diligence shall be sent by certified mail a copy of this ordinance.

Section 7. This ordinance shall be indexed after the property owner's name in the grantor and grantee indexes in the Office of the Register of Deeds of Wake County.

Section 8. City administration and the Raleigh Historic Development Commission are hereby authorized and directed to have erected an appropriate sign on the site hereinabove described setting forth the fact that said site has been designated a historic landmark by action of the Raleigh Historic Development Commission and the City Council of the City of Raleigh provided, should the owners of the hereinabove described property not consent to the erection of said sign on the described premises, City administration and the Raleigh Historic Development Commission are hereby authorized and directed to have said sign located on the public right-of-way adjacent to said property.

Section 9. In the event any building, site, structure, or object designated by this ordinance is demolished in accordance with the ordinances of the City of Raleigh, this ordinance shall automatically be null and void.

Section 10. Any violation of this ordinance shall be unlawful as by law provided.

Adopted: July 1, 2014

Effective: July 1, 2014

Distribution: Department of City Planning
Inspections Department
Raleigh Historic Development Commission
Wake County Tax Assessor
Property Owner and Occupant (if not the owner)

✓

Ordinance No. (2014) 326
Adopted: 7/1/14

Page 4
Effective: 7/1/14

Registrar of Deeds



City Of Raleigh
NORTH CAROLINA

STATE OF NORTH CAROLINA)
COUNTY OF WAKE)

CERTIFICATION

I, Ralph L. Puccini, Assistant Deputy Clerk of the City of Raleigh, North Carolina,
do hereby certify that the attached is a true and exact copy of City of Raleigh
Ordinance No. (2014) 326 adopted July 1, 2014.

IN WITNESS WHEREOF, I have unto set my hand and have caused the Seal of
the City of Raleigh to be affixed this 3rd day of July, 2014.



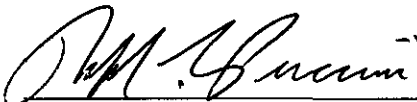

Ralph L. Puccini
Assistant Deputy Clerk

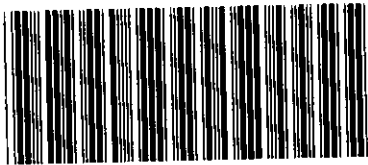

BOOK:015718 PAGE:02317 - 02322



Please retain yellow trailer page
It is part of the recorded document and must be submitted with the original for re-recording.

Laura M. Riddick
Register of Deeds
Wake County Justice Center
300 South Salisbury Street, Suite 1700
Raleigh, NC 27601

- | | |
|--|---|
| <input type="checkbox"/> New Time Stamp | <input type="checkbox"/> \$25 Non-Standard Fee |
| <input type="checkbox"/> Additional Document Fee | <input type="checkbox"/> Additional Reference Fee |

This Customer Group

_____ # of Time Stamps Needed

This Document

_____ *6* # of Pages *P*

Raleigh Department of City Planning
One Exchange Plaza
3rd floor
Raleigh, NC 27602
919-516-2626

www.raleighnc.gov/planning

Fee	_____
Amt Paid	_____
Check #	_____
Rec'd Date:	_____
Rec'd By:	_____
Completion Date:	_____

(Processing Fee: \$266.00 - valid until June 30, 2011 - Checks payable to the City of Raleigh.)

RALEIGH HISTORIC LANDMARK DESIGNATION APPLICATION

This application initiates consideration of a property for designation as a Raleigh Historic Landmark by the Raleigh Historic Districts Commission (RHDC) and the Raleigh City Council. It enables evaluation of the resource to determine if it qualifies for designation. The evaluation is made by the Research Committee of the RHDC, which makes its recommendation to the full commission which in turn makes its recommendation to the City Council. Procedures for administration by the RHDC are outlined in the Raleigh City Code, Section 10-1053.

Please type if possible. Use 8-1/2" x 11" paper for supporting documentation and if additional space is needed. All materials submitted become the property of the RHDC and cannot be returned. Return completed application to the RHDC office at One Exchange Plaza, Suite 300, Raleigh or mail to:

Raleigh Historic Districts Commission
PO Box 829 Century Station
Raleigh, NC 27602

1. Name of Property (if historic name is unknown, give current name or street address):

Historic Name: St Matthews School

Current Name: St Matthews School

2. Location:

Street Address: 5410 Louisburg Road

NC PIN No.: 1736042550

(Can be obtained from <http://imaps.co.wake.nc.us/imaps/>)

3. Legal Owner of Property (If more than one, list primary contact):

Name: ST MATTHEW BAPTIST CHURCH

Address: 5410 LOUISBURG RD

City: Raleigh State: NC Zip: 27616

Telephone No: () () - () Fax No. () () - ()

E-Mail: _____

4. Applicant/Contact Person (If other than owner):

Name: Cynthia de Miranda for RHDC

Address: PO Box 1399

City: Durham State: NC Zip: 27702

Telephone No: (919) (906) - (3136) Fax No. () () - ()

E-Mail: cynthia@mdmhc.com

5. General Data/Site Information:

Date of Construction and major additions/alterations: 1922

Number, type, and date of construction of outbuildings: N/A

Approximate lot size or acreage: .71

Architect, builder, carpenter, and/or mason: Unknown

Original Use: school

Present Use: church school

6. Classification:

A. Category (check all that apply):

Building(s) ☒ Structure ☐ Object ☐ Site ☐

B. Ownership

Private ☒Public ☐ Local ☐ State ☐ Federal ☐

C. Number of contributing and non-contributing resources on the property:

	Contributing	Noncontributing
Buildings	1	
Structures		
Objects		

D. Previous field documentation (when and by whom): ssn WA1717

E. National Register of Historic Places Status:

Check One:

Entered X Date: 4/25/2001	Nominated <input type="checkbox"/>
Determined Eligible <input type="checkbox"/> Date:	Determined Not Eligible <input type="checkbox"/> Date:
Nomination Not Requested <input type="checkbox"/>	Removed <input type="checkbox"/> Date:
Significant changes in integrity since listing should be noted in section 10.B. below.	

7. Reason for Request: per request by RHDC due to significance and rarity of Rosenwald Schools.

8. Is the property income producing? Yes No X

9. Are any interior spaces being included for designation? Yes ☐ No X

10. Supporting Documentation (Attach to application on separate sheets. Please type or print):

A. Photographs/Slides:

At least *two sets of current exterior archival-grade photographic prints* (minimum print size 5"x7") of all facades of the building and at least one photo of all other contributing and non-contributing resources. If interior spaces of the property are being considered for designation, please include two sets of photos for these features. Prints may be created by using archival-grade black and white film photography and processing or digital photography. The minimum standard for a digital print is 5x7 at a resolution of 300 pixels per inch (ppi). This translates into a pixel dimension of 1950 x 1350. Digital images must be printed with an acceptable ink and paper combination as determined by the National Park Service Go to: <http://www.nps.gov/history/nr/publications/bulletins/photopolicy/index.htm>. All photographs must be labeled with the name of the structure, address and date the photograph was taken with pencil or archival-approved photo pen. In addition to prints, all digital images should be submitted on a CD-R in TIF format. Any additional exterior or interior views and views of other structures on the property (color, black and white, or slides) will be helpful.

B. Boundary Map:

Please include a map showing the location of the property. A sketch map is acceptable, but please note street names and number. Any other structures on the property should also be shown. Please include a "North" arrow. Map should be no larger than 11" x 17". A tax map with boundaries marked is preferred, which can be found at: <http://imaps.co.wake.nc.us/imaps/>.

C. Architectural Significance:

Describe the property, including exterior architectural features, additions, remodelings, and alterations. Also describe significant outbuildings and landscape features. If the owner is including interior features in the nomination for the purpose of design review protection; describe them in detail and note their locations. Include a statement regarding the architectural significance of the property.

D. Historic Significance:

Note any significant events, people, and/or families associated with the property. Include all major owners. Note if the property has ever been recorded during a historic building survey by the City of Raleigh or by the NC State Historic Preservation Office. If so, who and when? (See application item 6.D.) Please include a bibliography of sources. Information regarding prior designations can be found by contacting the Survey and Planning Branch of the NC State Historic Preservation Office (NCSHPO) at 919-807-6570, 919-807-6573 or at: <http://www.hpo.dcr.state.nc.us/spbranch.htm>.

E. Special Significance Summary:

Include a one to two paragraph summary of those elements of the property that are integral to its historical, prehistorical, architectural, archaeological, and/or cultural importance.

St. Matthews School
Landmark Application
December 2013

Section 10A: Photographs



Facade, view west



South elevation

St. Matthews School
Landmark Application
December 2013



East elevation



North elevation

St. Matthews School
Landmark Application
December 2013



Setting, view NE



Setting, view S

St. Matthews School
Landmark Application
December 2013



Setting, view W



From front of property down to Louisburg Road, view SW

St. Matthews School
Landmark Application
December 2013



North classroom, view SE



North classroom, view NW

St. Matthews School
Landmark Application
December 2013



Room divider, seen in north classroom, view SW



South classroom, view SW

St. Matthews School
Landmark Application
December 2013



South classroom, view SE



South classroom, view NW

St. Matthews School
Landmark Application
December 2013



Kitchen, view NW

St. Matthews School
Landmark Application
December 2013

Section 10B: Maps



Tax Map of 5410 Louisburg Road, Raleigh

St. Matthews School
Landmark Application
December 2013

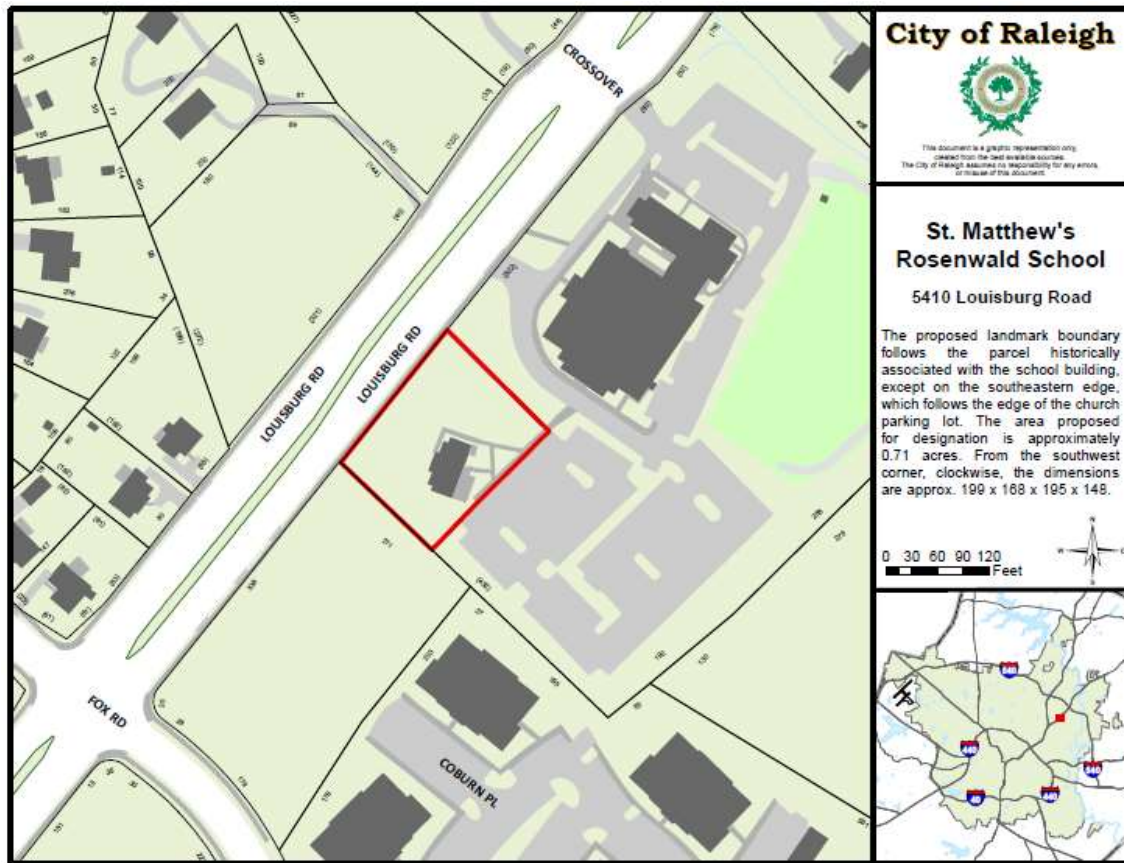

Site Map of St. Matthew's Rosenwald School
Heavy line depicts proposed boundary

St. Matthews School
Landmark Application
December 2013



Aerial Site Map of St. Matthew's Rosenwald School
Heavy line depicts proposed boundary

St. Matthews School
Landmark Application
December 2013

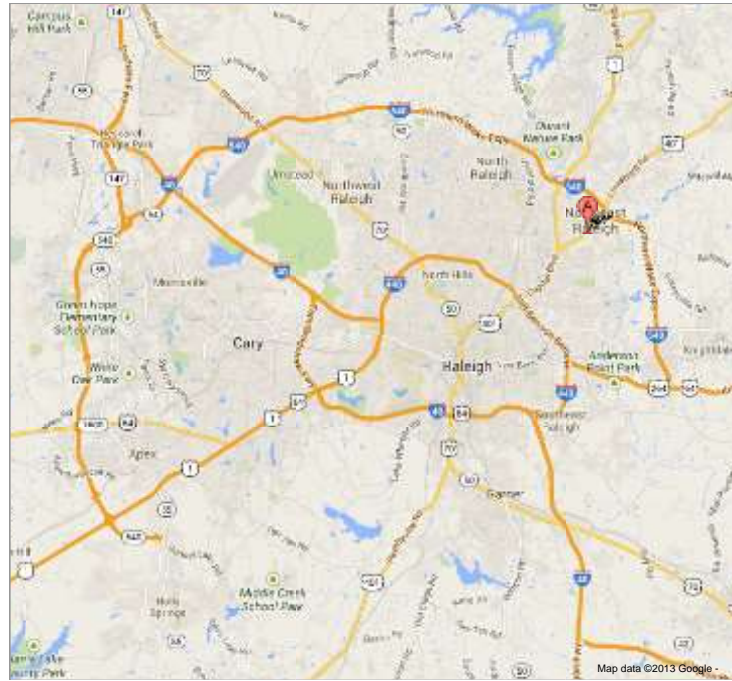

Location Map 1: 5410 Louisburg Road, Raleigh, Wake County
Map generated by Google.com, December 16, 2013

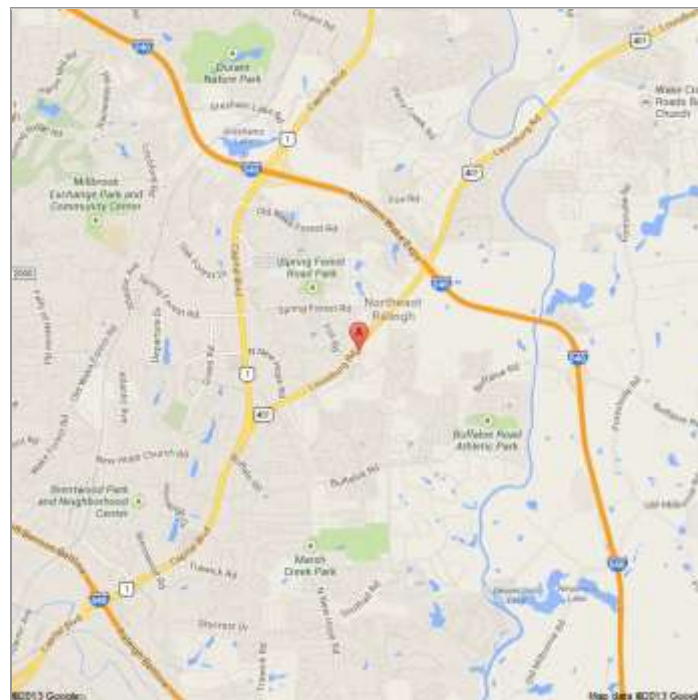

Location Map 1: 5410 Louisburg Road, Raleigh, Wake County
Map generated by Google.com, December 16, 2013

Section 10C: Architectural Significance

See attached National Register Nomination Form.

Update to description: The school remains in its original location on the crest of a hill above Louisburg Road in northwest Raleigh. The surrounding site, however, has changed. A large parking lot fills the area between the school and the church cemetery, formerly the site of the lawn used for recreation by the students. A new church building, erected in 2002, now stands immediately south of the original church, which is still extant. A paved drive separates the new church from St. Matthews School to the south and leads to another parking lot immediately behind the church buildings. The school's immediate surrounding is the same; it stands within a grove of trees at the top of the hill, on a higher grade than the parking lots and the nearby church buildings. The grove of trees north of the building has been thinned significantly so that there is now a small yard to the north of the building.

The school building itself remains as described in the National Register nomination form of 2001. As stated in that nomination, the building retains architectural integrity despite some renovation. The original plan and form are intact, as is original siding, windows, and interior materials. It is easily recognizable as a Rosenwald school and is maintained in very good condition.

The school building historically occupied a two-acre parcel once identified by PIN 0191. That parcel has been combined with the parcel to the north; together, the once-separate parcels are now identified by the single PIN 1736042550. The entire two-acre parcel is included in the National Register of Historic Places boundary.

Section 10D: Historic Significance

See attached National Register Nomination Form.

Local Landmark Boundary Description

On the west, south, and north, the boundary line coincides with the lot lines of the two-acre parcel historically associated with the school building. On the east side, the boundary lies alongside the west edge of the parking lot. The boundary excludes the entirety of the parking lot and its curbing.

The boundary as described includes land historically associated with St. Matthews School but excludes the land that has been paved as a parking lot.

St. Matthews School
Landmark Application
December 2013

USDI/NPS NRHP Registration Form
St. Matthews School
Wake County, North Carolina

Page 1

NPS Form 10-900
(Rev. 10-90)

OMB No. 1024-0018

United States Department of the Interior
National Park Service

MAR 23 2001

NATIONAL REGISTER OF HISTORIC PLACES
REGISTRATION FORM

This form is for use in nominating or requesting determinations for individual properties and districts. See instructions in How to Complete the National Register of Historic Places Registration Form (National Register Bulletin 16A). Complete each item by marking "x" in the appropriate box or by entering the information requested. If any item does not apply to the property being documented, enter "N/A" for "not applicable." For functions, architectural classification, materials, and areas of significance, enter only categories and subcategories from the instructions. Place additional entries and narrative items on continuation sheets (NPS Form 10-900a). Use a typewriter, word processor, or computer, to complete all items.

1. Name of Property

historic name St. Matthews School

other names/site number St. Matthew School

2. Location

street & number SE side US401, 0.5 mi NE of SR2213 not for publication N/A
city or town Raleigh vicinity X
state North Carolina code NC county Wake code 183 zip code 27604

3. State/Federal Agency Certification

As the designated authority under the National Historic Preservation Act of 1986, as amended, I hereby certify that this X nomination request for determination of eligibility meets the documentation standards for registering properties in the National Register of Historic Places and meets the procedural and professional requirements set forth in 36 CFR Part 60. In my opinion, the property X meets does not meet the National Register Criteria. I recommend that this property be considered significant nationally statewide X locally. (See continuation sheet for additional comments.)

Signature of certifying official Jeffrey J. Crow SHPD

Date 3/6/01

North Carolina Department of Cultural Resources
State or Federal agency and bureau

NPS Form 10-900
(Rev. 10-90)

OMB No. 1024-0018

United States Department of the Interior
National Park Service

NATIONAL REGISTER OF HISTORIC PLACES
REGISTRATION FORM

This form is for use in nominating or requesting determinations for individual properties and districts. See instructions in How to Complete the National Register of Historic Places Registration Form (National Register Bulletin 16A). Complete each item by marking "x" in the appropriate box or by entering the information requested. If any item does not apply to the property being documented, enter "N/A" for "not applicable." For functions, architectural classification, materials, and areas of significance, enter only categories and subcategories from the instructions. Place additional entries and narrative items on continuation sheets (NPS Form 10-900a). Use a typewriter, word processor, or computer, to complete all items.

1. Name of Property

historic name St. Matthews School

other names/site number St. Matthew School

2. Location

street & number SE side US401, 0.5 mi NE of SR2213 not for publication N/A
city or town Raleigh vicinity X
state North Carolina code NC county Wake code 183 zip code 27604

3. State/Federal Agency Certification

As the designated authority under the National Historic Preservation Act of 1986, as amended, I hereby certify that this X nomination request for determination of eligibility meets the documentation standards for registering properties in the National Register of Historic Places and meets the procedural and professional requirements set forth in 36 CFR Part 60. In my opinion, the property X meets does not meet the National Register Criteria. I recommend that this property be considered significant nationally statewide X locally. (See continuation sheet for additional comments.)

Signature of certifying official

Date

North Carolina Department of Cultural Resources

State or Federal agency and bureau

In my opinion, the property _____ meets _____ does not meet the National Register criteria. (_____ See continuation sheet for additional comments.)

Signature of commenting or other official Date

State or Federal agency and bureau

=====

4. National Park Service Certification

=====

I, hereby certify that this property is:

☒ entered in the National Register

See continuation sheet.

determined eligible for the
National Register

See continuation sheet.

determined not eligible for the
National Register

removed from the National Register

other (explain): _____

Signature of Keeper

Date
of Action

=====

5. Classification

=====

Ownership of Property (Check as many boxes as apply)

☒ private

public-local

public-State

public-Federal

Category of Property (Check only one box)

☒ building(s)

district

site

structure

object

Number of Resources within Property

Contributing

Noncontributing

 1

 0 buildings

 0

 0 sites

 0

 0 structures

 0

 0 objects

 1

 0 Total

Number of contributing resources previously listed in the National Register N/A

Name of related multiple property listing (Enter "N/A" if property is not part of a multiple property listing.)

 Historic and Architectural Resources of Wake County, NC

=====

6. Function or Use

=====

Historic Functions (Enter categories from instructions)

Cat: <u>EDUCATION</u>	Sub: <u>School</u>
_____	_____
_____	_____
_____	_____
_____	_____
_____	_____
_____	_____

Current Functions (Enter categories from instructions)

Cat: <u>RELIGION</u>	Sub: <u>Meeting Hall</u>
_____	_____
_____	_____
_____	_____
_____	_____
_____	_____
_____	_____

=====

7. Description

=====

Architectural Classification (Enter categories from instructions)

OTHER: Vernacular

Materials (Enter categories from instructions)

foundation CONCRETE BLOCK

roof ASPHALT

walls WOOD: Weatherboard

other _____

Narrative Description (Describe the historic and current condition of the property on one or more continuation sheets.)

=====
8. Statement of Significance
=====

Applicable National Register Criteria (Mark "x" in one or more boxes for the criteria qualifying the property for National Register listing)

- ☒ A Property is associated with events that have made a significant contribution to the broad patterns of our history.
- ☐ B Property is associated with the lives of persons significant in our past.
- ☐ C Property embodies the distinctive characteristics of a type, period, or method of construction or represents the work of a master, or possesses high artistic values, or represents a significant and distinguishable entity whose components lack individual distinction.
- ☐ D Property has yielded, or is likely to yield information important in prehistory or history.

Criteria Considerations (Mark "X" in all the boxes that apply.)

- ☒ A owned by a religious institution or used for religious purposes.
- ☐ B removed from its original location.
- ☐ C a birthplace or a grave.
- ☐ D a cemetery.
- ☐ E a reconstructed building, object, or structure.
- ☐ F a commemorative property.
- ☐ G less than 50 years of age or achieved significance within the past 50 years.

Areas of Significance (Enter categories from instructions)

EDUCATION

ETHNIC HERITAGE: Black

SOCIAL HISTORY

Period of Significance 1922-1949

Significant Dates 1922

Significant Person (Complete if Criterion B is marked above)

N/A

Cultural Affiliation

N/A

Architect/Builder

Unknown

Narrative Statement of Significance (Explain the significance of the property on one or more continuation sheets.)

=====

9. Major Bibliographical References

=====

(Cite the books, articles, and other sources used in preparing this form on one or more continuation sheets.)

Previous documentation on file (NPS)

☐ preliminary determination of individual listing (36 CFR 67) has been requested.

☐ previously listed in the National Register

☐ previously determined eligible by the National Register

☐ designated a National Historic Landmark

☐ recorded by Historic American Buildings Survey # _____

☐ recorded by Historic American Engineering Record # _____

Primary Location of Additional Data

☒ State Historic Preservation Office

☐ Other State agency

☐ Federal agency

☐ Local government

☐ University

☐ Other

Name of repository: _____

=====

10. Geographical Data

=====

Acreage of Property 2.0 acres

UTM References (Place additional UTM references on a continuation sheet)

	Zone	Easting	Northing	Zone	Easting	Northing
1	<u>17</u>	<u>720200</u>	<u>3970990</u>	3	_____	_____
2	_____	_____	_____	4	_____	_____
<u>See continuation sheet.</u>						

Verbal Boundary Description (Describe the boundaries of the property on a continuation sheet.)

Boundary Justification (Explain why the boundaries were selected on a continuation sheet.)

=====

11. Form Prepared By

=====

name/title Nancy Van Dolsen

organization _____ date 30 September 2000

street & number 1601 Highland Drive telephone 252.243.7861

city or town Wilson state NC zip code 27893

=====

Additional Documentation

=====

Submit the following items with the completed form:

Continuation Sheets

Maps

A USGS map (7.5 or 15 minute series) indicating the property's location.
A sketch map for historic districts and properties having large acreage
or numerous resources.

Photographs

Representative black and white photographs of the property.

Additional items (Check with the SHPO or FPO for any additional items)

=====

Property Owner

=====

(Complete this item at the request of the SHPO or FPO.)

name St. Matthew Baptist Church c/o Mr. Pryce Baldwin

street & number 3218 Crandon Lane telephone _____

city or town Raleigh state NC zip code 27604

=====

United States Department of the Interior
National Park Service

NATIONAL REGISTER OF HISTORIC PLACES
CONTINUATION SHEET

St. Matthews School
Wake County, North Carolina

Section 7 Page 1

DESCRIPTION

St. Matthews School sits on the crest of a hill, facing northwest. A grove of trees stands to the south and north of the building. St. Matthews Baptist Church, which now owns the school, stands on an adjacent parcel to the northeast, on the other side of the grove of trees, and a cemetery is located behind the church. A large lawn, formerly used by the school children as a playground and ball field, separates the cemetery from the school.

St. Matthews School is a one-story, frame building standing on a continuous concrete block foundation. The hip roof has exposed rafter ends and is pierced by a short central brick flue. The building features a central front-gable ell, flanked by shallower shed pavilions, each containing a double door entry. The shed roofs of the pavilions are engaged with the front flank of the main roof.. The southwest pavilion is intact, and retains its recessed entrance and narrow four-over-four windows. The northwest pavilion has been remodeled: the window has been removed and the recessed entrance vestibule enclosed. The building retains its weatherboarding and large, nine-over-nine sash windows arranged in a group of four on the front gable ell and in two groups of five on the rear elevation. Two doors topped by a nine-light transom, each leading into a classroom, are located at the northeast and southeast ends of the rear elevation. The two end elevations feature two eight-light windows approximately one foot below the exposed rafter ends.

In 1995, new steps were built for the southwest entry. A long ramp for handicap accessibility was added across the northwest elevation. Two decks were built onto the rear elevation in the late 1990s and the rear exterior doors were also replaced at that time.

Within, the building retains its original floor plan: two separate entries that lead to the two classrooms. From each vestibule, a door leads to a room that was used as the "industrial" classroom that now is used as a kitchen. The two cloakrooms have been converted to rest rooms. One central chimney served stoves used to heat the three rooms. The original floors remain but have been covered with vinyl flooring. The tongue-and-groove walls and board ceilings are intact under modern sheetrock which was added in 2000.

A series of folding, paneled doors originally provided access between the two classrooms. During the 1995 renovation work, the opening was altered by the insertion of a low (approximately two-and-a-half feet high) wall. A wood partition that folds horizontally was inserted above the low wall to allow the two rooms to be open to each other. A single door was cut into the east end of the central wall to provide pedestrian access.

Although the school has experienced some renovation, the building retains its original plan, form, siding, and windows and is clearly recognizable as a Rosenwald School.

United States Department of the Interior
National Park Service

NATIONAL REGISTER OF HISTORIC PLACES
CONTINUATION SHEET

St. Matthews School
Wake County, North Carolina

Section 8 Page 2

STATEMENT OF SIGNIFICANCE

Summary

St. Matthews School is eligible for the National Register of Historic Places under Criterion A in three areas of significance: education, social history, and ethnic heritage. Built in 1922 with funds from the Julius Rosenwald Foundation, contributions from the local African American community, and support from the Wake County School Board, St. Matthews School is one of only five remaining Rosenwald Schools in Wake County; twenty-one were constructed between 1919 and 1928. During the late 1920s, 1930s, and 1940s, the school served as an educational and social center for the African American community, hosting plays, glee club performances, adult education classes, vaccination clinics, home demonstrations, and meetings between the county extension agent and farmers. The school closed its doors in 1949, but is presently used as a meeting hall by the St. Matthews Baptist Church and the surrounding community. St. Matthews School stands as a physical reminder of the strong, vital, historic African American community founded around the St. Matthews Baptist Church shortly after the Civil War. The community remains active and vital today. St. Matthews School is discussed in the Multiple Property Documentation Form, "Historic and Architectural Resources of Wake County, North Carolina (ca. 1770-1941)," under Property Type 4: Institutional Buildings, Post World War I Consolidated Schools and in Context 4: Boom, Bust and Recovery Between World Wars (1919-1941), Rural School Consolidation and High Schools Offer Greater Advantage. An addendum to the Wake County Multiple Property Documentation Form, "Wake County's Rosenwald Schools," discusses in-depth the social history, education, and ethnic heritage context for St. Matthews School and the county's other Rosenwald-funded schools. The School also meets Criterion Consideration A for religious properties because during its period of significance it was not owned by a religious institution, and it derives its primary significance from its historical associations and distinctive architecture.

Historical Background

The community surrounding St. Matthews Baptist Church and St. Matthews School was founded during the late 1860s or early 1870s. A group of African American families broke away from the New Hope Baptist Church to establish their own congregation, which they named St. Matthews.¹

St. Matthews School was built in 1922 with funds from the Julius Rosenwald Foundation, donations from the local community, and support from the Wake County Board of Education. In Wake County, the Rosenwald Fund helped to build twenty-one schools with eighty-one classrooms; the fund contributed \$23,000, while the school board gave \$143,805 (the second highest in the state), the white community donated \$605, and the African American community raised \$35,756 (the largest in the state).²

The school that the Wake County Board of Education chose to construct was a two-teacher building based on plans provided by the Rosenwald Foundation. The building has all the characteristics of a Rosenwald School: large

¹ Elizabeth Reid Murray, Memo to Kelly Lally, September 10, 12, 1990. St. Matthews School, Survey File, Wake County, NC. North Carolina Division of Archives and History, Raleigh, North Carolina. Currently the church and school are also known as St. Matthew Baptist Church and St. Matthew School, however, the township name is St. Matthews.

² Jerry L. Cross, "Julius Rosenwald: His Fund and His Schools, A Brief Historical Sketch of the Rosenwald Fund and Black Education in the South 1917-1948," March 19, 1980; unpub. typescript in the "Rosenwald Schools" file, Eastern Office, Division of Archives and History, Greenville, NC; 7. The Johnston County school district contributed \$156,500 toward the cost of constructing African-American rural schools. The greatest number of school buildings was constructed in Mecklenburg County, a total of 26.

United States Department of the Interior
National Park Service

NATIONAL REGISTER OF HISTORIC PLACES
CONTINUATION SHEET

St. Matthews School
Wake County, North Carolina

Section 8 Page 3

windows with multi-light sash arranged in groupings; two large classrooms at the rear separated by a wall which opened to create a one large space; and a third room that was used as the "industrial" room.

During the 1920s and 1930s, the school year consisted of a six-month term, and the term for the African American schools would begin later than in the white schools. In 1932, the school year began on September 5 for white children and on September 19 for black students.³ Although the school consisted of only two formal classrooms, in 1933 three teachers were hired for St. Matthews School. Most likely, the "industrial" room had been pressed into service as a third classroom.⁴

During the late 1930s and early 1940s, grades one through seven were taught at the school. Grades one through four were taught in the southwest classroom, and grades five through seven occupied the northeast room. The "industrial" room was used as a kitchen where lunch was prepared and served and the girls learned home economics.⁵

From 1922 when it opened until 1949 when it closed, the school was actively used. At the school building, adult education was offered during the evenings; the county agricultural cooperative extension held home demonstration programs; the county agents met with local farmers; and almost everyone attended the plays put on by the students.⁶

In 1949 the Wake County Board of Education sold the school to the trustees of St. Matthews Church. The building was then renovated to house three apartments. During the late 1980s the school was vacant and began to deteriorate. In 1990 the congregation of St. Matthews Baptist Church decided to repair and rehabilitate the building and in 1995 began a full restoration. St. Matthews School remains a source of pride for the African American community of the area. The building is presently used as a social hall and for community meetings.⁷

³ Wake County Board of Education, Minutes, 2 May 1932. North Carolina State Archives. Raleigh, North Carolina. Microfilm.

⁴ Wake County Board of Education, Minutes, 3 June 1932.

⁵ Almarie Caudle, Interview with Nancy Van Dolsen, September 2000. Ms. Caudle attended St. Matthews School.

⁶ Almarie Caudle, Interview with Nancy Van Dolsen, September 2000.

⁷ Almarie Caudle, Interview with Nancy Van Dolsen, September 2000.

United States Department of the Interior
National Park Service

NATIONAL REGISTER OF HISTORIC PLACES
CONTINUATION SHEET

St. Matthews School
Wake County, North Carolina

Section 9 Page 4

Bibliography

Caudle, Ann Marie. Interview with Nancy Van Dolsen, September 2000.

Cross, Jerry L. "Julius Rosenwald: His Fund and His Schools, A Brief Historical Sketch of the Rosenwald Fund and Black Education in the South 1917-1948," March 19, 1980. Unpublished typescript, in the "Rosenwald School" file, Eastern Office of the Department of Archives and History, Greenville, North Carolina.

Crow, Jeffrey J. , Paul D. Escott, Flora H. Hatley, *A History of African Americans in North Carolina*. Raleigh: Division of Archives and History, North Carolina Department of Cultural Resources, 1992.

Embree, Edwin R. *Julius Rosenwald Fund: A Review to June 30, 1928*. Chicago: Julius Rosenwald Fund, 1928.

Embree, Edwin R. and Julia Waxman. *Investment in People: The Story of the Julius Rosenwald Fund*. New York: Harper & Brothers, Publishers, 1949.

Hanchett, Thomas H. "The Rosenwald Schools and Black Education in North Carolina." *The North Carolina Historical Review* Vol. LXV, No. 4, October 1988: 388-444.

Lally, Kelly. *Historic Architecture of Wake County, North Carolina*. Raleigh: Planning Department of Wake County, 1995.

Lally, Kelly. National Register of Historic Places Multiple Property Documentation Form. Historic and Architectural Resources of Wake County, North Carolina (ca. 1770-1941). March 18, 1993.

Murray, Elizabeth Reid. Memo to Kelly Lally, September 10, 12, 1990. St. Matthews School, Survey File, Wake County, NC. North Carolina Division of Archives and History, Raleigh, North Carolina.

Thomas, Beth P. National Register of Historic Places Nomination for the W.E.B. Dubois School, Wake County, North Carolina. March 31, 1993.

Wake County Board of Education, Minutes 1925-1959. North Carolina State Archives, Raleigh, North Carolina. Microfilm.

United States Department of the Interior
National Park Service

NATIONAL REGISTER OF HISTORIC PLACES
CONTINUATION SHEET

St. Matthews School
Wake County, North Carolina

Section 10 Page 5

Verbal Boundary Description

The boundary corresponds to the present tax parcel number, St. Matthews Branch Township, PIN 0191.

Boundary Justification

The proposed boundary includes the original two-acre tract of land associated with the school, and the school itself.

St. Matthews School
Wake County, North Carolina

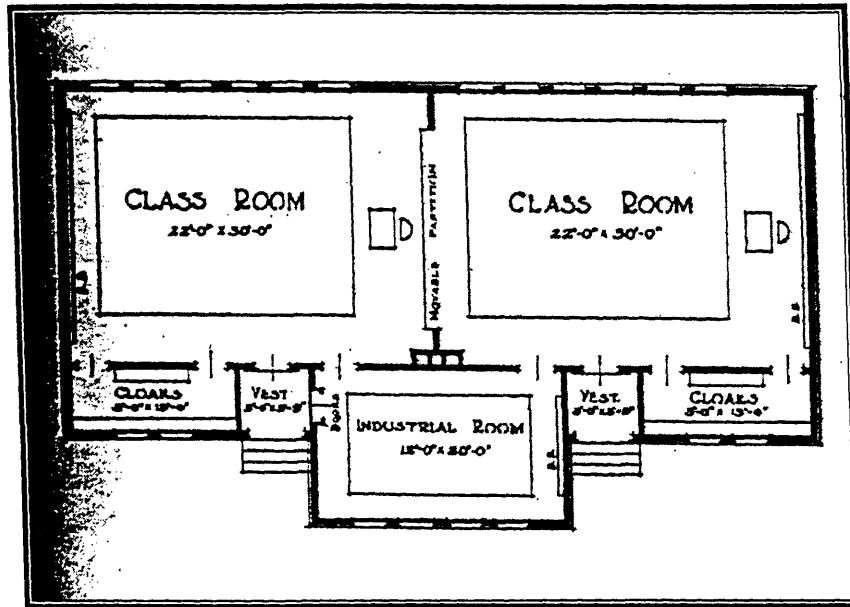

Plan for a two-teacher school from the Julius Rosenwald Foundation.
Identical plan constructed for St. Matthews School, Wake County, NC, 1922.
[from Edwin R. Embree, *Julius Rosenwald Fund: A Review to June 30, 1928*
(Chicago: 1928) 23.]

