

## DECIBEL Permit – Site Plan

The City of Raleigh established the **DECIBEL Permit** to allow commercial establishments to operate amplified sound at levels above standard limits while protecting quality of life for nearby residents. This permit applies to businesses located outside the Glenwood South Hospitality District and is intended for applicants who can demonstrate a commitment to responsible sound management. Approval is contingent on ensuring that amplified sound extending beyond the property line does not create significant harm to the surrounding community.

As part of the application process, applicants are required to submit a **Sound Mitigation Plan** and a **Site Plan**. These materials must clearly identify proposed sound equipment, programming, and specific strategies to minimize sound impacts beyond the property line. All plans must be completed in full and submitted online as attachments through the [Permit and Development Portal](#) when applying for the DECIBEL Permit.

City staff will review all submitted materials to determine whether the proposed use is appropriate for the site, considering factors such as proximity to residential areas, proposed sound levels, and the effectiveness of the proposed mitigation measures. Approved permits will include specific conditions that regulate amplified sound operations to reduce potential negative impacts on the surrounding community. This document outlines the required information needed to prepare a complete Site Plan.

### Business Information

Applicant Name: \_\_\_\_\_

Date: \_\_\_\_\_

Business Name: \_\_\_\_\_

Business Address: \_\_\_\_\_

### Site and Surroundings

Distance to Nearest Residential Use: \_\_\_\_\_

Distance to Nearest Adjacent Property: \_\_\_\_\_

Size of Listening Area: \_\_\_\_\_

Capacity of Listening Area: \_\_\_\_\_

### Description of Surrounding Area

Describe the area surrounding your establishment. *Examples may include, but are not limited to, nearby neighborhoods, schools, businesses, hotels, unique topographical features, zoning, and land use.*

## Site Plan:

Applicants must include a detailed site plan that illustrates the layout and orientation of all amplified sound equipment within the commercial property.

### The site plan should clearly show:

- The location of each speaker or sound source
- The direction each speaker is facing
- The boundaries of the listening area
- The proximity of the sound equipment to nearby residential properties
- Any physical structures or landscape features (e.g., walls, trees, elevation changes) that may affect sound travel
- Entrance
- Emergency Exit(s)
- Mixing Board (if applicable)
- Emergency Shut Off / Shunt Trip (if applicable)

This visual representation helps city staff assess the potential sound impact and evaluate the effectiveness of proposed mitigation strategies.

Please ensure the site plan is legible, to scale, and includes labels for all relevant elements.

### Example Acceptable Site Plan:

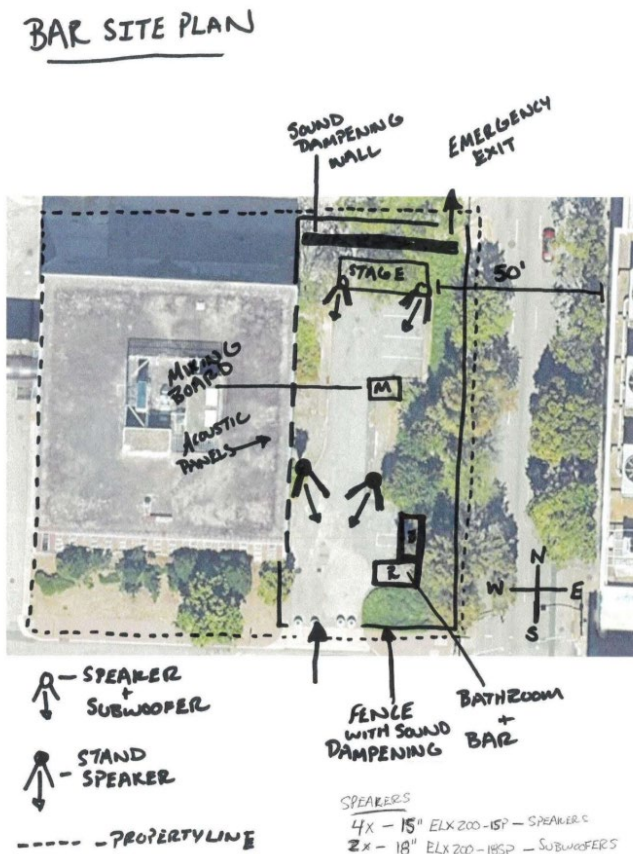

### Example Unacceptable Site Plan:

