



CERTIFICATE OF APPROPRIATENESS PLACARD

for Raleigh Historic Resources

Project Description:

Replace wood shingle roof with asphalt shingle roof

601 E Lane St

Address

Oakwood

Historic District

Historic Property

COA-0059-2024

Certificate Number

6/7/2024

Date of Issue

12/7/2024

Expiration Date

This card must be kept posted in a location within public view until all phases of the described project are complete. The work must conform with the code of the City of Raleigh and laws of the state of North Carolina. When your project is complete, you are required to ask for a final zoning inspection in a historic district area. Telephone the RHDC office at 832-7238 and commission staff will coordinate the inspection with the inspections Department. If you do not call for this final inspection, your Certificate of Appropriateness is null and void.

Signature, _____

Collette K

Raleigh Historic Development Commission

Pending the resolution of appeals, commencement of work is at your own risk.

Type or print the following:

Applicant name: Robin & Kimberly Weitkamp

Mailing address: 601 E Lane St

City: Raleigh

State: NC

Zip code: 27601

Date: 5/22/2024

Daytime phone #: 408.931.1344

Email address: robin.weitkamp@gmail.com

Applicant signature:

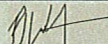

Minor work (staff review) – one copy

Major work (COA committee review) – ten copies

Additions > 25% of building sq. footage

New buildings

Demolition of building or structure

All other

Post approval re-review of conditions of approval

Office Use Only

Transaction #: _____

File #: **COA-0059-2024**

Fee: _____

Amount paid: _____

Received date: _____

Received by: _____

Property street address: 601 E Lane St.

Historic district: Oakwood

Historic property/Landmark name (if applicable): n/a

Owner name: Robin & Kimberly Weitkamp

Owner mailing address: 601 E Lane St, Raleigh, NC 27601

For applications that require review by the COA Committee (major work), provide addressed and stamped envelopes for owners for all properties with 100 feet on all sides of the property, as well as the property owner.

Property Owner Name & Address	Property Owner Name & Address

I understand that all major work applications that require review by the Raleigh Historic Development Commission's COA Committee must be submitted by 4 p.m. on the date of the application deadline; otherwise, consideration will be delayed until the following committee meeting. An incomplete application will not be accepted.

<p>Will you be applying for rehabilitation tax credits for this project? Yes <input type="checkbox"/> No <input checked="" type="checkbox"/></p> <p>Did you consult with staff prior to filing the application? Yes <input checked="" type="checkbox"/> No <input type="checkbox"/></p>	<p>Office Use Only</p> <p>Type of work: <u>CO</u></p>
---	---

Design Guidelines: please cite the applicable sections of the design guidelines (www.rhdc.org).		
Section/Page	Topic	Brief description of work (attach additional sheets as needed).
3.5.4	Roof covering materials	Cedar shingle roof needs repairs. If a complete reroofing is suggested, we seek approval to an asphalt shingle as is common in the neighborhood.
3.5.5	Roof covering materials	Same as above

Minor Work Approval (office use only)

Upon being signed and dated below by the Planning Director or designee, this application becomes the Minor Work Certificate of Appropriateness. It is valid until 12/07/2024.

Please post the enclosed placard form of the certificate as indicated at the bottom of the card. Issuance of a Minor Work Certificate shall not relieve the applicant, contractor, tenant, or property owner from obtaining any other permit required by City Code or any law. Minor Works are subject to an appeals period of 30 days from the date of approval.

Signature (City of Raleigh) Collette K Date 06/07/2024

601 E Lane St.

1909 constructed house has had several roofing treatments throughout the years. The previous owner (we purchased the house in 2019) had a cedar shingle roof installed. We have had some quotes for maintenance on the roof and some roofers have suggested a complete replacement using an asphalt or similar composition roofing material vs. spot repairs of the wood shingles. In evaluating options, we would like approval for asphalt (or similar composition) shingles, which are common throughout the Oakwood neighborhood, as a replacement option. We have not decided on whether we will repair or replace but would like to ensure that we have approval prior to any further evaluation of repair options.

The current roofing materials are shown below:



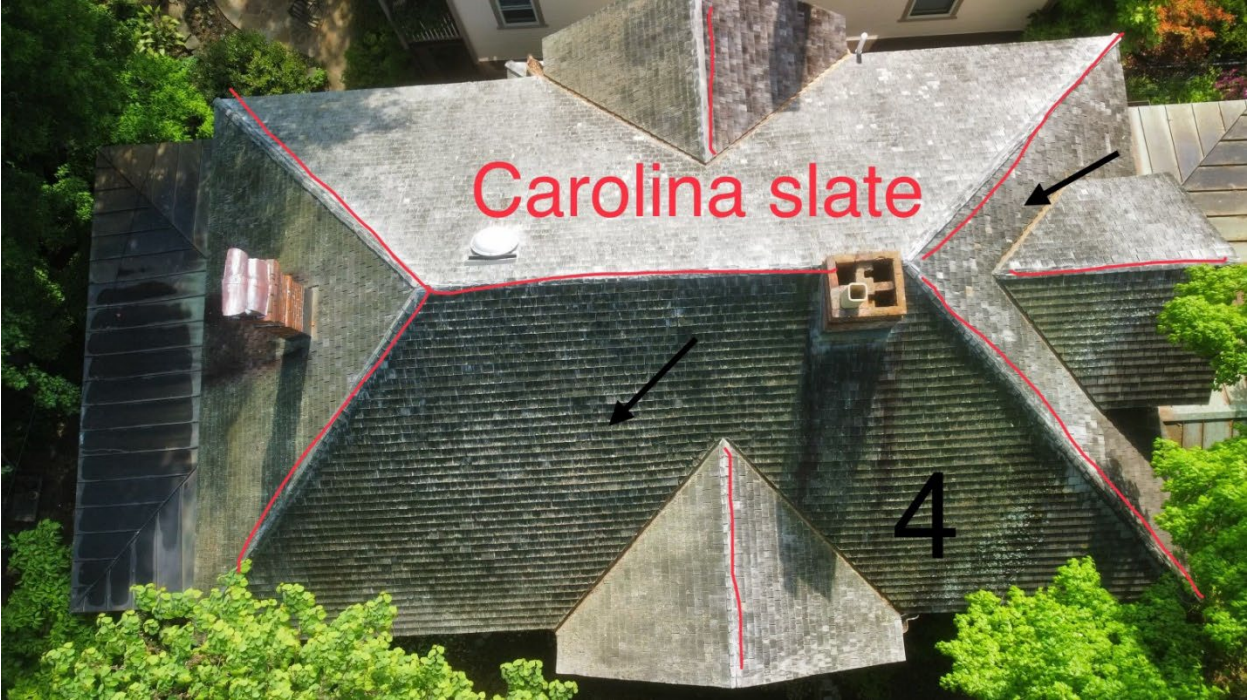

Carolina slate

4



Carolina slate



1

Carolina slate

4

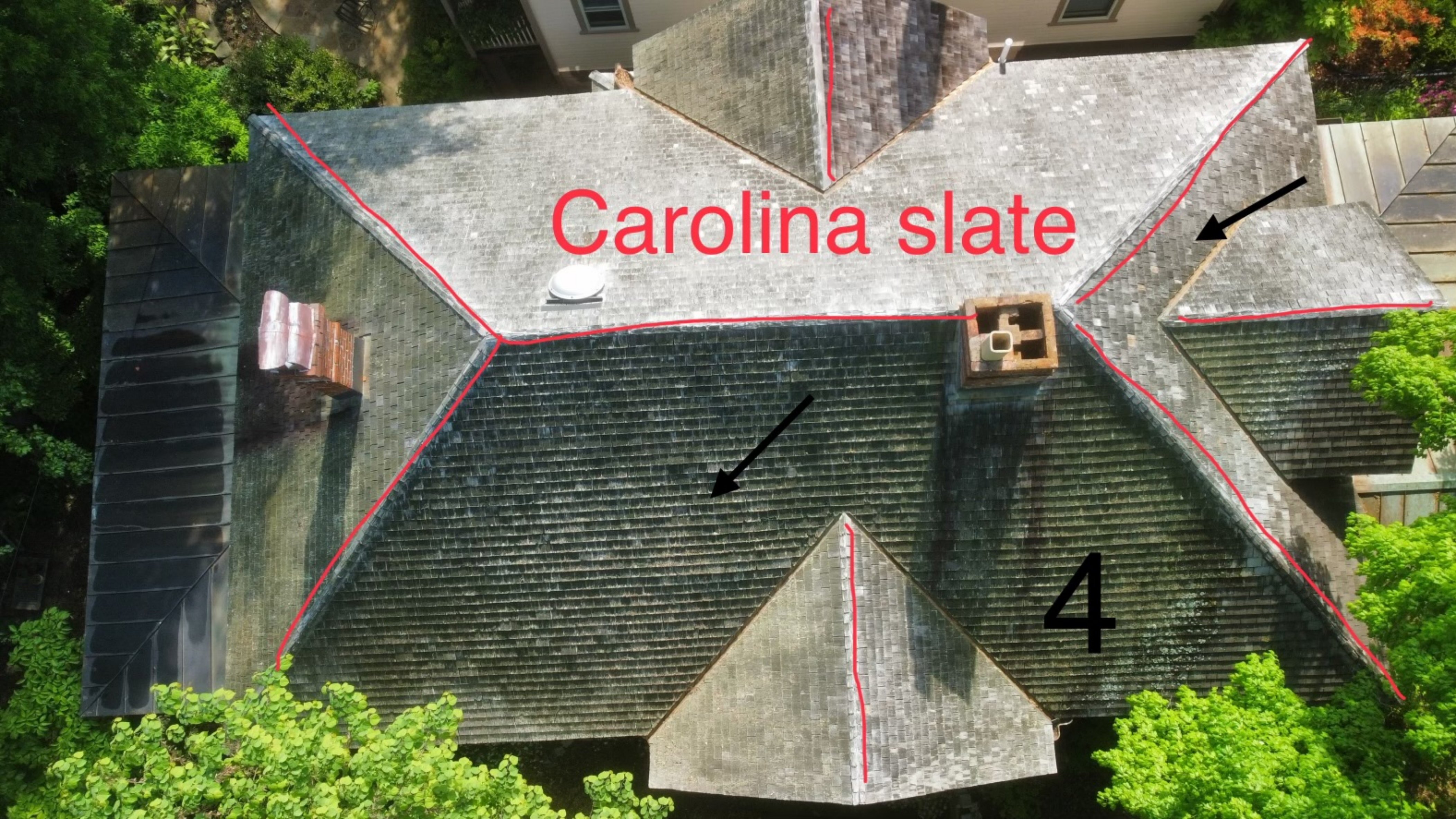

Building Supplies / Roofing / Roof Shingles

GAF Timberline Hdz Weathered Wood Laminated Architectural Roof Shingles (33.33-sq ft per Bundle)

Item #1439798 | Model #0487900

Shop GAF ★★★★★ 18289 ♡



20+ bought last week

\$39.48

Bulk Savings
\$35.53/ Each (10.0% Off) when you buy 72+

\$37.51 when you choose 5% savings on eligible purchases every day. [Learn How](#)

Shop the Collection

- A great value, architecturally stylish, but practically priced — with a Lifetime Limited Warranty (see GAF shingle and accessory limited warranty for complete coverage and details)
- New StrikeZone™ nailing area is the largest nail zone designed for high visibility, ease of installation, and maximum accuracy
- Proprietary LayerLock™ Technology mechanically fastens the common bond, allowing for a larger nailing area, up to 600% larger nailing target (compared to Timberline HDZ)

Manufacturer Color/Finish: Weathered Wood

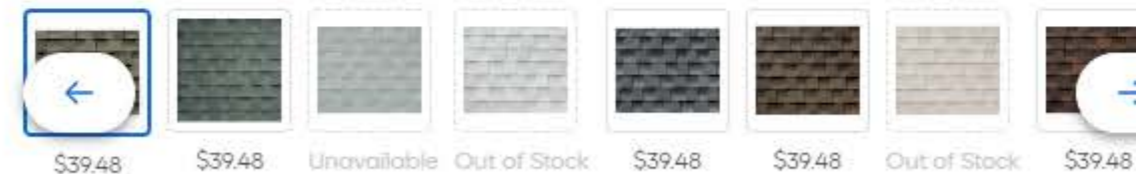

Pickup
Ready **Today**

Delivery
As soon as **Today**