

# CERTIFICATE OF APPROPRIATENESS PLACARD

for Raleigh Historic Resources

**Project Description:**

Replace vinyl windows; alter door

609 E Lane St

Address

Oakwood

Historic District

Historic Property

COA-0076-2020

Certificate Number

6/2/2020

Date of Issue

12/2/2020

Expiration Date

*This card must be kept posted in a location within public view until all phases of the described project are complete. The work must conform with the code of the City of Raleigh and laws of the state of North Carolina. When your project is complete, you are required to ask for a final zoning inspection in a historic district area. Telephone the RHDC office at 832-7238 and commission staff will coordinate the inspection with the inspections Department. If you do not call for this final inspection, your Certificate of Appropriateness is null and void.*

Signature, \_\_\_\_\_

Raleigh Historic Development Commission

A handwritten signature in dark ink, appearing to read "Erin Morton", is written over a horizontal line.

*Pending the resolution of appeals, commencement of work is at your own risk.*



Type or print the following:

Applicant name: William Madison

Mailing address: PO Box 6177

City: RALEIGH

State: NC

Zip code: 27628

Date: 5.18.2020

Daytime phone #: 919 4226039

Email address: MADISON RENOVATIONS NC @ GMAIL . COM

Applicant signature: [Signature]

Minor work (staff review) – one copy

Major work (COA committee review) – ten  
copies

Additions > 25% of building sq. footage

New buildings

Demolition of building or structure

All other

Post approval re-review of conditions of  
approval

**Office Use Only**

Transaction #: \_\_\_\_\_

File #: COA-0076-2020

Fee: \_\_\_\_\_

Amount paid: \_\_\_\_\_

Received date: \_\_\_\_\_

Received by: \_\_\_\_\_

Property street address: 609 E LANE ST RALEIGH NC 27604

Historic district: OAKWOOD

Historic property/Landmark name (if applicable):

Owner name: LIMBERLIE MESSER

Owner mailing address: 601 VIRGINIA AVE RALEIGH NC 27604

**For applications that require review by the COA Committee (major work), provide addressed and stamped envelopes for owners for all properties with 100 feet on all sides of the property, as well as the property owner.**

| Property Owner Name & Address | Property Owner Name & Address |
|-------------------------------|-------------------------------|
|                               |                               |
|                               |                               |
|                               |                               |
|                               |                               |
|                               |                               |
|                               |                               |



I understand that all major work applications that require review by the Raleigh Historic Development Commission's COA Committee must be submitted by 4 p.m. on the date of the application deadline; otherwise, consideration will be delayed until the following committee meeting. An incomplete application will not be accepted.

|  |  |
|--|--|
| Will you be applying for rehabilitation tax credits for this project?<br>Yes <input type="radio"/> No <input checked="" type="radio"/> | Office Use Only<br>Type of work: <u>29, 84</u> |
| Did you consult with staff prior to filing the application?<br>Yes <input checked="" type="radio"/> No <input type="radio"/>           |  |

| Design Guidelines: please cite the applicable sections of the design guidelines ( <a href="http://www.rhdc.org">www.rhdc.org</a> ). |         |   |
|---|---------|---|
| Section/Page  | Topic   | Brief description of work (attach additional sheets as needed). |
| 2.7.1   | Windows | REPLACE EXISTING VINYL UNITS W/ FULL VIEW WOOD                  |
| 2.7.1   | Windows | REPLACE SIDE ENTRY DOOR W NEW WINDOW                            |
|   |         |   |
|   |         |   |

| Minor Work Approval (office use only)   |                        |
|---|------------------------|
| Upon being signed and dated below by the Planning Director or designee, this application becomes the Minor Work Certificate of Appropriateness. It is valid until <u>12/02/2020</u> .   |                        |
| Please post the enclosed placard form of the certificate as indicated at the bottom of the card. Issuance of a Minor Work Certificate shall not relieve the applicant, contractor, tenant, or property owner from obtaining any other permit required by City Code or any law. Minor Works are subject to an appeals period of 30 days from the date of approval. |                        |
| Signature (City of Raleigh) <u>Elin Morth</u>   | Date <u>06/02/2020</u> |

All the existing vinyl sashes will be replaced with new wood sashes

The rear small window will be replaced with a similar sized casement unit facing the side yard

The side porch door (secondary door- there is 2) will be replaced with a new matching wood window







08



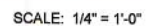

NEW  
CASEMENT WINDOW

VINYL

NEW PLAN

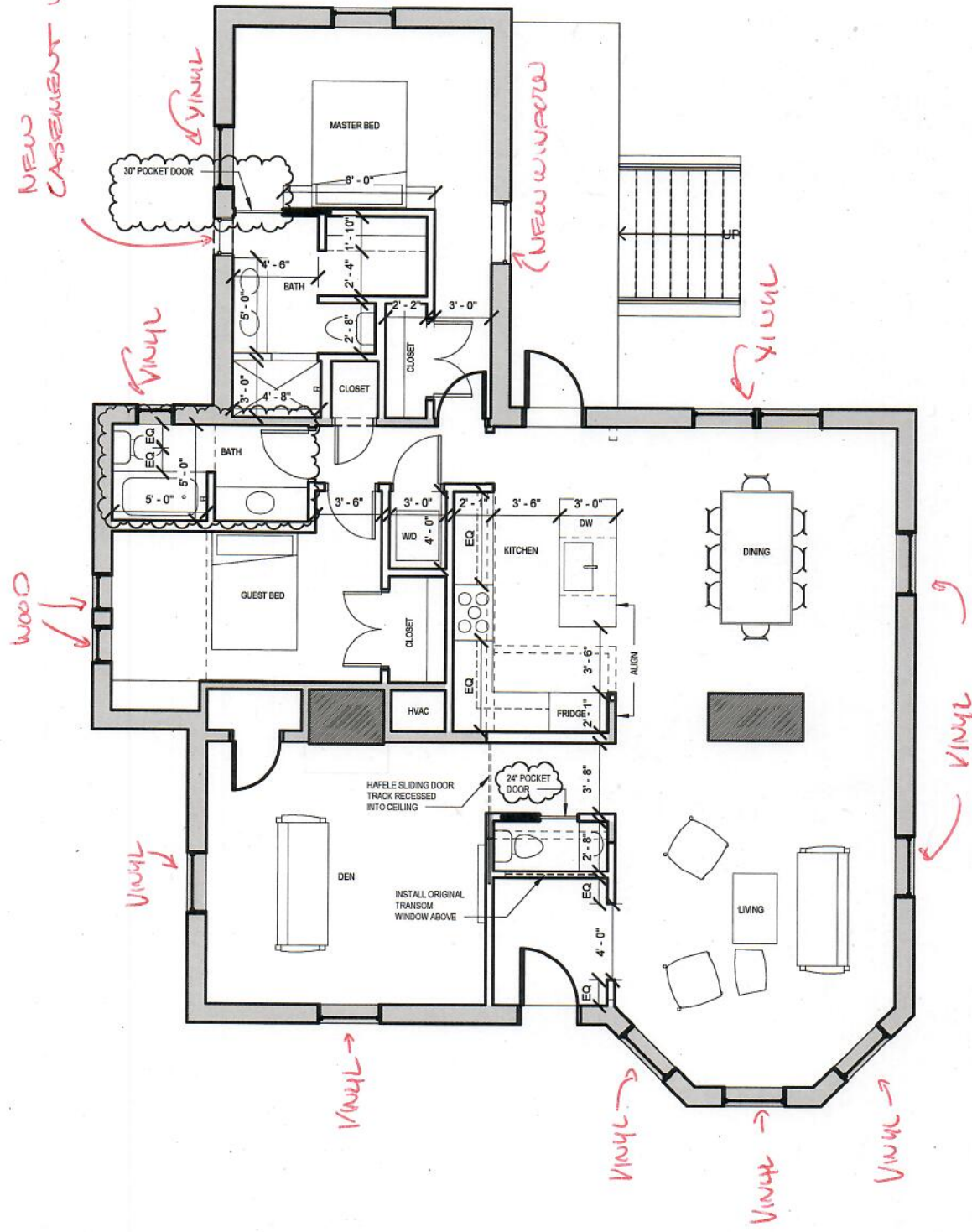

609 East Lane Street

MontgomeryChoi LLC  
602 East Hargett Street, Raleigh, NC 27601

03/23/20

LEVEL 1

SCALE: 3/16" = 1'-0"



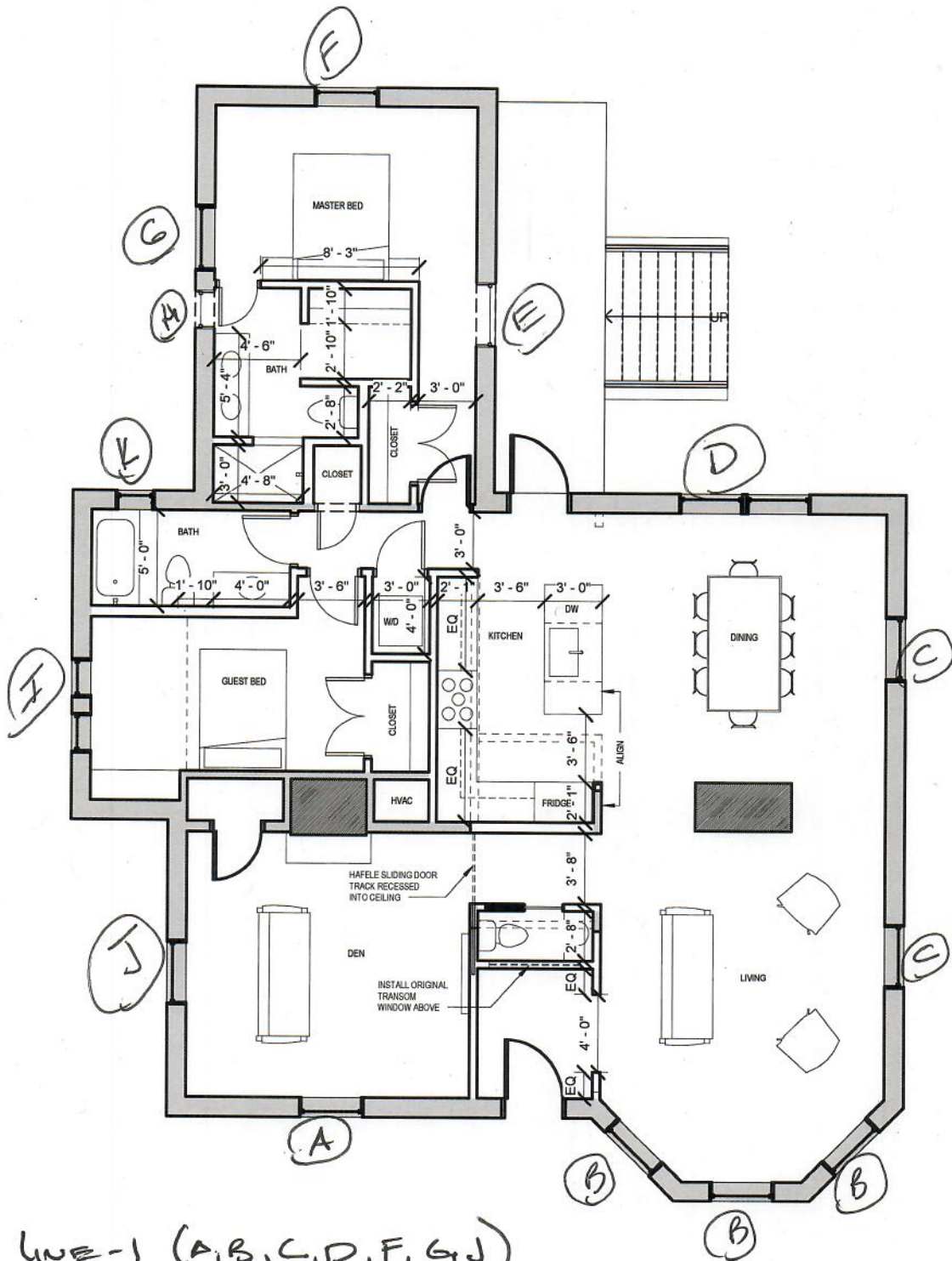

11- LINE-1 (A,B,C,D,F,G,J)  
 LINE-2 (K)  
 LINE-3-(I)  
 LINE-4-(E)  
 LINE-5-(H)

609 East Lane Street

MontgomeryChoi LLC  
 602 East Hargett Street, Raleigh, NC 27601

03/12/20

**LEVEL 1**

SCALE: 3/16" = 1'-0"







©



D



E -  
Door to  
Window





(F)

(F) LOCATION of  
New CASement

(G)





I - OLD WOOD  
WINDOWS FOUND  
IN CRAWL SPACES  
REPLACED THE  
SLIDERS FOR  
COA-0017-2020







This was the old small unit @ "H" location originally moved in COA 0017-2020





TMLS















Peter L. Farren  
1053 E. Whitaker Mill Rd Suite 165  
Raleigh, NC 27604  
919-609-6567



**BILL TO:**

**SHIP TO:**

**Phone**

**Phone**

**Email**

**Fax**

**Contact Info**

**Contact Info**

| QUOTE # | PO # | QUOTE NAME     | PROJECT | JOB NAME | CUSTOMER PO # |
|---------|------|----------------|---------|----------|---------------|
| 1154851 |      | 609 E. Lane St | Madison |          |               |

| LINE # | LINE TYPE | DESCRIPTION | QTY | U/M |
|--------|-----------|-------------|-----|-----|
|--------|-----------|-------------|-----|-----|

|       |               |         |    |  |
|-------|---------------|---------|----|--|
| 100-1 | WindowAndDoor | PK- 329 | 11 |  |
|-------|---------------|---------|----|--|

**\*\*2020 PRICING\*\***

All-Wood Universal Sash Replacement Kit Double Hung Operating 32 x 70

2-8 x 5-10, Sash Opening Width = 32, Sash Opening Height = 70, Sash Split = 50/50

Complete Sash Kit, CoreGuard Plus, Sill Angle 14, Product Offering Special Modification = Yes

Pine Exterior, Exterior Primed Finish = White, Natural, Pine Interior

Sash-Panel Exterior Primed Finish = White, Sash Interior = Natural

Dual Insulated, Low-E, Standard Bead, Argon Gas, Black Warm Edge Spacer

Standard Hardware Type, Matte Black, Jamb Liner Type = Concealed, 2-Locks, WOCD=No

No Screen, Exterior Side Screen Stop = No, Exterior Head Screen Stop = No

Entire Set

U-Factor = 0.29, SHGC = 0.27, CR = 60, VT = 0.5, AI = <0.30/<1.5, CPD

= SIE-N-112-01437-00001, Energy Star Region = NC, GapFill1 = ARG,

Can ER = 17, Can ES Zone = No/non, W m 2k = 1.65

Unit 1: Glass Width = 27.5, Glass Height = 31.96875,

\*\*\* Internal Comments \*\*\*

Unit 1: MFG W/ WHITE HEAD STOP

**Rough Opening:** N/AA

**Overall Unit Size:** N/AA

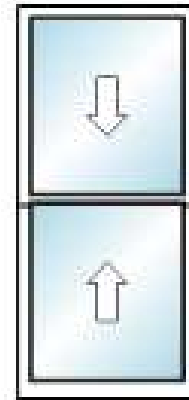

Room Location: None Assigned

| QUOTE # | PO # | QUOTE NAME     | PROJECT | JOB NAME | CUSTOMER PO # |
|---------|------|----------------|---------|----------|---------------|
| 1154851 |      | 609 E. Lane St | Madison |          |               |

| LINE # | LINE TYPE     | DESCRIPTION | QTY | U/M |
|--------|---------------|-------------|-----|-----|
| 200-1  | WindowAndDoor | PK- 329     | 1   |     |

**\*\*2020 PRICING\*\***

All-Wood Universal Sash Replacement Kit Double Hung Operating 24 x 38  
2-0 x 3-2, Sash Opening Width = 24, Sash Opening Height = 38, Sash Split = 50/50  
Complete Sash Kit, CoreGuard Plus, Sill Angle 14, Product Offering Special Modification = Yes  
Pine Exterior, Exterior Primed Finish = White, Natural, Pine Interior Sash-Panel Exterior Primed Finish = White, Sash Interior = Natural  
Dual Insulated, Low-E, Standard Bead, Argon Gas, Black Warm Edge Spacer  
Standard Hardware Type, Matte Black, Jamb Liner Type = Concealed, 1-Lock, WOCD=No  
No Screen, Exterior Side Screen Stop = No, Exterior Head Screen Stop = No  
Entire Set  
U-Factor = 0.29, SHGC = 0.27, CR = 60, VT = 0.5, AI = <0.30/<1.5, CPD = SIE-N-112-01437-00001, Energy Star Region = NC, GapFill1 = ARG, Can ER = 17, Can ES Zone = No/non, W m 2k = 1.65  
Unit 1: Glass Width = 19.5, Glass Height = 15.96875,

\*\*\* Internal Comments \*\*\*

Unit 1: MFG W/ WHITE HEAD STOP

**Rough Opening:** N/AA

**Overall Unit Size:** N/AA

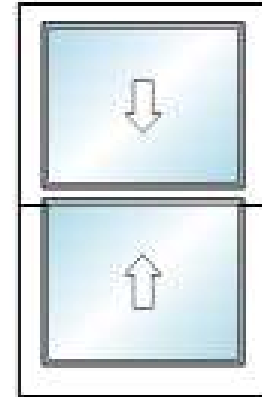

Room Location: None Assigned

| LINE # | LINE TYPE     | DESCRIPTION | QTY | U/M |
|--------|---------------|-------------|-----|-----|
| 300-1  | WindowAndDoor | PK- 329     | 2   |     |

**\*\*2020 PRICING\*\***

All-Wood Universal Sash Replacement Kit Double Hung Operating 24 x 54  
2-0 x 4-6, Sash Opening Width = 24, Sash Opening Height = 54, Sash Split = 50/50  
Complete Sash Kit, CoreGuard Plus, Sill Angle 14, Product Offering Special Modification = Yes  
Pine Exterior, Exterior Primed Finish = White, Natural, Pine Interior Sash-Panel Exterior Primed Finish = White, Sash Interior = Natural  
Dual Insulated, Low-E, Standard Bead, Argon Gas, Black Warm Edge Spacer  
Standard Hardware Type, Matte Black, Jamb Liner Type = Concealed, 1-Lock, WOCD=No  
No Screen, Exterior Side Screen Stop = No, Exterior Head Screen Stop = No  
Entire Set  
U-Factor = 0.29, SHGC = 0.27, CR = 60, VT = 0.5, AI = <0.30/<1.5, CPD = SIE-N-112-01437-00001, Energy Star Region = NC, GapFill1 = ARG, Can ER = 17, Can ES Zone = No/non, W m 2k = 1.65  
Unit 1: Glass Width = 19.5, Glass Height = 23.96875,

\*\*\* Internal Comments \*\*\*

Unit 1: MFG W/ WHITE HEAD STOP

**Rough Opening:** N/AA

**Overall Unit Size:** N/AA

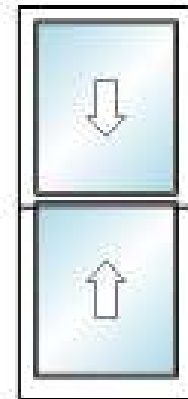

Room Location: None Assigned



| QUOTE # | PO # | QUOTE NAME     | PROJECT | JOB NAME | CUSTOMER PO # |
|---------|------|----------------|---------|----------|---------------|
| 1154851 |      | 609 E. Lane St | Madison |          |               |

| LINE # | LINE TYPE     | DESCRIPTION | QTY | U/M |
|--------|---------------|-------------|-----|-----|
| 400-1  | WindowAndDoor | PK- 329     | 1   |     |

\*\*APPROVED STATUS.\*\*

\*\*2020 PRICING\*\*

\*\*This unit has custom pricing.\*\*

Wood Windows Double Hung Operating 33.46875 x 72.625

28 x 32, Frame Width = 33.46875, Frame Height = 72.625, Sash Split = 50/50

Complete Unit, CoreGuard Plus, Product Offering Special Modification = Yes

Pine Exterior, Exterior Primed Finish = White, Natural, Pine Interior

Sash-Panel Exterior Primed Finish = White, Sash Interior = Natural

Ind. FL = FL24481.3, Ind. TDI =

Dual Insulated, Low-E, Standard Bead, Argon Gas, Black Warm Edge Spacer

Applied Hardware, Matte Black, Jamb Liner Type = Concealed, 2-Locks, WOCD=No

No Screen

Flat Casing, Custom, 4.5", Casing W/Sill Nose-Subsill, Exterior Sill

Nose-Subsill Size = Historic 2", Primed Exterior, Casing Applied,

Extended Sill Horn, 1.5

4-9/16"

Packaging Type = Sill Nose/Subsill Packaging

U-Factor = 0.29, SHGC = 0.27, CR = 60, VT = 0.5, AI = <0.30/<1.5, CPD

= SIE-N-112-01437-00001, Energy Star Region = NC, GapFill1 = ARG,

Can ER = 17, Can ES Zone = No/non, W m 2k = 1.65

Performance Upgrade = No

Status = Approved, Status Description = ALL-WOOD DOUBLE HUNG

33.46875X72.625, Status Quote Number = 1154851, Status Date =

5072020

Unit 1: Glass Width = 28, Glass Height = 32, Lower Glass Sash Width =

30.375, Lower Glass Sash Height = 35.92188, Upper Glass Sash Width =

30.375, Upper Glass Sash Height = 34.60938

\*\*\* Internal Comments \*\*\*

Unit 1: MFG W/ CUSTOM FLAT CASING - 4.5"

**Rough Opening:** 34.21875" X 73.125"

**Overall Unit Size:** 33.46875" X 72.625"

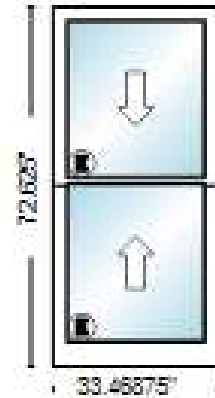

Room Location: Master Bedroom

| QUOTE # | PO # | QUOTE NAME     | PROJECT | JOB NAME | CUSTOMER PO # |
|---------|------|----------------|---------|----------|---------------|
| 1154851 |      | 609 E. Lane St | Madison |          |               |

| LINE # | LINE TYPE     | DESCRIPTION | QTY | U/M |
|--------|---------------|-------------|-----|-----|
| 500-1  | WindowAndDoor | PK- 329     | 1   |     |

\*\*APPROVED STATUS.\*\*

\*\*2020 PRICING\*\*

\*\*This unit has custom pricing.\*\*

All-Wood Casement-Awning Casement Right 20.1875 x 32.1875

15 x 27, Frame Width = 20.1875, Frame Height = 32.1875, Screen Width = 16.4375, Screen Height = 27.375

Complete Unit, CoreGuard Plus, Standard, Product Offering Special Modification = Yes

Pine Exterior, Exterior Primed Finish = White, Weatherstrip Grey, Natural, Pine Interior

Sash-Panel Exterior Primed Finish = White, Sash Interior = Natural, Weatherstrip White

Ind. FL = FL21154.3, Ind. TDI =

Dual Insulated, Low-E, Standard Bead, Argon Gas, Black Warm Edge Spacer

Hardware = Shipped with Unit, E-Guard Finish (Beige), Encore, Matte Black, WOCD=No, 14" Hinge

Full Screen Shipped Separately, Matte Black, Fiberglass Mesh

Flat Casing, Custom, 4.5", Casing W/Sill Nose-Subsill, Exterior Sill Nose-Subsill Size = Historic 2", Primed Exterior, Casing Applied, Extended Sill Horn, 1.5

4-9/16"

Packaging Type = Crating

U-Factor = 0.27, SHGC = 0.27, CR = 61, VT = 0.47, AI = <0.30/<1.5, CPD = SIE-N-117-00238-00001, Energy Star Region = N,NC, GapFill1 = ARG, Can ER = -1, Can ES Zone = , W m 2k = 1.53

Status = Approved, Status Description = ALL-WOOD CASEMENT

20.1875X32.1875, Status Quote Number = 1154851, Status Date = 5122020

Unit 1: Glass Width = 15, Glass Height = 27,Sash Width = 18.59375, Sash Height = 30.59375

\*\*\* Internal Comments \*\*\*

Unit 1: MFG W/ CUSTOM FLAT CASING - 4.5"

**Rough Opening:** 20.9375" X 33.4375"

**Overall Unit Size:** 20.1875" X 32.1875"

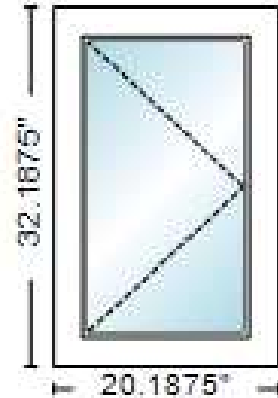

Room Location: Master Bath



| QUOTE # | PO # | QUOTE NAME     | PROJECT | JOB NAME | CUSTOMER PO # |
|---------|------|----------------|---------|----------|---------------|
| 1154851 |      | 609 E. Lane St | Madison |          |               |

| BID BY | SALESPERSON |
|--------|-------------|
|        | 240         |

Comments:

RK3039 - 5/07/2020 - PRICE LIST. QUOTE VALID FOR 30 DAYS.

RK - 5/12/2020 - REVISED

#### COMPANY

Unless otherwise noted on the line item, this product is covered under a Sierra Pacific Windows limited warranty. Please see your dealer, the Website [WWW.SIERRAPACIFICWINDOWS.COM](http://WWW.SIERRAPACIFICWINDOWS.COM) or our marketing literature for a copy of the applicable limited warranty for specific language, limitations and exclusions.

The pricing on this Quote is valid for 30 days and not intended to be used as a final Invoice. (Contingent on current pricebook) The Quote does not include charges for Shop Drawings.

Sierra Pacific offers a variety of wood species produced in combinations of solid and veneer-wrapped wood parts that have varying grain patterns. Wood characteristics also vary due to the species of the wood. The combination of these items could result in color variations of the finished stained products. Outswing Doors will have a complementary species of wood threshold.

#### RATINGS

Oversized units and certain mulled/stacked configurations have not been tested and therefore have no performance guide (PG) rating. Job-specific engineering analysis may be available for these non-rated units. Please contact your DST group to determine available options for non-rated product. A complete list of rated products is available at [WWW.SIERRAPACIFICWINDOWS.COM](http://WWW.SIERRAPACIFICWINDOWS.COM)

The Transcend H3 products do not have a PG rating.

If units are being installed in an area requiring specific PG ratings the unit must be installed in the exact manner tested as shown in our certified installation details. These details can be found on the Florida Building Code website at [www.floridabuilding.org](http://www.floridabuilding.org) or can be obtained by contacting Sierra Pacific's Architectural Services Department at 800-433-4873 ext. 1734.

Recent building code changes require the addition of limiting devices on any operating unit installed where the finished clear opening of the unit is within 24" of the floor and is more than 72" above the finished grade or other surface below the window. Please check with your local building department to determine if this code is a requirement in your jurisdiction and order units accordingly.

#### THERMAL PERFORMANCE

This quote may contain glazing options that include coating 'i89'. These glazing options may create an increased risk of room side glass condensation in areas where the winter outdoor temperatures are below freezing (32°F/0°C).

**We Appreciate Your Business!**

- It is the responsibility of the architect and/or contractor to determine proper fit and function of any product relative to code requirements in the municipality of a given building site.
- All installations should be performed by an approved, certified installer and be installed in accordance with AAMA Installation Masters methodology.
- It is the responsibility of the installer to properly install products and to verify compatibility of sealants, flashing, and all building envelope membrane system components.
- It is the responsibility of the installer to adequately shim all windows and doors. The shim placement should start no more than 4 inches from each corner, then every 12 to 16 inches thereafter. Shims are required at the check rails on double hung windows.
- For complete and product specific installation instructions please refer to our installation manual or contact your Sierra Pacific Windows Representative.
- Blocking, sealant / caulking, installation, interior trim, fasteners, flashing, metal trim, sill pans and shims are not supplied unless otherwise noted.
- Sierra Pacific Windows is not responsible for repair or replacement of products damaged by other trades, window protection or storage following delivery, label removal or final cleaning.
- For warranty questions, please refer to Sierra Pacific Limited Warranty.
- Improper installation will void the warranty.
- Manufacturing lead time does not begin until all signed submittals have been received at the Sierra Pacific Windows Office.
- Sierra Pacific is not responsible for the design of, conditions in, or performance of building construction beyond the perimeters of the Sierra Pacific units.
- Sierra Pacific is not responsible for any errors incurred through the use of these drawings by others.
- Sierra Pacific is not responsible for improper installation
- It is the Distributor's responsibility to verify that all items specified on the order are correct.

**TEMPERED GLASS NOTES:**  
 The manufacturing of tempered glass involves heating and cooling processes that impart a minor wave distortion in the glass surface resulting in non-flat reflection. Currently, there is no industry standard for wave distortion in tempered glass. There are no methods or tools available for measuring wave distortion in the field and any attempt at measurement is subjective at best. Most field applications are insulated glass units which, due to their construction and in combination with various environmental factors, also affect reflection. Wave distortion is an unavoidable characteristic of tempered glass that does not impair the integrity of the glass, is not recognized in the industry as a defect and is, therefore, a non-warrantable item.

| REVISIONS |       |     |
|-----------|-------|-----|
| Symbol:   | Date: | By: |
|           |       |     |
|           |       |     |
|           |       |     |
|           |       |     |

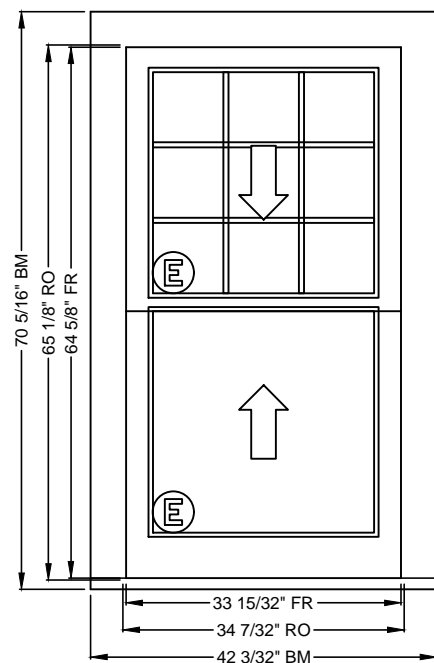

**ROOM LOCATION:**  
 FRONT BR, SIDE BR,  
 BACK BR

**LINE ITEM: 200, Qty: 6**

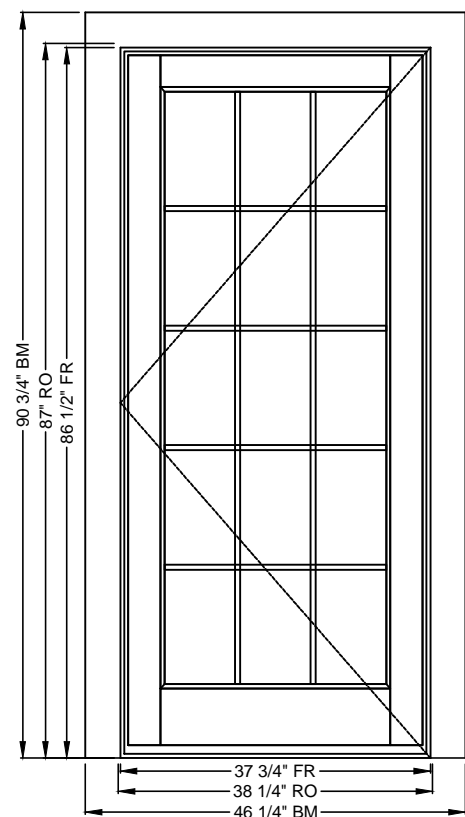

**ROOM LOCATION:**  
 FRONT DOOR

**LINE ITEM: 700, Qty: 1**



## Elevations

(Exterior View)

### E 1.0 - E 1.0

APPROVED SHOP DRAWINGS MUST BE SIGNED OR STAMPED BY THE FOLLOWING BEFORE THIS PROJECT WILL BE RELEASED INTO A PRODUCTION ORDER.

THE SIGNATURES REQUIRED ARE TO CONFIRM THAT QUANTITIES, SIZES, GLAZING, HANDING, TRIM, GENERAL NOTES, WALL CONDITIONS, INSTALLATION AND FLASHING DETAILS, ETC. HAVE BEEN REVIEWED AND APPROVED.

|                   |            |
|-------------------|------------|
| DISTRIBUTOR _____ | DATE _____ |
| ARCHITECT _____   | DATE _____ |
| CONTRACTOR _____  | DATE _____ |

- GLAZING KEY -

Ⓣ TEMPERED

**SPW Distributor Name**  
 STEPHENSON MILLWORK CO  
 INC  
 E MAIL

**Customer Support Drawing**  
**E-Bid #: 967753**  
☐ PDF Attached to eBid

**Project Name**  
**GATEWAY BUILDING CO**

Request Date: 6/29/2018  
 DST: RANDEE KREMSREITER

|                  |              |
|------------------|--------------|
| Date: 6/29/2018  | Sheet        |
| Scale: 1/2" = 1" | 8 1/2" X 11" |
| Drawn By: BK     | <b>E 1.0</b> |



4 1/2

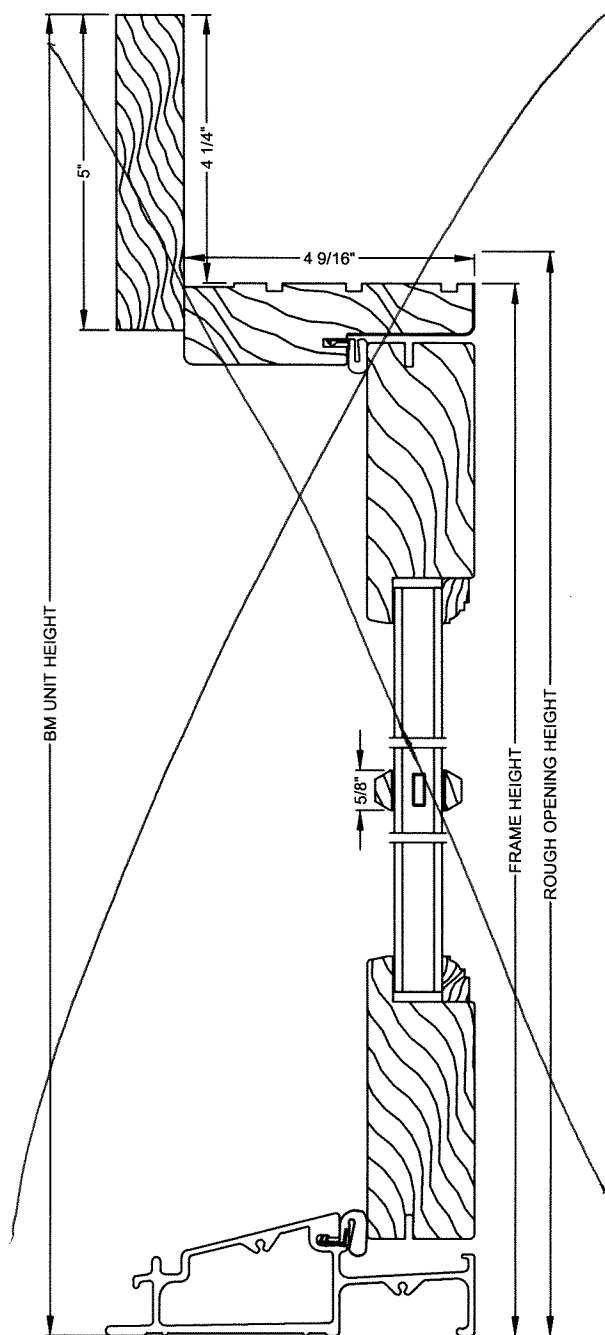
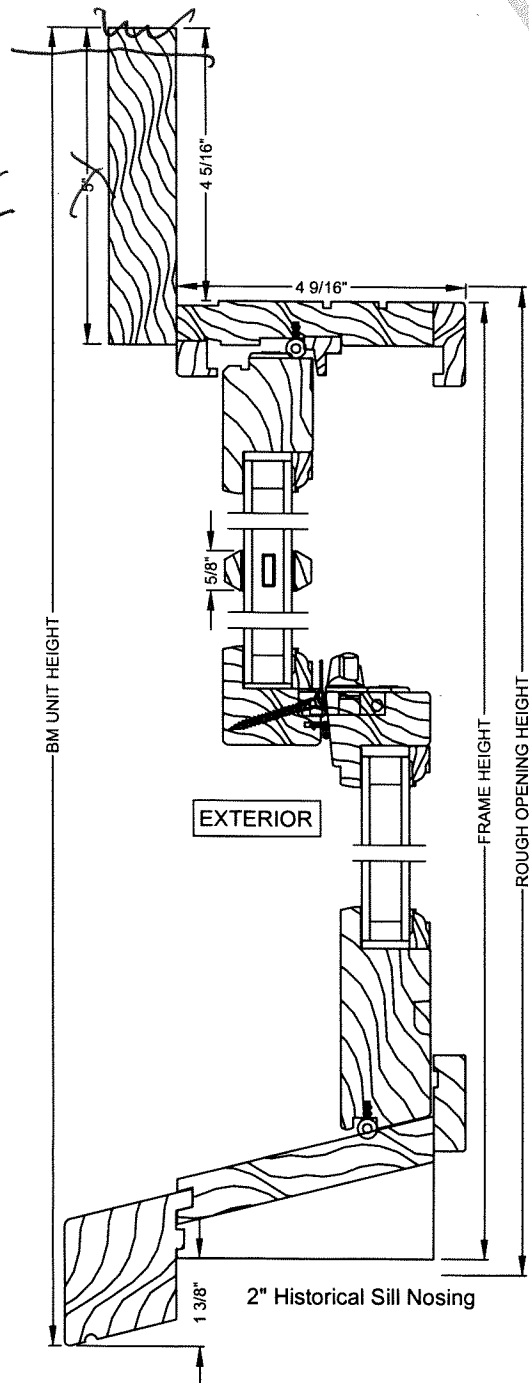

## Sections

(Exterior View)

### S 1.0 - S 2.0

APPROVED SHOP DRAWINGS MUST BE SIGNED OR STAMPED BY THE FOLLOWING BEFORE THIS PROJECT WILL BE RELEASED INTO A PRODUCTION ORDER.

THE SIGNATURES REQUIRED ARE TO CONFIRM THAT QUANTITIES, SIZES, GLAZING, HANDING, TRIM, GENERAL NOTES, WALL CONDITIONS, INSTALLATION AND FLASHING DETAILS, ETC. HAVE BEEN REVIEWED AND APPROVED.

|                   |            |
|-------------------|------------|
| DISTRIBUTOR _____ | DATE _____ |
| ARCHITECT _____   | DATE _____ |
| CONTRACTOR _____  | DATE _____ |

- GLAZING KEY -

① TEMPERED

SPW Distributor Name  
STEPHENSON MILLWORK CO  
INC

Customer Support Drawing  
**E-Bid #: 967753**

☐ PDF Attached to eBid

Project Name  
**GATEWAY BUILDING CO**

Request Date: 6/29/2018  
DST: RANDEE KREMSREITER

Date: 6/29/2018

Scale: 4" = 1'

Drawn By: BK

Sheet  
8 1/2" X 11"

**S 1.0**



# SIERRA All-Wood PACIFIC Casement Window WINDOWS

SECTION DETAILS  
DRAWN TO 1"=1" SCALE  
Printed Scale 3" = 1'

PAGE 2 of 4

## HEAD DETAIL ALL-WOOD CASEMENT, OPERATING

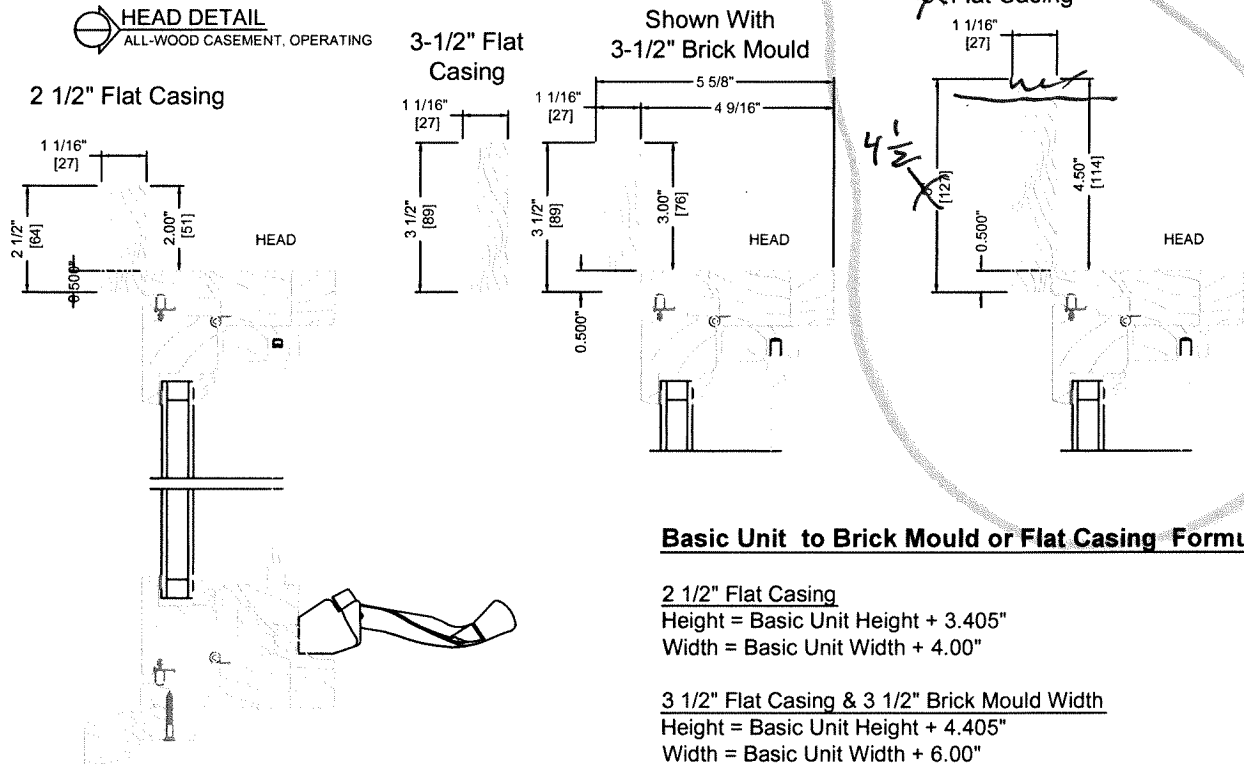

## Basic Unit to Brick Mould or Flat Casing Formulas

### 2 1/2" Flat Casing

Height = Basic Unit Height + 3.405"

Width = Basic Unit Width + 4.00"

### 3 1/2" Flat Casing & 3 1/2" Brick Mould Width

Height = Basic Unit Height + 4.405"

Width = Basic Unit Width + 6.00"

### 4 1/2" Flat Casing

Height = Basic Unit Height + 5.905"

Width = Basic Unit Width + 9.00"

## 2 1/2" Flat Casing

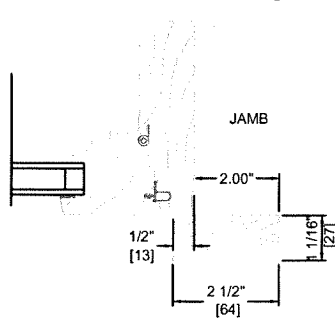

## 3-1/2" Brick Mould

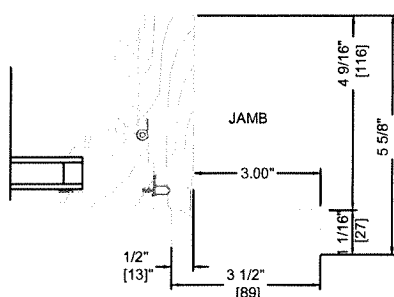

## 5" Flat Casing

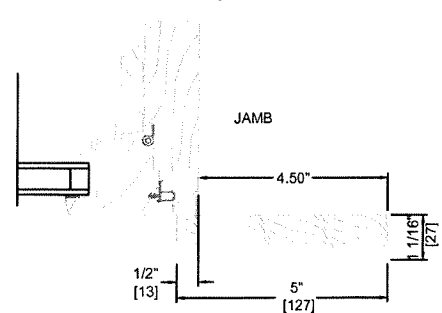

## 3-1/2" Flat Casing

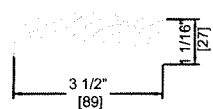

## SILL DETAIL ALL-WOOD CASEMENT, OPERATING

## GLAZING OPTIONS

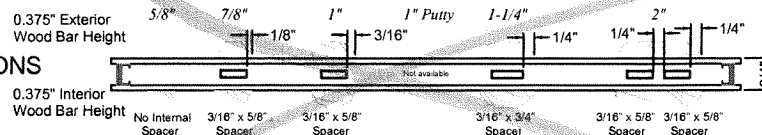

PLEASE NOTE: STANDARD SPACER COLOR IS MILL FINISH



2" Historic Subsill

## 2" Historic Subsill

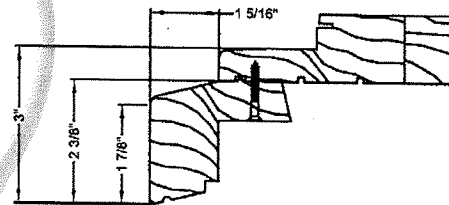

## 2" Optional Subsill

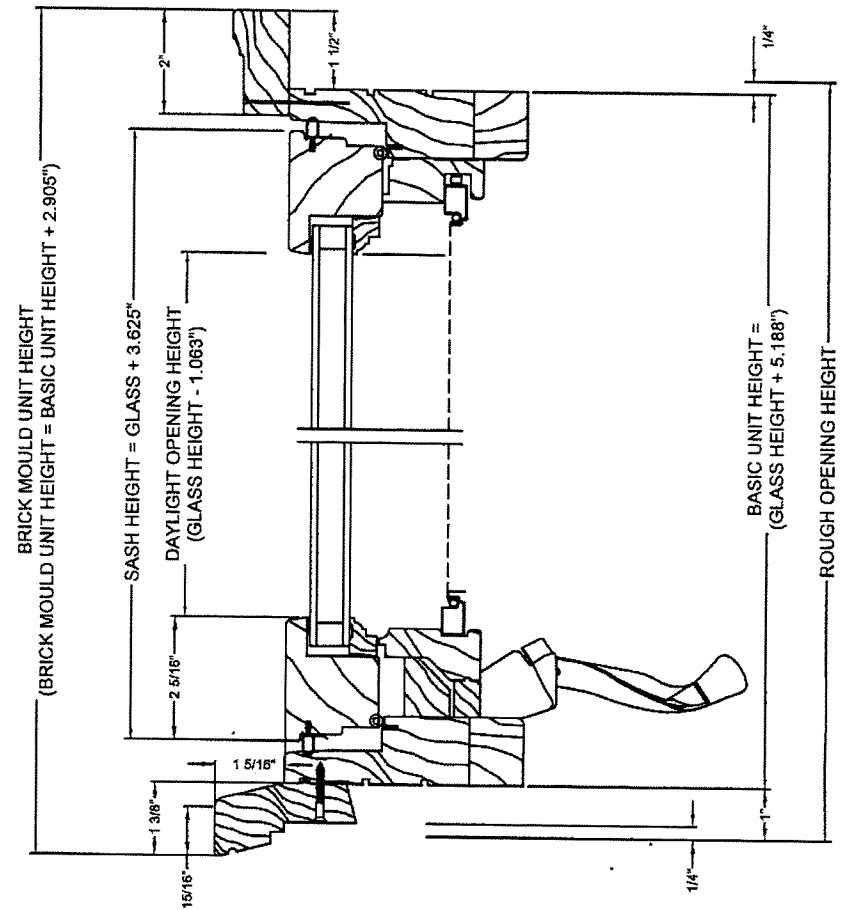

2" Standard Subsill



Head & Sill Details  
Page 1 of 8  
Drawn to Full Scale  
Printed Scale 4" = 1'

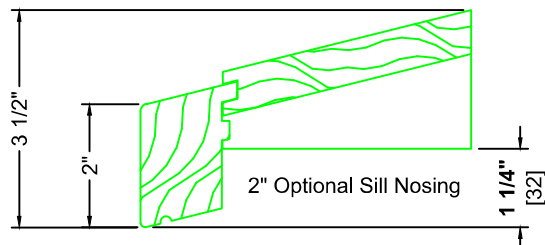
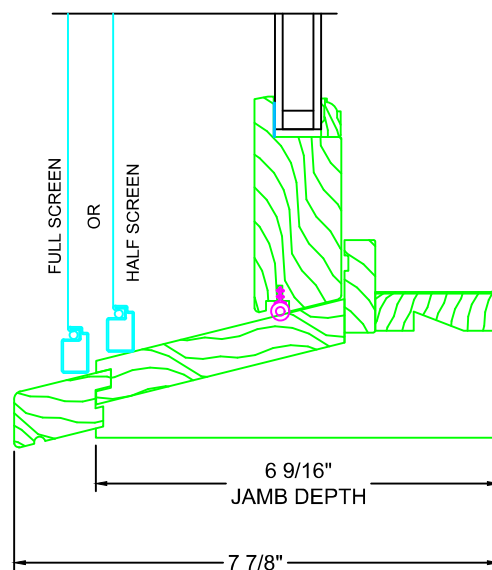



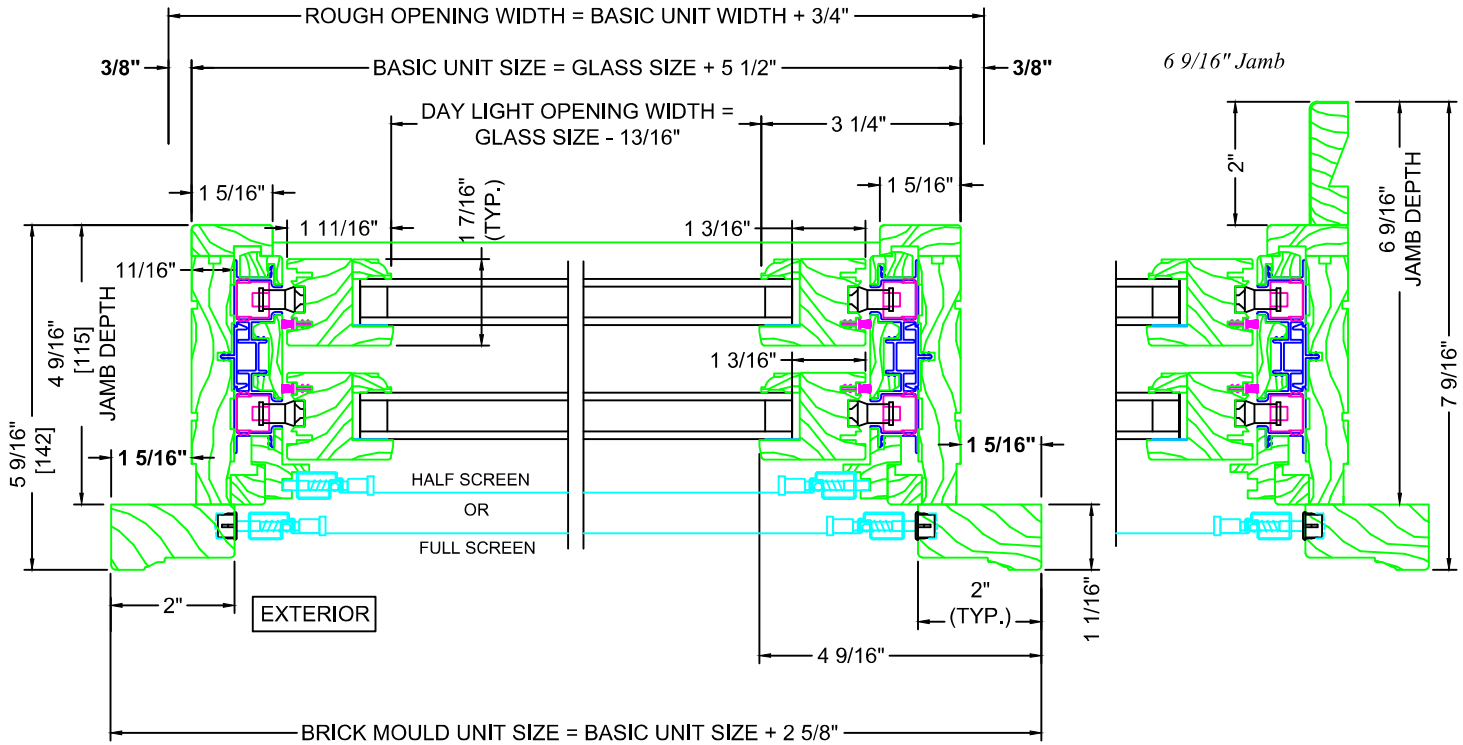

## GLAZING OPTIONS

Single & Dual Insulated Glass available in operating and fixed units.  
Grille in Airspace

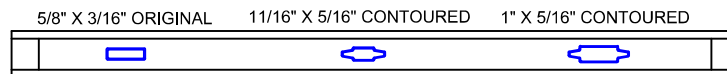

## HDL, Surround and KD Grille Bar Chart

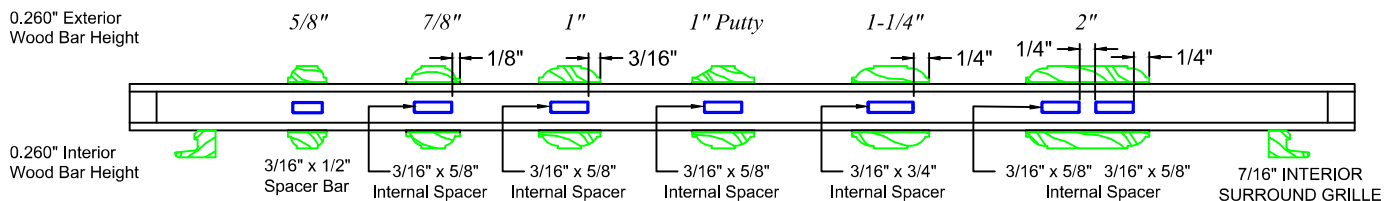

PLEASE NOTE: STANDARD INTERNAL SPACER COLOR IS MILL FINISH

**2 1/2", 3 1/2" & 5" Flat Casing also Available**

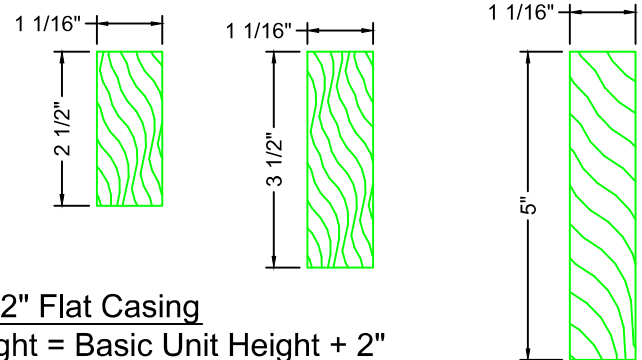
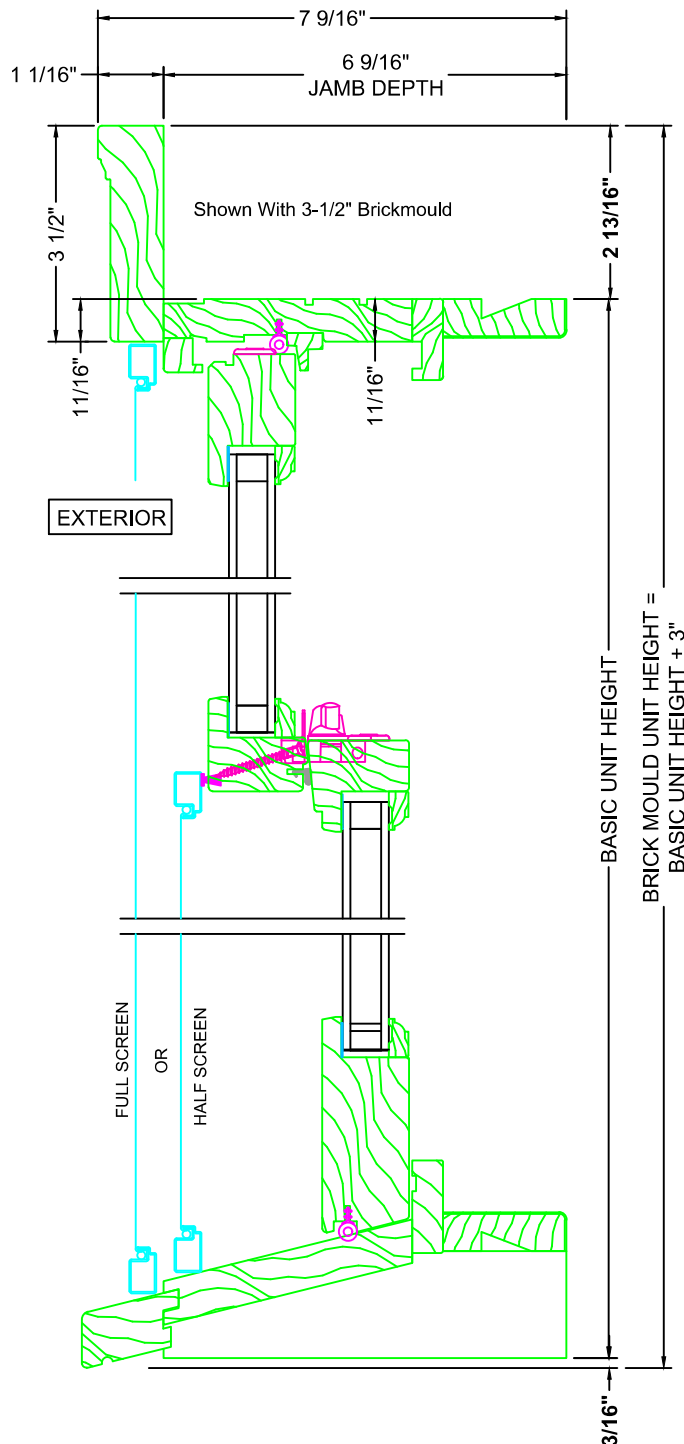

**2 1/2" Flat Casing**

Height = Basic Unit Height + 2"

Width = Basic Unit Width + 3.625"

**3 1/2" Flat Casing & 3 1/2" Brick Mould Width**

Height = Basic Unit Height + 3"

Width = Basic Unit Width + 5.625"

**5" Flat Casing**

Height = Basic Unit Height + 4.500"

Width = Basic Unit Width + 8.625"

For Heights the Sill nosing adds 3/16" to the overall Brick Mould / Flat Casing Height

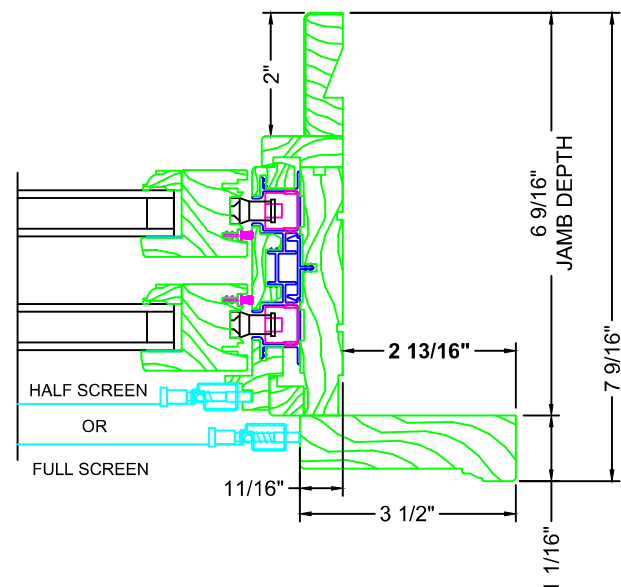





# All-Wood Tilt Double Hung Windows with Sill Nosing & No Brickmould

Head & Sill Details  
Page 1 of 8  
Drawn to Full Scale  
Printed Scale 4" = 1"

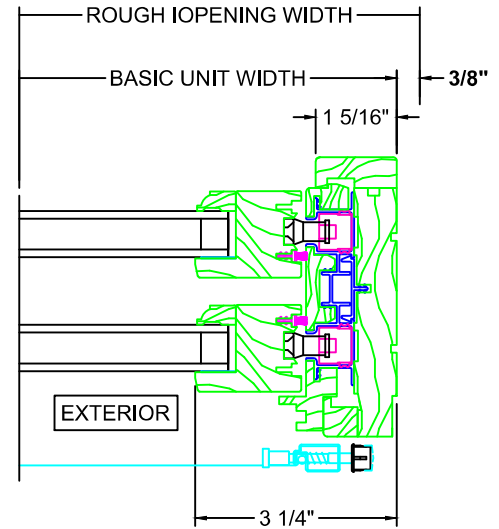
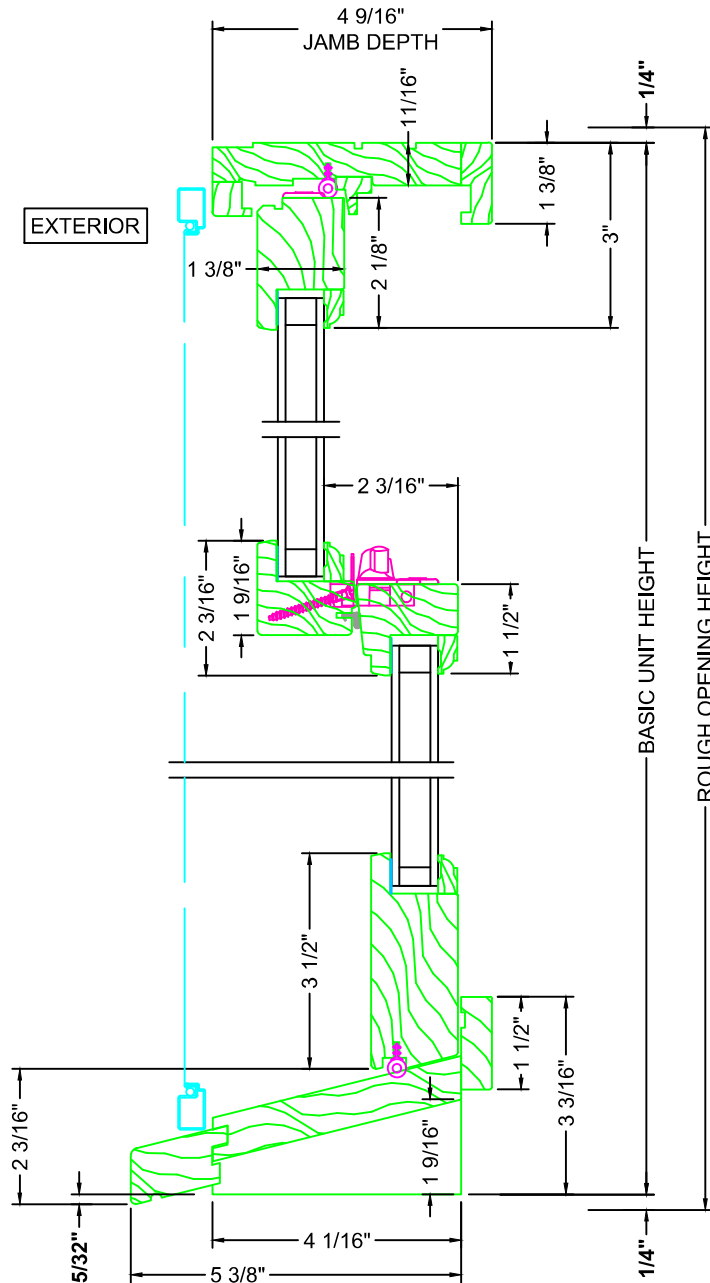

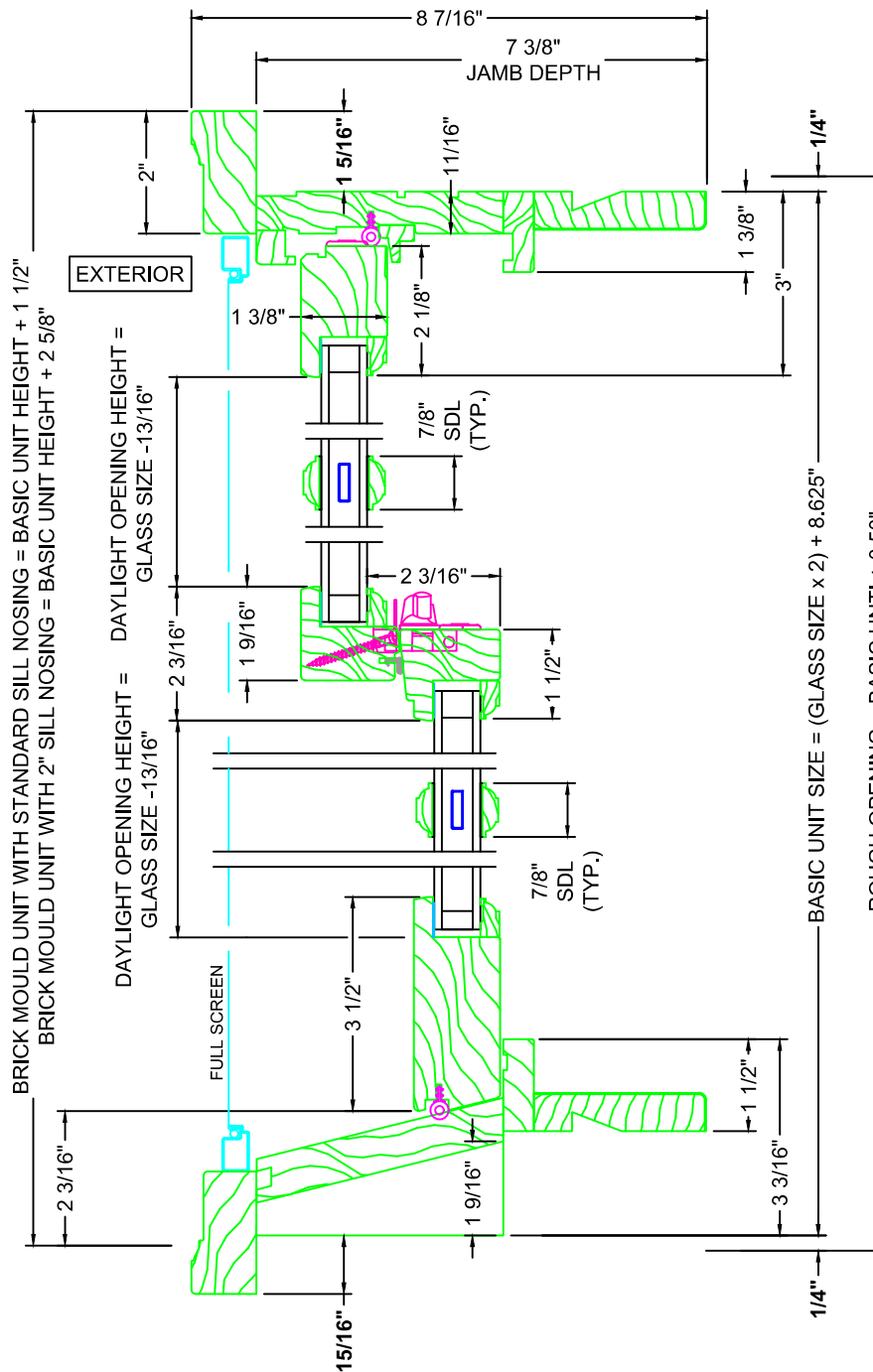
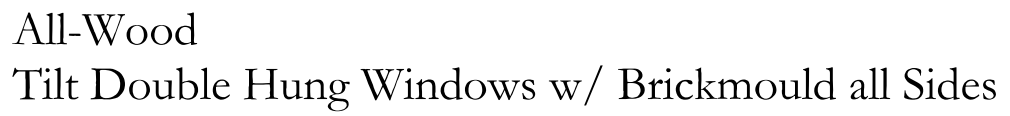





All-Wood

# Tilt Double Hung Windows w/ Brickmould all Sides

Jamb Details  
Drawn to Full Scale  
Printed Scale 4" = 1'

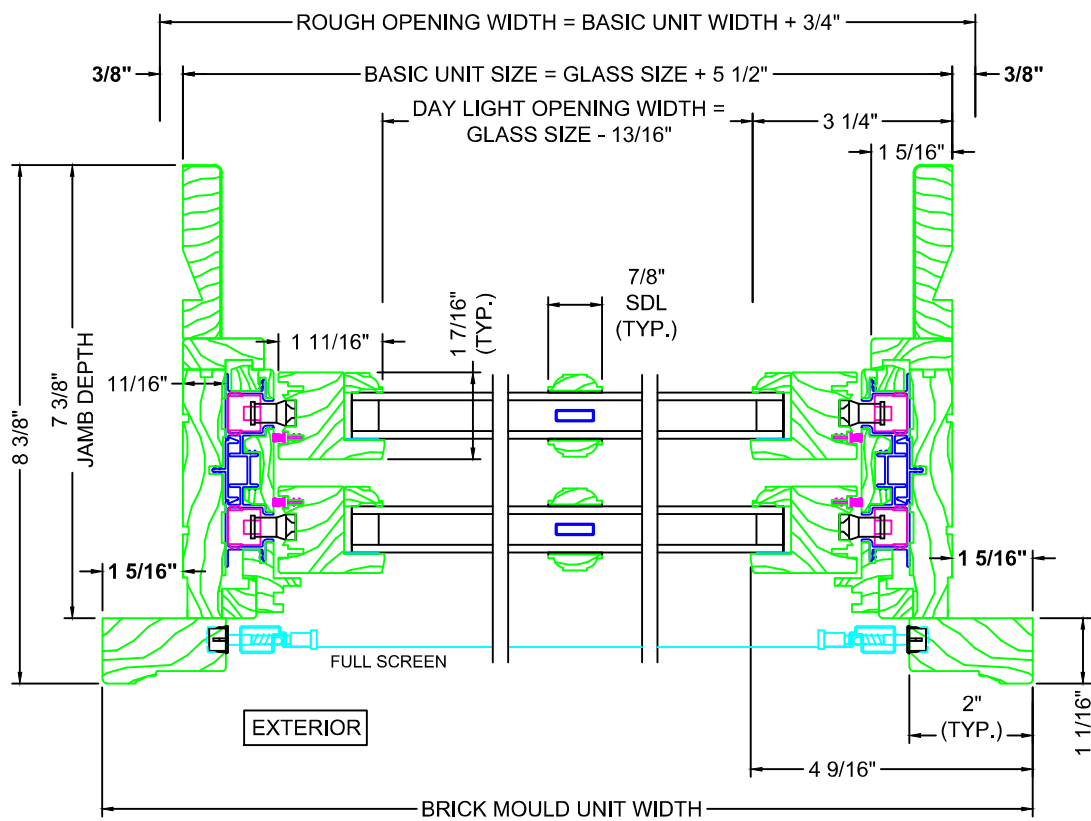



# All-Wood Tilt Double Hung Windows w/ NO Brickmould

Head & Sill Details  
Drawn to Full Scale  
Printed Scale 4" = 1'

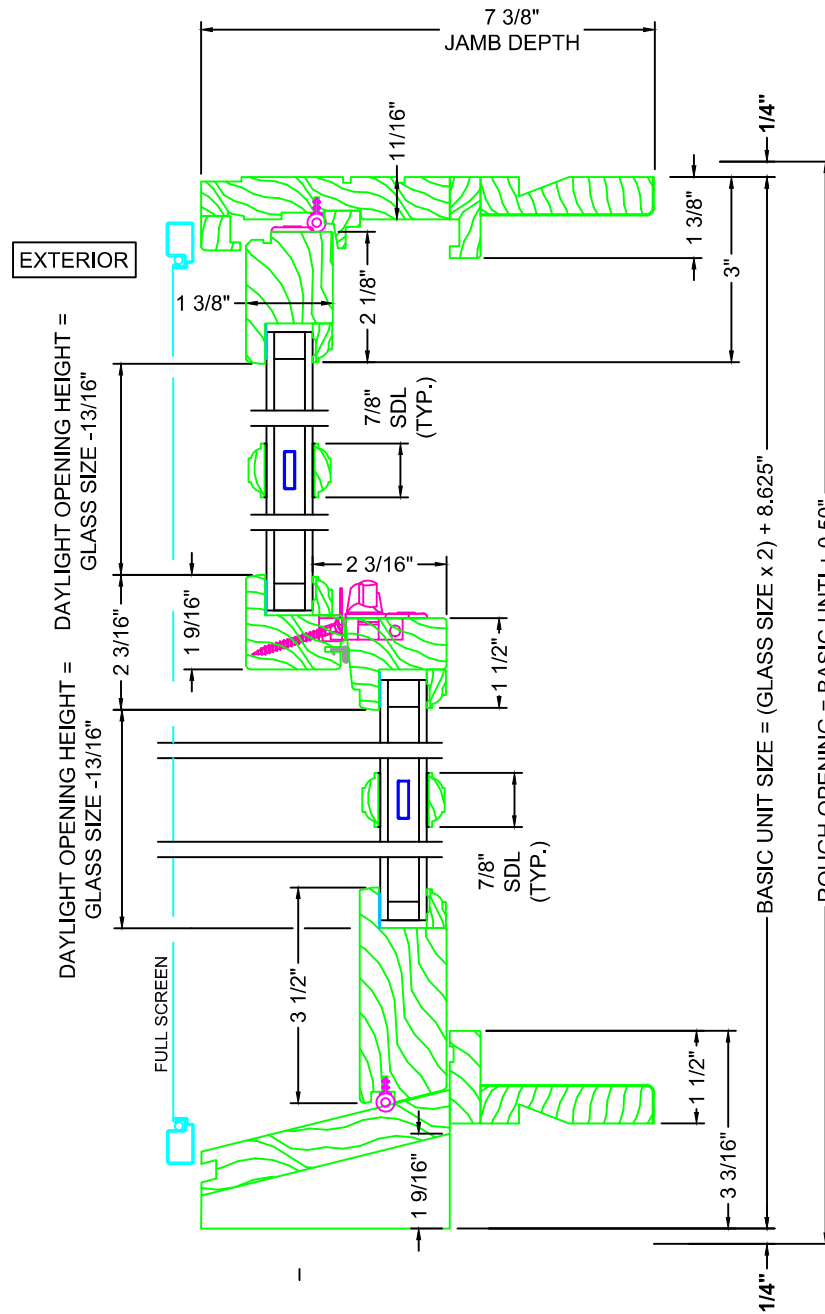





# All-Wood Tilt Double Hung Windows w/ NO Brickmould

Jamb Details  
Drawn to Full Scale  
Printed Scale 4" = 1'

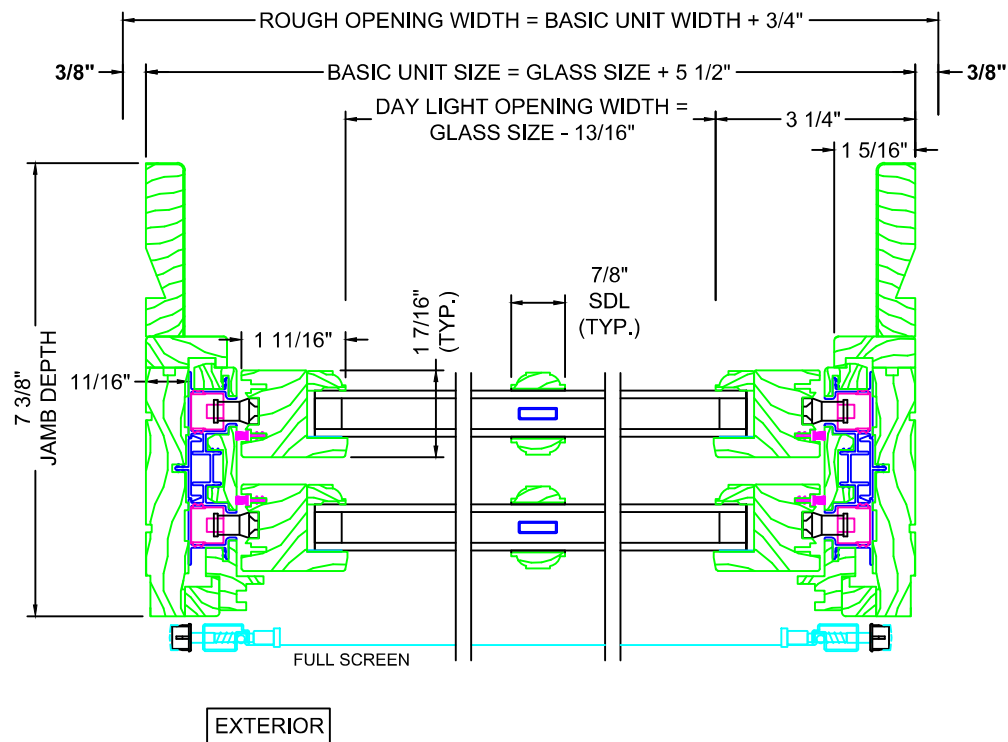

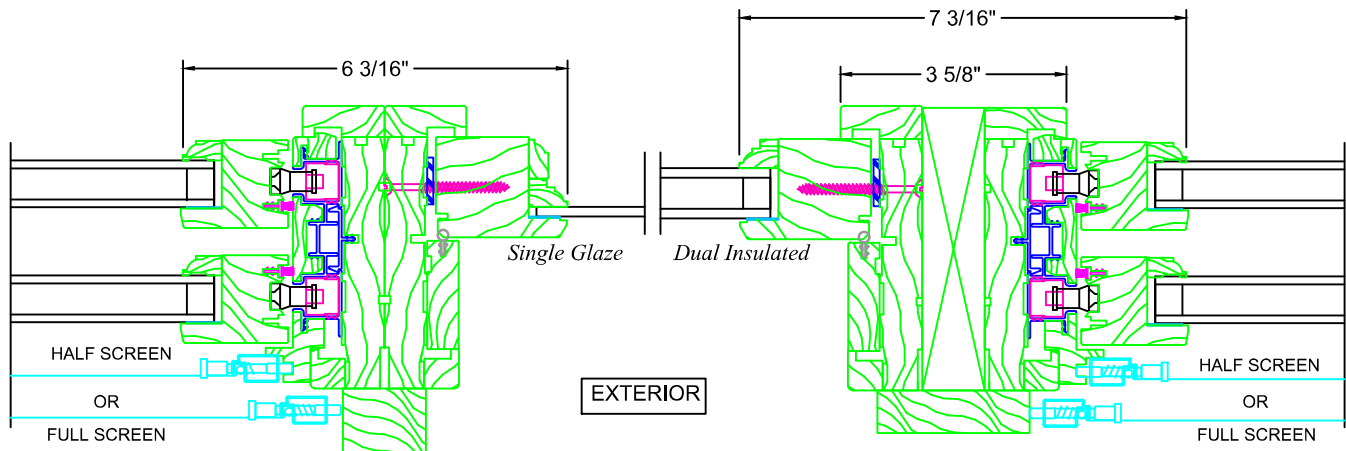

TIGHT MULL DETAIL

1" SPREAD MULL DETAIL

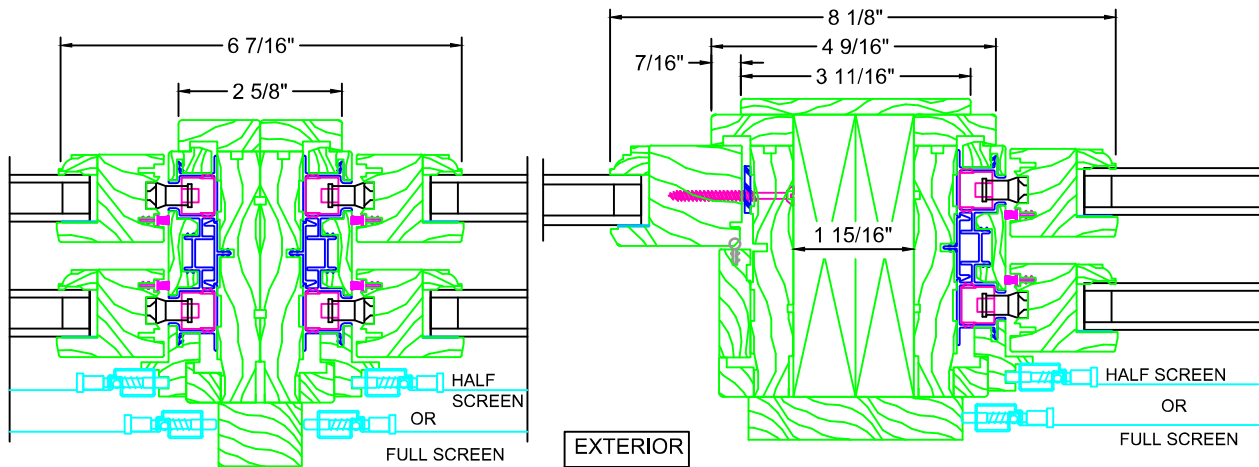

TIGHT MULL DETAIL

2" SPREAD MULL DETAIL

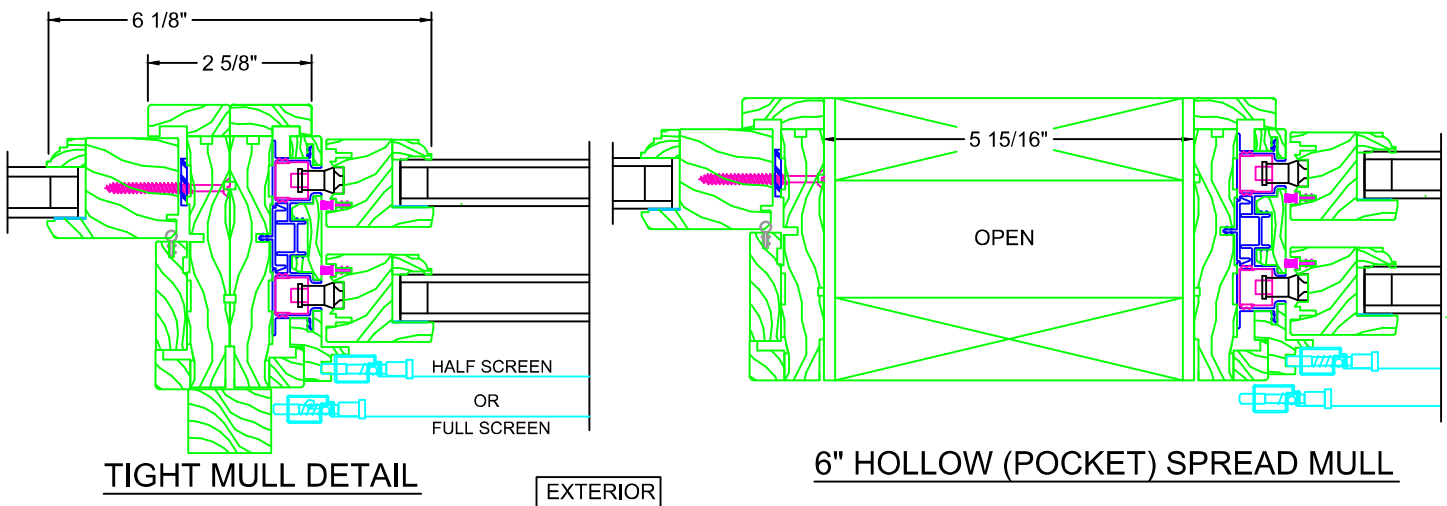

TIGHT MULL DETAIL

6" HOLLOW (POCKET) SPREAD MULL





# All-Wood Tilt Double Hung A-Bay Windows

Jamb Details  
Half & Full Screen Shown  
Page 4 of 8  
Angle Bay  
Drawn to Full Scale  
Printed Scale 4" = 1'

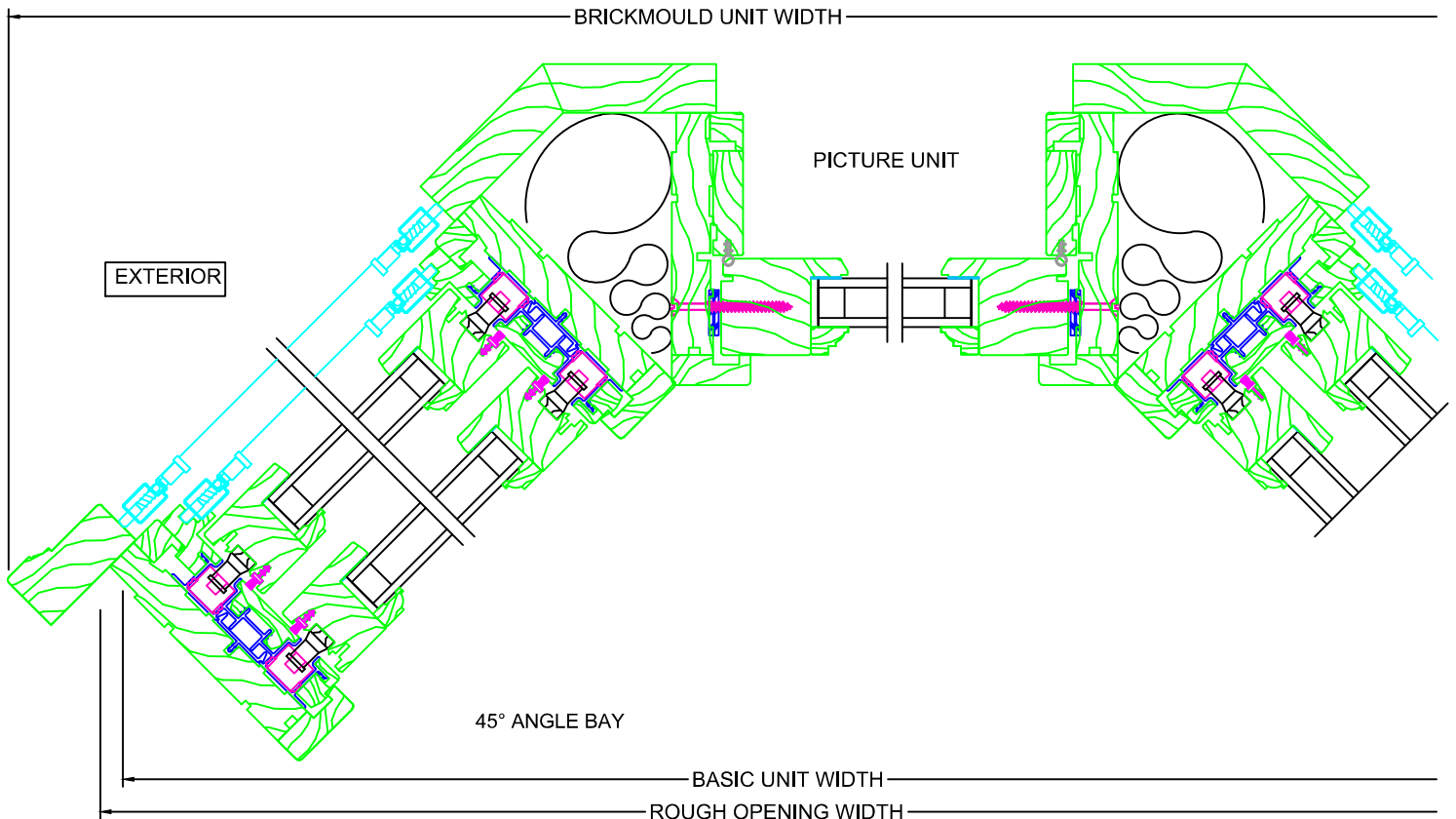
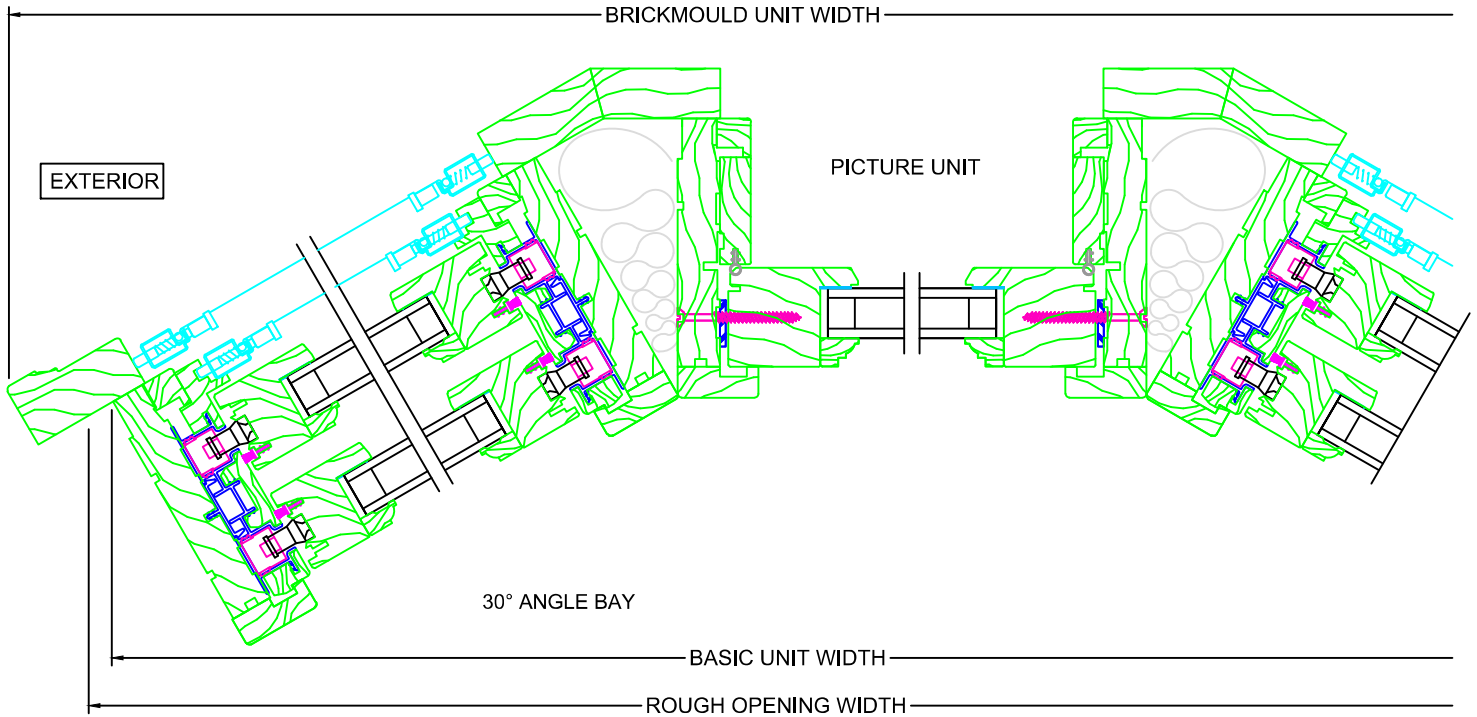

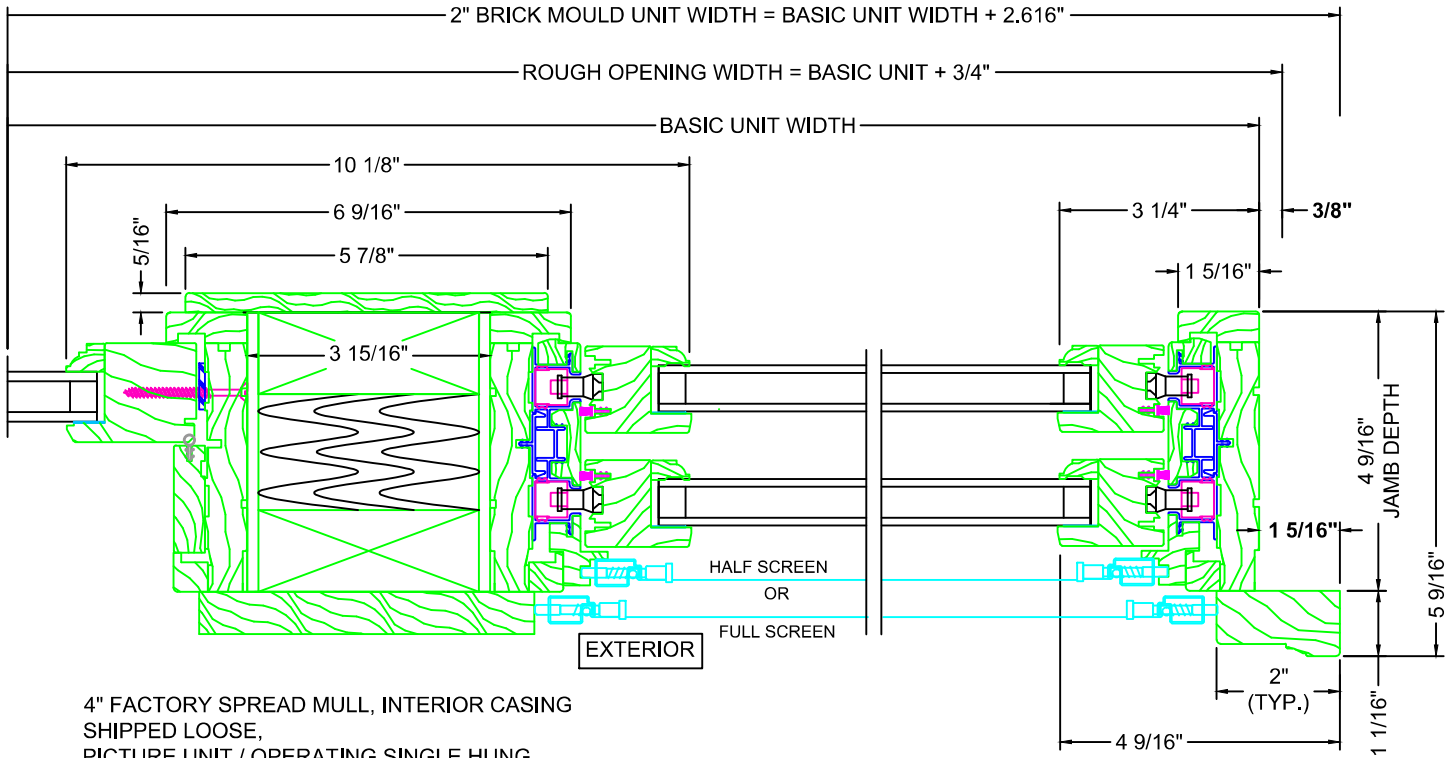

4" INSULATED BOX SPREAD MULL DETAIL

JAMB DETAIL

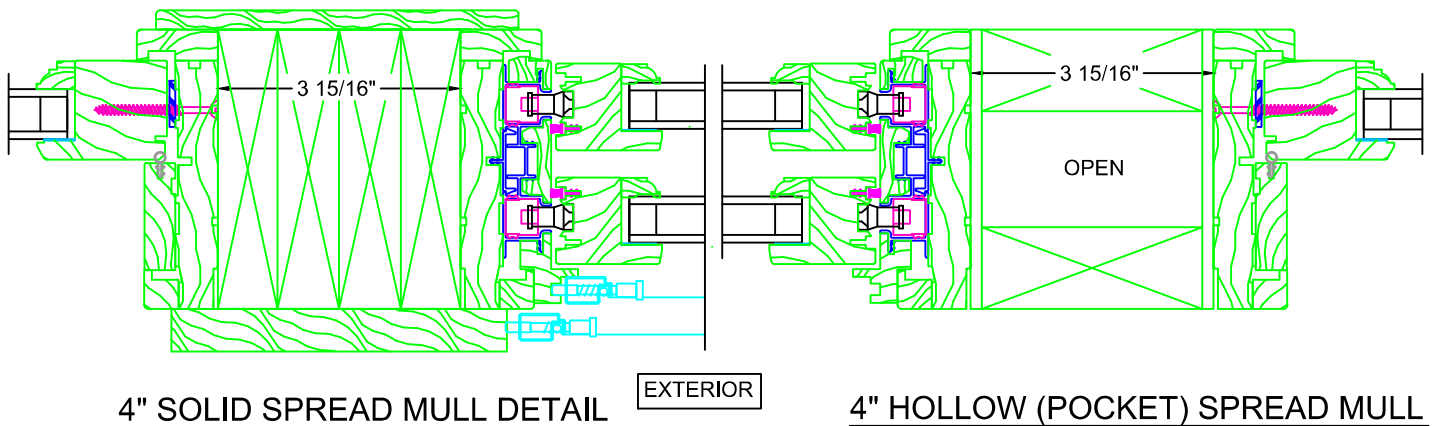

4" SOLID SPREAD MULL DETAIL

4" HOLLOW (POCKET) SPREAD MULL

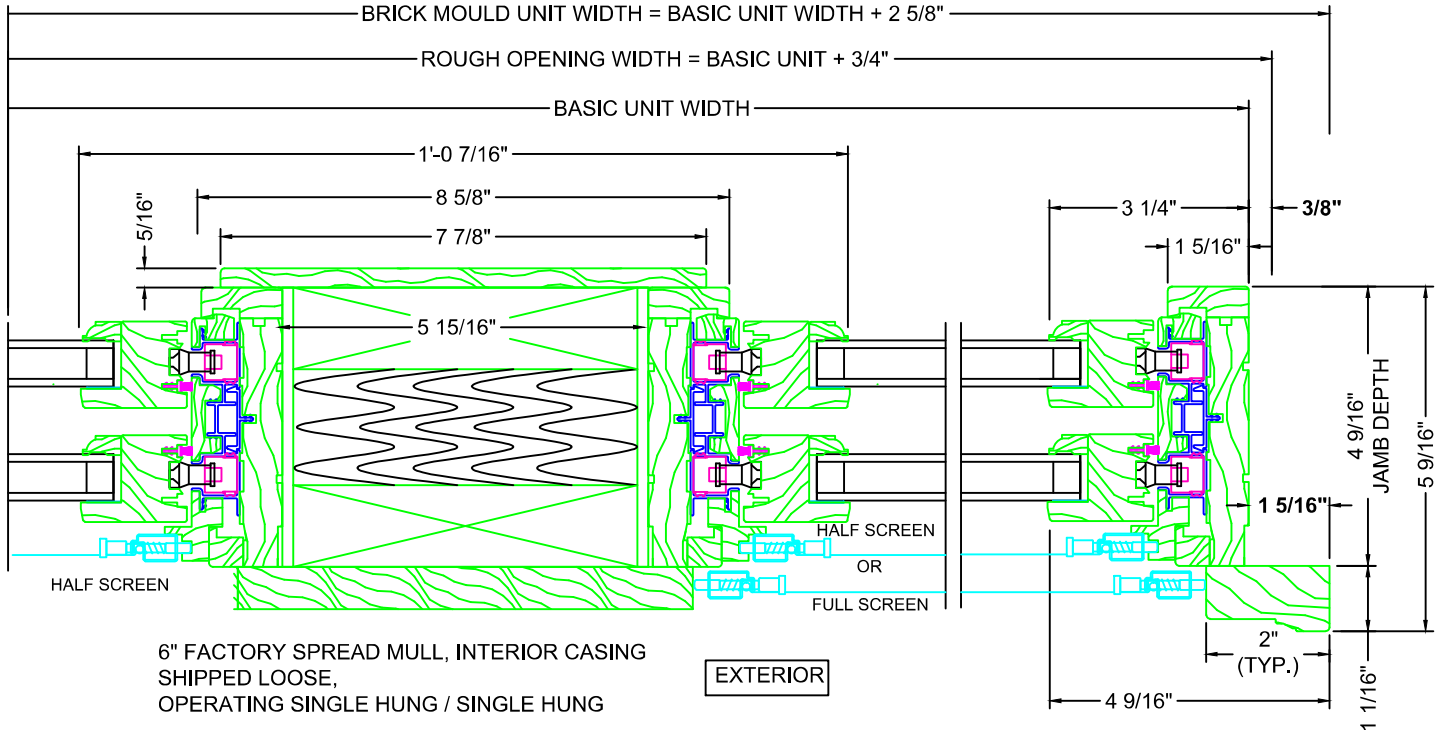

**6" INSULATED BOX SPREAD MULL DETAIL**

**JAMB DETAIL**

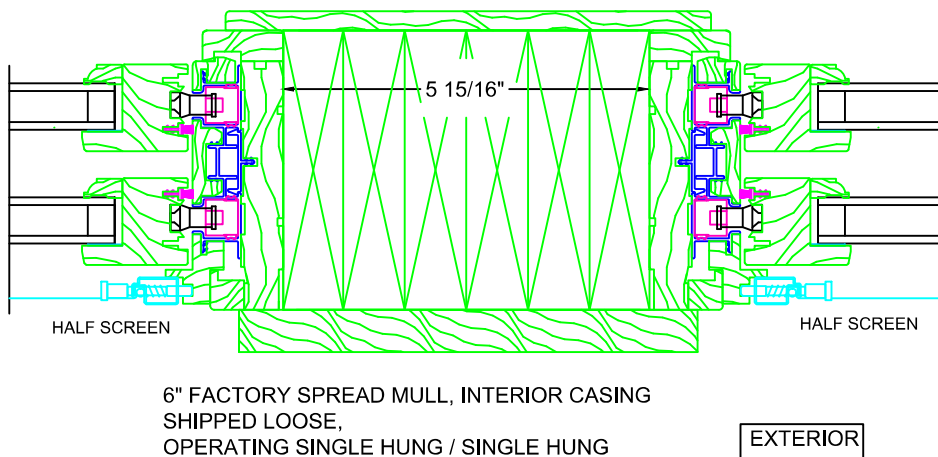

**6" SOLID SPREAD MULL DETAIL**

### MULL DEFINITIONS

- **INSULATED BOX MULLS** AVAILABLE FOR 4" & 6" MULLS ONLY  
THESE RUN FULL UNIT HEIGHT & ARE PERMANENTLY ATTACHED

- **SOLID MULLS** CONSIST OF SINGLE OR MULTIPLE PIECES OF FINGER JOINT WOOD PERMANENTLY ATTACHED TOGETHER AT THE SIZES SHOWN - THESE RUN FULL UNIT HEIGHT & ARE PERMANENTLY ATTACHED

- **HOLLOW MULLS** ARE CONSTRUCTED WITH 6" WOOD STRIPS, AS SHOWN, TEMPORARILY ATTACHED TO THE UNITS NEAR THE TOP & BOTTOM UP TO 60" UNIT HEIGHTS -
  - UNITS THAT EXCEED A 60" HEIGHT MAY HAVE 4 OR MORE WOOD PIECES APPLIED
  - THESE TEMPORARY PIECES ARE FOR FIELD REMOVAL PRIOR TO UNIT INSTALLATION





# All-Wood Tilt Double Hung Windows w/ NO Brickmould

Head & Sill Details  
Drawn to Full Scale  
Printed Scale 4" = 1'

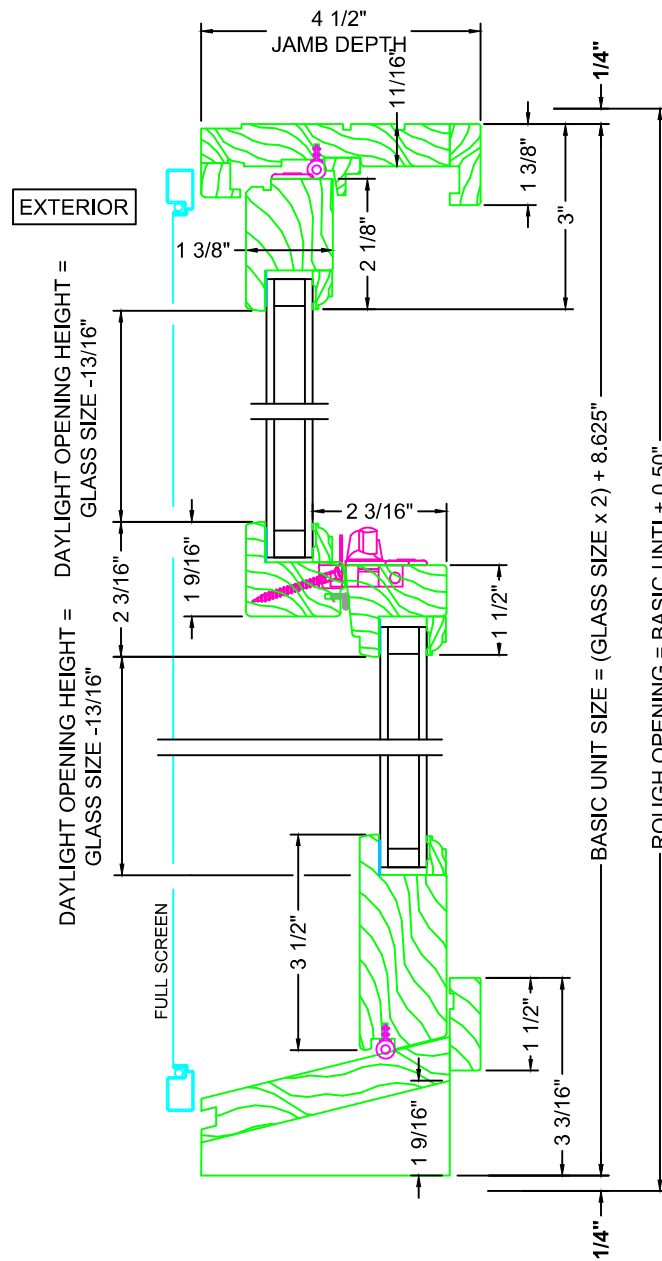



# All-Wood Tilt Double Hung Windows w/ NO Brickmould

Jamb Details  
Drawn to Full Scale  
Printed Scale 4" = 1'

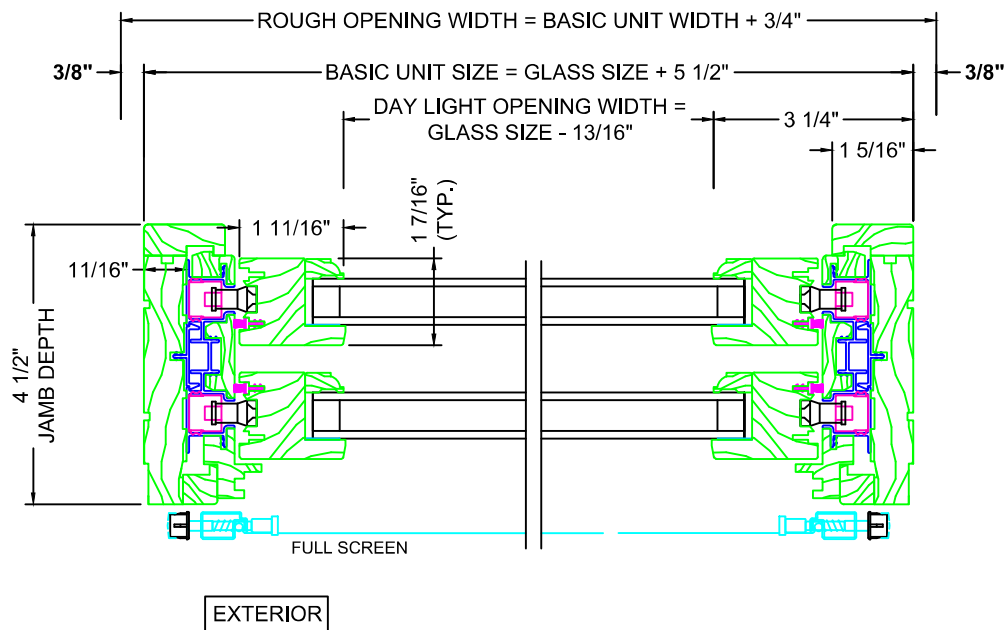



SIERRA  
PACIFIC  
WINDOWS

# All-Wood Casement Window

For Product Built 06/25/2012 to Present

SECTION DETAILS  
Drawn to 1" = 1" Scale  
Printed Scale 3" = 1"  
4 9/16" & 6 9/16" JAMB

PAGE 1 of 4

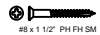

\*JAMB EXTENSION MAY BE APPLIED WITH STAINLESS STEEL 18 (1/4) x 1-1/4" STAPLE.

BRAD NAILS, 1" or 1 1/4" T-NAILS OR SCREWS (PRE-DRILL AND COUNTERSINKING REQUIRED WHEN USING SCREWS).

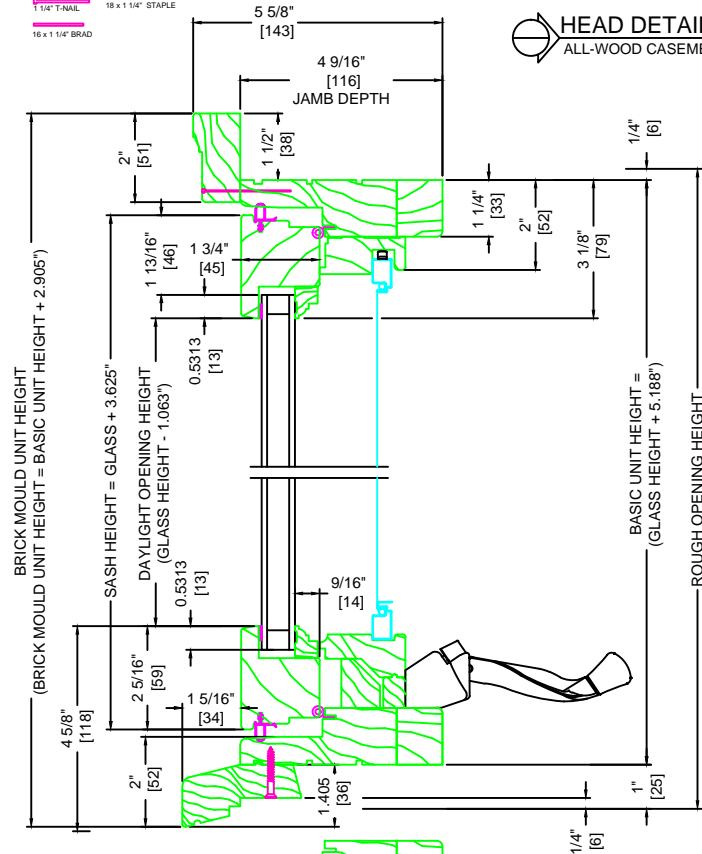

Glass Height + 3.625" = Sash Height  
Glass Width + 3.625" = Sash Width

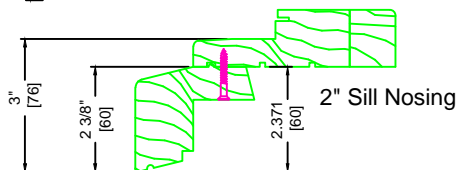
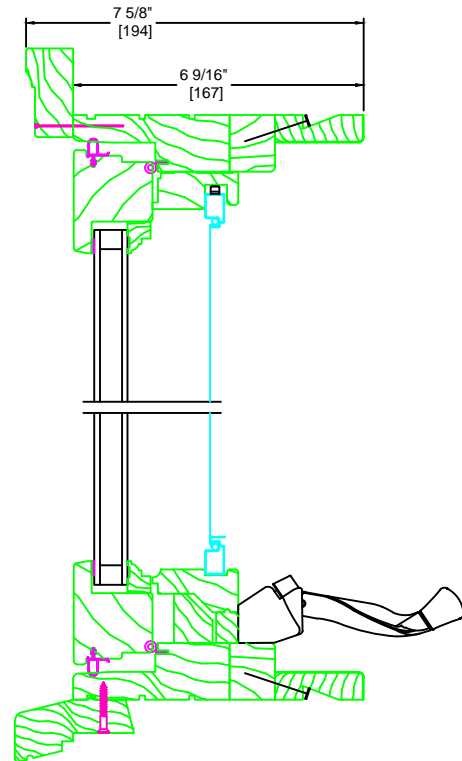

**SILL DETAIL**  
ALL-WOOD CASEMENT, OPERATING

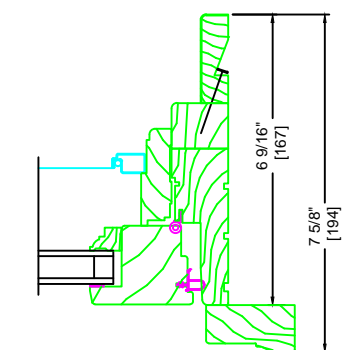
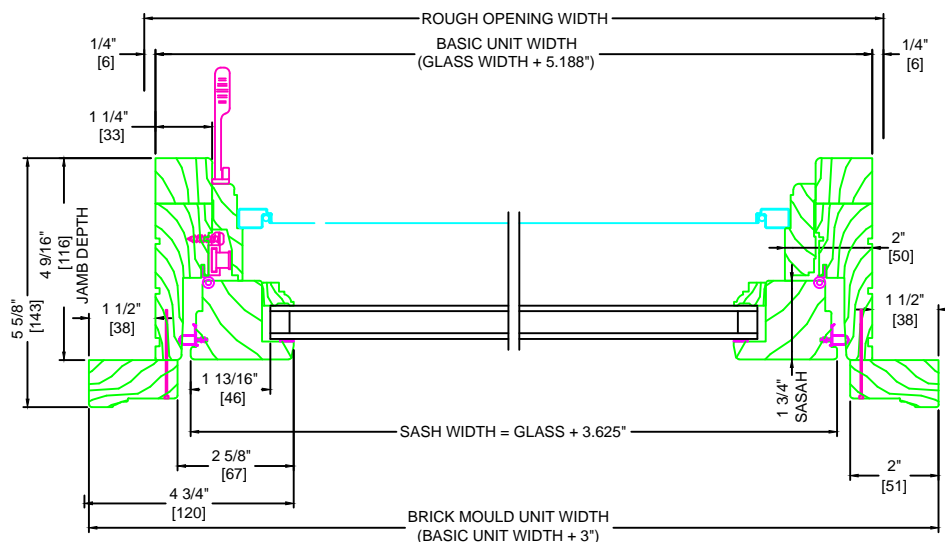

**JAMB DETAIL**  
ALL-WOOD CASEMENT, OPERATING





# All-Wood Casement Window

SECTION DETAILS  
DRAWN TO 1"=1" SCALE  
Printed Scale 3" = 1"

PAGE 2 of 4

## HEAD DETAIL ALL-WOOD CASEMENT, OPERATING

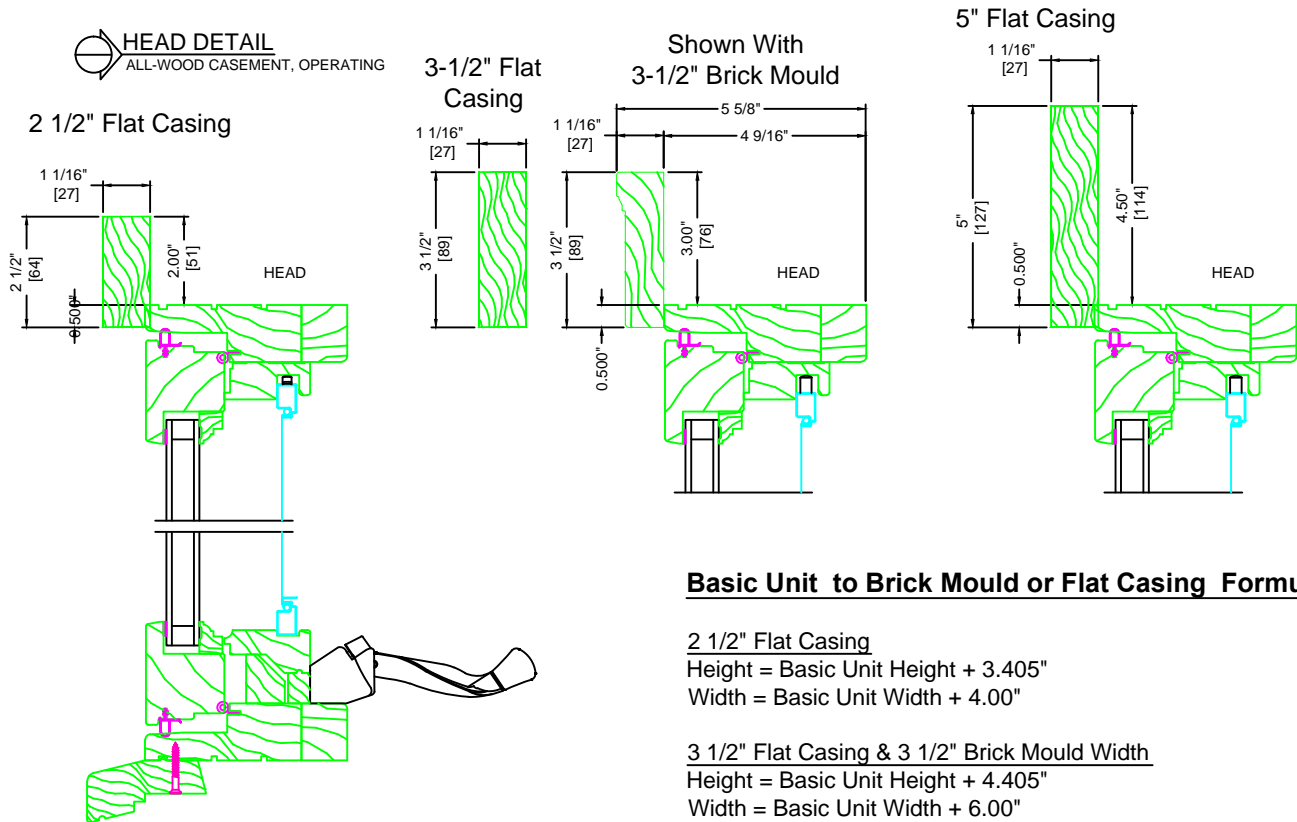

## Basic Unit to Brick Mould or Flat Casing Formulas

### 2 1/2" Flat Casing

Height = Basic Unit Height + 3.405"

Width = Basic Unit Width + 4.00"

### 3 1/2" Flat Casing & 3 1/2" Brick Mould Width

Height = Basic Unit Height + 4.405"

Width = Basic Unit Width + 6.00"

### 5" Flat Casing

Height = Basic Unit Height + 5.905"

Width = Basic Unit Width + 9.00"

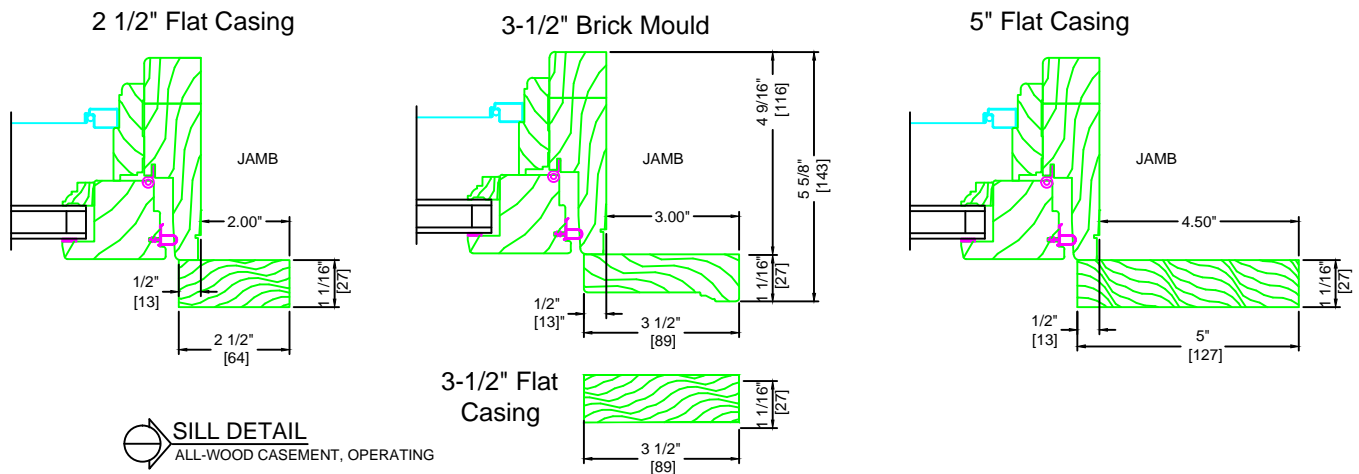

## SILL DETAIL ALL-WOOD CASEMENT, OPERATING

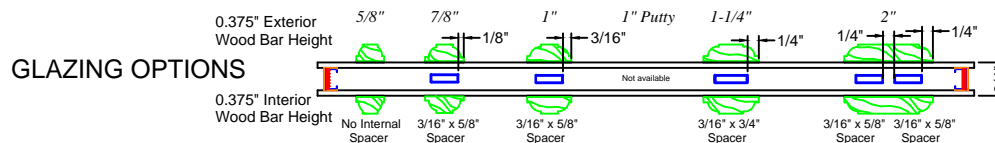

PLEASE NOTE: STANDARD SPACER COLOR IS MILL FINISH



# SIERRA All-Wood PACIFIC Casement Window WINDOWS

MULL DETAILS  
DRAWN TO 1"=1" SCALE  
Printed Scale 3" = 1'  
TYPICAL FACTORY MULL DETAILS

PAGE 3 of 4

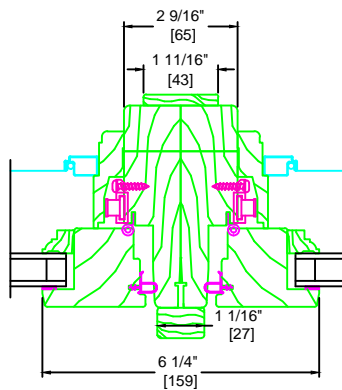

**DIRECT MULL**  
ALL-WOOD CASEMENT  
OPERATING / OPERATING

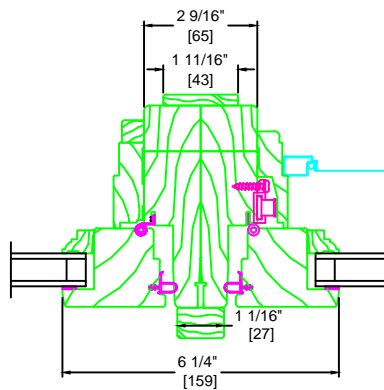

**DIRECT MULL**  
ALL-WOOD CASEMENT  
STATIONARY / OPERATING

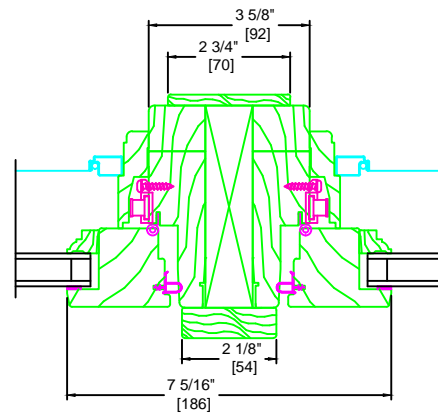

**1\"/>**

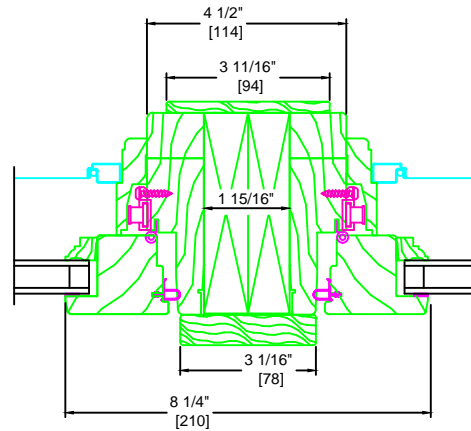

**2\"/>**

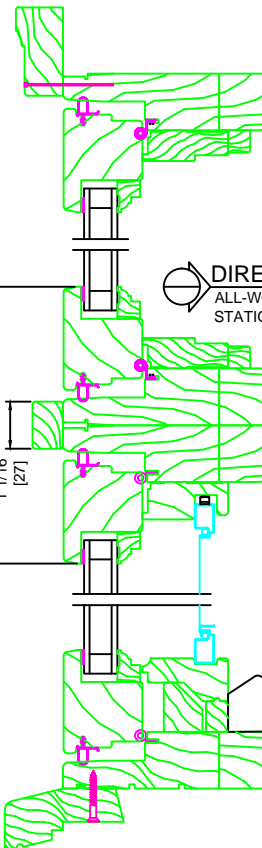

**DIRECT STACK**  
ALL-WOOD CASEMENT  
STATIONARY / OPERATING

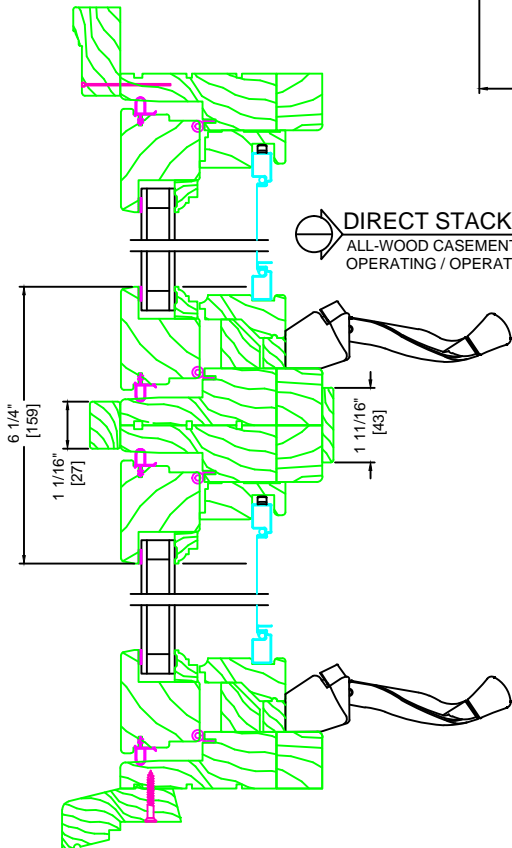

**DIRECT STACK**  
ALL-WOOD CASEMENT  
OPERATING / OPERATING



# SIERRA All-Wood Casement Window

PACIFIC WINDOWS

TYPICAL FACTORY MULL DETAILS

Printed Scale 3"=1'

PAGE 4 of 4

## MULL DEFINITIONS

### • INSULATED BOX MULLS

AVAILABLE FOR 4" & 6" MULLS  
ONLY THESE RUN FULL UNIT  
HEIGHT & ARE PERMANENTLY  
ATTACHED

### • SOLID MULLS

CONSIST OF SINGLE OR MULTIPLE  
PIECES OF FINGER JOINT WOOD  
PERMANENTLY ATTACHED  
TOGETHER AT THE SIZES SHOWN  
- THESE RUN FULL UNIT HEIGHT &  
ARE PERMANENTLY ATTACHED

### • HOLLOW / POCKET MULLS

ARE CONSTRUCTED WITH 6" WOOD STRIPS, AS SHOWN, TEMPORARILY  
ATTACHED TO THE UNITS NEAR THE TOP & BOTTOM UP TO 60" UNIT HEIGHTS  
- UNITS THAT EXCEED A 60" HEIGHT MAY HAVE 4 OR MORE WOOD PIECES  
APPLIED  
- THESE TEMPORARY PIECES ARE FOR FIELD REMOVAL PRIOR TO UNIT  
INSTALLATION  
- INSTALLATION IS FROM THE EXTERIOR OF THE STRUCTURE  
- AFTER TEMPORARY WOOD BRACING ARE REMOVED, EXTERIOR CASING WILL  
BE IN PLACE

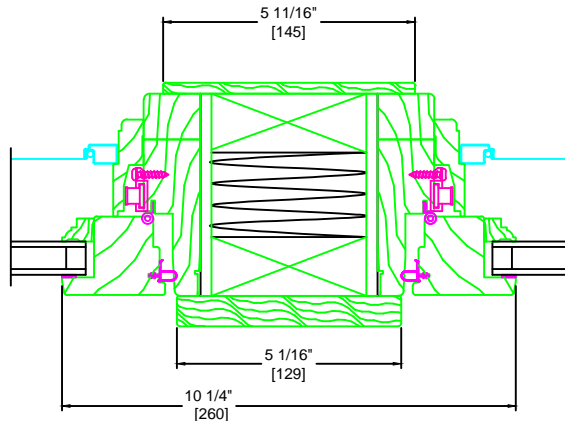

4" INSULATED BOX SPREAD MULL  
ALL-WOOD CASEMENT STATIONARY / STATIONARY

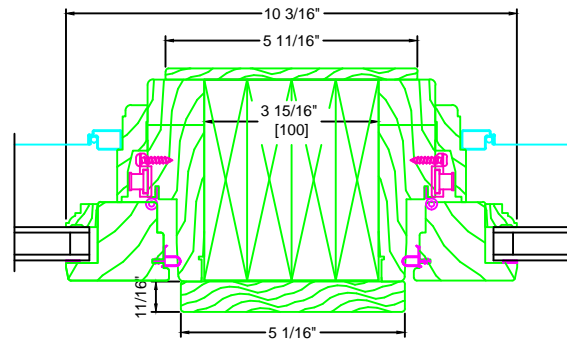

4" SOLID SPREAD MULL  
ALL-WOOD CASEMENT STATIONARY / STATIONARY

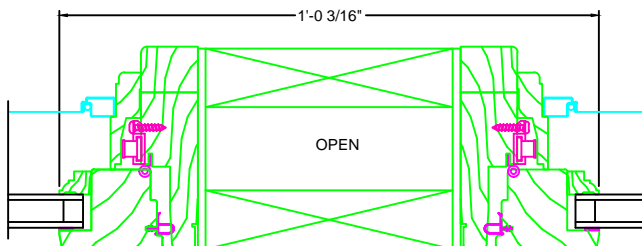

6" HOLLOW (POCKET) SPREAD MULL  
ALL-WOOD CASEMENT STATIONARY / OPERATING

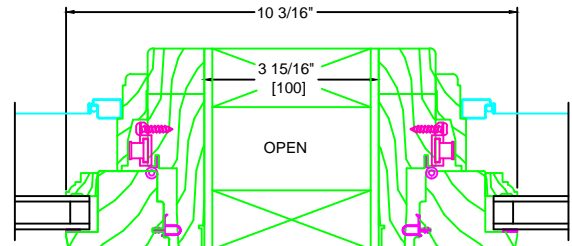

4" HOLLOW (POCKET) SPREAD MULL  
ALL-WOOD CASEMENT STATIONARY / OPERATING

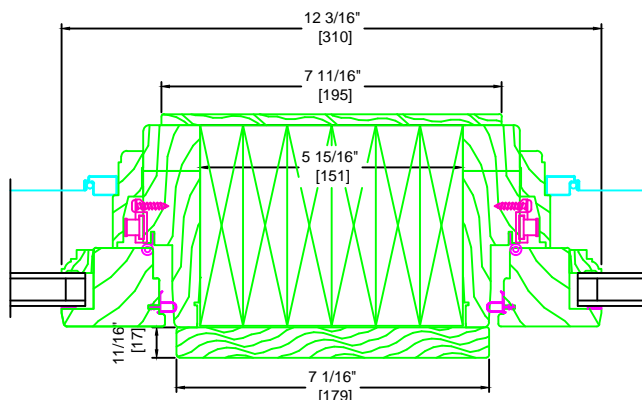

6" SOLID SPREAD MULL  
ALL-WOOD CASEMENT OPERATING / OPERATING

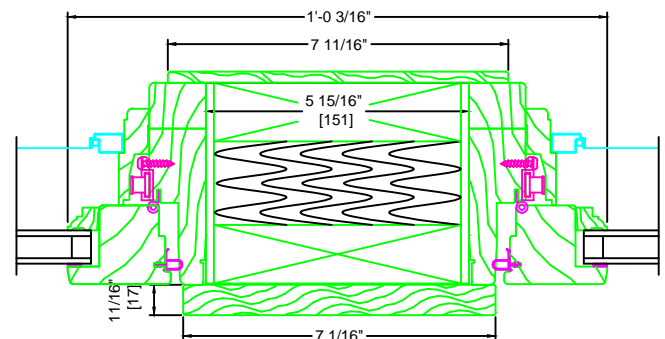

6" INSULATED BOX SPREAD MULL  
ALL-WOOD CASEMENT OPERATING / OPERATING





SIERRA  
PACIFIC  
WINDOWS

All-Wood

For Product Built 06/25/2012 to Present

Casement Window, No Brickmould w/ Sill Nosing

SECTION DETAILS  
Drawn to 1" = 1" Scale  
Printed Scale 3" = 1'  
4 9/16" JAMB

 **HEAD DETAIL**  
ALL-WOOD CASEMENT, OPERATING

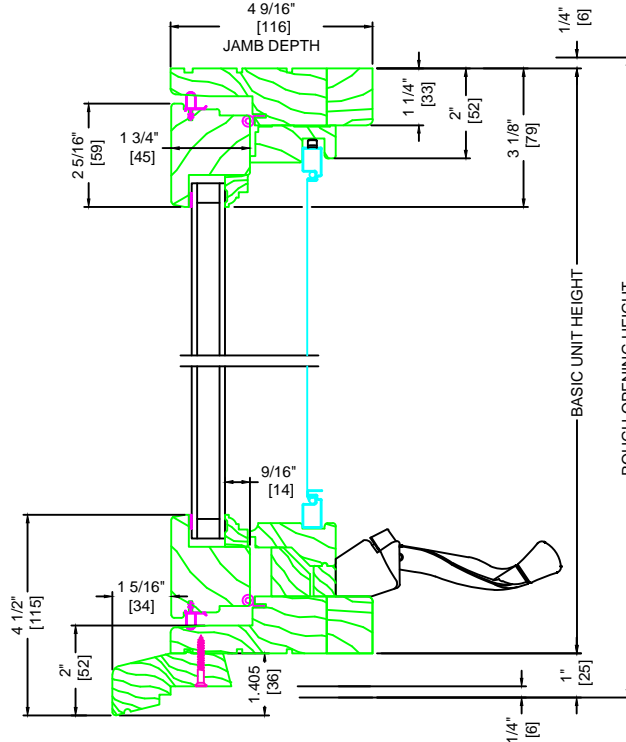

 **SILL DETAIL**  
ALL-WOOD CASEMENT, OPERATING

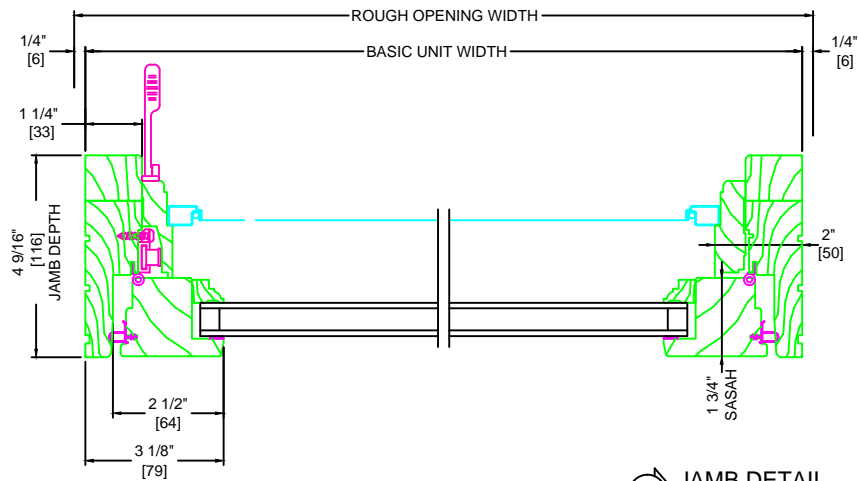

 **JAMB DETAIL**  
ALL-WOOD CASEMENT, OPERATING



SIERRA  
PACIFIC  
WINDOWS

All-Wood

For Product Built 06/25/2012 to Present

# Casement Window, No Brickmould

SECTION DETAILS  
Drawn to 1" = 1" Scale  
Printed Scale 3" = 1'  
4 9/16" JAMB

 **HEAD DETAIL**  
ALL-WOOD CASEMENT, OPERATING

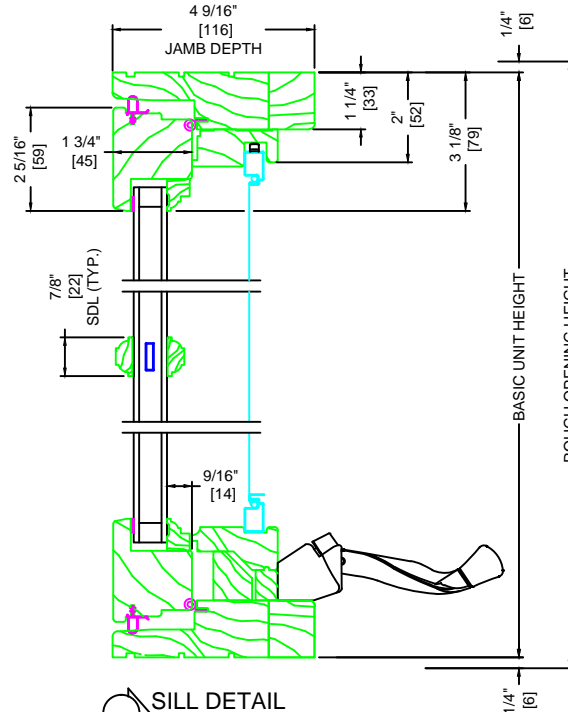

 **SILL DETAIL**  
ALL-WOOD CASEMENT, OPERATING

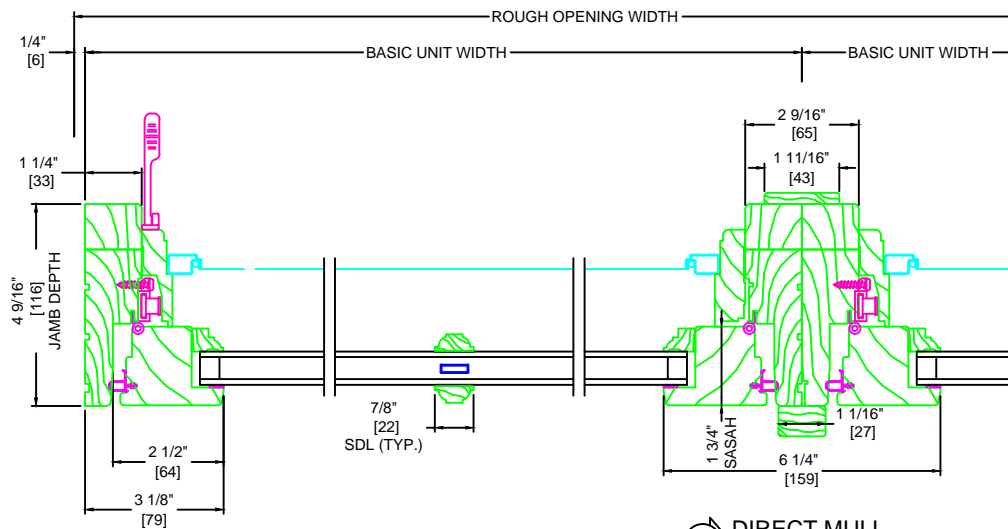

 **JAMB DETAIL**  
ALL-WOOD CASEMENT, OPERATING

 **DIRECT MULL**  
ALL-WOOD CASEMENT  
OPERATING/ OPERATING



SIERRA All-Wood  
PACIFIC Casement Window, No Brickmould, No Nosing  
WINDOWS

For Product Built 06/25/2012 to Present

SECTION DETAILS  
Drawn to 1" = 1" Scale  
Printed Scale 3" = 1"  
6 9/16" JAMB

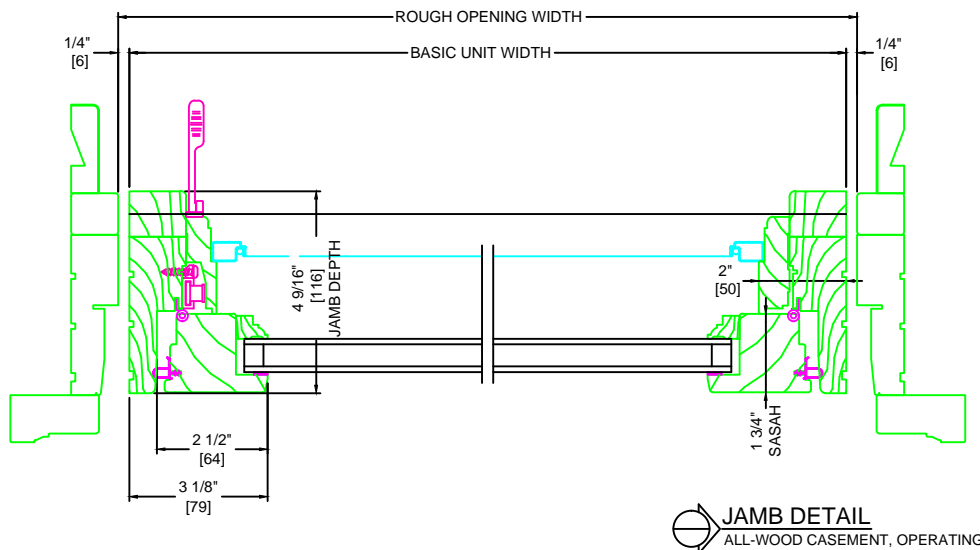
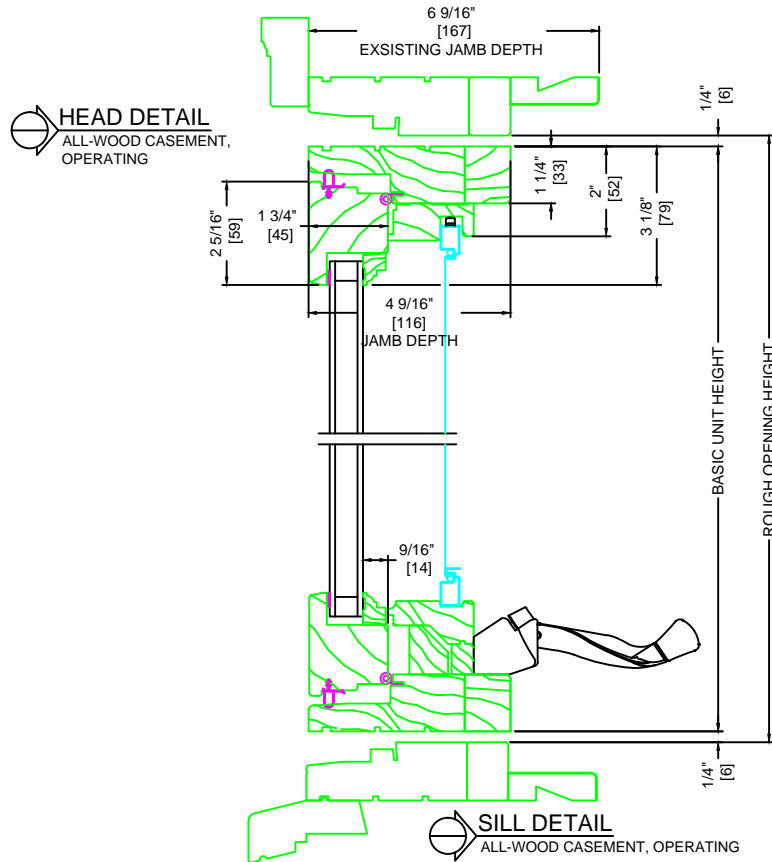



# SIERRA PACIFIC DOUBLE HUNG SASH KITS

## TRANSCEND

REPLACEMENT WINDOWS & PATIO DOORS



**SIERRA  
PACIFIC**  
WINDOWS THAT  
NEVER COMPROMISE



# REPLACE YOUR OLD DOUBLE HUNG WINDOWS WITH NEW ENERGY-EFFICIENT SIERRA PACIFIC WINDOWS WITHOUT REMOVING YOUR EXISTING WINDOW FRAME.



1. Unlike other sash kits, our balances are concealed. You'll appreciate the difference immediately.
2. Our sash kits are adjustable for far superior installation and smoother operation.
3. Our wood is protected to the very core with CoreGuard™ Plus. It's the best wood protection in the business, and only Sierra Pacific has it.
4. Our sash kits are protected on the outside by double-thick, heavy-duty, .055 extruded aluminum cladding.
5. Our optional integral screen channel is a first.

It's all accomplished from inside your home—without removing your existing frame, sill, interior or exterior trim.

As with every Sierra Pacific product, better engineering in our sash kit means noticeably better performance. Both sash tilt easily to make removal and cleaning a snap. Both sash operate smoothly and seal completely.

So you get all the benefits of today's newest window technology without the expense and mess of a big remodeling project.

## HERE'S WHY SIERRA PACIFIC SASH KITS ARE SUPERIOR TO OTHERS:

6. Matching full or half screens are available and automatically Pre-Sized to the Sash Kit.
7. Although you get everything you need (all parts, detailed installation and finishing instructions), we've simplified installation by using fewer parts and no clips.



If your existing double hung window frames are still in good condition, here's the smartest, least expensive, most convenient way to replace them. Sierra Pacific easy-tilt replacement sash kits are sized to fit your existing sash opening. They install very easily. It's all accomplished from inside your home—without removing your existing frame, sill, interior or exterior trim.

# AVAILABLE WITH THE FULL RANGE OF SIERRA PACIFIC OPTIONS.

## PICK YOUR FAVORITE COLOR.

### COLOR STAY™ COLLECTION

|                   |                   |                  |                       |                    |                       |                       |
|-------------------|-------------------|------------------|-----------------------|--------------------|-----------------------|-----------------------|
| White 001         | ✓ Linen 032       | French Linen 112 | Morning Dove Gray 113 | Colonial White 313 | Sandstone 003         | Beige 335             |
| Tan 043           | ✓ Gull Gray 007   | ✓ Seawolf 044    | Fashion Gray 111      | Slate Gray 045     | ✓ Battleship Gray 321 | TW Black 061          |
| ✓ Black Sable 060 | Slate Blue 008    | Light Blue 046   | ✓ Steel Blue 114      | Aqua Mist 115      | Hampton Blue 323      | Sage Green 005        |
| Teal 047          | Hemlock Green 048 | Patina Green 051 | Forest Green 049      | Evergreen 009      | Green 004             | ✓ Hartford Green 050  |
| Moss 031          | ✓ Greek Olive 081 | Terra Cotta 053  | ✓ Clay 026            | ICI Brown 056      | ✓ Colonial Red 054    | Harvest Cranberry 010 |
| Burgundy 055      | Deep Plum 116     | Deep Taupe 077   | ✓ Antique Bronze 057  | TW Brown 058       | ✓ Bahama Brown 309    | Regal Brown 059       |
| Brown 002         | ✓ Bronze 024      | ✓ Black 023      |                       |                    |                       |                       |

### TEXTURED COLLECTION

|                     |                   |                           |
|---------------------|-------------------|---------------------------|
| El Cajon Silver 068 | Sift Espresso 097 | Mocha 098                 |
| Cajun Spice 099     | Pesto 100         | Available AAMA 2604 only. |

### WEATHERED COLLECTION

|                           |                     |                          |
|---------------------------|---------------------|--------------------------|
| Weathered Café Royale 104 | Weathered Cocoa 105 | Weathered Brown 034      |
| Weathered Bronze 078      | Weathered Clay 075  | Weathered Red Pepper 108 |
| Weathered Rust 076        | Weathered Basil 107 |                          |

### INDUSTRIAL COLLECTION

|                              |                            |
|------------------------------|----------------------------|
| Medium Bronze Industrial 101 | Dark Bronze Industrial 102 |
|------------------------------|----------------------------|

### PEARL METALLIC COLLECTION

|                         |                       |                        |
|-------------------------|-----------------------|------------------------|
| El Cajon Silver 068     | Platinum 067          | Light Bronze Pearl 069 |
| Medium Bronze Pearl 070 | Dark Bronze Pearl 071 |                        |

### METALLIC COLLECTION

|                    |                        |                    |
|--------------------|------------------------|--------------------|
| Alpine Silver 062  | Metallic Champagne 063 | Bronze Classic 064 |
| Classic Copper 088 | Copper Penny 065       |                    |

### ANODIZED COLLECTION

|                         |                     |                  |
|-------------------------|---------------------|------------------|
| Clear Anodized 103/332  | Anodized 096/307    | Anodized 095/306 |
| Black Anodized 0117/353 | Copper Anodized 352 |                  |

✓ Colors available in vinyl  
Printing limits our ability to show colors precisely.  
See your local representative for actual cladding samples.



# PICK YOUR FAVORITE WOOD.



# PICK YOUR FAVORITE FINISH.



A Sierra Pacific replacement sash kit will warm your room with the natural beauty and insulation of wood.

In a perfect world, your windows would match your cabinets perfectly. So Sierra Pacific lets you specify the wood species for your sash kit. While our standard ponderosa pine is pure premium grade, you can also choose from eight other woods or any workable species.

## CHOOSE FROM 7 OF TODAY'S MOST POPULAR HARDWARE FINISHES.

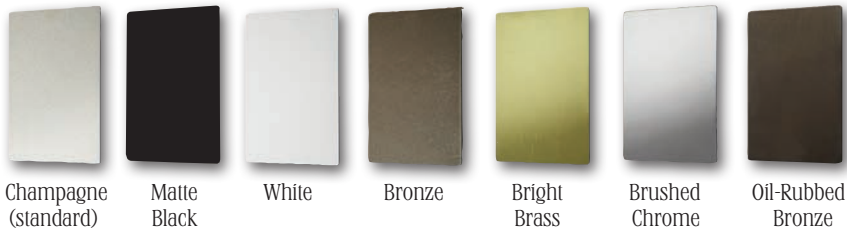

## A SPOTLESS FACTORY FINISH.

While an unfinished interior is our standard finish, or a Latex Factory Primer is available- both allowing you to apply your own final finish, nothing beats a factory finish performed with state-of-the-art equipment under rigorously controlled, ultra-clean conditions. Sierra Pacific gives you 2 premium options.

Our Ultra Stain brings out all the beauty of your wood interior.

Our Ultra Coat is a catalyzed polyurethane, interior paint that's so durable, it could be used outdoors.

Custom matched stains are also available.

# TURN BASIC INTO BOASTFUL.

Enhance your sash kit with the classic charm of our wood grilles or divided lites. Choose from our standard grille configurations, or design your own custom grille.

### Removable Wood Grille

Our full surround removable wood grille is a beautiful alternative to divided lites. The grille pops out easily for washing the window or if your tastes change.

### Simulated Divided Lites

Get the look of traditional true divided lites, but without the energy loss caused by individual glass panes. Extruded aluminum outside, natural wood inside, and aluminum spacers between the glass. Also available in an all-wood version.

### Grilles in Airspace

We seal the grille between the panes of glass. So you get the look you want without the grilles ever getting in your way. Available in solid or two-tone finishes. Choose from flat (5/8") or contour (11/16 or 1") profile.

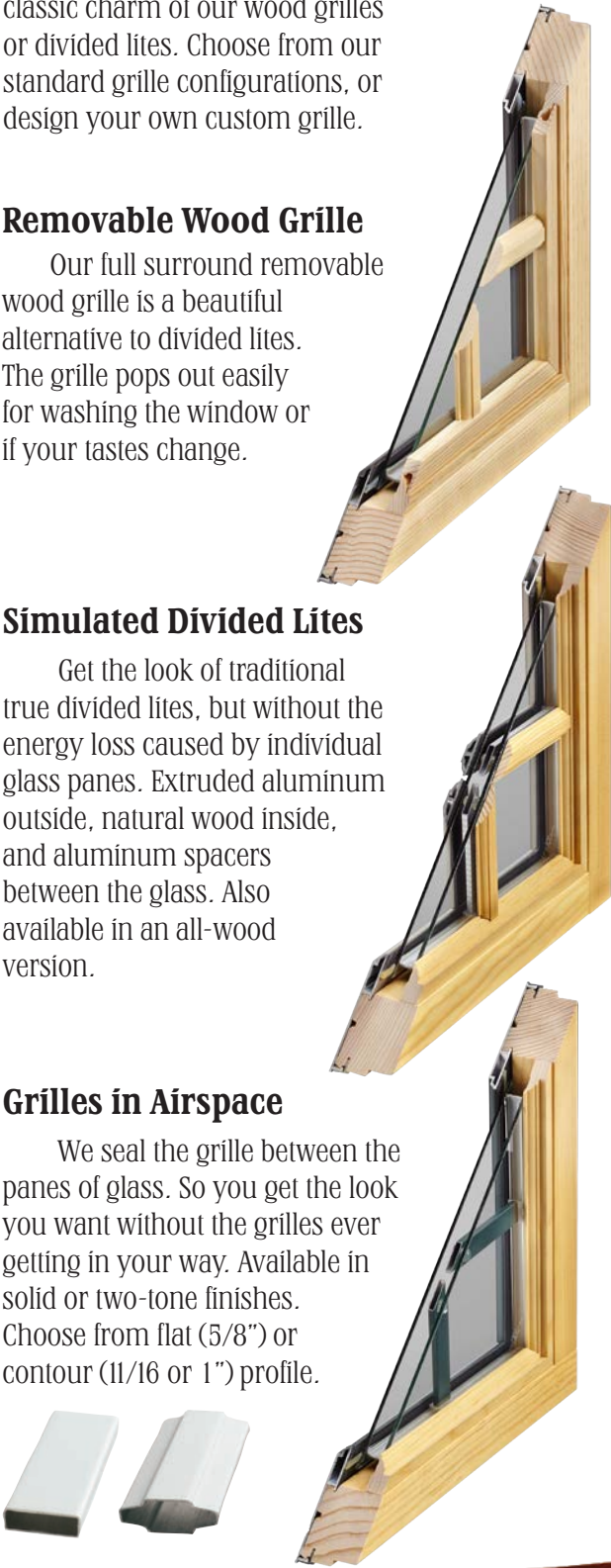

| Grille Profiles | Sierra Pacific Simulated Divided Lite | Wood Grille |
|-----------------|---------------------------------------|-------------|
| Putty 5/8"      |                                       |             |
| Putty 7/8"      |                                       |             |
| Putty 1"        |                                       |             |
| 5/8"            |                                       |             |
| 7/8"            |                                       |             |
| 1"              |                                       |             |
| 1-1/4"          |                                       |             |
| 2"              |                                       |             |



# HIGH PERFORMANCE GLAZING OPTIONS.

What's the best glazing for your replacement windows and patio doors?

Obviously, what's best for a freezing northern winter is not necessarily right for a hot southern summer.

We have the answer. With one of the broadest selections of glazing options in the window industry, Sierra Pacific lets you choose exactly the right performance glass for your exact weather and environmental conditions.

You can choose glazing to improve your energy efficiency and lower your energy bills. you can capture the sun's heat, or reflect it. You can also reduce outside noise, block the sun's damaging UV rays, or even enhance your privacy.

## Dual Pane Warm Edge Low-E



Insulated for improved energy efficiency. Single surface low-E coating to reduce solar heat gain and block UV rays.

## Low-E 366



Cardinal's triple layer silver product with Warm Edge Spacer, a high density foam, for superior performance. 95% UV protection. Solar heat gain coefficient of 0.27\*. Also available with Preserve® protective film or with Preserve and Neat® coating for a naturally cleaner glass.\* \*\*

## Low-E 366 with i89 Coating\*\*



The same superior performance as regular Low-E 366 (above), but with the addition of i89 coating on the interior surface to increase insulating value and reduce solar heat gain. Meets even the most extreme requirements in the majority of the Canadian Energy Star zones. Also available with Preserve protective film or with Preserve and Neat coating.\* \*\*

## Low-E 340



Cardinal's newest glazing innovation. It has an amazingly low 0.18\* solar heat gain coefficient to keep out the heat even in the blazing sun. Slightly tinted. Blocks 98% of UV rays. Less heat gain when it's hot, less heat loss when it's cold, and maximum glare control. Also available with Preserve protective film or with Preserve and Neat coating.\* \*\*

## Low-E 180 Passive Solar



A very high (0.70\*) coefficient for capturing solar heat gain. Ideal for reducing your heating bills in colder climates. Superior insulation value blocks cold and keeps in the heat. Also available with Preserve protective film or with Preserve and Neat coating.\* \*\*

## Low-E 180 Passive Solar with i89 Coating\*\*



The same superior performance as regular Low-E 180 (above), but with the addition of i89 coating on the interior surface to increase insulating value. Meets even the most extreme requirements in the majority of the Canadian Energy Star zones. Also available with Preserve protective film or with Preserve and Neat coating for a naturally cleaner glass.\* \*\*

## Insulated Glass



For moderate climates. Basic glazing with basic performance.

## Sound Control

Reduces outside noise by as much as 50% while blocking 99% of damaging UV rays. Laminated for shatter resistance. Available insulated or non-insulated.

## Additional Options: Obscure Glass

## Tempered Glass

## Tinted Glass

We offer 11 different decorative glass styles to help you create unique window designs, filter harsh sunlight or enhance privacy and security. From fancy to simple, formal to casual, each has its own personality and lends its own character to your décor. For the optimum in one-of-a-kind, custom designed windows, consider our leaded or stained glass. Your options are limitless. We'll work with you to handcraft anything your mind can imagine.

\*All values shown are center of glass. \*\*Interior surface coatings, also known as surface #4, are applied to the interior (room-side surface) of a dual pane IG unit, resulting in improved thermal performance and lower heating costs. Because the coating reflects heat back into the room, the room-side pane of glass will be slightly colder in winter, causing a higher potential for interior condensation. \*\*\*Available when selecting XL Edge Spacer.

# MEASURING & SIZING INFORMATION.

## How To Measure:

1. Measure the width of your existing sash opening from the inside of the wood on the left jamb to the inside of the wood on the right jamb in 3 different places: top, middle, bottom.



2. Measure the sash opening (pocket) height from the head jamb to where the exterior of the bottom sash sits on the sill when fully closed. Measure at the left side, middle, and right side.



## Tools Needed:

- Level
- Measuring tape
- Putty knife
- Utility knife
- Flathead screwdriver
- Phillips screwdriver
- Small finishing nails
- Roofing nails
- Hammer
- Miter gauge and protractor
- Saw
- Safety glasses
- Drill and drill bits

3. Measure your sill angle using a miter gauge and protractor, or use another angle measuring tool available at your hardware store. (The standard sill angle for Sierra Pacific sash kits is 14 degrees, but any angle between 5 and 14 degrees is available if specified.)



## Custom Sizes in 1/8" Increments Available

## Minimum Size:

16.5" x 30.5" sash opening

## Maximum Size:

Sash opening widths up to 44", heights up to 92.5"

Sash kits can adjust to fit an opening width by as much as 1/8" via jambliner compression and installation screw adjustment. The sash opening height cannot be adjusted from the actual opening height.

Step 1 Prepare the opening.



Step 2 Install new jamb and balances.



Step 3 Install new sash.



Step 4 Install new head weatherstripping.



Step 5 Enjoy your new window.







# SIERRA PACIFIC

WINDOWS THAT  
NEVER COMPROMISE

[www.SierraPacificWindows.com](http://www.SierraPacificWindows.com) | P.O. Box 8489, Red Bluff, CA 96080 | 800-824-7744 | A Division of



Sierra Pacific windows and doors are successful thanks to our unique patents. Visit [spi-ind.com/ip](http://spi-ind.com/ip) to learn more.

## Morton, Erin

---

**From:** Will Madison <madisonrenovationsnc@gmail.com>  
**Sent:** Thursday, May 28, 2020 12:38 PM  
**To:** Morton, Erin  
**Subject:** Circled Details.pdf  
**Attachments:** Circled Details.pdf

**CAUTION:** This email originated from outside of the organization. Do not click links or open attachments unless you verify that the attachment and content are safe. If you believe this email is suspicious, please click the 'Phish Alert' link in the banner to report this message.

Will;  
The circled casement details are for that one casement and all the DH details are for the rest of the windows.

Peter Farren

Sent from my iPhone



## Morton, Erin

---

**From:** Morton, Erin  
**Sent:** Wednesday, May 27, 2020 2:05 PM  
**To:** madisonrenovationsnc@gmail.com  
**Cc:** Tully, Tania; Kinane, Collette  
**Subject:** RE: COA-0076-2020 (609 E Lane St) Minor Work - Initial Staff Comments

Will,

Thank you for the photographs of all additional windows to be replaced, as well as the keyed floor plan. That is very useful for our file.

The last things we need are a marked-up version of the window sections you have provided, circling the specific options you plan to use. The selected sections need to be keyed to the relevant window numbers on the floor plan you have provided.

Please also clarify the proposed header, jamb, and sill profiles and dimensions for the new windows. Stephenson's quote shows 4 different sizes of double-hung units plus the small casement window. The "historic sillnose-flat casing" attachment you provided depicts one window unit and a front door which does not appear to be a part of this COA application. Will all new window units have flat wood casings in the dimensions shown on the double-hung window in this attachment?

Let us know if you have any questions about the requested information. We look forward to receiving the remaining items. Thank you!

Best,  
Erin

**Erin Morton**  
Preservation Planner II  
City of Raleigh  
Planning and Development Department

■ **Raleigh Urban Design Center**  
One Exchange Plaza, Suite 300 | Raleigh, NC 27601  
919-996-2632 | [raleighnc.gov](http://raleighnc.gov)

For Planning and Development COVID-19 updates, please [visit our information page](#).

---

**From:** madisonrenovationsnc@gmail.com <madisonrenovationsnc@gmail.com>  
**Sent:** Wednesday, May 20, 2020 3:39 PM  
**To:** Morton, Erin <Erin.Morton@raleighnc.gov>  
**Cc:** Tully, Tania <Tania.Tully@raleighnc.gov>; Kinane, Collette <Collette.Kinane@raleighnc.gov>  
**Subject:** RE: COA-0076-2020 (609 E Lane St) Minor Work - Initial Staff Comments

**CAUTION:** This email originated from outside of the organization. Do not click links or open attachments unless you verify that the attachment and content are safe. If you believe this email is suspicious, please click the 'Phish Alert' link in the banner to report this message.



Went out in rain and took these – hope they help. I marked up the sides with the plan to make more sense where things are going. We are not replacing the crawl space windows. And we are leaving the existing header, jamb and sills that are there, just matching the 2 new windows to that – think Peter included that in his Sierra Pacific drawings – but they will match existing exactly along with siding

Thanks

Will

---

**From:** Morton, Erin <[Erin.Morton@raleighnc.gov](mailto:Erin.Morton@raleighnc.gov)>  
**Sent:** Wednesday, May 20, 2020 2:06 PM  
**To:** [madisonrenovationsnc@gmail.com](mailto:madisonrenovationsnc@gmail.com)  
**Cc:** Tully, Tania <[Tania.Tully@raleighnc.gov](mailto:Tania.Tully@raleighnc.gov)>; Kinane, Collette <[Collette.Kinane@raleighnc.gov](mailto:Collette.Kinane@raleighnc.gov)>  
**Subject:** RE: COA-0076-2020 (609 E Lane St) Minor Work - Initial Staff Comments

Will,

Thank you for the quick response. We are still waiting on photos of the remaining windows to be replaced whenever you can provide them. Additionally, am I understanding that the two original wood windows currently located on the inside wall of the house are still proposed to be relocated to the exterior wall? I see in your note below that you plan to replace two of the old wood windows, but I thought there was a vinyl slider window in that location currently. Perhaps your previous minor work application is bleeding into my memory here.

The window section details from Sierra Pacific are very detailed – thank you for all the great information! I think my confusion stems from only seeing two elevation drawings for two window types – there are three proposed unit sizes, is that correct? Can you label which section details will be used for which new windows? Finally, are the proposed header, jamb, and sill profiles milled to match the two existing historic wood windows?

Thanks for helping to clear up our questions. We look forward to hearing from you.

Best,  
Erin

**Erin Morton**  
Preservation Planner II

■ **Raleigh Urban Design Center**  
One Exchange Plaza, Suite 300 | Raleigh, NC 27601  
919-996-2632 | [raleighnc.gov](http://raleighnc.gov)

For Planning and Development COVID-19 updates, please [visit our information page](#).

---

**From:** [madisonrenovationsnc@gmail.com](mailto:madisonrenovationsnc@gmail.com) <[madisonrenovationsnc@gmail.com](mailto:madisonrenovationsnc@gmail.com)>  
**Sent:** Tuesday, May 19, 2020 12:02 PM  
**To:** Morton, Erin <[Erin.Morton@raleighnc.gov](mailto:Erin.Morton@raleighnc.gov)>  
**Cc:** Tully, Tania <[Tania.Tully@raleighnc.gov](mailto:Tania.Tully@raleighnc.gov)>; Kinane, Collette <[Collette.Kinane@raleighnc.gov](mailto:Collette.Kinane@raleighnc.gov)>; 'Susan Parry' <[skparry49@gmail.com](mailto:skparry49@gmail.com)>  
**Subject:** RE: COA-0076-2020 (609 E Lane St) Minor Work - Initial Staff Comments

**CAUTION:** This email originated from outside of the organization. Do not click links or open attachments unless you verify that the attachment and content are safe. If you believe this email is suspicious, please click the 'Phish Alert' link in the banner to report this message.

Hey

Here is a plan of the original locations and where we were going to add the master bedroom full size unit. The new plan shows the location of the new casement in the master bath, and image 5644 shows the small unit we are replacing with a casement unit. Also attached is the front façade.

We are replacing 12 vinyl units, 2 of the old wood units, adding 1 casement window in the master bath and replacing the side porch door with a new matching double hung. I think Peter sent and I included the casement information but I have attached again in case.

Thanks again

Will

---

**From:** Morton, Erin <[Erin.Morton@raleighnc.gov](mailto:Erin.Morton@raleighnc.gov)>

**Sent:** Tuesday, May 19, 2020 11:53 AM

**To:** [madisonrenovationsnc@gmail.com](mailto:madisonrenovationsnc@gmail.com)

**Cc:** Tully, Tania <[Tania.Tully@raleighnc.gov](mailto:Tania.Tully@raleighnc.gov)>; Kinane, Collette <[Collette.Kinane@raleighnc.gov](mailto:Collette.Kinane@raleighnc.gov)>; 'Susan Parry' <[skparry49@gmail.com](mailto:skparry49@gmail.com)>

**Subject:** RE: COA-0076-2020 (609 E Lane St) Minor Work - Initial Staff Comments

You can email the materials to us. We will process the application as though we are not waiting on paint color information unless you indicate otherwise. Just let us know. Thanks!

Best,  
Erin

**Erin Morton**

Preservation Planner II

■ **Raleigh Urban Design Center**

One Exchange Plaza, Suite 300 | Raleigh, NC 27601  
919-996-2632 | [raleighnc.gov](http://raleighnc.gov)

For Planning and Development COVID-19 updates, please [visit our information page](#).

---

**From:** [madisonrenovationsnc@gmail.com](mailto:madisonrenovationsnc@gmail.com) <[madisonrenovationsnc@gmail.com](mailto:madisonrenovationsnc@gmail.com)>

**Sent:** Tuesday, May 19, 2020 11:41 AM

**To:** Morton, Erin <[Erin.Morton@raleighnc.gov](mailto:Erin.Morton@raleighnc.gov)>

**Cc:** Tully, Tania <[Tania.Tully@raleighnc.gov](mailto:Tania.Tully@raleighnc.gov)>; Kinane, Collette <[Collette.Kinane@raleighnc.gov](mailto:Collette.Kinane@raleighnc.gov)>; 'Susan Parry' <[skparry49@gmail.com](mailto:skparry49@gmail.com)>

**Subject:** RE: COA-0076-2020 (609 E Lane St) Minor Work - Initial Staff Comments

**CAUTION:** This email originated from outside of the organization. Do not click links or open attachments unless you verify that the attachment and content are safe. If you believe this email is suspicious, please click the 'Phish Alert' link in the banner to report this message.

Thanks Erin – all those pics are part of the previous permit, but can resend them today. Do I upload to site or just email back to you?

Will

---

**From:** Morton, Erin <[Erin.Morton@raleighnc.gov](mailto:Erin.Morton@raleighnc.gov)>  
**Sent:** Tuesday, May 19, 2020 11:26 AM  
**To:** Will Madison <[madisonrenovationsnc@gmail.com](mailto:madisonrenovationsnc@gmail.com)>  
**Cc:** Tully, Tania <[Tania.Tully@raleighnc.gov](mailto:Tania.Tully@raleighnc.gov)>; Kinane, Collette <[Collette.Kinane@raleighnc.gov](mailto:Collette.Kinane@raleighnc.gov)>; Susan Parry <[skparry49@gmail.com](mailto:skparry49@gmail.com)>  
**Subject:** COA-0076-2020 (609 E Lane St) Minor Work - Initial Staff Comments

Will,

Thank you for submitting a minor work application for 609 E Lane St. Upon initial review, it looks like all exterior changes you are proposing are approvable, including the conversion of the side porch door to new wood window. We do need some additional materials to make sure the application is complete and to issue the blue placard.

Please provide additional photographs, including a photo of the front elevation of the house and detailed photographs of all the existing vinyl windows. The existing floor plan you provided appears to still be noted to propose a new master bedroom window to match the existing larger window; please remove that note if it is no longer something the owners want to pursue. We would also appreciate it if you would mark up the existing floor plans identifying the locations of all existing vinyl windows, so that we understand the extent of the proposed replacement. From Stephenson's drawings, it appears that there are 6 window units in total, excluding the door location?

I see the elevation for the front door window replacement and various large window replacements, but do not see information for the smaller casement window replacement. Please provide a window section and elevation for the smaller window. Will the head/jamb/sill details be the same for that window as the larger ones?

On a related note, Susan Parry reached out to us to discuss a new minor work for getting paint color approval for the building. If you would like, you are able to amend the application document for this minor work and upload the paint color materials to the City portal under this minor work. Either way is fine with us, it just may save you all the additional application fee. I have CC'ed Susan on this email response.

We look forward to receiving the additional materials when you are ready. And congratulations to Susan on the new house!

Best,  
Erin

**Erin Morton**  
Preservation Planner II

■ **Raleigh Urban Design Center**  
One Exchange Plaza, Suite 300 | Raleigh, NC 27601  
919-996-2632 | [raleighnc.gov](http://raleighnc.gov)

For Planning and Development COVID-19 updates, please [visit our information page](#).

---

**From:** Will Madison <[madisonrenovationsnc@gmail.com](mailto:madisonrenovationsnc@gmail.com)>  
**Sent:** Monday, May 18, 2020 2:00 PM  
**To:** Morton, Erin <[Erin.Morton@raleighnc.gov](mailto:Erin.Morton@raleighnc.gov)>  
**Cc:** Tully, Tania <[Tania.Tully@raleighnc.gov](mailto:Tania.Tully@raleighnc.gov)>; Kinane, Collette <[Collette.Kinane@raleighnc.gov](mailto:Collette.Kinane@raleighnc.gov)>  
**Subject:** Re: 609 e lane submittal



**CAUTION:** This email originated from outside of the organization. Do not click links or open attachments unless you verify that the attachment and content are safe. If you believe this email is suspicious, please click the 'Phish Alert' link in the banner to report this message.



Sent from my iPhone

On May 18, 2020, at 1:24 PM, Morton, Erin <[Erin.Morton@raleighnc.gov](mailto:Erin.Morton@raleighnc.gov)> wrote:

Will,

Based on a quick look at the materials, this seems sufficient. You are correct that this will need to be a new minor work application. Please include additional photos and a marked up floor plan showing the proposed location of the additional small casement window in the master bedroom. If we have additional questions after the submittal, we will let you know. Thank you and have a great week!

Best,  
Erin

**Erin Morton**  
Preservation Planner II

■ **Raleigh Urban Design Center**  
One Exchange Plaza, Suite 300 | Raleigh, NC 27601  
919-996-2632 | [raleighnc.gov](http://raleighnc.gov)

For Planning and Development COVID-19 updates, please [visit our information page](#).

---

**From:** [madisonrenovationsnc@gmail.com](mailto:madisonrenovationsnc@gmail.com) <[madisonrenovationsnc@gmail.com](mailto:madisonrenovationsnc@gmail.com)>

**Sent:** Monday, May 18, 2020 12:30 PM

**To:** Morton, Erin <[Erin.Morton@raleighnc.gov](mailto:Erin.Morton@raleighnc.gov)>

**Subject:** 609 e lane submittal

**CAUTION:** This email originated from outside of the organization. Do not click links or open attachments unless you verify that the attachment and content are safe. If you believe this email is suspicious, please click the 'Phish Alert' link in the banner to report this message.

Hey

I figured I would need to do a resubmittal for this and I am trying to get these ordered for them. The original case number is COA-017-2020 for replacing the sliders for 2 original windows and replacing the left side window in the master bath with a larger one. We will have replaced the slider with the 2 original units, but we have not used the larger unit for the master. Plan changed.

They now want to replace all the vinyl units with wood sash kits from Sierra Pacific (see attached information). They also want to replace the existing side door with a matching double hung unit, and instead of adding a larger unit in the master, they want to add a smaller unit (casement) in there which faces the side of the house (where they had the smaller unit originally).

Let me know what else I need to do to get this going.

Thanks

Will