



# CERTIFICATE OF APPROPRIATENESS PLACARD

for Raleigh Historic Resources

**Project Description:**

Alter front walkway

\*Beyond this expiration date, NC Session Law 2021-03 grants an extension to all valid development permits until 150-days after NC Executive Order 116 is rescinded.

220 Hillsborough St

Address

Capitol Square

Historic District

Andrew Goodwin House

Historic Property

COA-0140-2021

Certificate Number

9/3/2021

Date of Issue

3/3/2022\*

Expiration Date

*This card must be kept posted in a location within public view until all phases of the described project are complete. The work must conform with the code of the City of Raleigh and laws of the state of North Carolina. When your project is complete, you are required to ask for a final zoning inspection in a historic district area. Telephone the RHDC office at 832-7238 and commission staff will coordinate the inspection with the inspections Department. If you do not call for this final inspection, your Certificate of Appropriateness is null and void.*

Signature, \_\_\_\_\_

*Erin Morton*

Raleigh Historic Development Commission

*Pending the resolution of appeals, commencement of work is at your own risk.*



Type or print the following:		
Applicant name: NC Democratic Party, Meredith Cuomo		
Mailing address: PO Box 1926		
City: Raleigh	State: NC	Zip code: 27602
Date: 08/10/2021	Daytime phone #: 919-821-2777	
Email address: meredithcuomo@ncdemocraticparty.org		
Applicant signature:		
Minor work (staff review) – one copy Major work (COA committee review) – ten copies Additions > 25% of building sq. footage New buildings Demolition of building or structure All other Post approval re-review of conditions of approval	<b>Office Use Only</b> Transaction #: _____ File #: COA-0140-2021 Fee: _____ Amount paid: _____ Received date: _____ Received by: _____	
Property street address: 220 Hillsborough St, Raleigh, NC 27603		
Historic district:		
Historic property/Landmark name (if applicable): The Andrew Goodwin House		
Owner name: NC Democratic Executive Committee		
Owner mailing address: PO Box 1926, Raleigh, NC 27602		

**For applications that require review by the COA Committee (major work), provide addressed and stamped envelopes for owners for all properties with 100 feet on all sides of the property, as well as the property owner.**

Property Owner Name & Address	Property Owner Name & Address

I understand that all major work applications that require review by the Raleigh Historic Development Commission's COA Committee must be submitted by 4 p.m. on the date of the application deadline; otherwise, consideration will be delayed until the following committee meeting. An incomplete application will not be accepted.

Will you be applying for rehabilitation tax credits for this project? Yes <input type="radio"/> No <input checked="" type="radio"/>	Office Use Only Type of work: <u>82</u>
Did you consult with staff prior to filing the application? Yes <input checked="" type="radio"/> No <input type="radio"/>	

Design Guidelines: please cite the applicable sections of the design guidelines ( <a href="http://www.rhdc.org">www.rhdc.org</a> ).		
Section/Page	Topic	Brief description of work (attach additional sheets as needed).
1.3.4	Site Features and P	Landscaping maintenance, protection, and brick pathways (see attached

Minor Work Approval (office use only)	
Upon being signed and dated below by the Planning Director or designee, this application becomes the Minor Work Certificate of Appropriateness. It is valid until <u>03/03/2022</u> .	
Please post the enclosed placard form of the certificate as indicated at the bottom of the card. Issuance of a Minor Work Certificate shall not relieve the applicant, contractor, tenant, or property owner from obtaining any other permit required by City Code or any law. Minor Works are subject to an appeals period of 30 days from the date of approval.	
Signature (City of Raleigh) <u>Emi Martin</u>	Date <u>09/03/2021</u>



### **NCDP Description of Minor Work**

#### *In accordance to section 1.3 - Site Features and Plantings*

In an effort to maintain the integrity of the landscaping and historic aesthetic of the Goodwin House, the North Carolina Democratic Party would like to propose an engraved brick path on the front grounds to replace the current concrete pathway (as noted by the grided portion of the project drawing). These engraved bricks will be a part of a fundraising campaign to honor past, present and future advocates of the NC Democratic Party. These engraved pavers will be a light gray so as to highlight the white exterior of the Goodwin House and the front marble stairs.



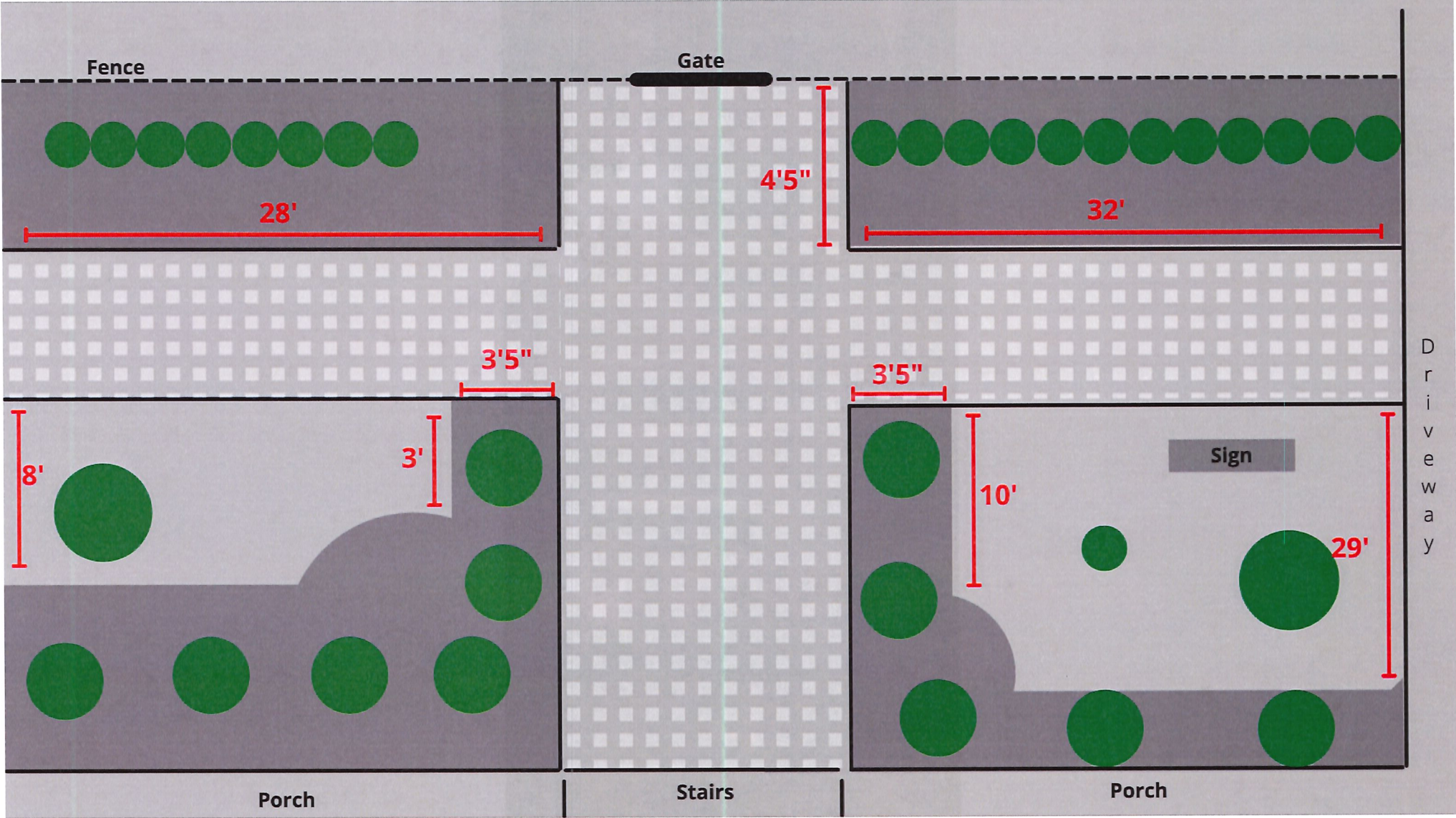

# Lighthouse Gray

COLOR

Gray

MANUFACTURER

Belden

[Visit the Belden Website](#)

























