



CERTIFICATE OF APPROPRIATENESS PLACARD

for Raleigh Historic Resources

Project Description:

Install storm windows and storm doors

404 Elm St

Address

Oakwood

Historic District

Historic Property

COA-0158-2021

Certificate Number

10/4/2021

Date of Issue

4/4/2022

Expiration Date

This card must be kept posted in a location within public view until all phases of the described project are complete. The work must conform with the code of the City of Raleigh and laws of the state of North Carolina. When your project is complete, you are required to ask for a final zoning inspection in a historic district area. Telephone the RHDC office at 832-7238 and commission staff will coordinate the inspection with the inspections Department. If you do not call for this final inspection, your Certificate of Appropriateness is null and void.

Signature, _____

Collette R K

Raleigh Historic Development Commission

Pending the resolution of appeals, commencement of work is at your own risk.

Type or print the following:		
Applicant name: Susan S. Iddings		
Mailing address: 611 Polk St.		
City: Raleigh	State: NC	Zip code: 27604
Date: August 19, 2021	Daytime phone #: 919-832-3978	
Email address: susaniddings@gmail.com		
Applicant signature:		
Minor work (staff review) – one copy Major work (COA committee review) – ten copies Additions > 25% of building sq. footage New buildings Demolition of building or structure All other Post approval re-review of conditions of approval	Office Use Only Transaction #: _____ File #: COA-0158-2021 Fee: _____ Amount paid: _____ Received date: _____ Received by: _____	
Property street address: 404 Elm St.		
Historic district: Historic Oakwood		
Historic property/Landmark name (if applicable): Pullen-Wynne House		
Owner name: Susan S. Iddings		
Owner mailing address: 611 Polk St., Raleigh, NC 27604		

For applications that require review by the COA Committee (major work), provide addressed and stamped envelopes for owners for all properties with 100 feet on all sides of the property, as well as the property owner.

Property Owner Name & Address	Property Owner Name & Address

I understand that all major work applications that require review by the Raleigh Historic Development Commission's COA Committee must be submitted by 4 p.m. on the date of the application deadline; otherwise, consideration will be delayed until the following committee meeting. An incomplete application will not be accepted.

Will you be applying for rehabilitation tax credits for this project? Yes No Did you consult with staff prior to filing the application? Yes No	Office Use Only Type of work: <u>70, 69</u>
--	--

Design Guidelines: please cite the applicable sections of the design guidelines (www.rhdc.org).		
Section/Page	Topic	Brief description of work (attach additional sheets as needed).
2.10/58-59	Sust. and Energy Retrofit	Install storm windows with screens and storm doors (see additional information submitted)

<p align="center">Minor Work Approval (office use only)</p> <p>Upon being signed and dated below by the Planning Director or designee, this application becomes the Minor Work Certificate of Appropriateness. It is valid until <u>04/04/2022</u>.</p> <p>Please post the enclosed placard form of the certificate as indicated at the bottom of the card. Issuance of a Minor Work Certificate shall not relieve the applicant, contractor, tenant, or property owner from obtaining any other permit required by City Code or any law. Minor Works are subject to an appeals period of 30 days from the date of approval.</p> <p>Signature (City of Raleigh) <u>Collette R</u> Date <u>10/04/2021</u></p>
--

Additional information for Minor Work COA Application

This minor work application seeks a COA:

- 1) To install operable exterior storm windows with screens. For the windows in the original stucco part of the house that was constructed circa 1888, I seek approval to install Velv-A-Lume double hung, triple track storm windows (V3T Three Track Storm Window) manufactured by West Company in bronze. For the windows in the wooden clapboard addition that was added to the rear of the house in the 1950's, I seek approval to install Concord double hung, triple track storm windows manufactured by ProVia in rustic bronze. These storm windows and screens are to be installed by Pioneer Exteriors. I am working with Don Becom, Operations Manager (919-828-4405).

The use of two different manufacturers of storm windows is appropriate because the windows in the original stucco structure, the main part of the house, are substantially different from the windows in the back addition. The windows in the front and back are double hung windows with six over six divided panes in each the top and bottom window. There the similarity ends. Foremost, the windows are different in that the windows in the front stucco part of the house are original to the house. The back wooden clapboard part of the house was added in the 1950's to replace an original back porch and to convert the house from a single family home to one with four apartments. Further, the windows differ in overall dimensions and in the frames' style. The windows in the original stucco front of the house are 34" wide by 80" tall. The wood window frames are recessed into the stucco siding, are 1 3/4" wide, and have an arched detail over the top of the window. (The arch is only in the wood of the frame, not the glass panes.) The windows in the wooden clapboard addition in the rear of the house are 33" wide by 62" tall. The wood window frames are applied over the clapboard wood siding. The frames are 4 1/2" wide, and they have no arch. These differences result in the overall effect of the windows in the front and back of the house being quite different. The windows in the front of the house appear to me as more elegant than those in the wooden addition. One can see these differences in the attached photos: Side, facing South and Side, facing North – 1. The original stucco front of the house has 10 windows; the wooden clapboard addition in the back has 17 windows. Selecting the Velv-A-Lume storm windows, widely recognized as the top aluminum storm window for an historic structure, is warranted for the main stucco structure constructed circa 1888. Selecting the ProVia storm windows for the back wooden clapboard is appropriate for an addition built in the 1950's and would result in a welcome cost savings. The differences in the storm windows would not be readily noticeable.

Currently, the window frames of the windows in the original stucco part of the house are painted a dark color, and the window frames of the windows in the wooden clapboard addition are painted a much lighter color. This could change over time. The colors of the two different types of storm windows for this COA Application are almost identical.

- 2) To install custom made storm doors for the three French doors that open onto the wrap-around front porch. Two of the French doors open onto the front porch that faces Elm Street and one is around the wrap of the porch that faces Oakwood Avenue. When I bought this property, the French door that faces Oakwood Avenue still had its original screen door. It has since been restored. See Photo Original screen door – 1 and Original screen door – 2. Please note that the screen for the transom is fixed and has a separate wooden frame that is in the same plane as the screen door when it is closed. I seek approval to use this single screen door to serve as the pattern for the storm door for it and for the other two identical French doors. Also, I seek approval to use it as the pattern for a screen door and a storm door for the back door and its

transom and for the storm door for the front door of the basement level Apartment that faces Oakwood Avenue. The photo Apt. front door shows it has no transom. These storm doors are to be painted to match the original screen door: Sherwin Williams Endurance exterior acrylic paint in the color green black. Lastly, I seek approval to add custom wooden storm windows to two windows in this same apartment: see photos Apt. South side window and Apt. East back window. The former window faces Oakwood Avenue, and the latter faces the back yard. Both of these windows open to the outside.

I welcome staff input on these storm doors, storm windows for the basement level apartment, and for suggestions on how to improve the weatherization of the double wood-paneled front door. If the front door cannot be adequately weatherized with weatherstripping or any other additional means, I seek staff input on what storm door style is appropriate to use for a custom storm door.



















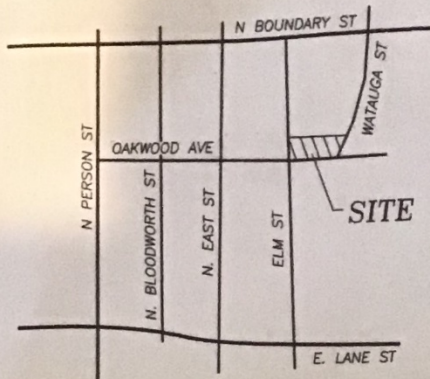

VICINITY MAP
(N.T.S.)

FLOOD CERTIFICATION

THIS WILL CERTIFY THAT THE SUBJECT PROPERTY
() IS or (X) IS NOT located in a SPECIAL FLOOD HAZARD AREA
as determined by the Department of Housing and Urban
Development, or as shown on the FLOOD INSURANCE RATE MAP.

370243 1704 J
COMMUNITY # PANEL SUFFIX

Jeffrey H. Davis, PLS
PROFESSIONAL LAND SURVEYOR

SCALE

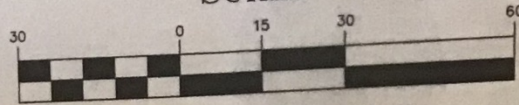

(IN FEET)
1 inch = 30 ft.

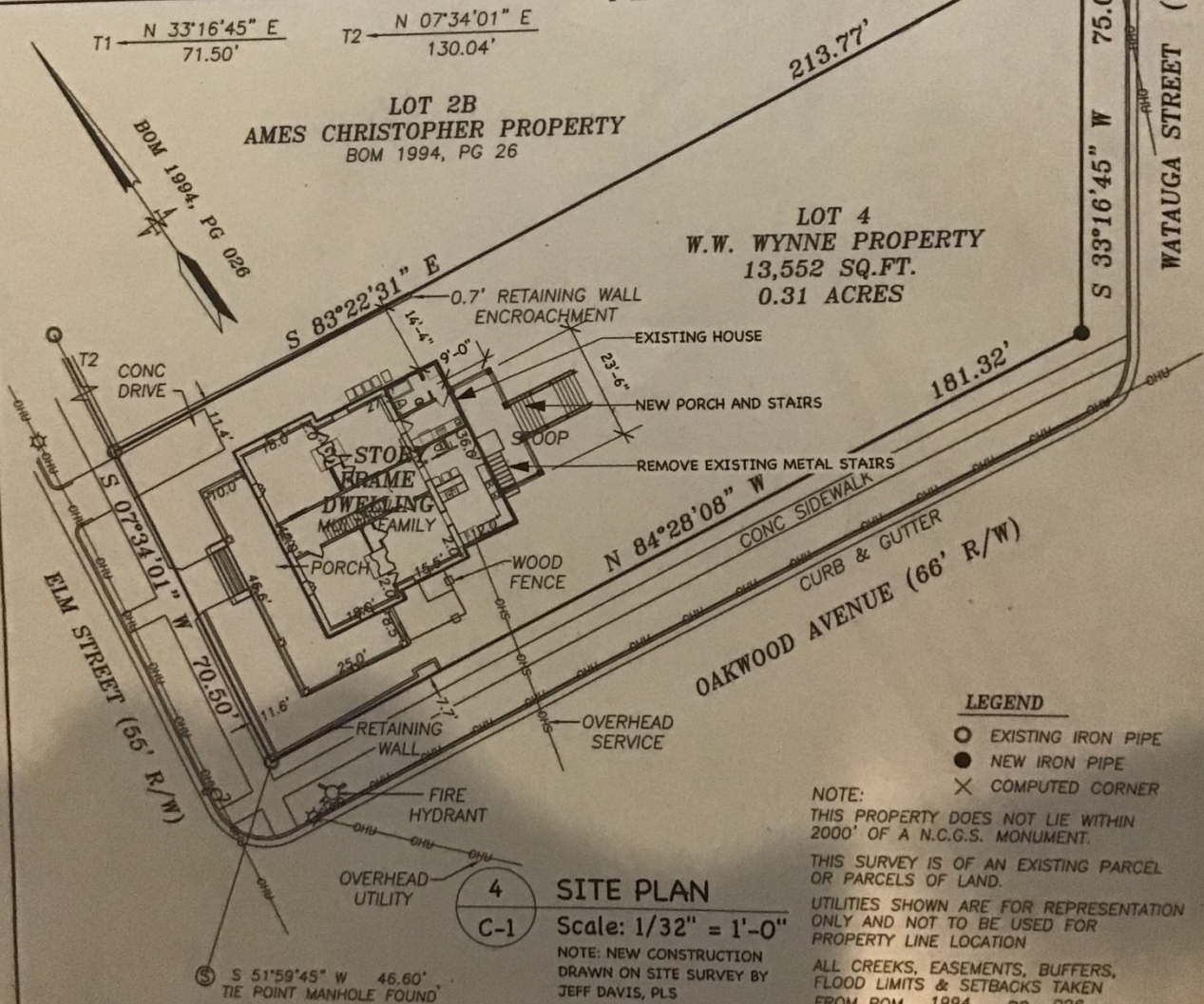

LEGEND

- EXISTING IRON PIPE
- NEW IRON PIPE
- × COMPUTED CORNER

NOTE:

THIS PROPERTY DOES NOT LIE WITHIN
2000' OF A N.C.G.S. MONUMENT.
THIS SURVEY IS OF AN EXISTING PARCEL
OR PARCELS OF LAND.
UTILITIES SHOWN ARE FOR REPRESENTATION
ONLY AND NOT TO BE USED FOR
PROPERTY LINE LOCATION
ALL CREEKS, EASEMENTS, BUFFERS,
FLOOD LIMITS & SETBACKS TAKEN
FROM BOM 1994, PG 026

SITE PLAN

Scale: 1/32" = 1'-0"

NOTE: NEW CONSTRUCTION
DRAWN ON SITE SURVEY BY
JEFF DAVIS, PLS

I, Jeffrey H. Davis, PLS, certify this map was drawn under my supervision from an actual survey made under my supervision;
and that the error of closure as calculated by latitudes and departures is 1/10,000+; that the boundaries not surveyed
are shown as broken lines plotted from information found in Book - ; Page - ; that this map was prepared in
accordance with G.S. 47-30 amended.

Witness my original signature, registration number and seal this



Velv-A-Lume



The Invisible Storm Window

 ***West Window Corporation***
Since 1949

Velv-A-Lume

The Invisible Storm Window

VELV-A-LUME Historical Storm Windows have been used to solve difficult window situations for many years in both residential and commercial buildings. With historic renovations on the rise all across the nation, there is a need for a storm window that will provide protection to the original windows as well as increase their thermal efficiency – without changing the historic look. Designed and produced with this exact purpose in mind, the VELV-A-LUME is the perfect solution for many historic window projects.

The combination of strong tubular aluminum extrusions, tongue and groove sash seal, and close tolerances between sash and frame make the VELV-A-LUME Storm Window a serious performer. As a result, VELV-A-LUME Storm Windows have been installed in many state, local, and federal projects, including office buildings, colleges, police barracks, highway department buildings, and hospitals, as well as veterans administration and military reservation facilities. Available as both an outside or inside mount window, the VELV-A-LUME has been installed on numerous warehouse or factory to loft-style apartment conversion projects with great success.

In many historic renovations, existing architectural details such as windows must be preserved due to restrictions and guidelines enacted by localities. The VELV-A-LUME Storm Window has been used extensively in these situations. Designed to fit flush within the existing window opening, it's often difficult to detect that a storm window has been installed. VELV-A-LUME Storm Windows are butt construction, expander style windows. An expander window is unique in that it can be fitted into a window opening that is out of square and still fit perfectly, allowing the sash and frame to remain square and operate with ease. A unique receptor system is also available for masonry openings, as well as radius top fixed windows to fit many openings. VELV-A-LUME...the ideal choice for "invisible" protection.

KEY

1. Sill Main Frame
2. Lower Sash Frame — Tubular Extrusion
3. Upper Sash Frame — Tubular Extrusion
4. Insect Screen Frame — Tubular Extrusion
5. Frame Jamb
6. Glazing Vinyl
7. Aluminum Insect Screen — (Fiberglass Optional)
8. Lower Screen Frame - Tubular Extrusion
9. Flush Finger-Tip Operated Sash Slide Bolt
10. Screen Latch Handle — Stainless Steel
11. Sash Interlock
12. Tongue and Groove Type Seal
13. Screen Track with Latch Lip

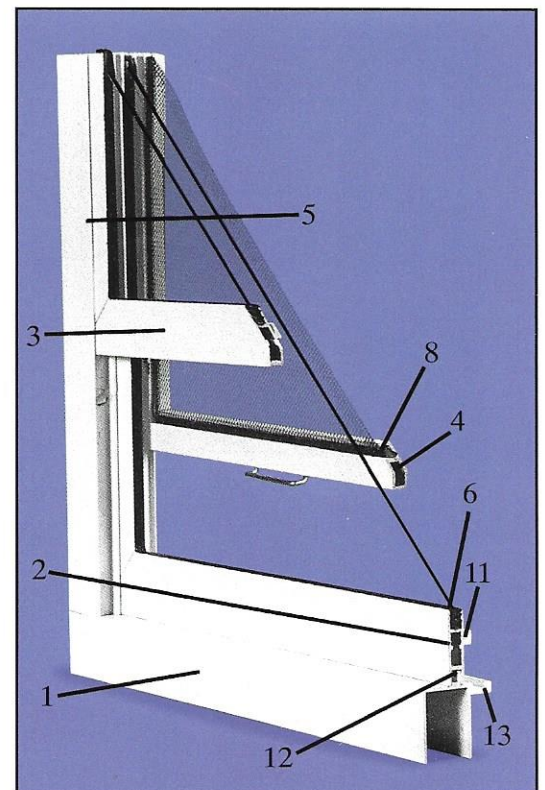
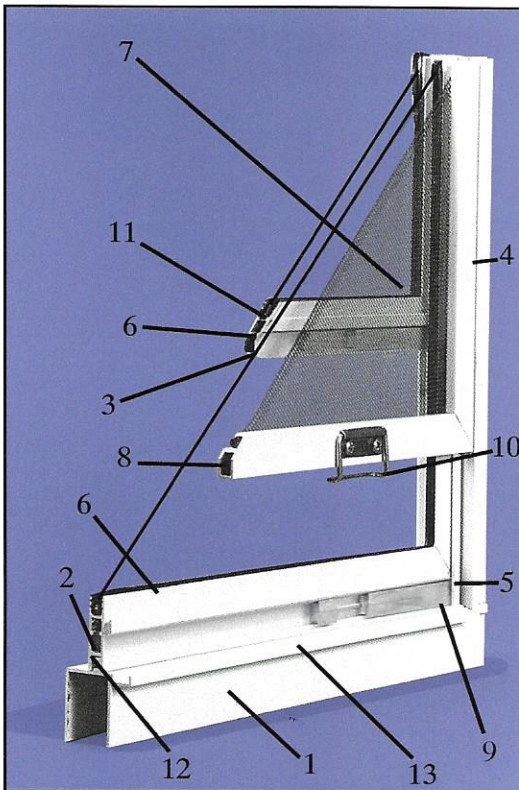

Corner section of main frame of storm window, showing both top and bottom sash and screen, each in separate tracks.
(Note: all screen rails and bottom of both insert rails are tubular extrusions to assure more strength and rigidity.)

Both sash are glazed with wrap-around vinyl for easier repair and strength. Special corners are used to eliminate dimples and staking marks.

On the Cover: "Person-McGhee Farm" located in Franklin County, North Carolina. Oldest part built between 1770 and 1820. Listed in National Register of Historical Places August 14, 1979. Velv-A-Lume Storm Windows installed in Spring of 1999.



Radius top Removable Panel Fixed Units shown in Tan on the Rockefeller Norfolk Luxury Apartments, Norfolk, Virginia. The VELV-A-LUME storm window is a great performer in both commercial and residential applications.



- Flush mounting for non-obtrusive appearance
- Expander type frame for a perfect fit in almost any opening
- Most fasteners are concealed by the expanders for a clean installed look
- Wide fingertip operated sash latches for easy operation
- Tubular extruded T6063-T6 aluminum for exceptional strength and long service life
- Interlocking sash and screen with tongue and groove seal at bottom for remarkable resistance to the elements
- Electrostatically applied polyester resin paint finishes provide long lasting service



V3T Three Track Storm Window

Standard Features

- Flush mount expander style Storm Window
- T-6063 Aluminum Extrusions, .050" walls in main frame, .0465" walls in sash profiles
- 1" Expanders on jambs, 7/8" Expander on head
- Sashes and screen are side-loaded into the frame for outstanding structural strength.
- Wide fingertip operated zinc die-cast sash slide bolts
- Sash corners are securely fastened with internal self-locking zinc die-cast corner gussets – no exposed fasteners
- Extruded full-width aluminum interlock at meeting rail
- Extruded tongue and groove sash to frame closure at frame sill for improved structure, air performance, and water control.
- Both sashes are channel glazed using a flexible vinyl glazing gasket and can be re-glazed if necessary.
- When ventilating with bottom sash fully raised, the screen interlocks with the sash for improved insect control (unless meeting rail is moved from the standard location).
- Architectural paint finish meets AAMA 2603. Colors available: White, Bronze, and Tan.

Optional Features

- Matching Picture Window (VPW)
- Radius Top Transom & Picture Window
- Numerous glazing options, Low-E, tempered glass
- Mullion for multiple units
- Receptor System for masonry openings
- Large Sill Expander for steeply sloped sills
- Beveled Side Expander for shallow openings
- Exterior or Interior mounting

DISTRIBUTED BY:

Manufactured by:

 **West Window Corporation**

P.O. Drawer 3071

Since 1949

Martinsville, Virginia 24115

Phone (276) 638-2394

www.westwindow.com

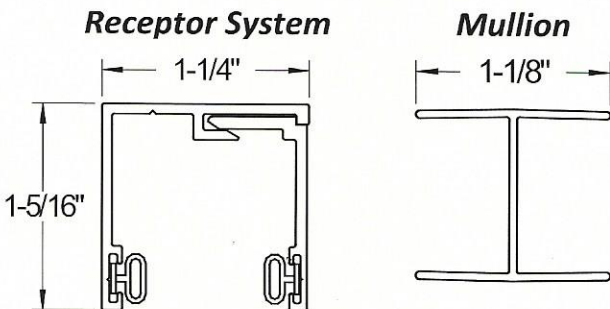
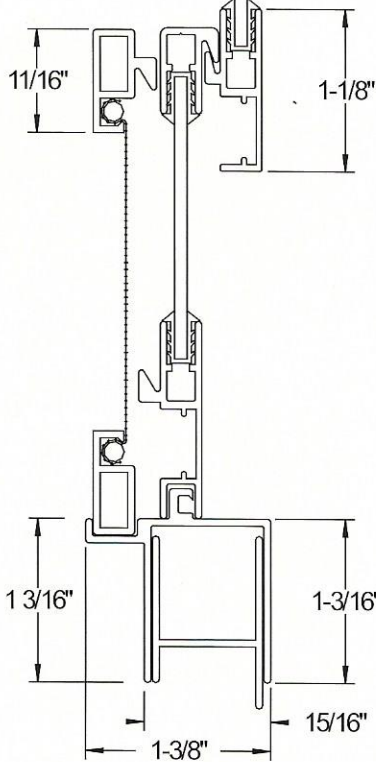
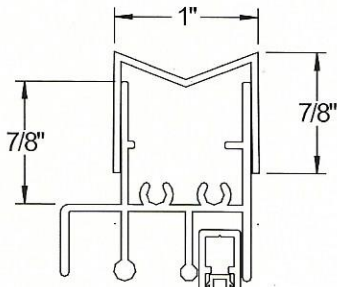

ALUMINUM STORM WINDOWS



ALUMINUM STORM WINDOWS

ARCHITECTURAL INTEGRITY AND PROTECTION

STORM WINDOW ADVANTAGES

Maintenance Free

Weather Protection

Reduce Outside Noise

Protect Original Windows

Easy to Install - No Mess!*

WHY CHOSE ALUMINUM STORM WINDOWS?

Custom-built to your exact specifications

Constructed of heavy-duty, extruded aluminum for long life and structural integrity

Creates a dead air space that helps block energy transfer

Complement your home with one of 17 colors

Low-E and other glass options available

Lifetime Limited Transferable Warranty



Latch bolts, swivel sash keys and sash guides have been designed for improved durability and functionality



Wrap around marine glazing seals glass firmly into sash



Anti-bow pins ensure sashes will resist bowing under heavy wind loads (double hung only)

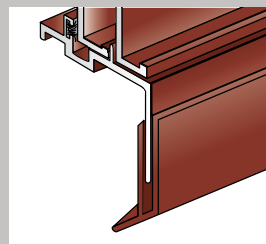

Adjustable 1" bottom expander simplifies installation for out of square openings and is weeped for drainage (except on #140 picture models)



Nylon pivot pins ensure smooth sash operation (double hung only)



Heavy-duty sash interlock seals seal out the elements (double hung & sliders)

* The basic installation of ProVia Storm Windows is excluded by definition from the U.S. EPA Lead-Based Repair, Replace and Painting Program (RRP Rule).



Shown: Mountain Berry Storm Windows

WHY CHOOSE **LOW-E** GLASS FOR YOUR WINDOW

Save Money and get Quick Payback!

Over 800,000 homes annually have storm windows installed¹, with virtually all having clear uncoated glass, reducing the heating load by only 13% with a 10 year simple payback².

In a Chicago study, Low-E storm windows showed marked improvement over the clear glass benefits amounting to an average of 21% heat load reduction and an average payback of 4.5 years².

Cost-effective alternative to total window replacement

Warmer in winter; average of 21% heat load reduction²

Cooler in summer; reduces solar heat gain

Reduces air infiltration

Storm windows are designed to be installed over existing windows having sloped sills and are not intended to be used as a primary window. Regardless of application, product warranty does not cover issues such as leaking and condensation.

¹ U.S. DOE, September 2014 - "Low-E Storms: The Next "Big" Thing" in Window Retrofits" by Pam Cole, Pacific Northwest Laboratory and U.S. DOE, June 2013 - "Low-E Storm Windows: Market Assessment and Pathways to Market Transformation" by KA Cort, Pacific Northwest Laboratory

² S. Craig Drumheller - NAHB Research Center, Christian Kohler - Lawrence Berkeley National Laboratory, Stefanie Minen - Utilvate Technologies, *Field Evaluation of Low-E Storm Windows*, 2007





DOUBLE HUNG

Town & Country

Triple Track Operation with Inside Operating Half Screen

Double Track Operation with Screen Under Exterior Sash

Mitered Frame Corners with Contoured Master Frame

Full Perimeter Black Vinyl Frame Liner

Mid-Window Stabilizer Bar

Removable Tilt In Sashes and Half Screen

Ratcheted Sash Stops every 1 $\frac{5}{8}$ " on Top and Bottom Sashes

Coated Springs and Polymer Constructed Latch Bolts



Mitered frame corners provide superior strength and beauty. For extra elegance we have a contoured master frame.

DOUBLE HUNG

Concord

Triple Track Operation with Inside Operating Half Screen

Double Track Operation with Screen Under Exterior Sash

Butted Frame Corners and Contemporary Look

Optional External Full Screen

Full Perimeter Weatherstripping

Mid-Window Stabilizer Bar

Removable Tilt-In Sashes and Half Screen

Ratcheted Sash Stops every 1 $\frac{5}{8}$ " on Top and Bottom Sashes

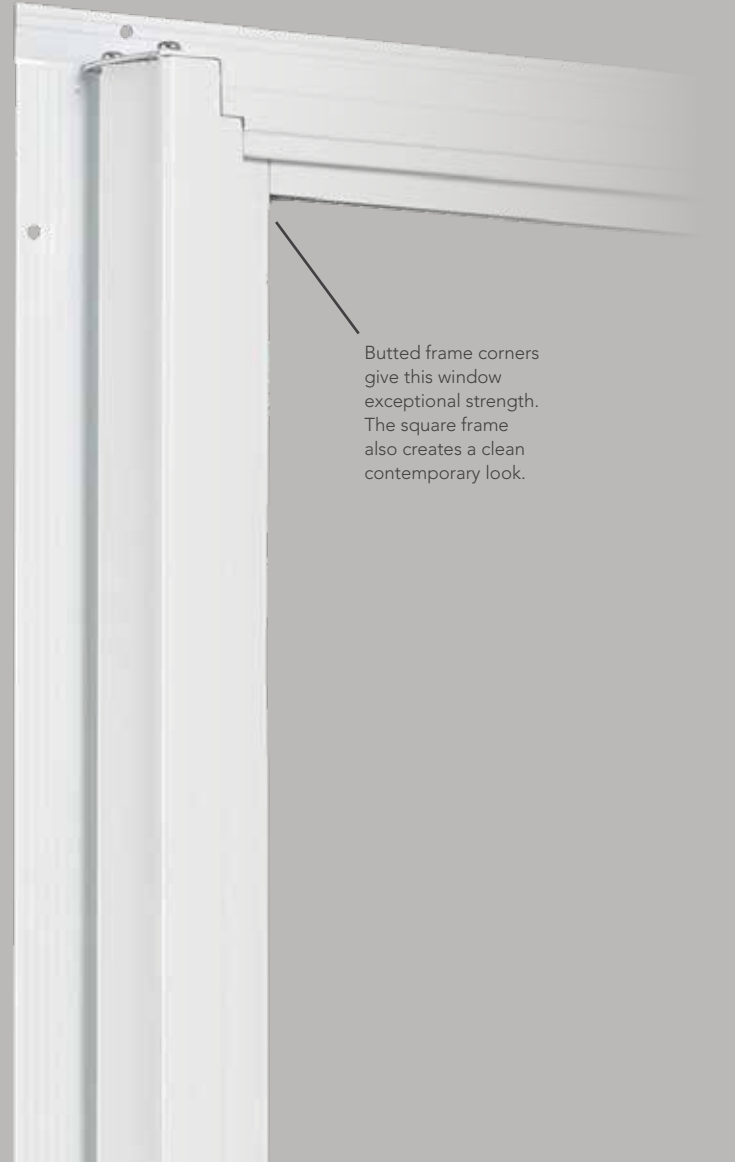

Butted frame corners give this window exceptional strength. The square frame also creates a clean contemporary look.

SLIDER

Valley Forge

Mitered Frame Corners

Available in 2 or 3-Lite Models

(3-Lite Available in 1/4, 1/2, 1/4 or 1/3, 1/3, 1/3 or Custom)

Hollow Sill Construction Provides Drainage Control

Full Length Pull Rail with Spring-Loaded Latches

Delrin® Rollers with Stainless Steel Housing

Stabilizer Bar in Screens over 40" Tall



Inside Latch

PICTURE

Clinton 240

Mitered Frame Corners

Available with Outside Removable Sash

Sash Clips for Removable Screen and Sash

Full Perimeter Weatherstripping

Available in 1, 2, 3, or 4 Lite Units

Architectural Shapes Available as Special Order with Additional Lead Time (See page 6 for more details.)

Also Available in 140 and 630 (Inside Removable) Styles



STORM WINDOW COMPARISON

	Town & Country Double Hung 520/527	Concord Double Hung 696/697	Valley Forge 2-Lite Slider 422	Valley Forge 3-Lite Slider 423	Clinton Outside Removable 140/240	Clinton Inside Removable 630
Mitered & Screwed Corner Construction	●	Butted & Screwed	●	●	●	●
Color Matched Installation Screws	●	●	●	●	●	●
Frame Profile	Contoured with Vinyl Liner	Square	Square	Square	Square	Contoured
Wrap Around Marine Glazing	●	●	●	●	●	●
Standard Screen Size	Half	Half (Full screen optional)	Half	Two	Full Optional	Full
Full Perimeter Weatherstripping	●	●	●	●	●	●
Stabilizing Bar	Horizontal	Horizontal	Vertical	Vertical	N/A	N/A
17 Standard Colors	●	●	●	●	●	●

COLOR OPTIONS

Our oven-baked finishes are backed by a Lifetime Limited Warranty for lasting beauty and low maintenance. These finishes are also available on ProVia Storm Doors, Entry Doors, Vinyl Windows and Patio Doors.



Always refer to our color selector for accurate color representation.

ARCHITECTURAL SHAPES

Nothing adds drama to a home like specialized architectural shapes. Customized shapes are available in a wide variety of styles, some of which are shown below.

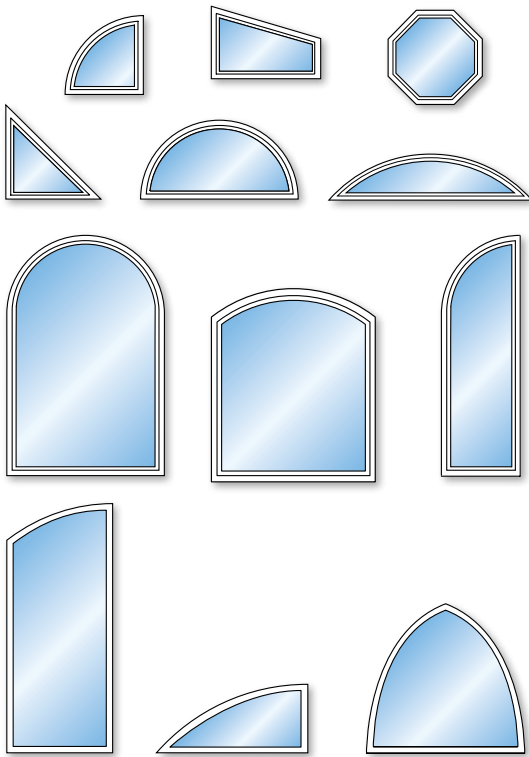

Architectural shapes available as special order with additional lead time.



Shown: Enzian Blue Storm Windows

ADD EXTRA PRIVACY AND TINT TO YOUR WINDOW

Privacy Options

Choose from Obscure Pebble or Gluechip glass if you need light to filter in, yet want to maintain privacy.



OBSCURE PEBBLE



GLUECHIP

Actual privacy levels will vary depending on your distance from the glass and also the amount of light in the room in comparison to the light outside your home. Privacy glass is not available for shaped storm windows.

Tint Options

Tinted glass can help reduce UV transmittance, solar heat gain and glare. Tinted glass options can give a room a whole new look, providing its own unique set of benefits. Be sure to choose the right one for your home.



Gray Tint

Excellent glare control
Exceptional protection against interior fabric and color fading
Ultraviolet light protection



Bronze Tint

High visible light transmittance
Warm glow to interior décors
Complements brick and stone
Ultraviolet light protection



Green Tint

Subdues interior brightness
High visible light transmittance



Blue Tint

Low shading coefficient
High visible light transmittance
Solar performance (reduces solar heat gain)

Additional Glass Options

Single glazed clear glass available in single strength and double strength.

Low-E and tempered glass options available.

1/8" Acrylic available in place of glass.





"To serve, by caring for details in ways others won't." It's not just our mission, but a way of letting our light shine every day at ProVia®. We continually strive to put these words into action by providing unmatched quality and service. The P-icon symbolizes each employee's commitment to devoting the utmost care, pride and quality into each building product we manufacture...it's The Professional Way.



DOORS | WINDOWS
SIDING | STONE | ROOFING
provia.com

© 2020 ProVia
P-MK-0070-20 | 1/20

Distributed by:

