

CITY OF RALEIGH

STANDARD DETAILS

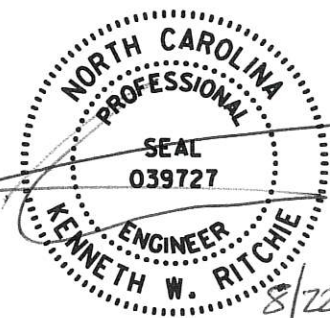

TRANSIT

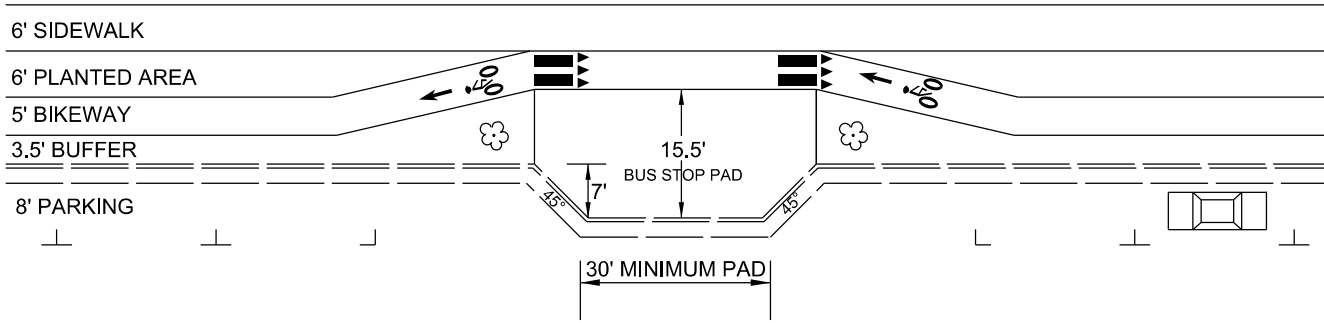

MID WITH PARKING

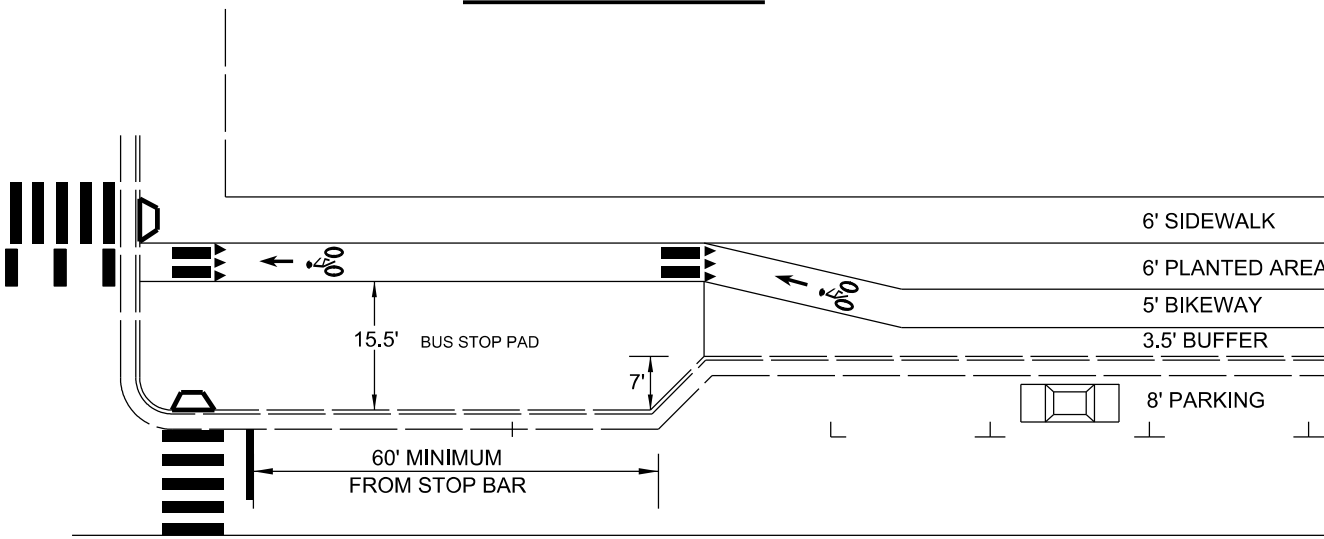

NEAR SIDE WITH PARKING

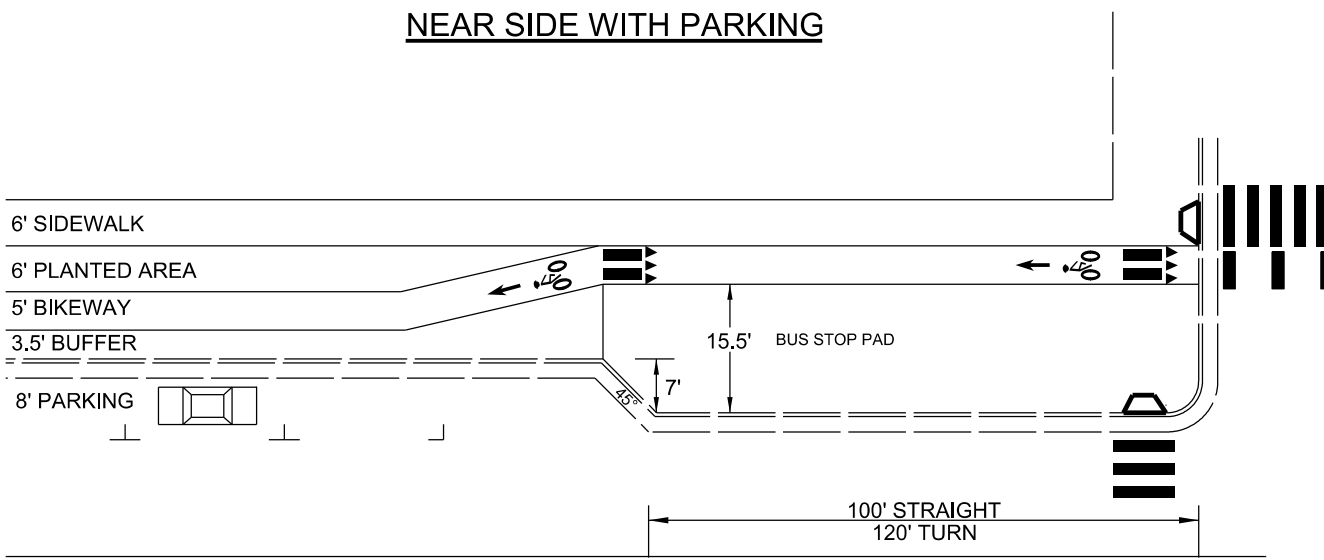

FAR SIDE WITH PARKING

SHEET 1 OF 3

NOTES:

1. STOPS SERVING HIGH-FREQUENCY ROUTES SHOULD BE TWICE AS LONG AS THE DIMENSIONS SHOWN, OR AS OTHERWISE APPROVED BY THE TRANSIT DIVISION.
2. SEE TT-02 FOR BUS STOP PAD DESIGN SPECIFICATIONS.
3. THE BIKEWAY SHIFTING TAPER SHOULD BE 7:1 PREFERRED, 3:1 MINIMUM.

**CITY OF RALEIGH
STANDARD DETAIL**

REVISIONS	DATE: 08/2023	NOT TO SCALE
	TYPICAL BUS STOP AT CURB-LEVEL BIKEWAY	
	TT-01.1	

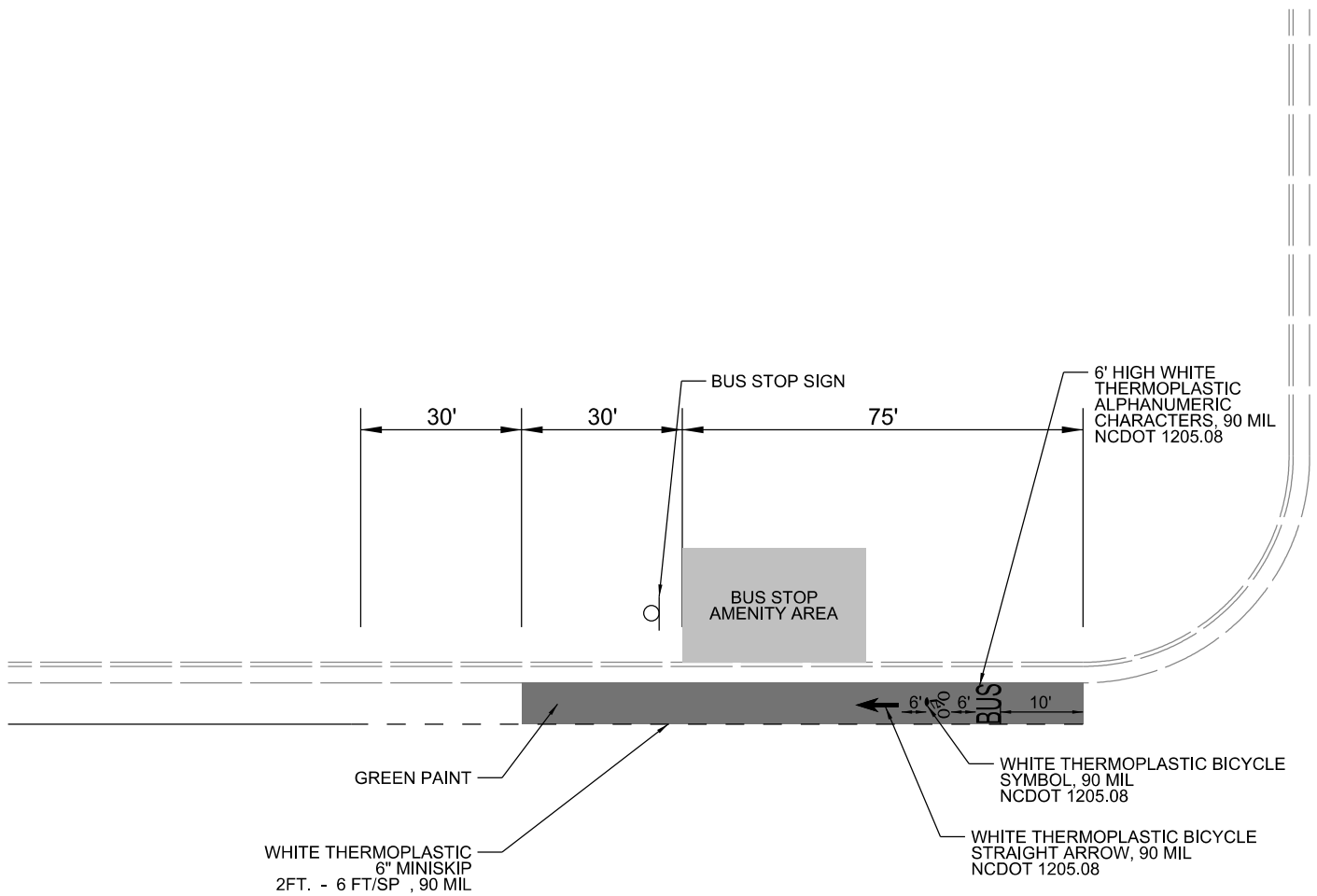

BUS STOP AT STREET-LEVEL BIKEWAY

SHEET 3 OF 3

NOTES:

1. STOPS SERVING HIGH-FREQUENCY ROUTES SHOULD BE TWICE AS LONG AS THE DIMENSIONS SHOWN, OR AS OTHERWISE APPROVED BY THE TRANSIT DIVISION.
2. SEE TT-02 FOR BUS STOP PAD DESIGN SPECIFICATIONS.

CITY OF RALEIGH STANDARD DETAIL		
REVISIONS	DATE: 08/2023	NOT TO SCALE
	TYPICAL BUS STOP AT STREET-LEVEL BIKEWAY	
	TT-01.3	



11. SIDEWALK AND CONCRETE IN UTILITY STRIP AT BACK OF CURB WILL BE 4" THICK IN ACCORDANCE WITH THE STANDARD SIDEWALK SECTION.



<h1 style="text-align: center;">CITY OF RALEIGH</h1> <h2 style="text-align: center;">STANDARD DETAIL</h2>	
REVISIONS DATE: 12/2022	DATE: 8/2020 NOT TO SCALE
 	BUS STOP PAD
 	<h1>TT-02</h1>

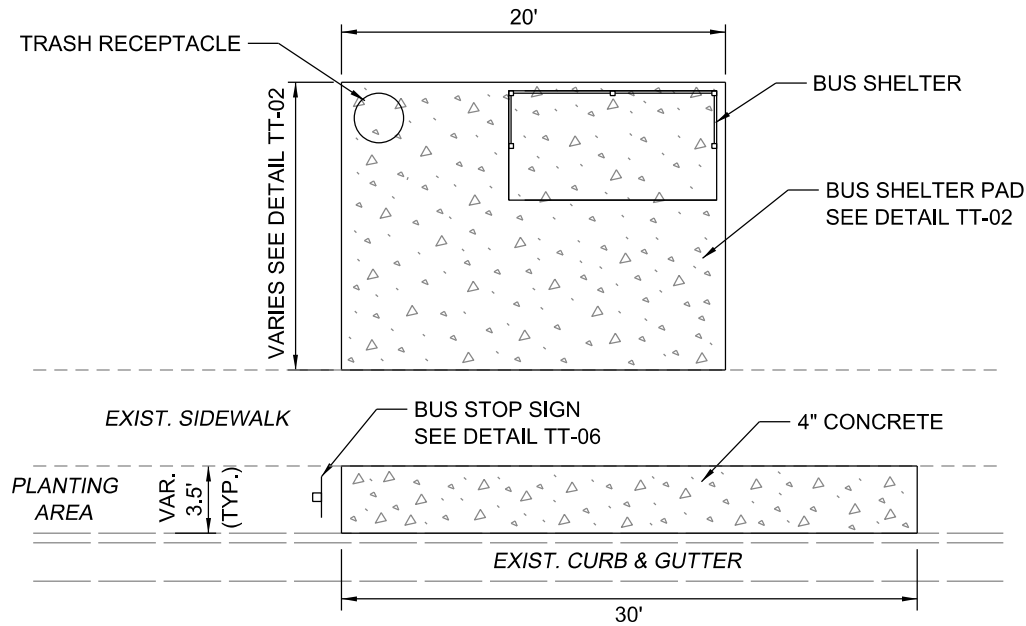

**TYPICAL SHELTER LAYOUT
WITH EXISTING SIDEWALK**
NTS

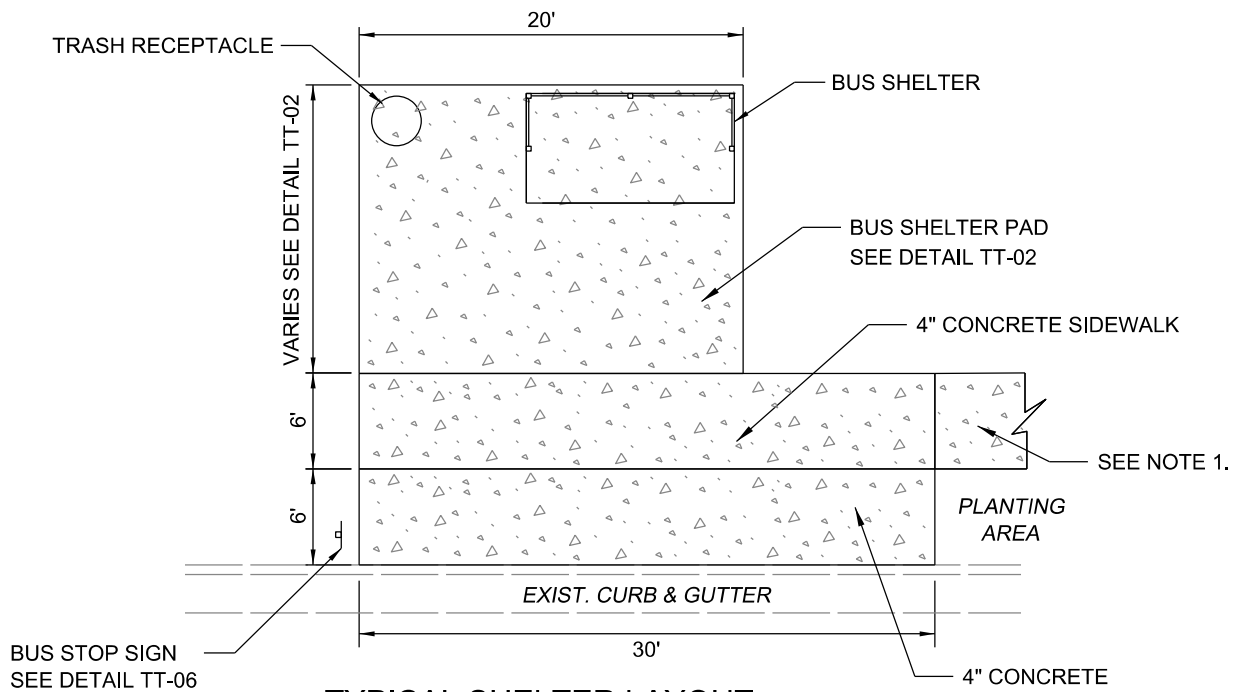

**TYPICAL SHELTER LAYOUT
WITHOUT EXISTING SIDEWALK**
NTS

NOTES:

1. IF NO SIDEWALK CURRENTLY EXISTS, PROVIDE SIDEWALK TO NEAREST ADA ACCESSIBLE INTERSECTION OR DRIVEWAY WITH APPROPRIATE RAMPS. SIDEWALK AND PLANTING AREA WIDTH TO BE IN COMPLIANCE WITH THE CITY'S UDO. PROVIDE CURB RAMP IN ACCORDANCE WITH CITY STANDARDS.
2. BUS SHELTER SHALL BE MINIMUM 6" FROM EDGE OF CONCRETE PAD.
3. FIXED OBJECTS SHALL BE PLACED OUTSIDE OF THE CLEAR ZONE.

CITY OF RALEIGH STANDARD DETAIL		
REVISIONS	DATE: 8/2020	NOT TO SCALE
	SITE LAYOUT FOR SHELTER	
	TT-04	

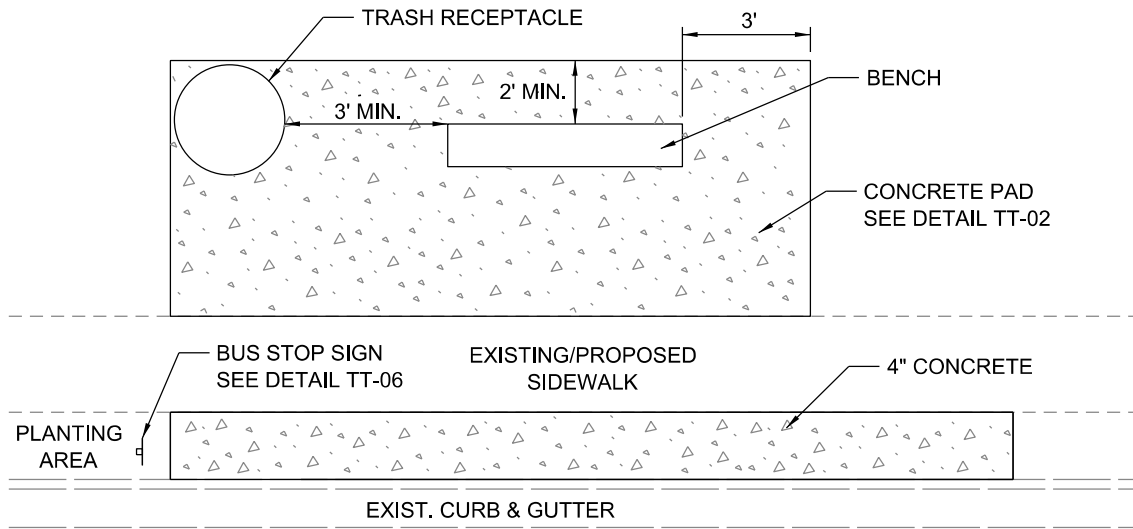

**TYPICAL BENCH LAYOUT
WITH EXISTING SIDEWALK**
NTS

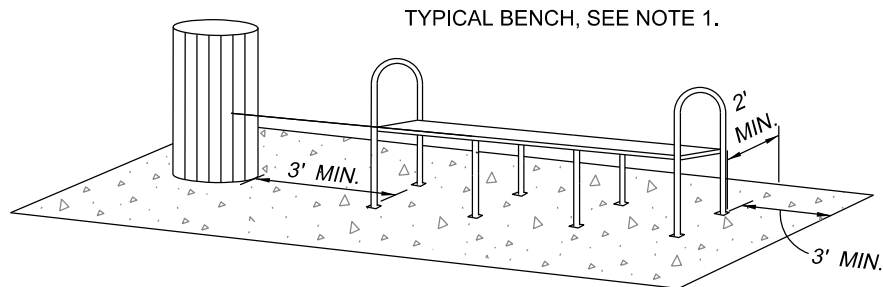

BENCH SCHEMATIC

NOTES:

1. BENCH STYLE SUBJECT TO CHANGE, COORDINATE WITH CITY.
2. BENCH SHOULD BE A MINIMUM OF 3' FROM THE SIDE OF THE CONCRETE PAD AND 2' FROM THE BACK EDGE OF THE CONCRETE PAD. COORDINATE LOCATION WITH THE CITY.
3. IF NO SIDEWALK CURRENTLY EXISTS, PROVIDE SIDEWALK TO NEAREST ADA ACCESSIBLE INTERSECTION OR DRIVEWAY WITH APPROPRIATE RAMPS.
4. FIXED OBJECTS SHALL BE PLACED OUTSIDE OF THE CLEAR ZONE.

CITY OF RALEIGH STANDARD DETAIL		
REVISIONS	DATE: 8/2020	NOT TO SCALE
DATE: 12/2022	SITE LAYOUT FOR BENCH	
	TT-05	

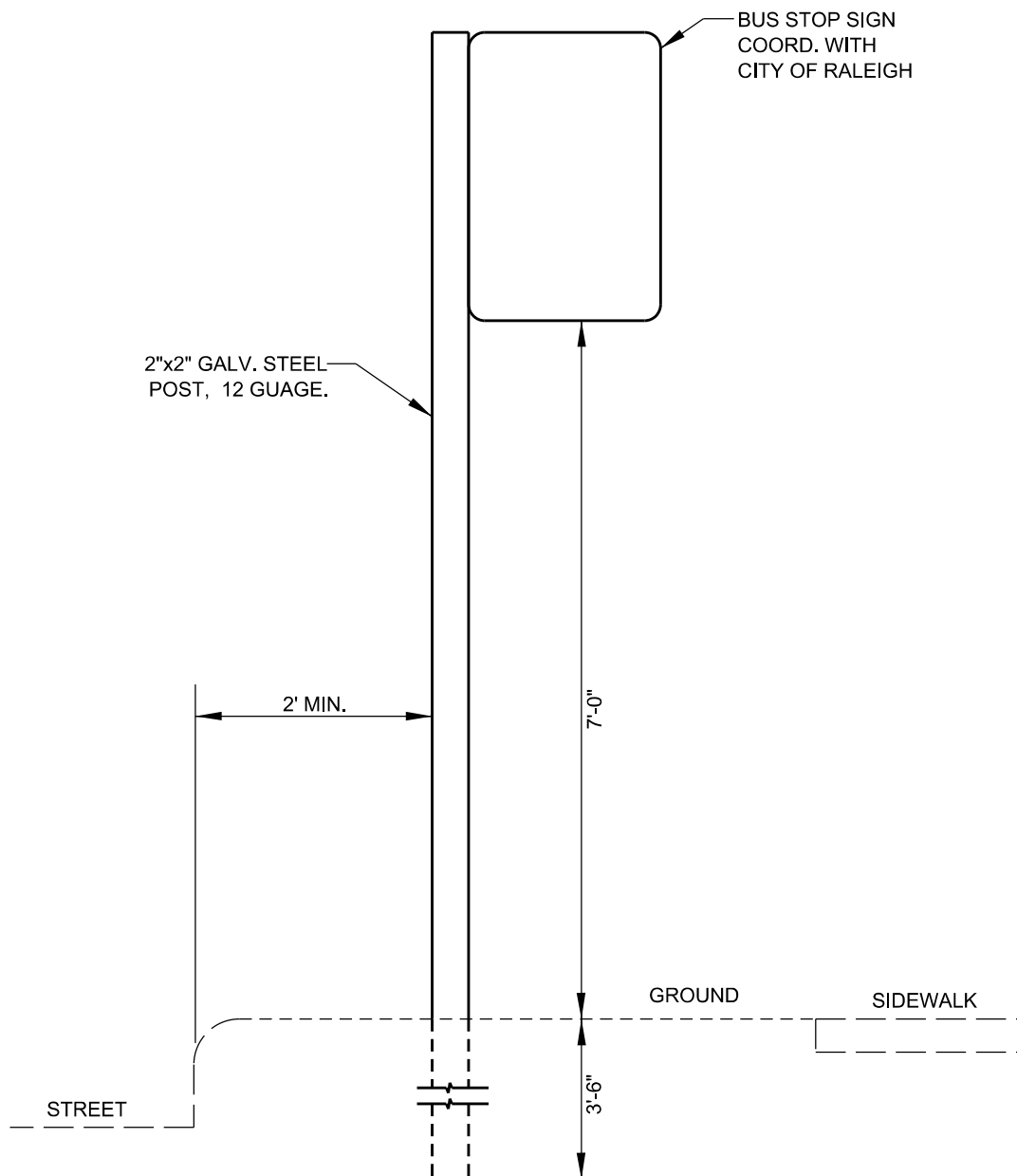

NOTES:

1. INSTALL SIGN AHEAD OF STOP 2' FROM CONCRETE SECTION IN UTILITY STRIP
2. CALL 811 FOR UNDERGROUND UTILITY LOCATION PRIOR TO INSTALLATION.

CITY OF RALEIGH STANDARD DETAIL		
REVISIONS	DATE: 8/2020	NOT TO SCALE
	SIGN POST LAYOUT	
	TT-06	

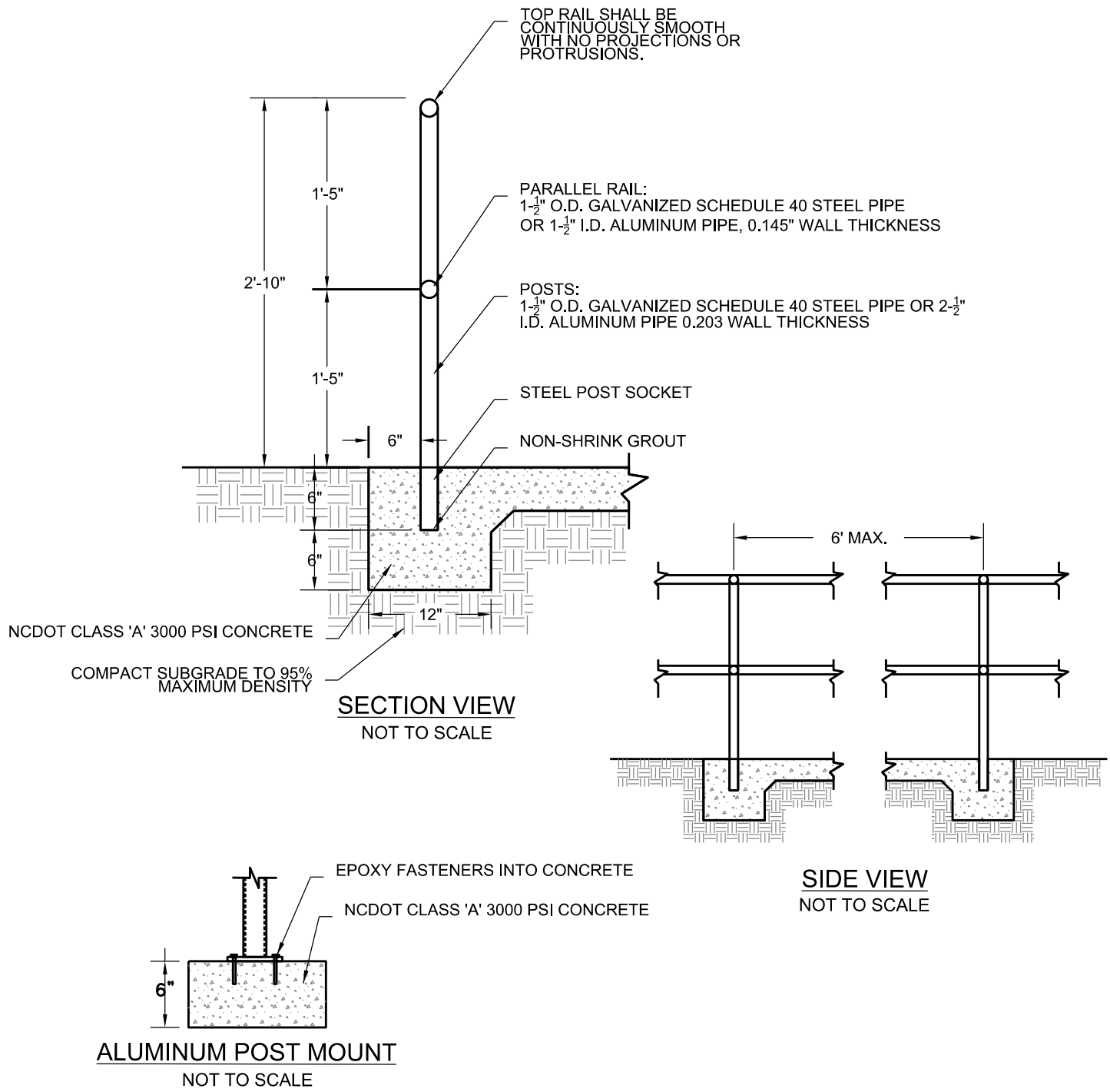

NOTES:
1. CONTRACTOR TO PROVIDE FULL SHOP DRAWINGS FOR HANDRAIL PRIOR TO INSTALLING.

CITY OF RALEIGH STANDARD DETAIL		
REVISIONS	DATE: 8/2020	NOT TO SCALE
	HANDRAIL INSTALLATION	
	TT-07	

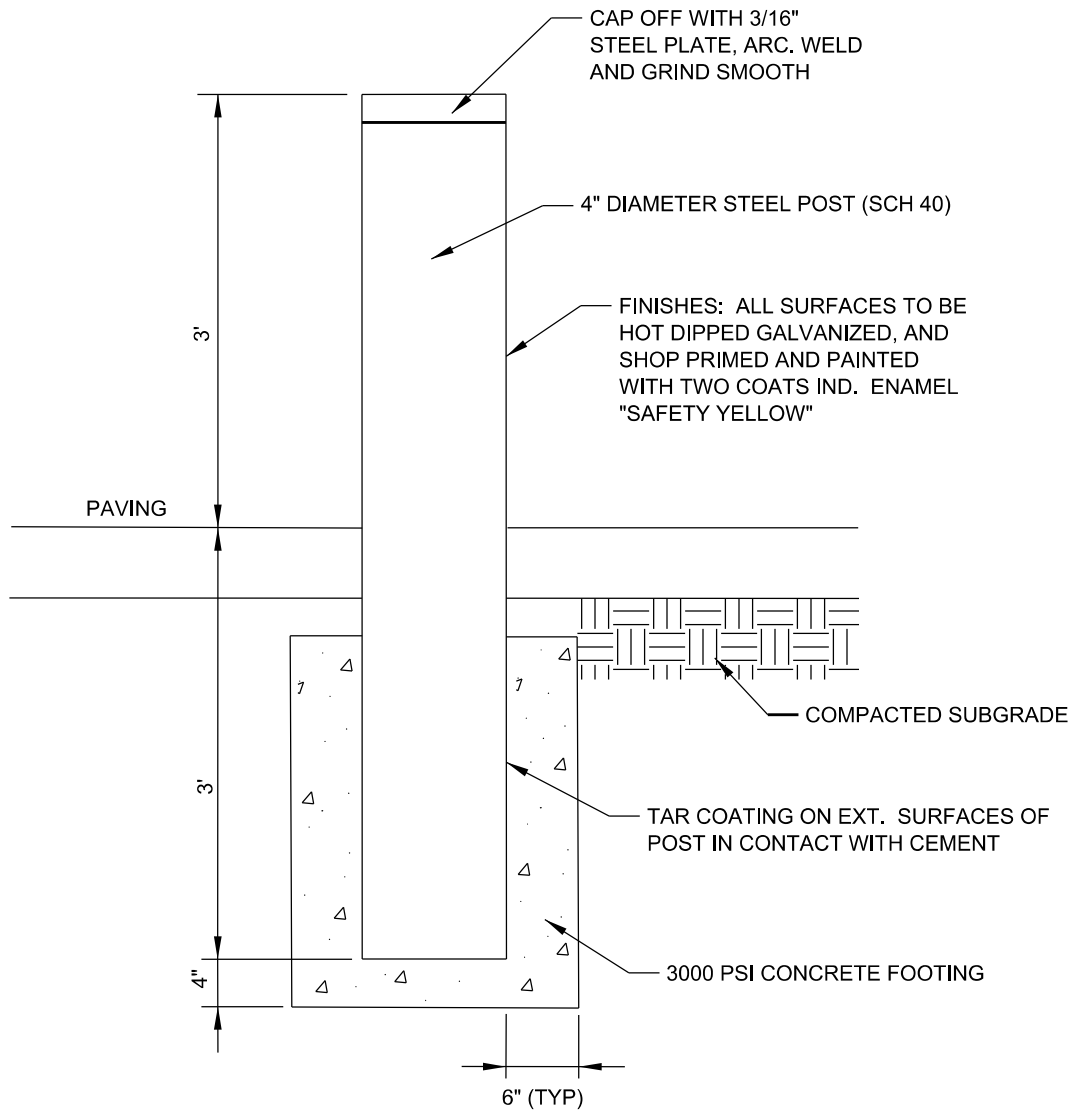

CITY OF RALEIGH
STANDARD DETAIL

REVISIONS	DATE: 8/2020	NOT TO SCALE
	BOLLARD INSTALLATION	
	TT-08	



CITY OF RALEIGH		
STANDARD DETAIL		
<i>REVISIONS</i>	<i>DATE: 8/2020</i>	<i>NOT TO SCALE</i>
	RETAINING WALL	
	TT-09	

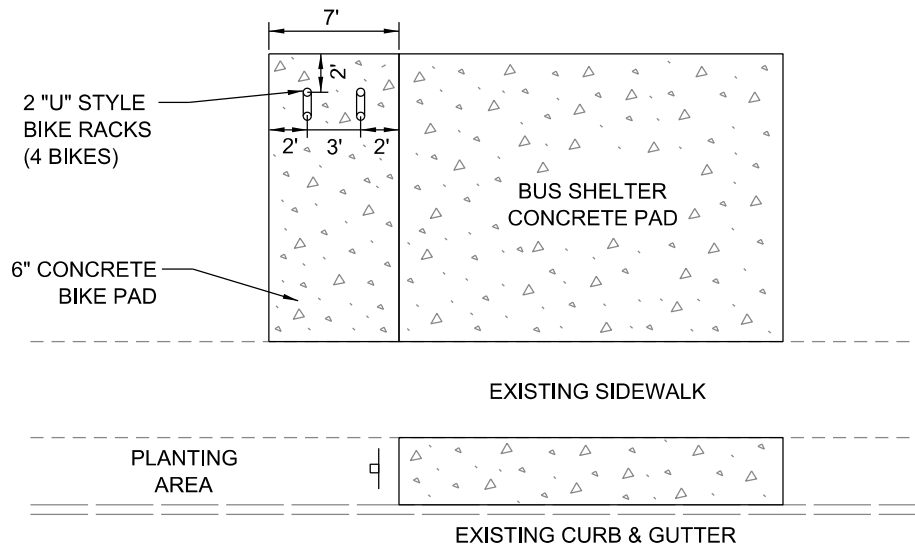

TYPICAL BIKE PAD LAYOUT
NTS

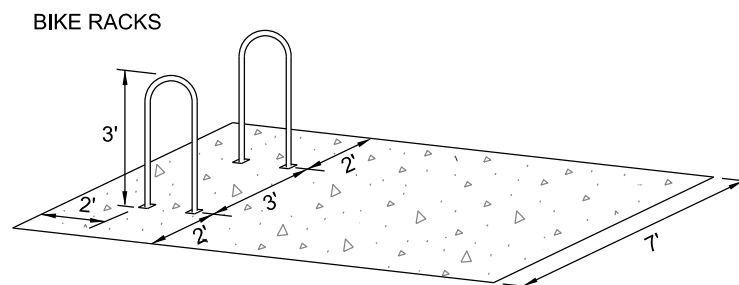

BIKE RACK SCHEMATIC

NOTES:

1. BIKE RACK TO BE 2" SCHEDULE 40 STEEL POWDER COATED BLACK.
2. COORDINATE LOCATION WITH THE CITY PRIOR TO INSTALLATION.

CITY OF RALEIGH STANDARD DETAIL		
REVISIONS	DATE: 8/2020	NOT TO SCALE
	SITE LAYOUT FOR BIKE PAD	
	TT-10	