

VICINITY MAP (NOT TO SCALE)

\* THE FOLLOWING PROPERTIES MAY HAVE THE SETBACK REDUCED AT THE ENGINEER'S DISCRETION DURING DESIGN TO ACCOMMODATE SEVERE TOPOGRAPHIC CHALLENGES AND PROPERTY IMPACTS.

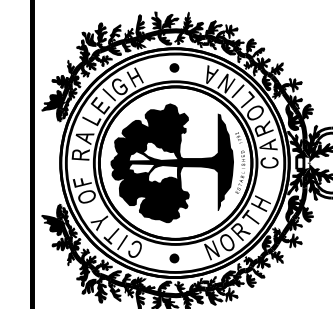
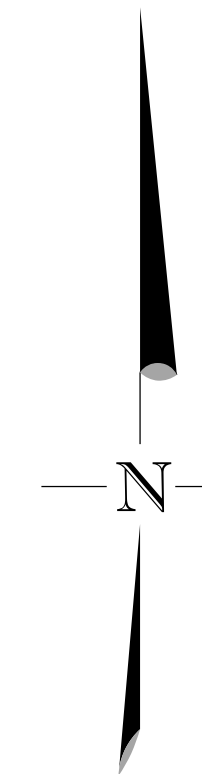

PRELIMINARY PLANS  
DO NOT USE FOR CONSTRUCTION  
PLANS REVIEW 25%

SIDEWALK  
PETITION SW 2019-08

KIMBERLY DRIVE  
FROM NORTH HILLS DRIVE  
TO GUNNISON PLACE

DATE: 07/02/2019

CADD TECH: AK

CHECKED BY:

REVISIONS

| NO. | DATE |
|-----|------|
|     |      |
|     |      |

SEE SHEET P2

MATCHLINE

EXISTING  
CURB & GUTTER  
AND SIDEWALK

EXISTING  
CURB & GUTTER  
AND SIDEWALK

NORTH HILLS DR

RAINTREE CT

KIMBERLY DR

50' RIGHT OF WAY

PROPOSED 6.00' SIDEWALK, 3.50' SETBACK

TYPICAL SIDEWALK SECTION  
(NOT TO SCALE)

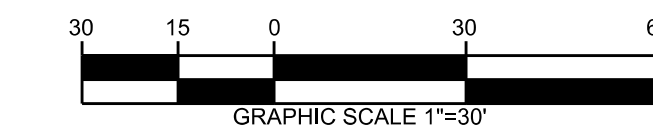
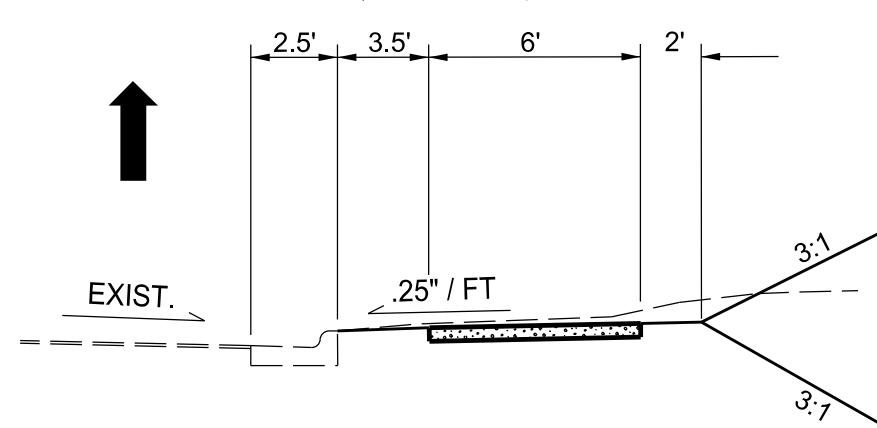

LEGEND

|  |     |
|--|-----|
| RIGHT OF WAY                                     | ——— |
| PROPERTY LINE                                    | ——— |
| EXISTING PAVEMENT                                | ——— |
| EXISTING CURB & GUTTER                           | ——— |
| PROPOSED CURB & GUTTER AND SIDEWALK IMPROVEMENTS | ——— |

- NOTE:
1. THIS MAP IS AN APPROXIMATION OF PROPOSED IMPROVEMENTS.
  2. THIS MAP IS NOT INTENDED TO BE USED FOR DESIGN. SIDEWALK WIDTH AND ALIGNMENTS MAY BE ADJUSTED DURING FINAL DESIGN TO AVOID MAJOR IMPACTS IN CERTAIN AREAS AS DETERMINED BY CITY ENGINEERING STAFF.
  3. ADDITIONAL EASEMENTS MAY BE NEEDED IN ORDER TO INSTALL THE IMPROVEMENTS AS PROPOSED.
  4. PLANIMETRICS ARE PER WAKE COUNTY GIS INFORMATION, NOT EXACT AND NOT FIELD VERIFIED.

P1

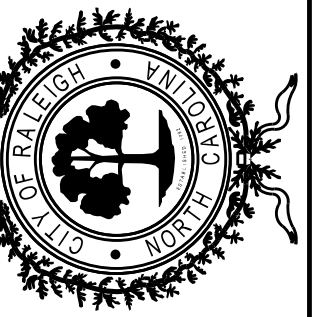

PRELIMINARY PLANS  
DO NOT USE FOR CONSTRUCTION  
PLANS REVIEW 25%

SIDEWALK  
PETITION SW 2019-08

KIMBERLY DRIVE  
FROM NORTH HILLS DRIVE  
TO GUNNISON PLACE

DATE: 07/02/2019

CADD TECH: AK

CHECKED BY:

REVISIONS

| NO. | DATE |
|-----|------|
|     |      |
|     |      |
|     |      |

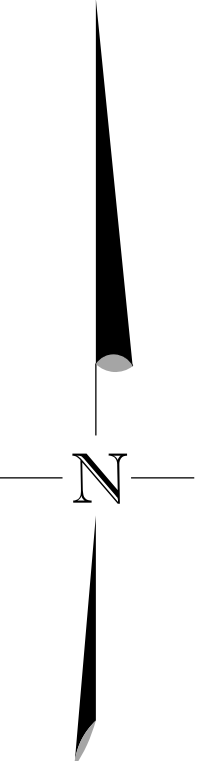

\* THE FOLLOWING PROPERTIES MAY HAVE THE SETBACK REDUCED AT THE ENGINEER'S DISCRETION DURING DESIGN TO ACCOMMODATE SEVERE TOPOGRAPHIC CHALLENGES AND PROPERTY IMPACTS.

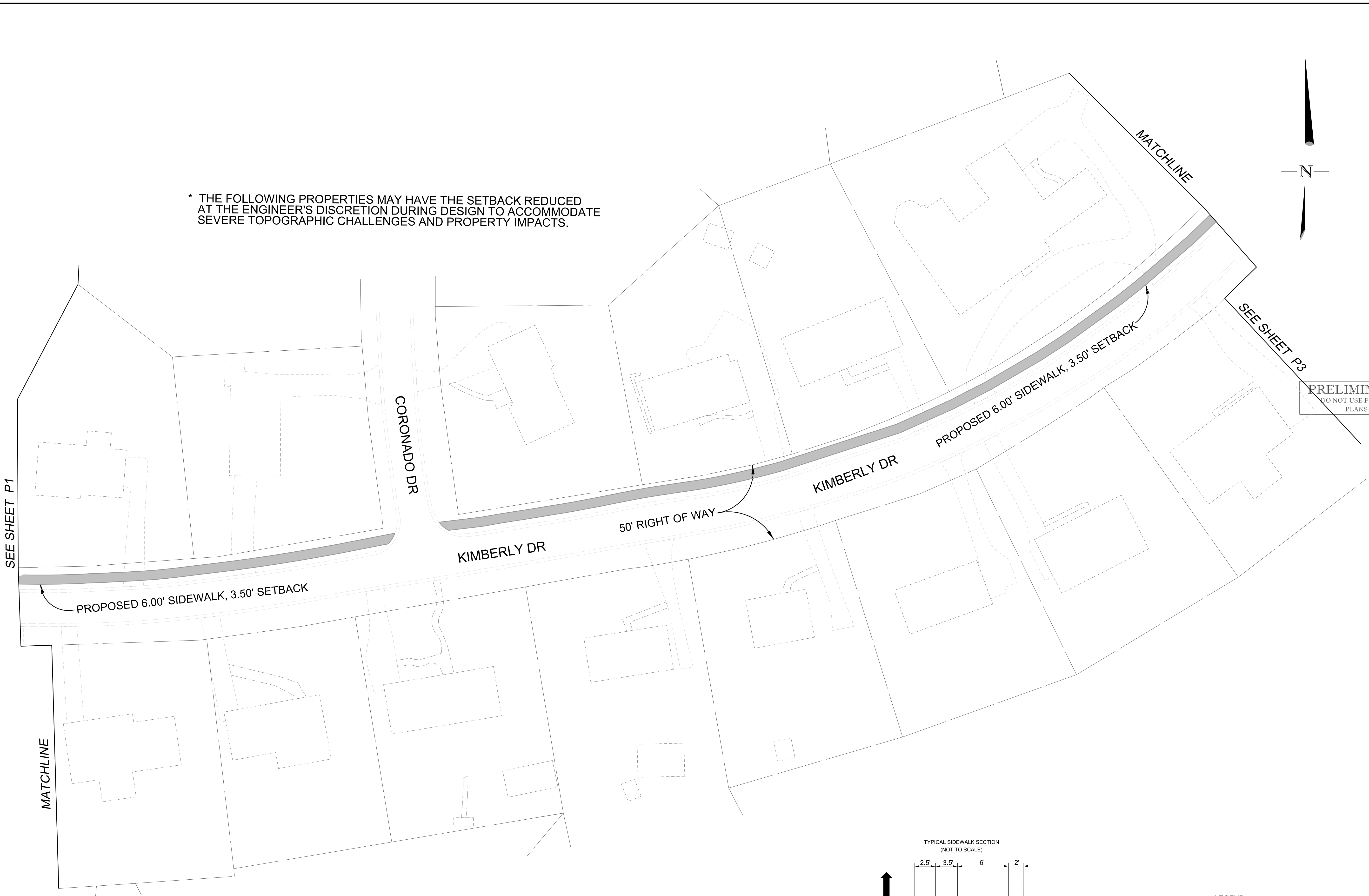

SEE SHEET P1

SEE SHEET P3

MATCHLINE

MATCHLINE

- NOTE:
- THIS MAP IS AN APPROXIMATION OF PROPOSED IMPROVEMENTS.
  - THIS MAP IS NOT INTENDED TO BE USED FOR DESIGN. SIDEWALK WIDTH AND ALIGNMENTS MAY BE ADJUSTED DURING FINAL DESIGN TO AVOID MAJOR IMPACTS IN CERTAIN AREAS AS DETERMINED BY CITY ENGINEERING STAFF.
  - ADDITIONAL EASEMENTS MAY BE NEEDED IN ORDER TO INSTALL THE IMPROVEMENTS AS PROPOSED.
  - PLANIMETRICS ARE PER WAKE COUNTY GIS INFORMATION, NOT EXACT AND NOT FIELD VERIFIED.

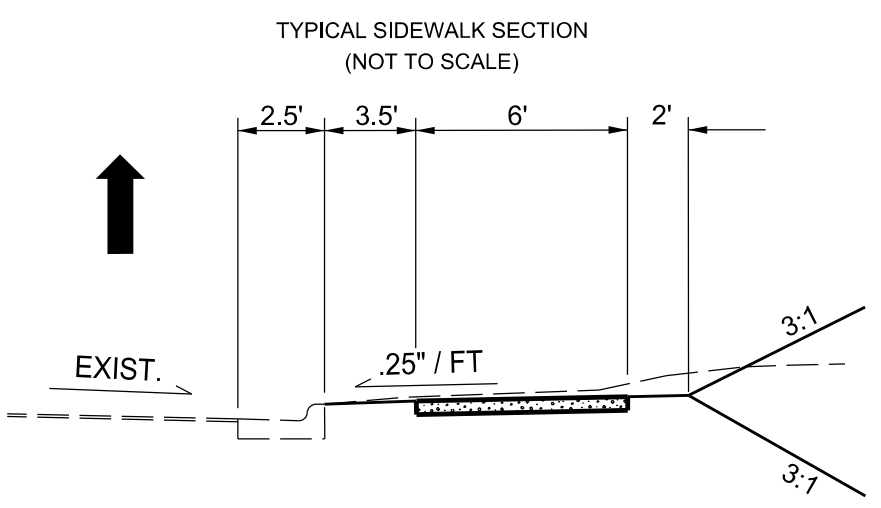

LEGEND

|  |       |
|--|-------|
| RIGHT OF WAY                                     | ———   |
| PROPERTY LINE                                    | ----- |
| EXISTING PAVEMENT                                | ----- |
| EXISTING CURB & GUTTER                           | ----- |
| PROPOSED CURB & GUTTER AND SIDEWALK IMPROVEMENTS | ===== |

\* THE FOLLOWING PROPERTIES MAY HAVE THE SETBACK REDUCED AT THE ENGINEER'S DISCRETION DURING DESIGN TO ACCOMMODATE SEVERE TOPOGRAPHIC CHALLENGES AND PROPERTY IMPACTS.

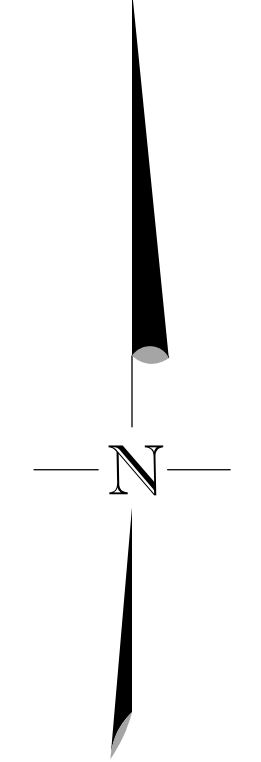
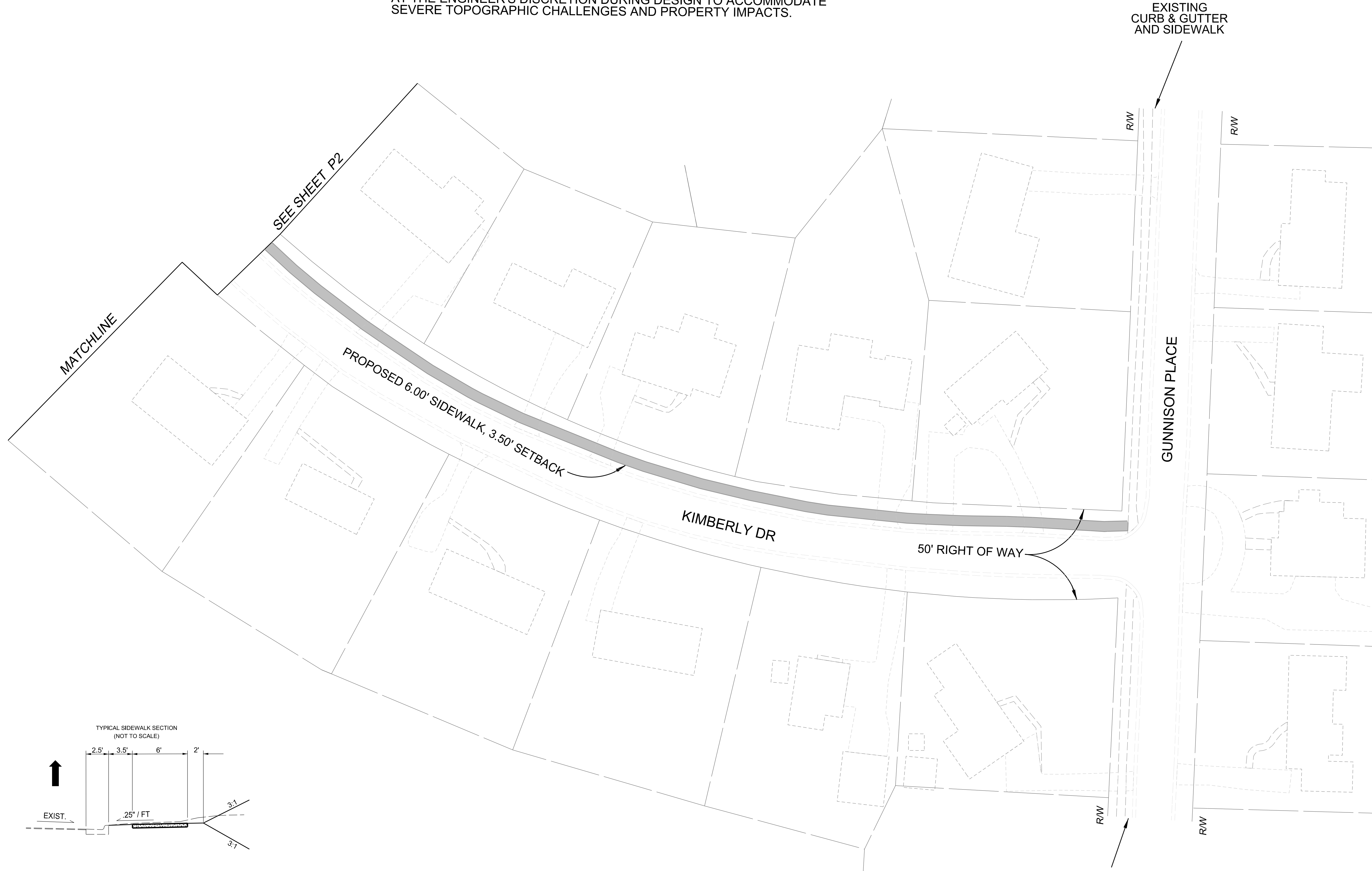

CITY OF RALEIGH  
ENGINEERING SERVICES  
DEPARTMENT



PRELIMINARY PLANS  
DO NOT USE FOR CONSTRUCTION  
PLANS REVIEW 25%

SIDEWALK  
PETITION SW 2019-08

KIMBERLY DRIVE  
FROM NORTH HILLS DRIVE  
TO GUNNISON PLACE

DATE: 07/02/2019

CADD TECH: AK

CHECKED BY:

REVISIONS

| NO. | DATE |
|-----|------|
|     |      |
|     |      |

SCALES

HSCALE 1" = 30'

VSCALE N/A

SHEET NO.

P3

SHEET 3 OF 3

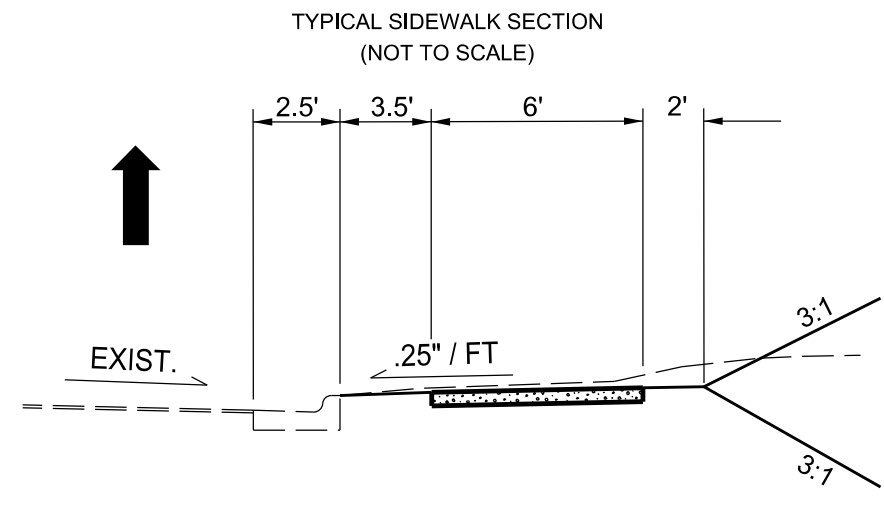

- NOTE:
1. THIS MAP IS AN APPROXIMATION OF PROPOSED IMPROVEMENTS.
  2. THIS MAP IS NOT INTENDED TO BE USED FOR DESIGN. SIDEWALK WIDTH AND ALIGNMENTS MAY BE ADJUSTED DURING FINAL DESIGN TO AVOID MAJOR IMPACTS IN CERTAIN AREAS AS DETERMINED BY CITY ENGINEERING STAFF.
  3. ADDITIONAL EASEMENTS MAY BE NEEDED IN ORDER TO INSTALL THE IMPROVEMENTS AS PROPOSED.
  4. PLANIMETRICS ARE PER WAKE COUNTY GIS INFORMATION, NOT EXACT AND NOT FIELD VERIFIED.

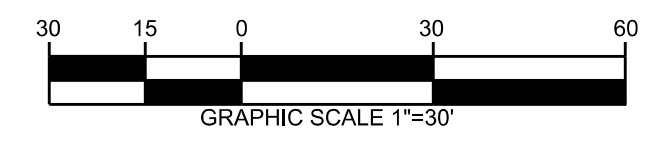

LEGEND

|  |     |
|--|-----|
| RIGHT OF WAY                                     | ——— |
| PROPERTY LINE                                    | ——— |
| EXISTING PAVEMENT                                | ——— |
| EXISTING CURB & GUTTER                           | ——— |
| PROPOSED CURB & GUTTER AND SIDEWALK IMPROVEMENTS | ——— |