

VICINITY MAP (NOT TO SCALE)

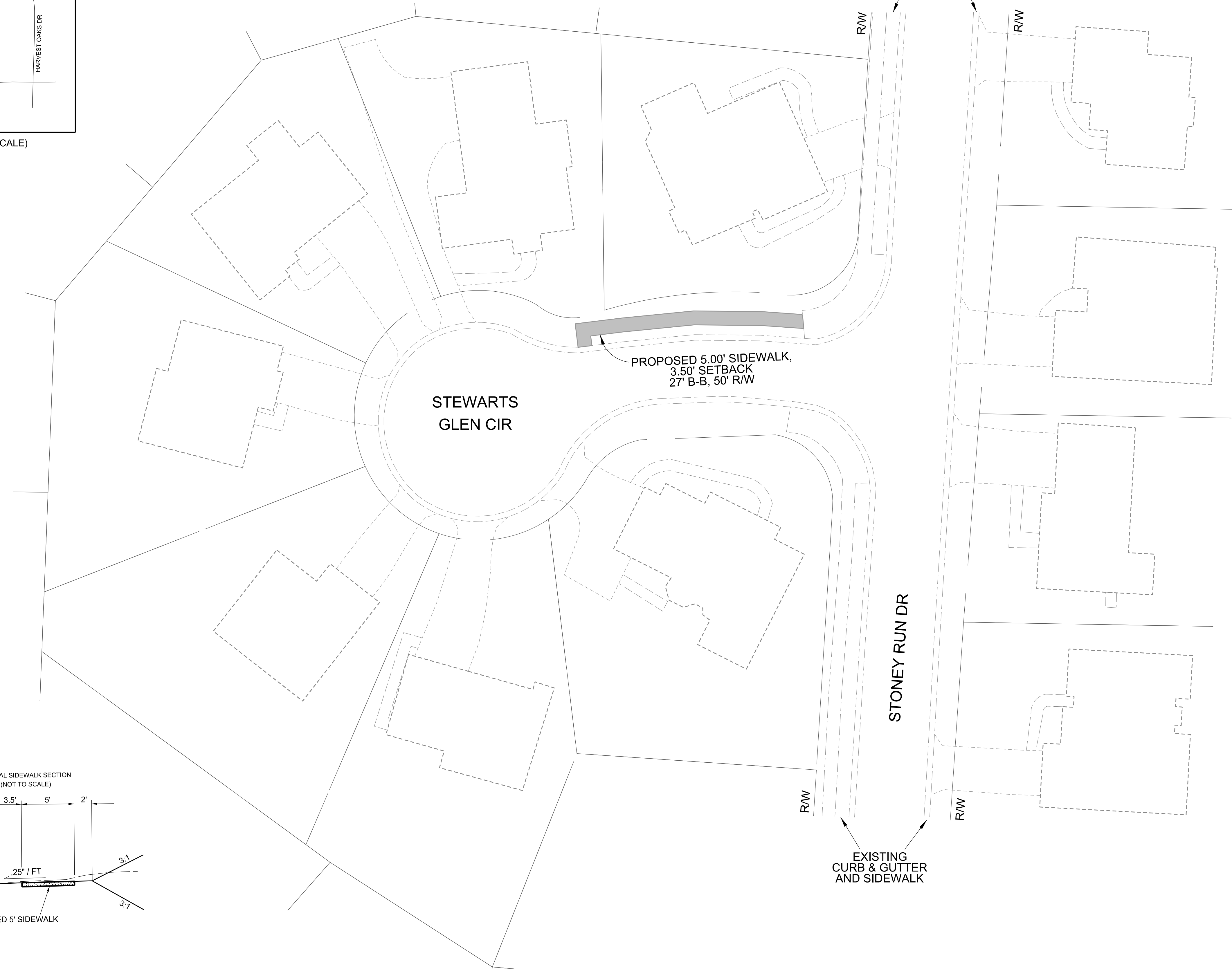

PROPOSED 5.00' SIDEWALK,  
3.50' SETBACK  
27' B-B, 50' R/W

STEWARTS  
GLEN CIR

STONEY RUN DR

EXISTING  
CURB & GUTTER  
AND SIDEWALK

EXISTING  
CURB & GUTTER  
AND SIDEWALK

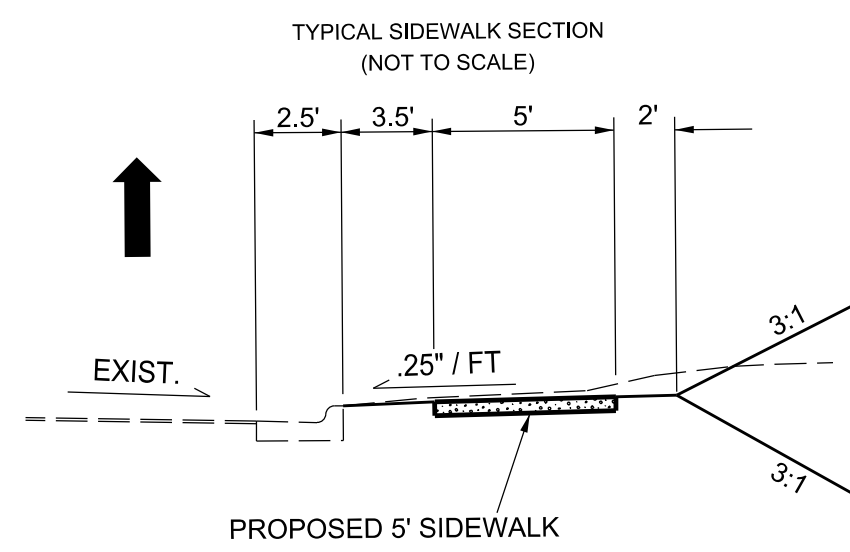

TYPICAL SIDEWALK SECTION  
(NOT TO SCALE)

↑  
EXIST.

PROPOSED 5' SIDEWALK

1. THIS MAP IS AN APPROXIMATION OF PROPOSED IMPROVEMENTS.
2. THIS MAP IS NOT INTENDED TO BE USED FOR DESIGN.
3. ADDITIONAL EASEMENTS MAY BE NEEDED IN ORDER TO INSTALL THE IMPROVEMENTS AS PROPOSED.
4. PLANIMETRICS ARE PER WAKE COUNTY GIS INFORMATION, NOT EXACT AND NOT FIELD VERIFIED.

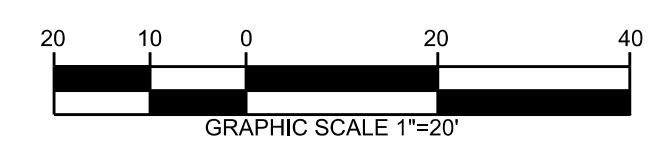

LEGEND

PROPOSED IMPROVEMENTS	
EXISTING CURB & GUTTER	
EXISTING SIDEWALK	
EXISTING PROPERTY	
EXISTING RIGHT OF WAY	

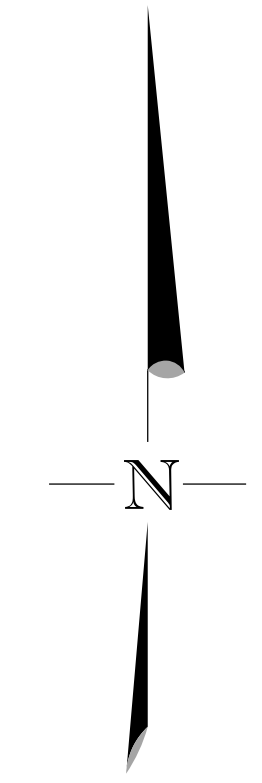

CITY OF RALEIGH  
ENGINEERING SERVICES  
DEPARTMENT



SIDEWALK  
PETITION SW 2018-11

STEWART GLEN CIR  
FROM EXISTING ON STONEY RUN DR  
TO BEGINNING OF CUL-DE-SAC

DATE: OCTOBER, 2018

CADD TECH: WDP

CHECKED BY:

REVISIONS

NO.	DATE

SCALES

HSCALE 1" = 20'

VSCALE N/A

SHEET NO.

PET1