

** 2.08% (1:48) max

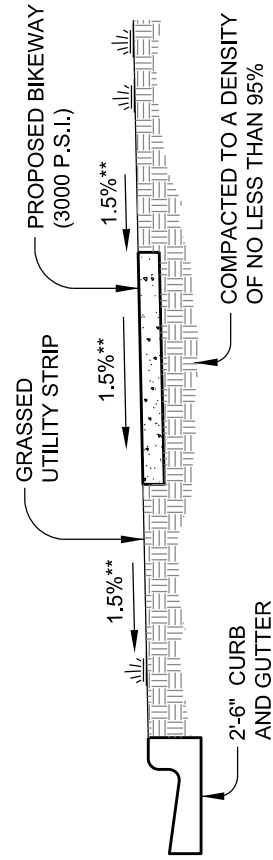

TYPICAL SECTION

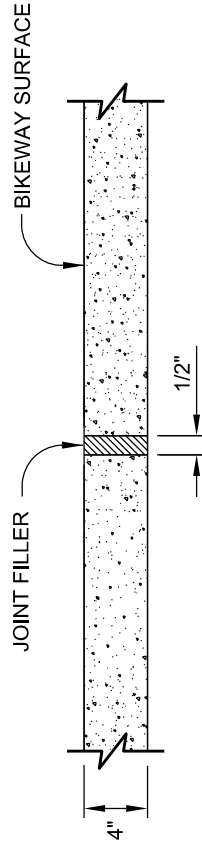

TRANSVERSE EXPANSION JOINT

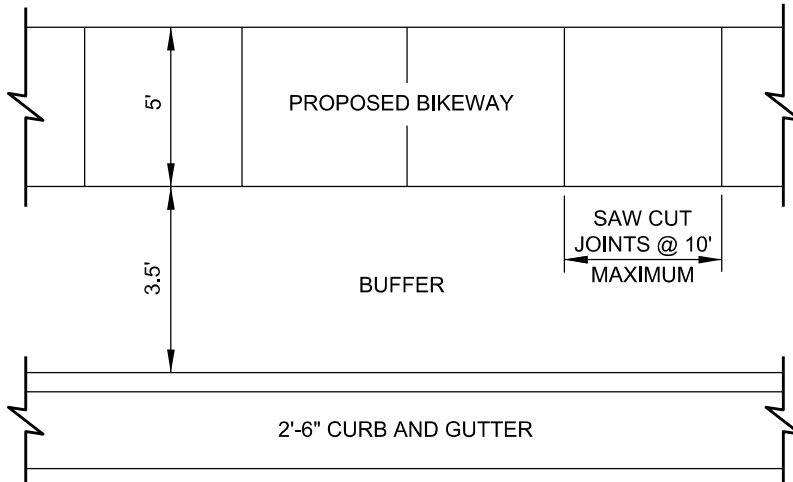

PLAN VIEW

NOTES:

1. TRANSVERSE EXPANSION JOINTS TO BE A MAXIMUM OF 50 FEET.
2. ALL CONCRETE TO BE 3000 PSI AND FINISHED WITH CURING COMPOUND.
3. A 6 INCH DEPTH IS REQUIRED AT LOCATIONS OF DRIVEWAY CORSSINGS, AT STREET INTERSECTIONS (ALONG THE LENGTH OF RADIUS CURB RETURNS) AND IN THE HANDICAP RAMPS.
4. BIKEWAY MATERIAL SHALL BE INTEGRALLY COLORED CONCRETE, COLORED BLACK, USING NON-FADING PIGMENTS.
5. CONTRACTOR SHALL SEAL ALL JOINTS. SEAL SHALL BE NON-SHRINKING AND FLUSH WITH FINISHED GRADE OF THE CONCRETE BIKEWAY.
6. JOINTS SHALL BE SAWCUT A MINIMUM OF 1/4 DEPTH, BUT NO MORE THAN 1/2 DEPTH.

CITY OF RALEIGH STANDARD DETAIL		
REVISIONS	DATE: 12/2022	NOT TO SCALE
	CONCRETE BIKEWAY	
	T-30.01.2	