

triangle . legal

2500 Regency Parkway, Suite 229, Cary, NC 27518

hayralah@triangle.legal

919-590-3647

Date: October 15, 2024

Re: Potential rezoning at 5428, 5426, 5422, 5420, 5418, 5416, 5414, 5412, and 0 Louisburg Rd, Parcels 1736055075; 1736056033; 1736046942; 1736047911; 1736047869; 1736048815; 1736048873; 1736049729; 1736049766; and 1736140712.

Neighboring Property Owners and Tenants:

You are invited to attend a neighborhood meeting on November 6, 2024 at 6:00 pm. The meeting will be held at Marsh Creek Community Center located at 3050 N New Hope Rd, Raleigh, NC 27604 and will begin at 6 p.m.

The purpose of this meeting is to discuss a potential rezoning of the property located near Louisburg Rd and Razan St. The enclosed maps show the location and current base zoning of the Property and surrounding parcels. This site is currently zoned R1 and is proposed to be rezoned to R10.

Prior to the submittal of any rezoning application, the City of Raleigh requires that a neighborhood meeting be held for all property owners and tenants within 500 feet of the area requested for rezoning.

Information about the rezoning process is available online; visit www.raleighnc.gov and search for "Rezoning Process." If you have further questions about the rezoning process, please contact Metra Sheshbaradaran at Raleigh Planning & Development at 919-996-2638 or metra.sheshbaradaran@raleighnc.gov.

If you have any concerns or questions about this potential rezoning I can be reached at: Hay'ralah Alghorazi, 919-590-3647, hayralah@triangle.legal.

Sincerely,

Hay'ralah Alghorazi

triangle . legal

2500 Regency Parkway, Suite 229, Cary, NC 27518

hayralah@triangle.legal

919-590-3647

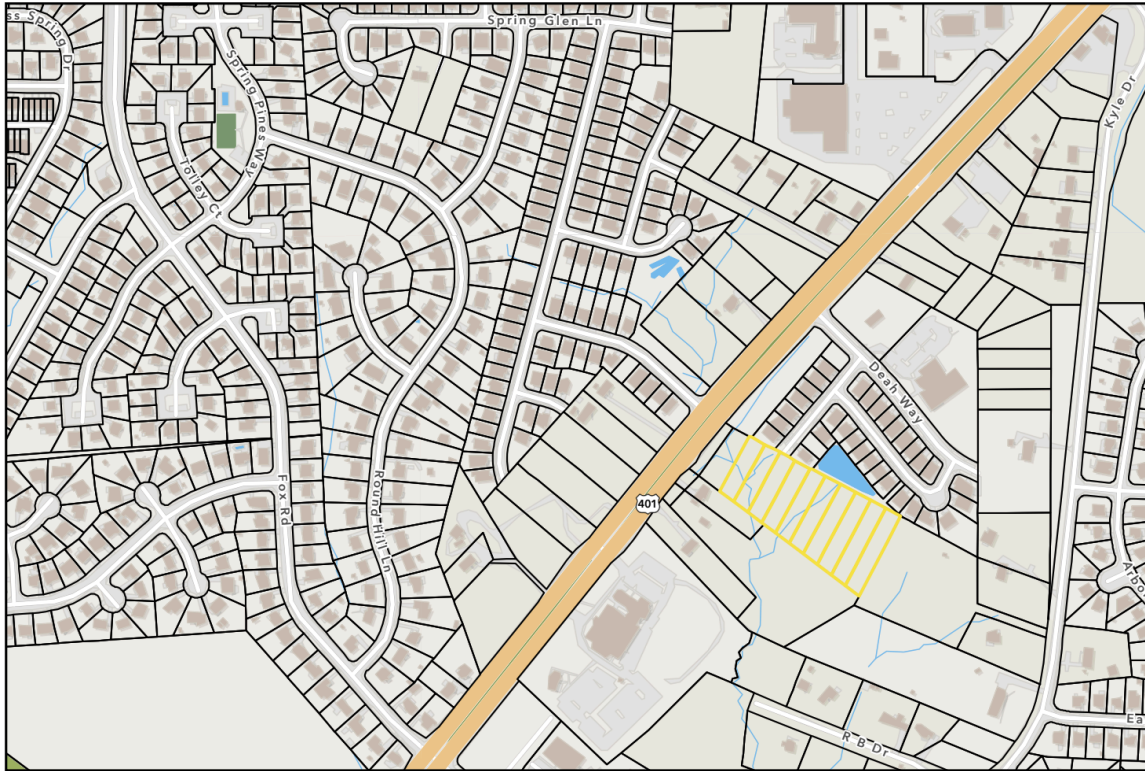

Attachment to Rezoning letter 1



0 200 400 800 ft
1 inch equals 400 feet

Disclaimer
iMaps makes every effort to produce and publish the most current and accurate information possible. However, the maps are produced for information purposes, and are NOT surveys. No warranties, expressed or implied, are provided for the data therein, its use, or its interpretation.

triangle . legal

2500 Regency Parkway, Suite 229, Cary, NC 27518

hayralah@triangle.legal

919-590-3647

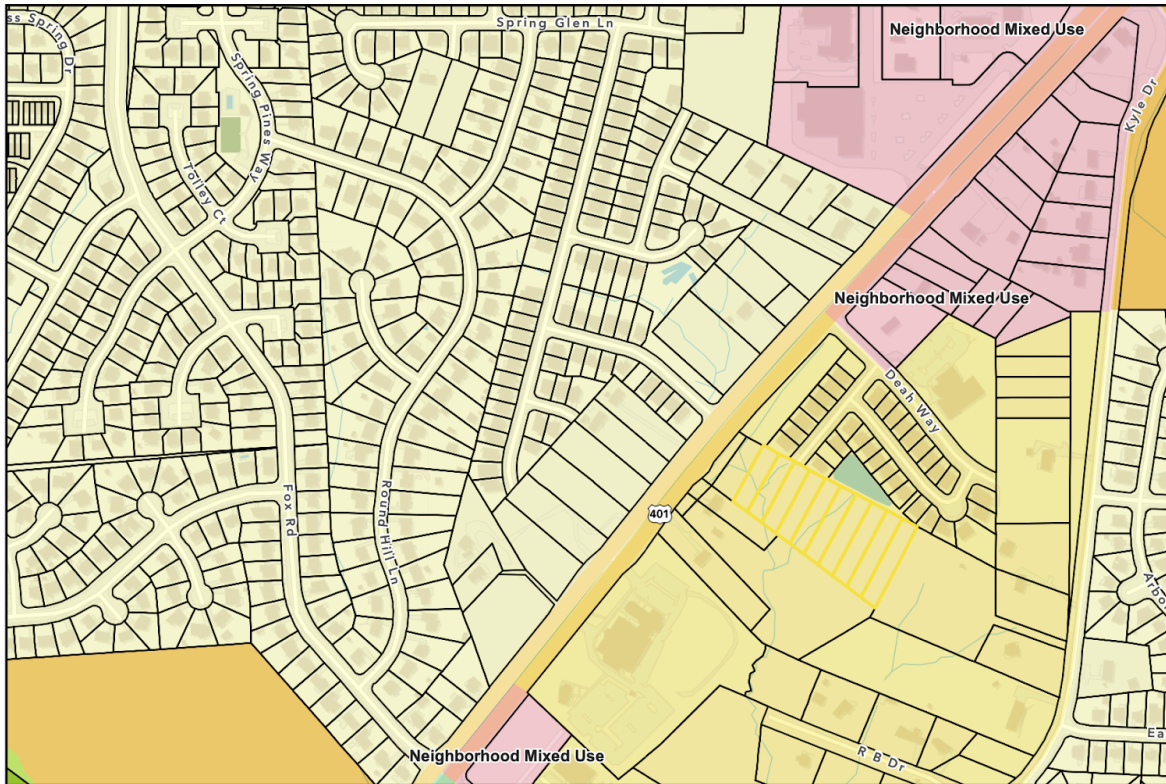

Attachment to Rezoning letter 3

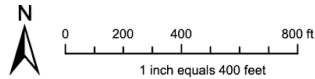

Disclaimer
iMaps makes every effort to produce and publish the most current and accurate information possible. However, the maps are produced for information purposes, and are NOT surveys. No warranties, expressed or implied, are provided for the data therein, its use, or its interpretation.