

Parks, Recreation, and
Cultural Resources

John Chavis Memorial Park Ph. 2

John P. Top Greene

South Park Heritage Trail

Schematic and Concept Designs

City Council

December 3, 2024



Raleigh



Agenda

- Project Overview
- Community Engagement Summary
- Schematic and Conceptual Design Review
- Estimated Implementation Schedule
- Questions

Project Overview – John Chavis Aquatics Center

Project Scope:

- New aquatic center with indoor and outdoors facilities for recreation, competition, and wellness opportunities
- Reconfigured new parking areas.
- Heritage Plaza improvement with additional historic interpretive displays.

Bond Budget: \$53,950,000 Total Project Budget

Public Art: \$100,000

Project Overview – John P. Top Greene African American Cultural Center

Project Scope:

- Renovation of the Community Center
- Building Expansion
- Site Stormwater Improvements
- Trailhead to South Park Heritage Trail

Bond Budget: \$9,295,000

Public Art: \$220,000 (for both SPHT and JPTG)

Project Overview – South Park Heritage Trail

Project Scope:

- Two-mile-long cultural trail in Southeast Raleigh
- Cultural and historical interpretation
- Wayfinding and signage
- Streetscape and accessibility enhancements

Bond Budget: \$3,000,000

Grant Funding: \$1,500,000 HUD

Public Art: \$220,000 (for both SPHT and JPTG)

Community Engagement for all 3 projects

November 2023: Community Advisory Group(CAG) approved by City Council

Feb. 2024 – Oct. 2024: 6 Joint CAG meetings

June 2024 – Oct. 2024: 4 Public Open Houses

June 2024 – Oct. 2024: 3 Focus group and stakeholder meetings

Future Engagement Opportunities:

- Boards, Commissions and Council reviews



**John Chavis Memorial Park Phase II
Aquatic Center and Heritage Plaza**









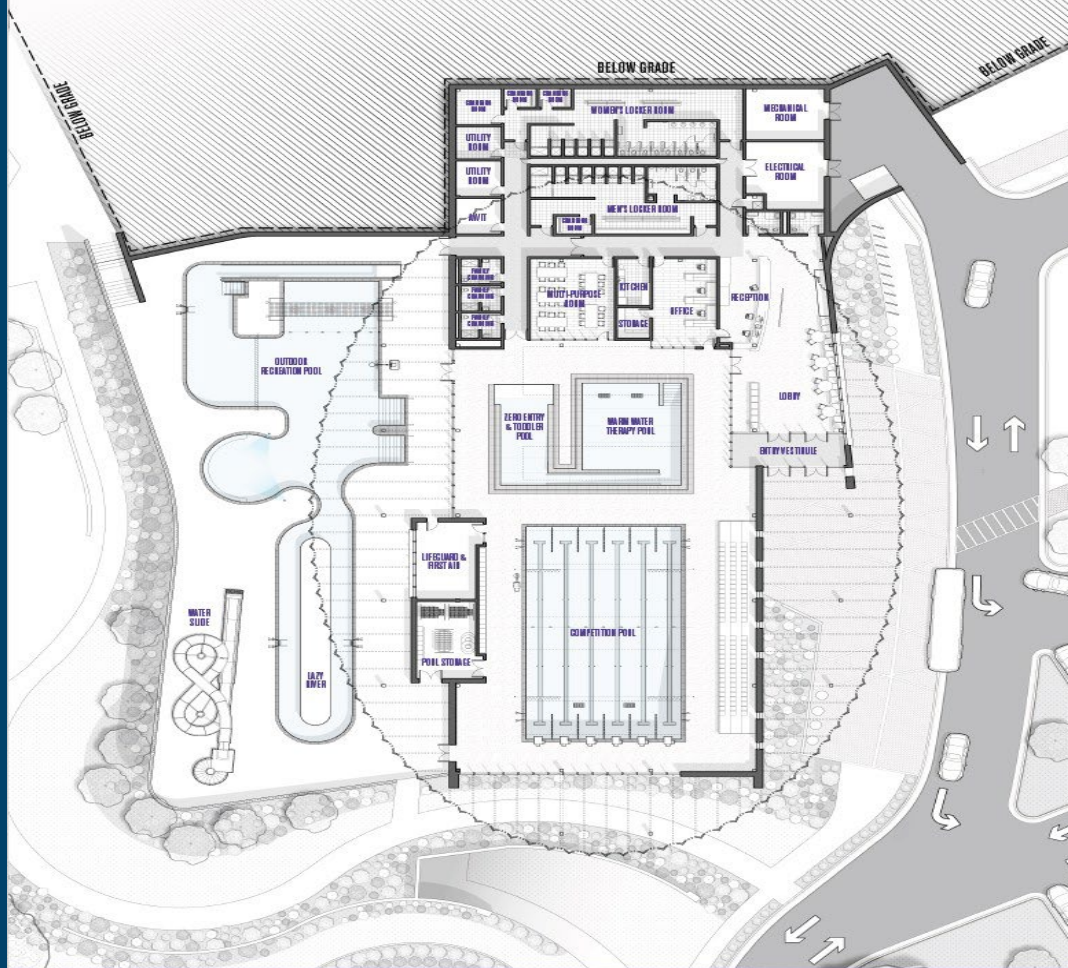

AQUATICS CENTER FLOOR PLAN

0 16 32





**John P. Top Greene African American
Cultural Center**

PLAN DEVELOPMENT

INTEGRATED INFLUENCE

CURRENT CONDITIONS



PREFERRED CONCEPT PLAN 07/2024



NCSU & SPERNA PROPOSAL 2014



DRAFT SCHEMATIC PLAN 08/2024

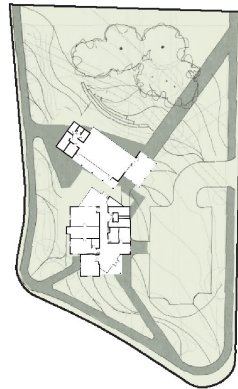

SCHEMATIC DESIGN PLAN 09/2024



PLAN DEVELOPMENT

INTEGRATED INFLUENCE



NEW EXTENSION FROM CAPE AVE. LOOKING SOUTHWEST



COMMUNITY ROOM INTERIOR LOOKING SOUTHEAST



COURTYARD FROM BLOODWORTH LOOKING SOUTHEAST



COMMUNITY CENTER FROM MLK JR BLVD LOOKING NORTHWEST



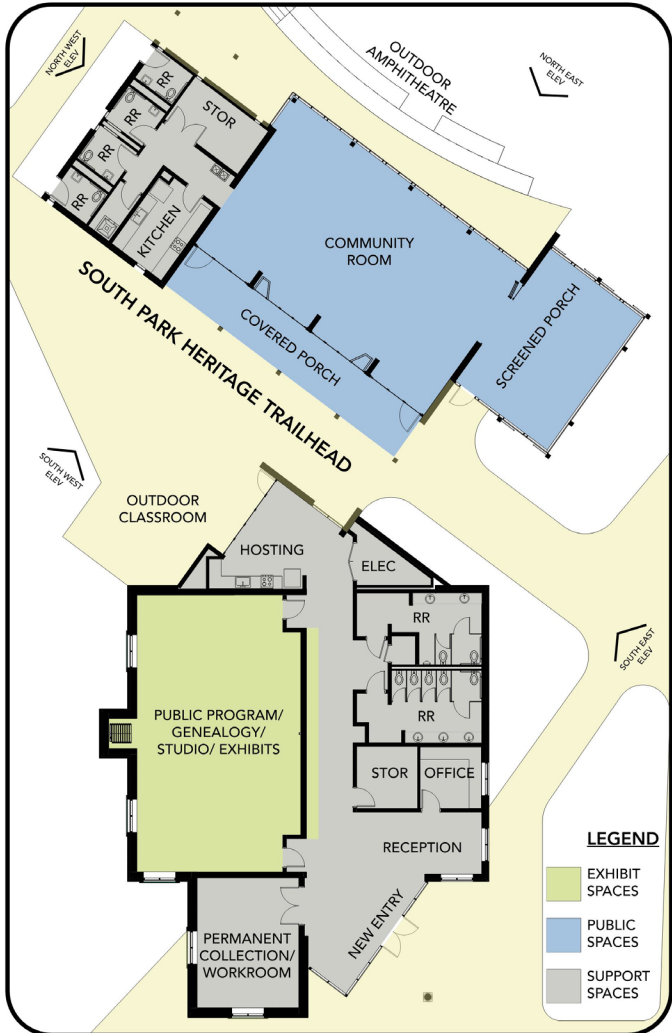

SCHEMATIC DESIGN PLAN 10/2024

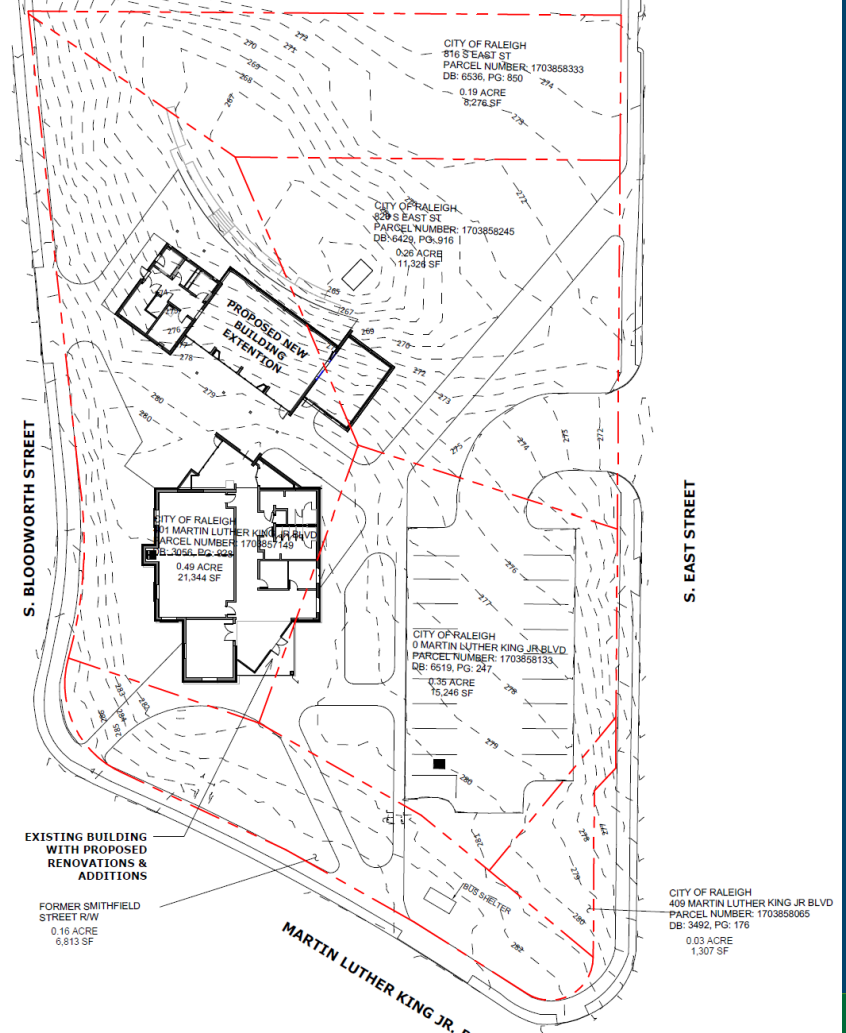

South Park Heritage Trail

SOUTH PARK HERITAGE TRAIL

Purpose

A heritage trail is a collection of features within the streetscape and other public spaces which may include interpretive elements, art, and signage that tell the area's history from the perspective of its residents. For South Park Heritage Trail, such features and improvements will only happen on public land.

Goals

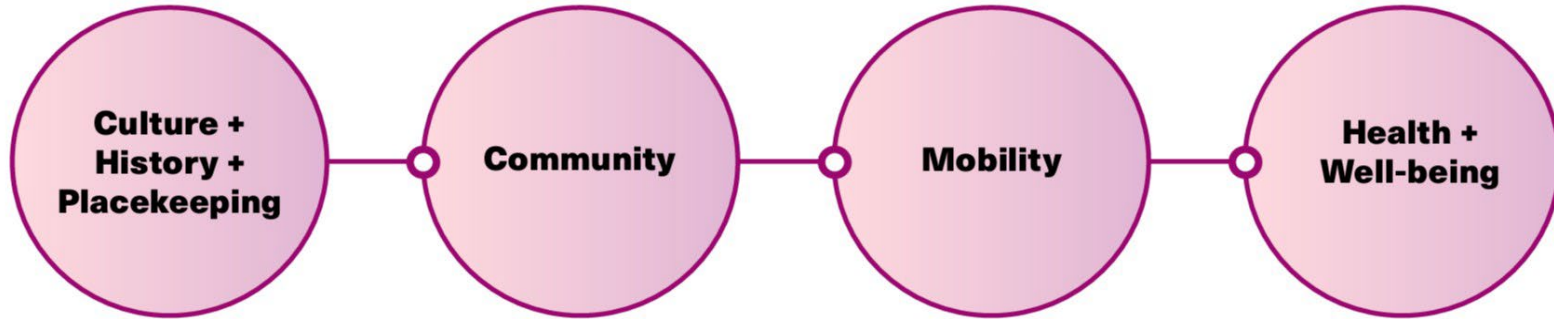

Celebrate culture, history and legacy and promote community pride.

Strengthen community relationships, capacity and resources.

Enhance mobility, connectivity and safety for cyclists and pedestrians.

Promote healthy living and increase access to high quality public spaces.

PROPOSED ROUTE & STORYTELLING THEMES

Arts + Entertainment

Black Entrepreneurship

Builders + Architects

Civil Rights + Civic Leadership

Community Leaders + Legacy

Cultural + Intellectual Hub

Gateway to Raleigh

Health + Well-Being

Leisure + Recreation

Style + Image

Legend

— Proposed Route

- - - Bus Rapid Transit (BRT) Route

● Proposed Storytelling Beacons

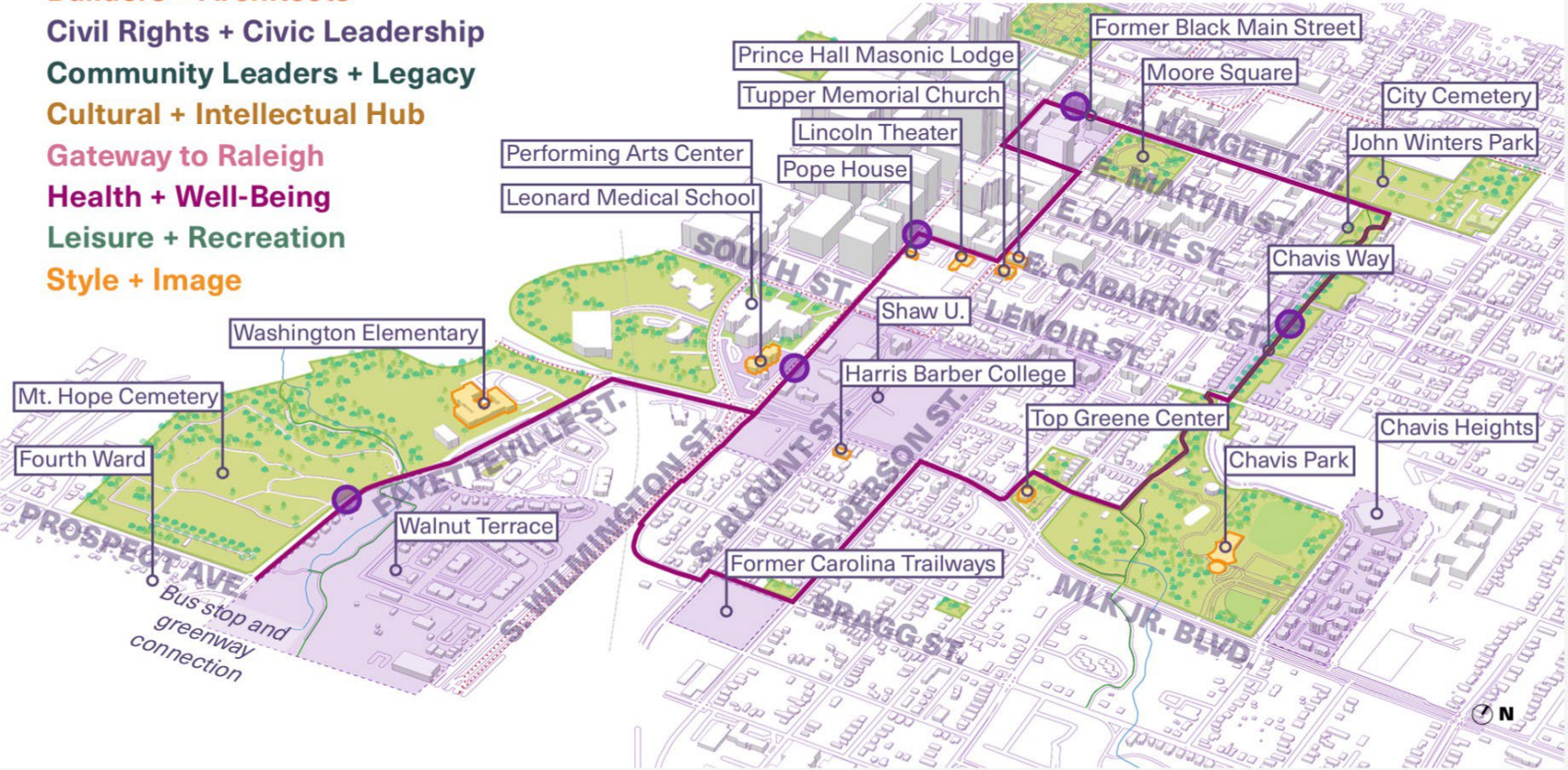

HOW WILL STORIES BE TOLD?

Signage Type 1 - Linear Ground Marker

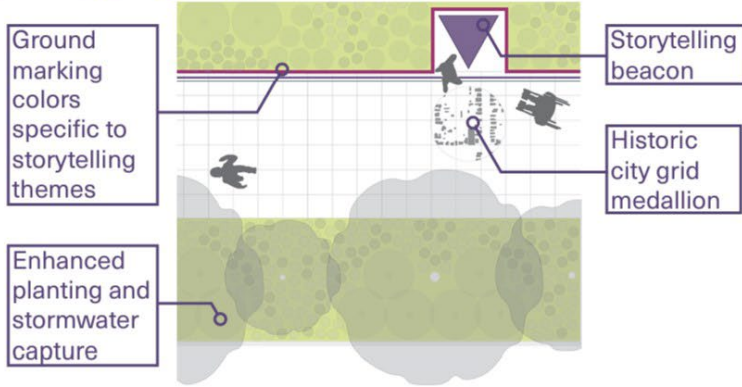

Signage Type 2 - Decision Point Signage

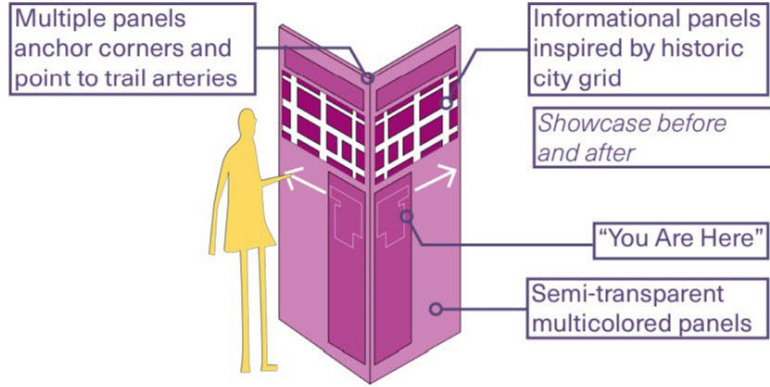

Signage Type 3 - Spur Signage

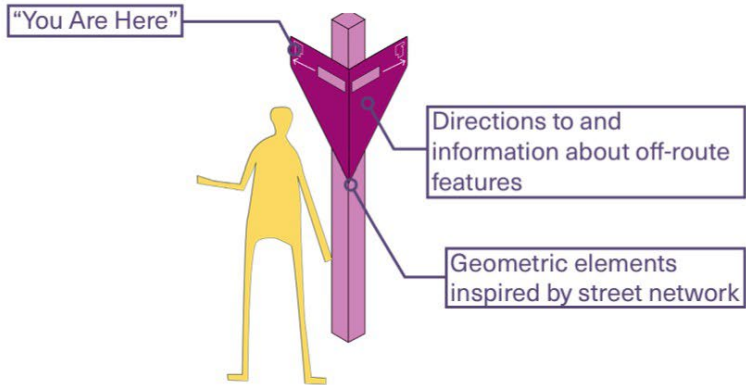

Signage Type 4 - Medallion

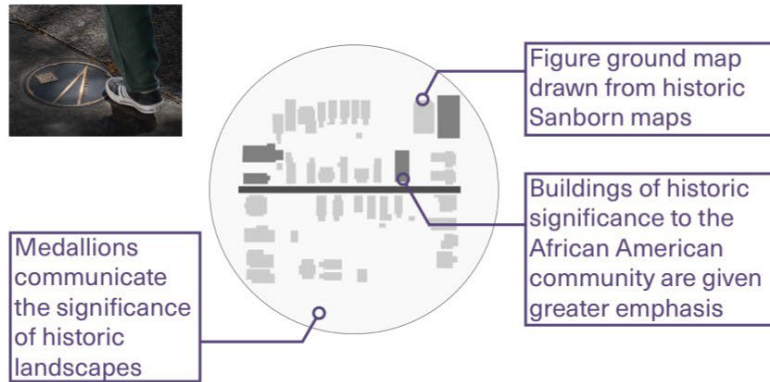

INTERPRETIVE ELEMENTS



A tall, narrow, purple-outlined structure with a decorative, geometric top section. It contains two inset images: the top one shows the interior of a building, and the bottom one shows the exterior of a building with the name 'HAMLIN' visible.

Primary
Storytelling Beacon



A purple, L-shaped bench with white text. The text reads: "Dr. Chris Hunt's office was upstairs in the Hamlin Drug building. The building was co-owned by Clarence Coleman".

Secondary
Storytelling Bench

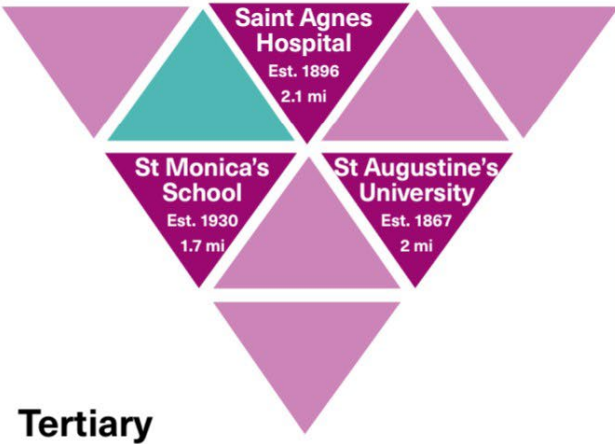

A purple triangular graphic divided into four smaller triangles. The top triangle is teal and contains the text: "Saint Agnes Hospital Est. 1896 2.1 mi". The bottom-left triangle is purple and contains: "St Monica's School Est. 1930 1.7 mi". The bottom-right triangle is purple and contains: "St Augustine's University Est. 1867 2 mi".

Tertiary
Spur Sidewalk Painting



Six horizontal bars of varying colors (teal, purple, brown, dark purple, pink, light blue) with the text "SOUTH PARK HERITAGE TRAIL" in white.

Signage

WHAT WILL THE TRAIL LOOK LIKE?

WILMINGTON ST - COMMERCIAL CONDITION

SECTION LOOKING NORTH ON WILMINGTON STREET AT THE ENTRANCE OF STRONACH'S ALLEY

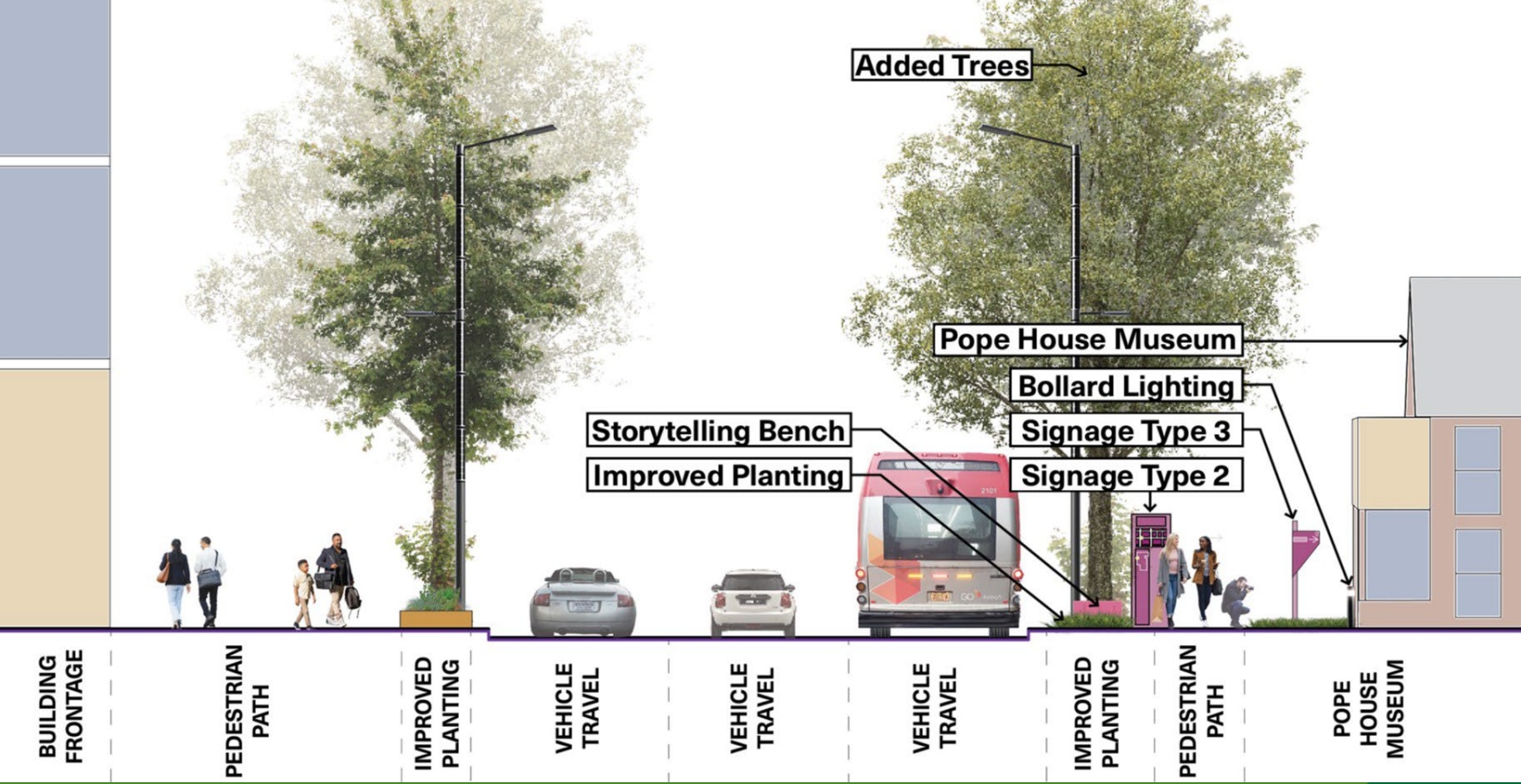

Estimated Schedule – John Chavis Aquatics

Design Development: Fall 2024 -Summer 2025

Construction Docs and Permitting: Summer 2025 – Spring 2026

Bidding and Contracts: Fall 2026 - Spring 2027

Construction: Spring 2027 - Fall 2029

Estimated Schedule – John P. Top Greene

Design Development: Fall 2024 -Spring 2025

Construction Docs and Permitting: Spring 2025 – Early 2026

Bidding and Contracts: Early 2026 - Late 2026

Construction: Late 2026 - Late 2027

Estimated Schedule – SPHT

Schematic Design: Fall 2024 -Summer 2025

Design Development: Summer 2025 – Late 2025

Construction Docs and Permitting: 2025 – 2026

Bidding and Contracts: 2026

Construction: 2026 -2027

**involves federal funding and may alter schedule*

Recommendations:

- Approve Concept Design for:
 - South Park Heritage Trail
- Approve Schematic Design for:
 - John Chavis Memorial Park Phase 2
 - John P. “Top” Greene African American Cultural Center
- Authorize for John P. “Top” Greene African American Cultural Ctr
 - To pursue the City’s quasi-judicial boards approval to facilitate the project implementation
 - To pursue a rezoning to remove the South Park Neighborhood Conservation Overlay District for the J. P. “Top” Greene Park area

Questions?