

1946 Aerial Photo courtesy of North Carolina State Archives

# JOHN CHAVIS MEMORIAL PARK

2017

**PUBLIC MEETING #1**

WEDNESDAY, JANUARY 25

1A: YOUTH INPUT SESSION 3:30-5pm

1B: GENERAL PUBLIC INPUT SESSION 6:30-7:30pm

**PUBLIC MEETING #2**

WEDNESDAY, FEBRUARY 15, 4-6pm

SCHEMATIC DESIGN REVIEW

**PUBLIC MEETING #3**

WEDNESDAY, MARCH 1, 4-7pm

**SCHEMATIC DESIGN LAUNCH + SOCIAL**

JAN

FEB

MAR

APR

**PARKS, RECREATION & GREENWAY  
ADVISORY BOARD**

THURSDAY, MARCH 16, 6pm

City Council Chambers

**SCHEMATIC DESIGN REVIEW**

**CITY COUNCIL**

TUESDAY, MARCH 21, 1pm

City Council Chambers

**SCHEMATIC DESIGN REVIEW + APPROVAL**

**PUBLIC INPUT SESSIONS**



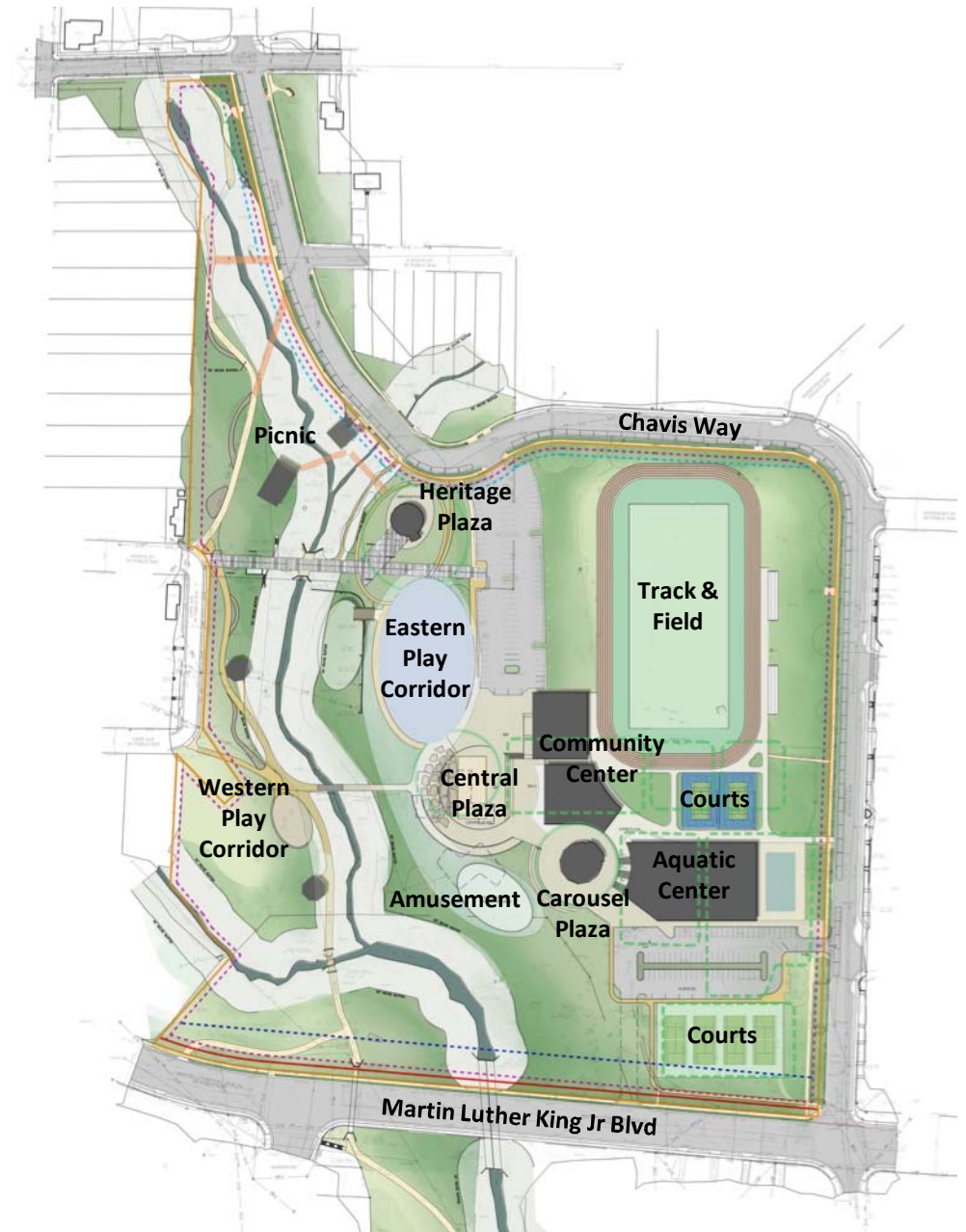

**MASTER PLAN**

**PLAN UPDATES**

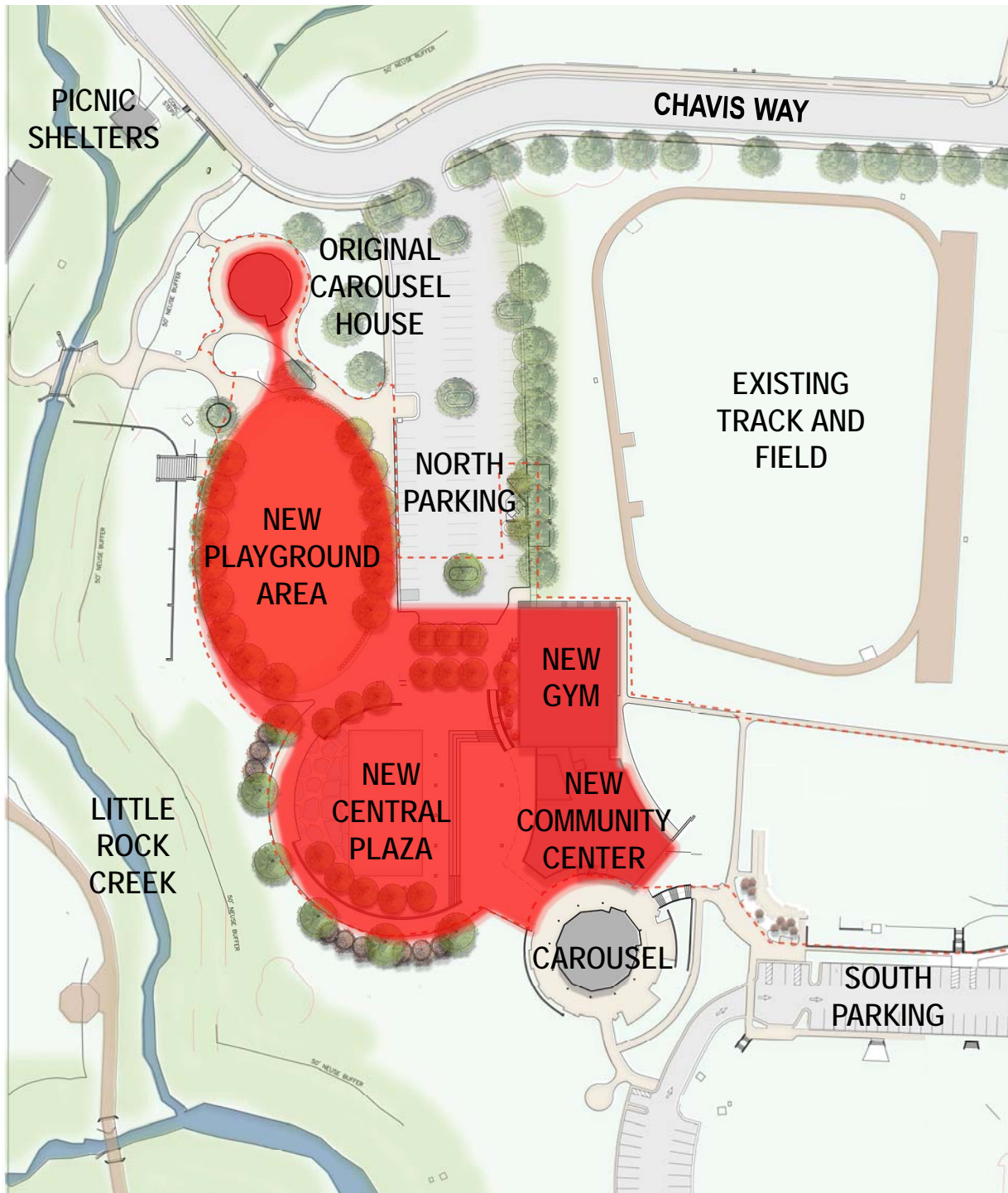

## Phase 1 *HEART OF THE PARK*

***NEW AND EXPANDED***  
COMMUNITY CENTER

***NEW*** MULTI-FUNCTIONAL  
CENTRAL PLAZA

***NEW AND EXPANDED***  
PLAYGROUND AREA

***RENOVATED*** ORIGINAL  
CAROUSEL HOUSE

# SITE PLAN



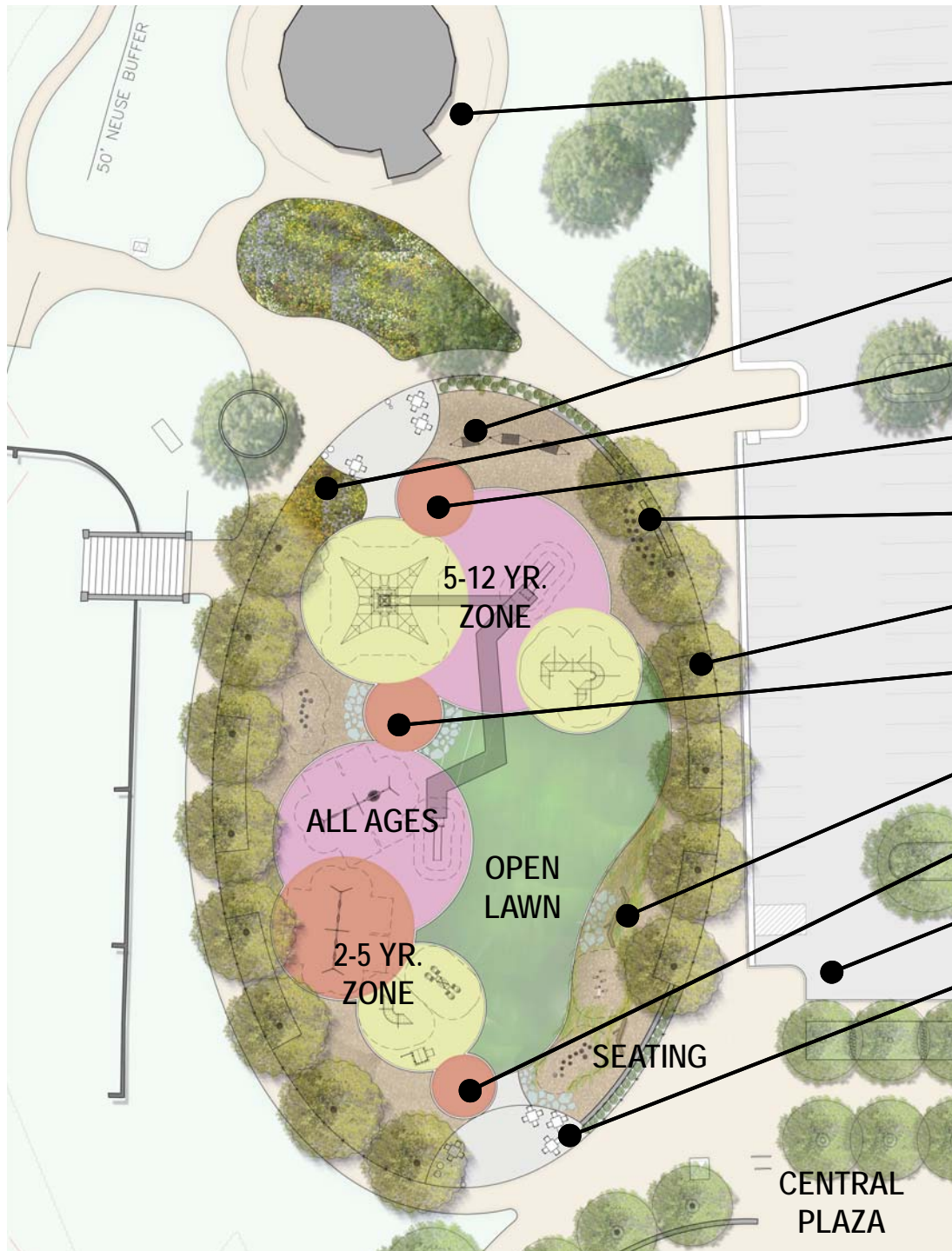

**SHADED SEATING, DRINKING  
FOUNTAIN, AND TRASH AT HERITAGE  
PLAZA**

**HAMMOCK FARM**

**AROMATIC GARDEN**

**INTERACTIVE OPPORTUNITIES**

**STORY CIRCLE**

**TREES IN WOOD DECKING**

**NATURAL PLAY AREA**

**NATURAL PLAY AREA**

**INTERPRETIVE OPPORTUNITIES**

**DROP OFF**

**SHADED TABLES/CHAIRS, DRINKING  
FOUNTAIN AND TRASH**

# **PLAYGROUND SITE PLAN**



WE-SAW



INFANT MAZE



NATURAL PLAY AREA



SEAT WALL



TREES IN WOOD DECKING



SKYWALK

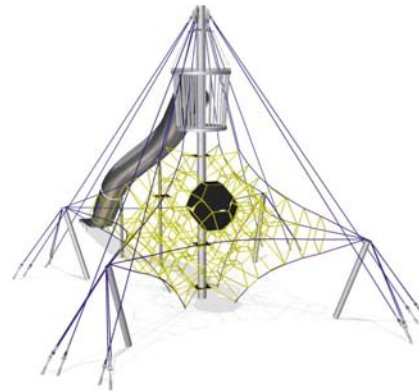

OCTA NET



MOBIUS CLIMBER



SWINGS



NATURAL PLAY AREA



MULCH



POURED IN PLACE RUBBER

# PLAYGROUND EQUIPMENT & SURFACES



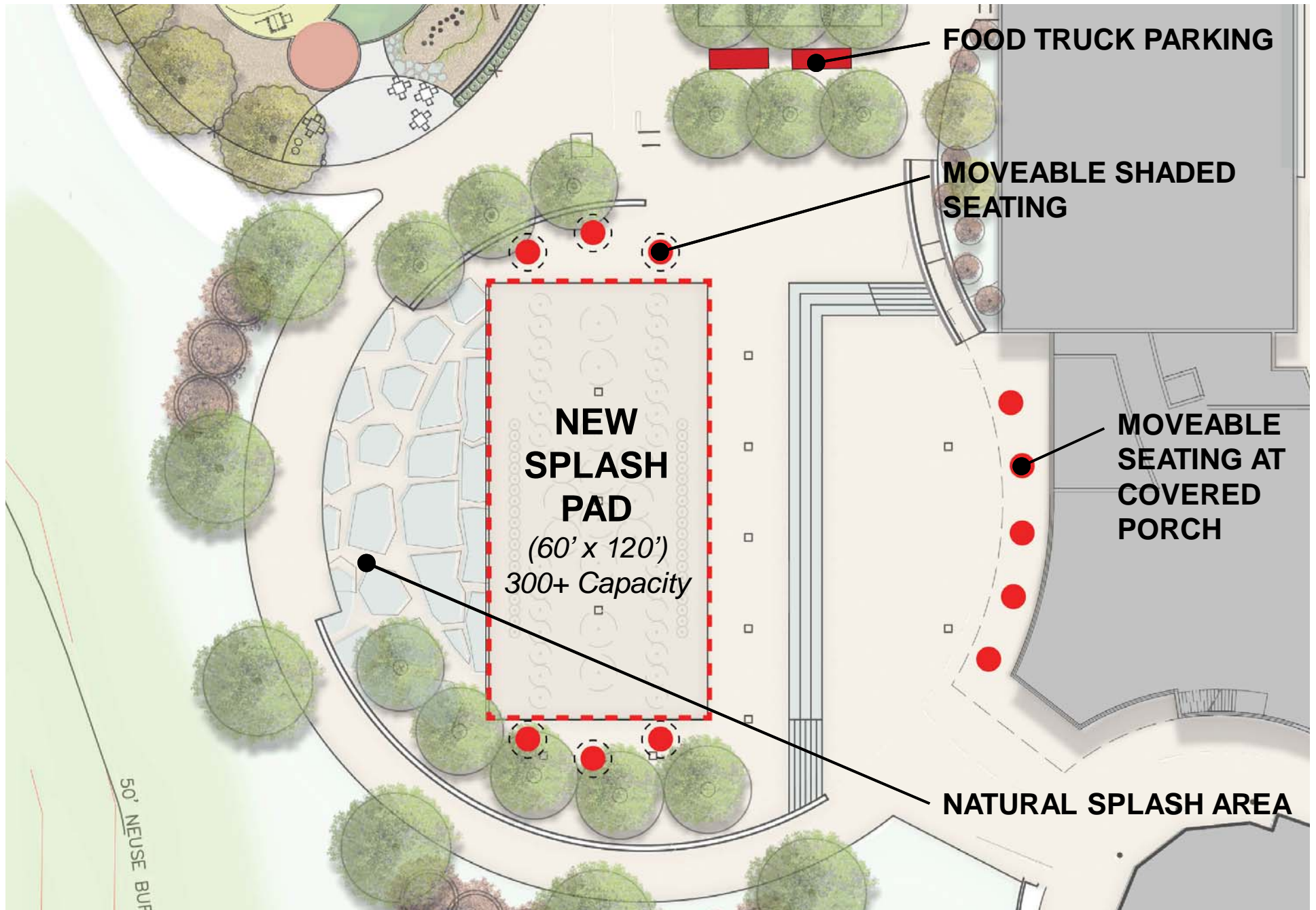

# CENTRAL PLAZA SITE PLAN

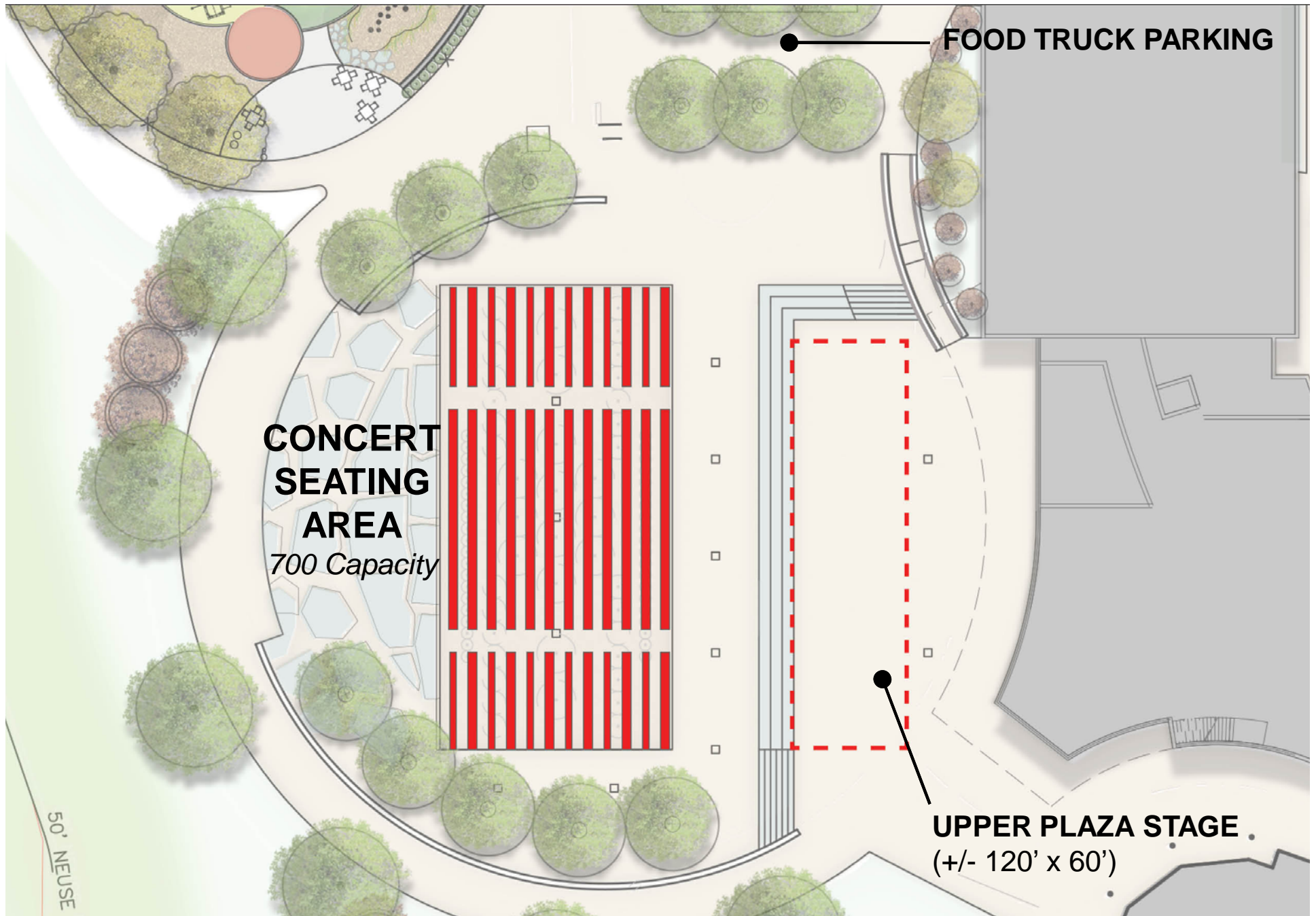

# CENTRAL PLAZA SITE PLAN



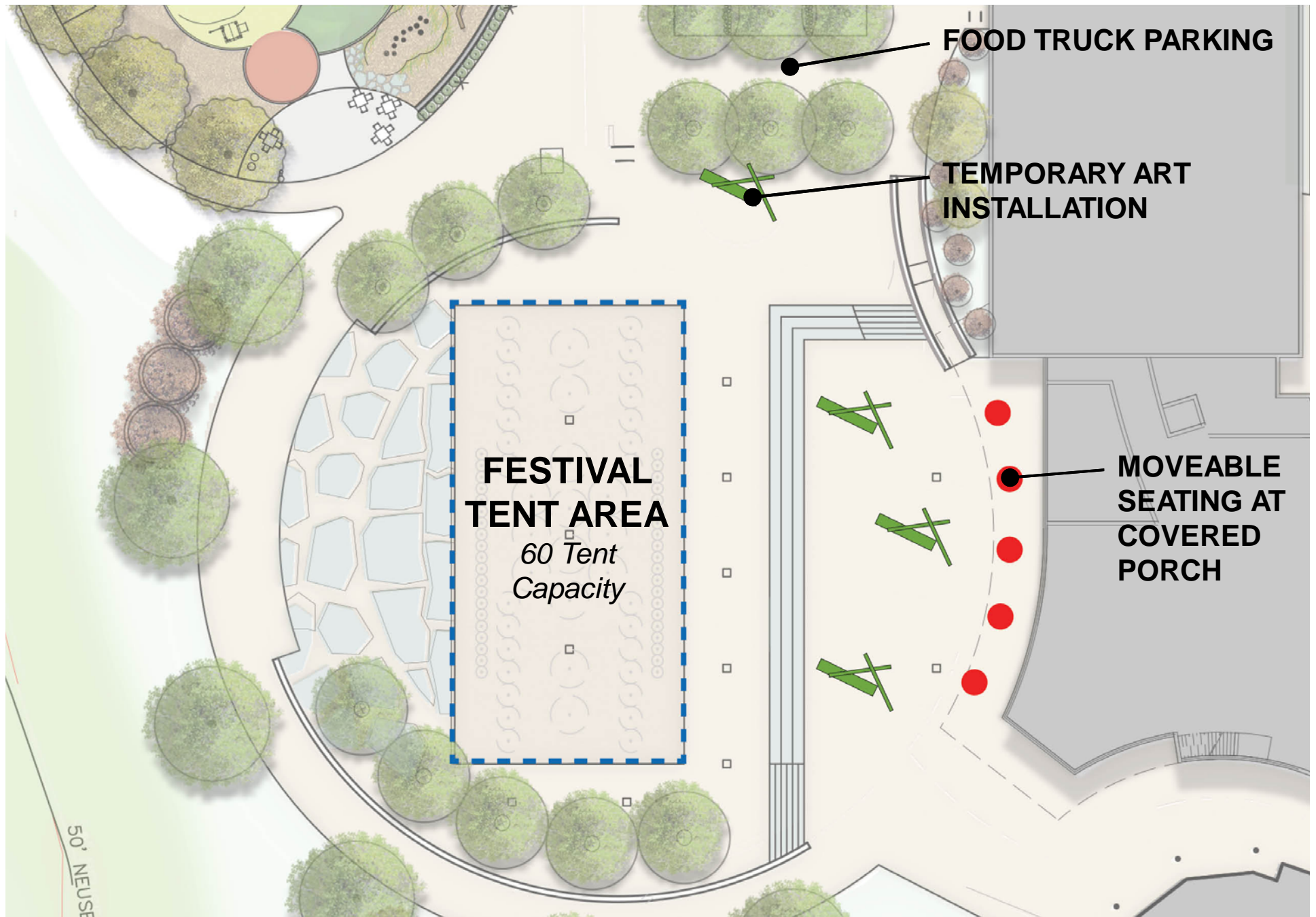

# CENTRAL PLAZA SITE PLAN



# PLAYGROUND





**CENTRAL PLAZA**





# WATER PLAY



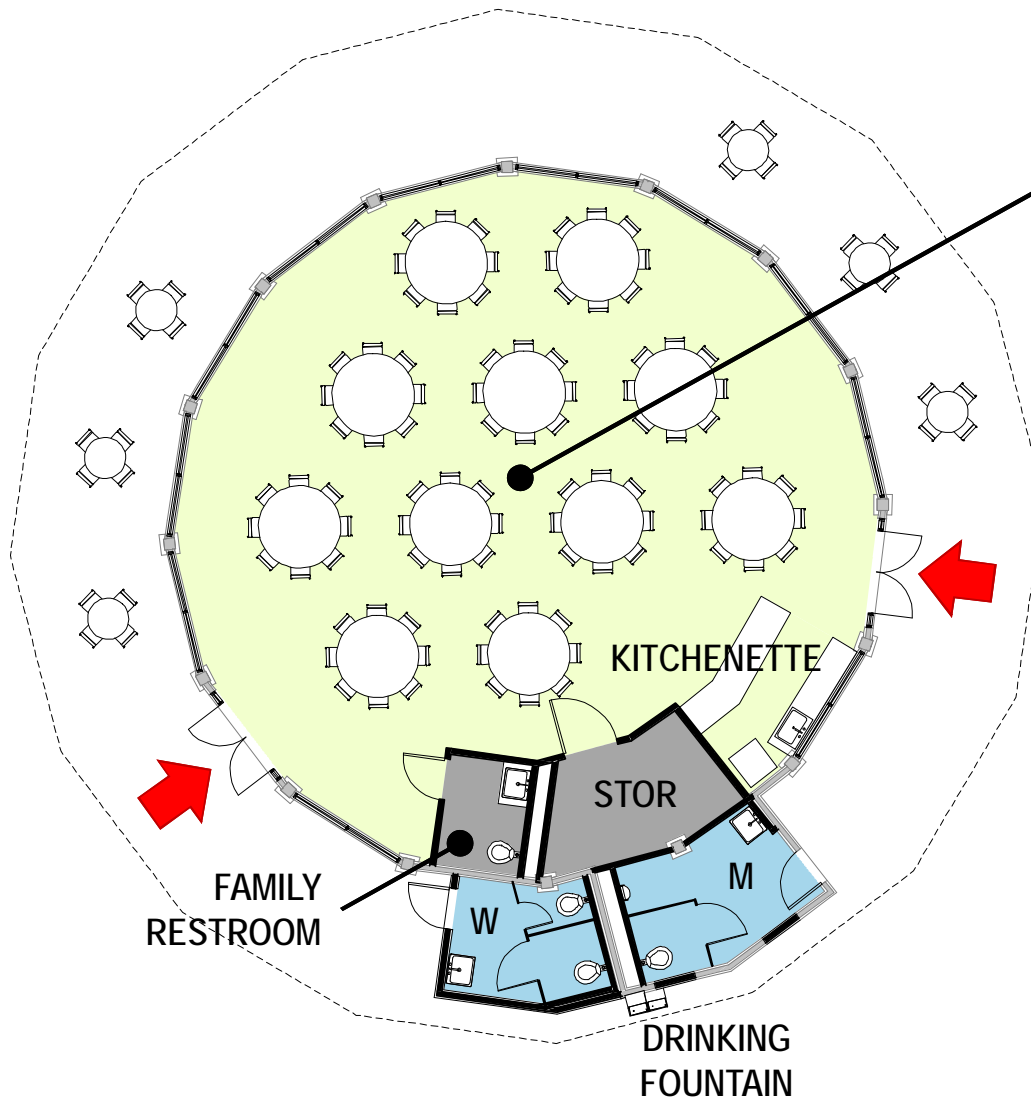

## RENOVATED ORIGINAL CAROUSEL HOUSE

*2000sf*

Seated capacity – 80-100

Standing capacity – 150+

## AMENITIES

Shaded seating, drinking fountain,  
trash and recycling

# ORIGINAL CAROUSEL FLOOR PLAN



# ORIGINAL CAROUSEL RENOVATION



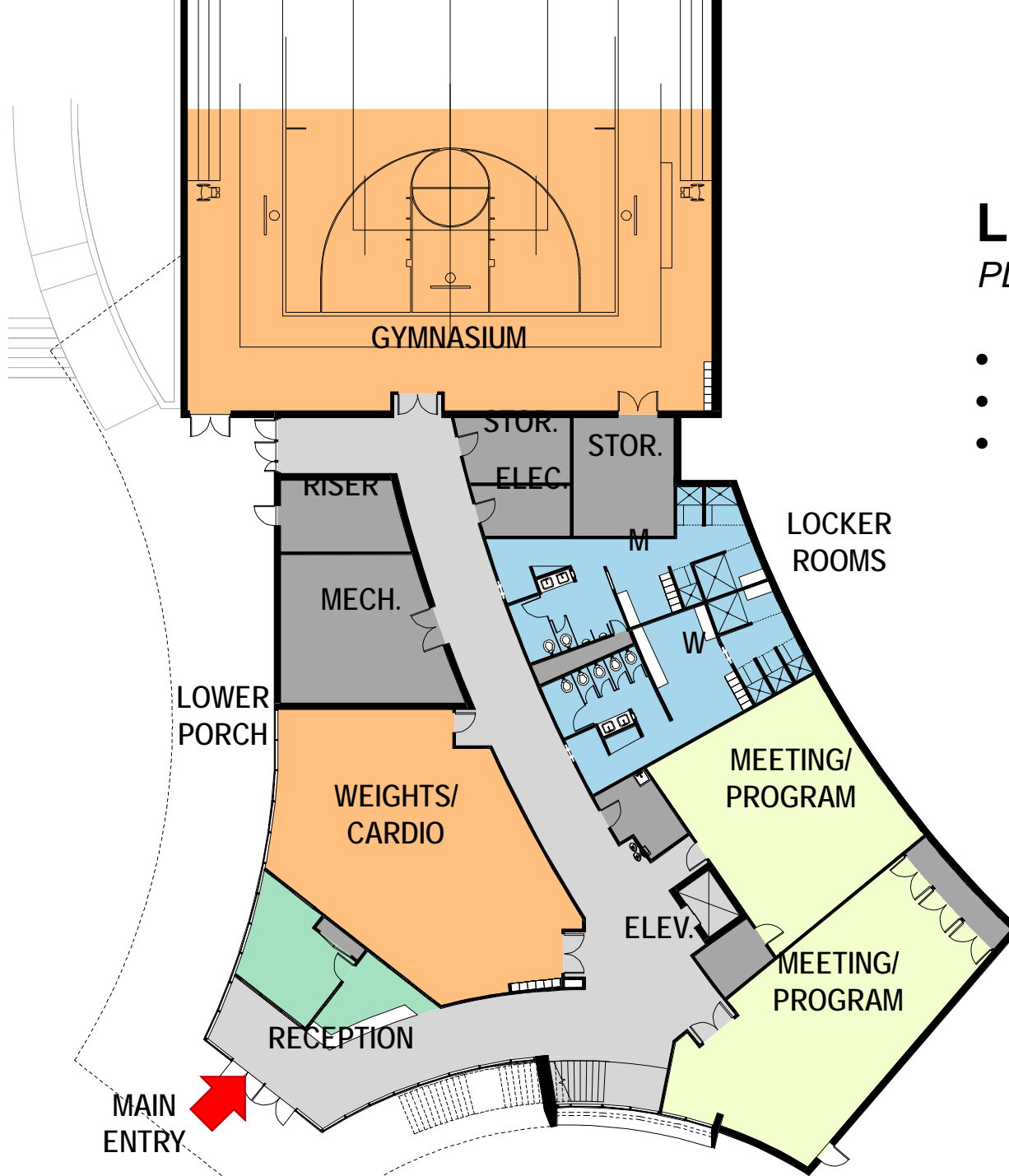

## LOWER LEVEL

*PLANNING UPDATES*

- RELOCATED ELEVATOR
- REORGANIZED ADMIN. AREA
- UPDATED LOCKER ROOM LAYOUT

# COMMUNITY CENTER FLOOR PLAN

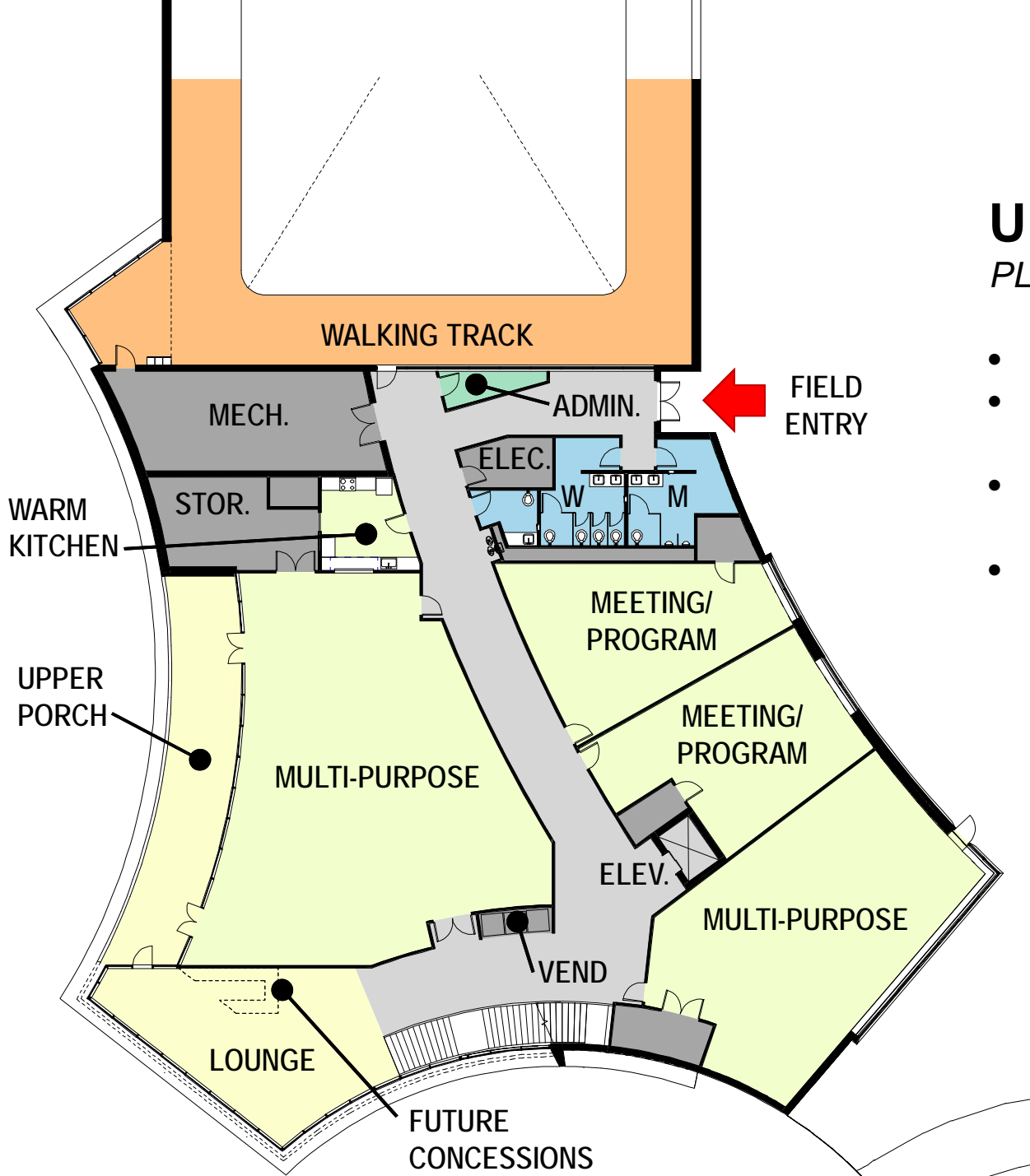

## UPPER LEVEL

*PLANNING UPDATES*

- RELOCATED ELEVATOR
- UPDATED TOILET ROOM LAYOUT
- ENLARGED WARMING KITCHEN
- SPACE FOR FUTURE CONCESSIONS

# COMMUNITY CENTER FLOOR PLAN





**AERIAL VIEW**



**MAIN ENTRY + SPLASH PLAZA**





**EVENT STAGE**



# PUBLIC ART OPPORTUNITIES





Russian icon of St Nicholas with scenes from his life



Pattern Inspiration



Resulting Paving Pattern

THIS DEMONSTRATES HOW ART TRANSLATED INTO A PAVING PATTERN

# PUBLIC ART OPPORTUNITIES

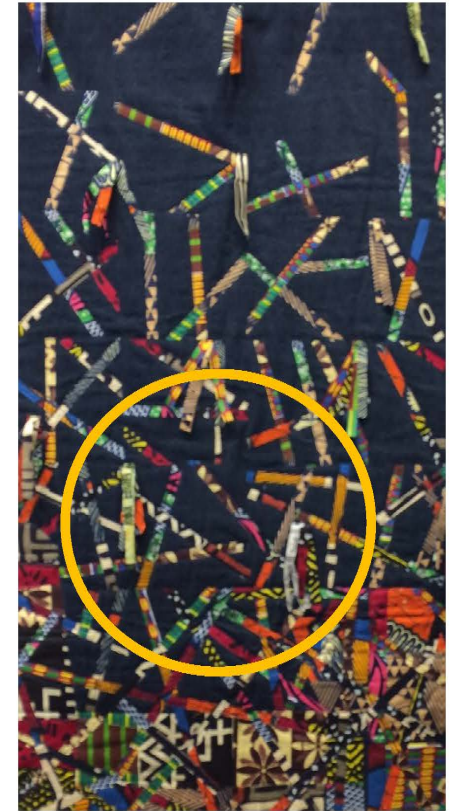
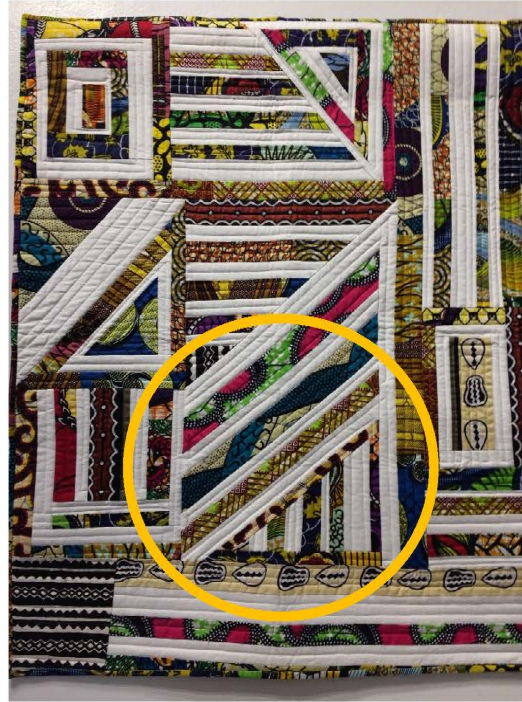

THE SAME TYPE OF PROCESS CAN BE APPLIED TO AFRICAN AMERICAN QUILT FABRIC ART.

# PUBLIC ART OPPORTUNITIES



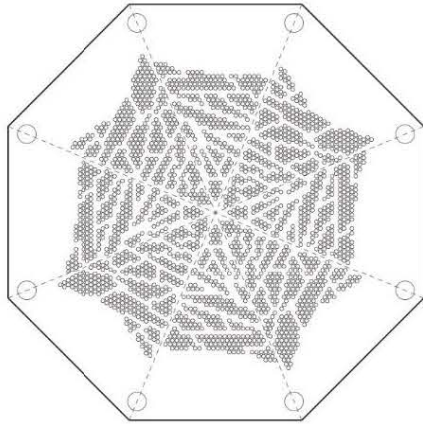

Play Tower Roof Plan

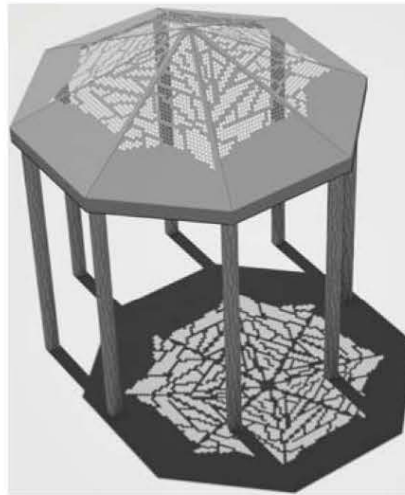

Play Tower Rendering

PATTERNS CAN ALSO BE PUT INTO SHADE STRUCTURES THAT ARE PART OF THE PLAYGROUND. SHADE STRUCTURES COULD ALSO BE INCORPORATED THROUGHOUT THE OTHER PEDESTRIAN AREAS OF THE PARK. VERY IMPORTANT, REMEMBER HOW HOT IT GETS IN EXPOSED AREAS. SHADE IS SUPER IMPORTANT HERE



# PUBLIC ART OPPORTUNITIES



Examples of Custom Play Panels with Integrated Interpretive Custom Artwork

ALSO IN PLAYGROUND AREAS ARE OPPORTUNITIES TO DO CUSTOM ARTWORK ON PANELS THAT CAN REPRESENT LOCAL CULTURE. THIS COULD BE HISTORIC, GEOGRAPHIC, ETC. THERE CAN BE AN INTERACTIVE COMPONENT TO IT. THIS ARTWORK IS SENT DIRECTLY TO THE MAIN PLAYGROUND MANUFACTURERS. APPROX. \$3000 PER PANEL , BUT CAN BE PART OF PLAYGROUND BUDGET.

# PUBLIC ART OPPORTUNITIES



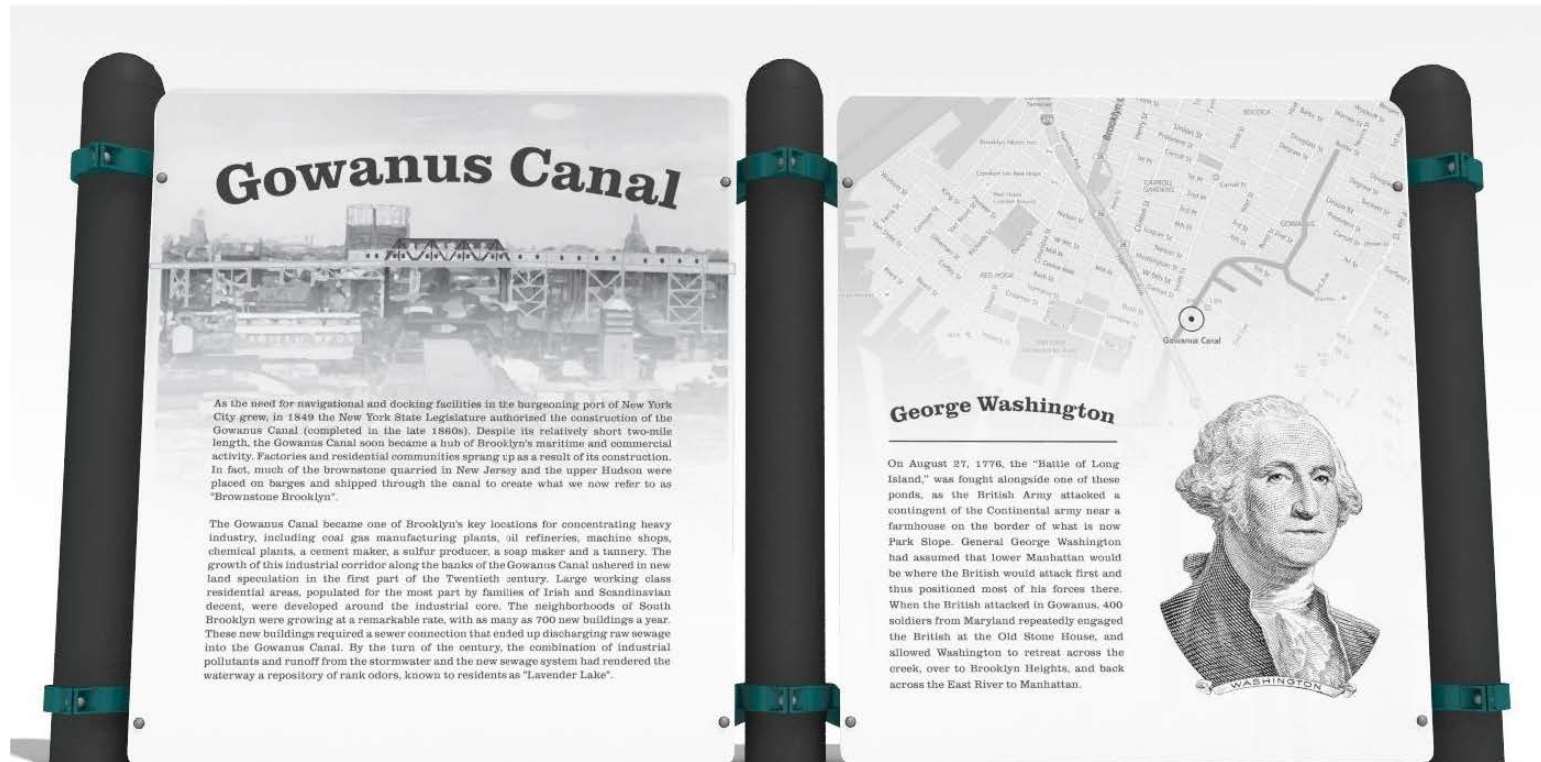

THESE ARE CUSTOM PANELS THAT ARE MANUFACTURED BY THE PLAY EQUIPMENT MANUFACTURERS. THIS ARTWORK IS FAIRLY DIRECT IN COMMUNICATION. ALMOST LIKE AN INTERPRETIVE SIGN. BUT LITERALLY ANY ARTWORK CAN GO ONTO THESE SIGNS THAT ARE PART OF TYPICAL POST-AND-DECK TYPE PLAY EQUIPMENT.

# PUBLIC ART OPPORTUNITIES



THE SPRAY PLAY AREA CAN BE WHERE A LARGE SCALE PATTERN IS UTILIZED. THIS PATTERN COULD HAVE A CONNECTION TO THE LARGER ART THEME.



THE GROUND PLANE OF THE WATER SPRAY PLAY AREA CAN UTILIZE CREATIVE PATTERNING THAT CORRESPONDS TO THE SPRAY JETS. THIS UTILIZES INTEGRAL COLORED CONCRETE BRONZE EDGING

# PUBLIC ART OPPORTUNITIES





PROVIDING SHADE IS AN OPPORTUNITY TO INTEGRATE COLORS, SHAPES AND TEXTURES. THIS CAN BE ACCOMPLISHED WITH GLASS, FABRIC, STEEL, COMPOSITES, ETC.



# PUBLIC ART OPPORTUNITIES

## TEXT INSTALLATION

(Fragments from *Song of Myself* by Walt Whitman), Jenny Holzer.

YOU. I LOAFE AND  
CEASE NOT TILL D  
THE THE FRAGRAN  
BE IN CONTACT I  
SOUND OF THE BE  
BED AND MEETING  
I SHALL NO LONG  
OR THE END. THE  
TITY, ALWAYS DIST  
V. SHOWING THE  
ING BED-FELLOW  
HICH IS AHEAD?  
BATTLES, THE HC  
THING

### PAVING DETAILS:

- Paver width: 12" and 15"
- Paver lengths: 5' to 7' approx.
- Typeface: Trajan Regular
- Letter Height: 1-3/4"
- Flush joints
- Curved joints: 1/4"
- Radial joints: 1/8"
- Letters: 1/8" engraved
- In-painting: Dark grey
- Grout color to match stone color

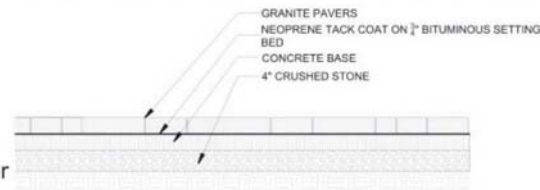

## READING PATTERN: Spiral

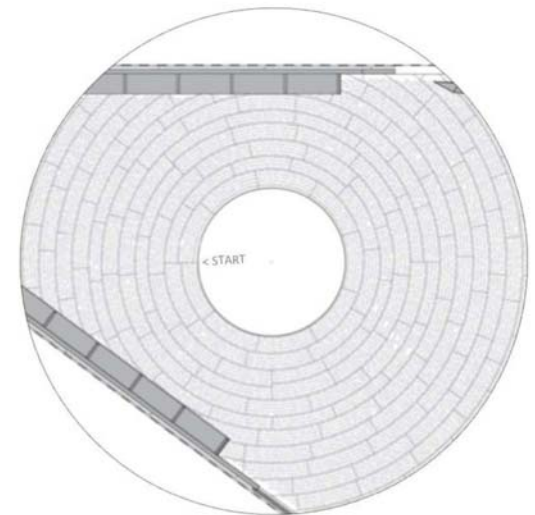
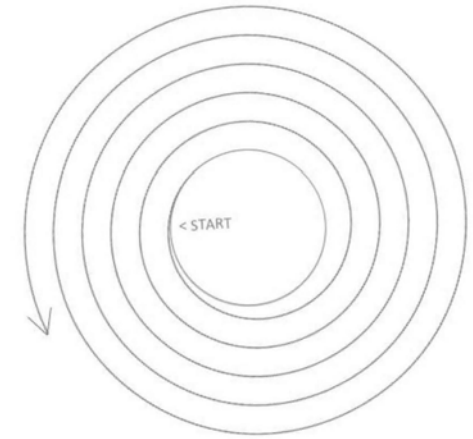

TEXT CAN BE UTILIZED AND BE DONE IN A WAY THAT HELPS TELL THE STORY.

# PUBLIC ART OPPORTUNITIES



# **PARKS, RECREATION & GREENWAY ADVISORY BOARD**

THURSDAY, MARCH 16, 6pm  
City Council Chambers

**SCHEMATIC DESIGN REVIEW**

## **CITY COUNCIL**

TUESDAY, MARCH 21, 1pm  
City Council Chambers

**SCHEMATIC DESIGN REVIEW + APPROVAL**

**CONSTRUCTION DOCUMENTS**

SUMMER – FALL 2017

**PERMITTING & BIDDING**

WINTER 2017

**CONSTRUCTION**

SPRING 2018

# **NEXT STEPS**

