

Latta House & University Site Master Plan

Citizen Planning Committee Meeting #2

May 24nd, 2019



Raleigh





Agenda

- 1) Meeting Minutes*
- 2) Charter*
- 3) Vision Statement*
- 4) General Input Results Overview
- 5) Master Plan Goals
- 6) Master Plan Design Alternatives
- 7) Next Steps



Raleigh

Consensus Building Process

Consensus decision-making is a group decision-making process in which group members develop, and agree to support a decision in the best interest of the whole

- 1) **Endorsement** (Member fully supports it)
- 2) **Endorsement with minor point of contention** (Member likes it)
- 3) **Agreement with minor reservation** (Formal disagreement, but will not block or hold up the proposed)
- 4) **Stand aside with major reservations** (Formal disagreement, but will not block or hold up the proposed)
- 5) **Block** (Member will not support the proposed plan)



Consensus Building Process

Measuring Consensus:

Consensus = all committee members present rate the proposal as a 1, 2, or 3

Consensus with Major Reservations = All committee members present rate the proposal as a 1, 2, or 3, except at least one Committee member rates it as a 4

No Consensus = *Any committee member rates the proposal as a 5*



Charter

1. Discussion
2. Adoption



Collected Vision Statements

For the safety, general well-being, and future of the Latta University site; Troy Burton, Doug Porter, Joshua Ingersoll and Ernest Dollar shall be permanently banned from ever stepping foot on the property!



Collected Vision Statements

The Latta House and university site will be a place for bringing people of all ages, races, and backgrounds together to learn, enjoy, and celebrate Raleigh's past, and to develop a better understanding of each other.

A beautiful, serene space with art.
A place to reflect. A place to show the historical significance of the area.

The project should be a 'goes down easy' history lesson mixed with a site where families can go for an outing, like a picnic.

The Latta House & University Site will be a gathering place for the community to connect with the natural beauty of the site and learn about the site's unique history and the legacy of Reverend Latta.



Key Terms & Thoughts

The Latta House and university site will be a place for bringing people of all ages, races, and backgrounds together to learn, enjoy, and celebrate Raleigh's past, and to develop a better understanding of each other.

A beautiful, serene space with art.
A place to reflect. A place to show the historical significance of the area.

The project should be a 'goes down easy' history lesson mixed with a site where families can go for an outing, like a picnic.

The Latta House & University Site will be a gathering place for the community to connect with the natural beauty of the site and learn about the site's unique history and the legacy of Reverend Latta.



Draft Vision Statement

The Latta House & University Site will be a beautiful, serene gathering place for bringing people of all ages, races, and backgrounds together to learn, reflect on, enjoy, and celebrate Raleigh's past and the legacy of Reverend Latta.



General Input: *April 2019*

1. Online Survey – April 5-29
2. Public Input Open House – April 6
3. Chavis Egg Hunt – April 13
4. Mordecai Plant Sale – April 27

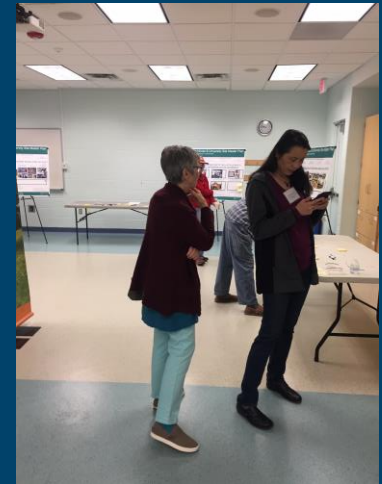



General Input: *April 2019*



3
events including
input meeting,
Chavis Egg Hunt, &
Mordecai Plant Sale

20
participated
in the
online survey



39
left feedback
at public input
meetings
& event outreach

63
In-depth
comments
received





Master Plan Goals

1. Honor the Legacy of Latta
2. Educate & Engage Diverse Communities
3. Enhance the Site's Natural Beauty
4. Encourage Community Gathering
5. Preserve the Site Historic Resources

Existing Conditions

Latta House & University Site - Existing Conditions

0 30 60 120 Feet

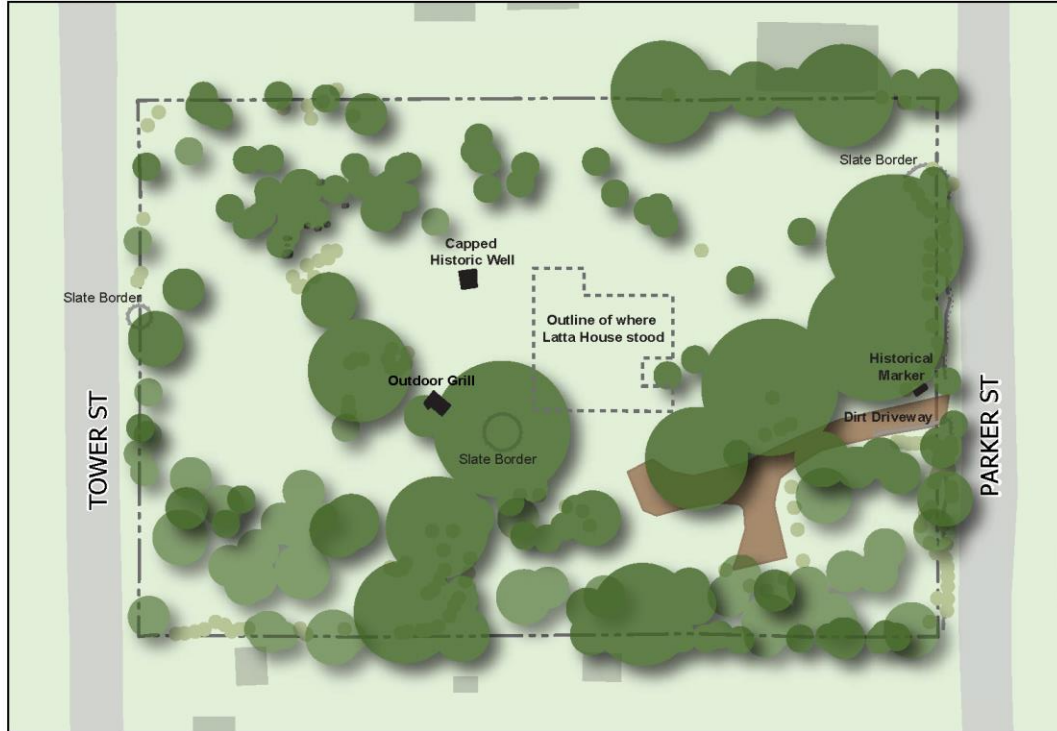



Design Alternatives

1. Design A – *Enhance & Inspire*
2. Design B – *Gather & Engage*
3. Design C – *Educate & Preserve*

Design A – *Enhance & Inspire*

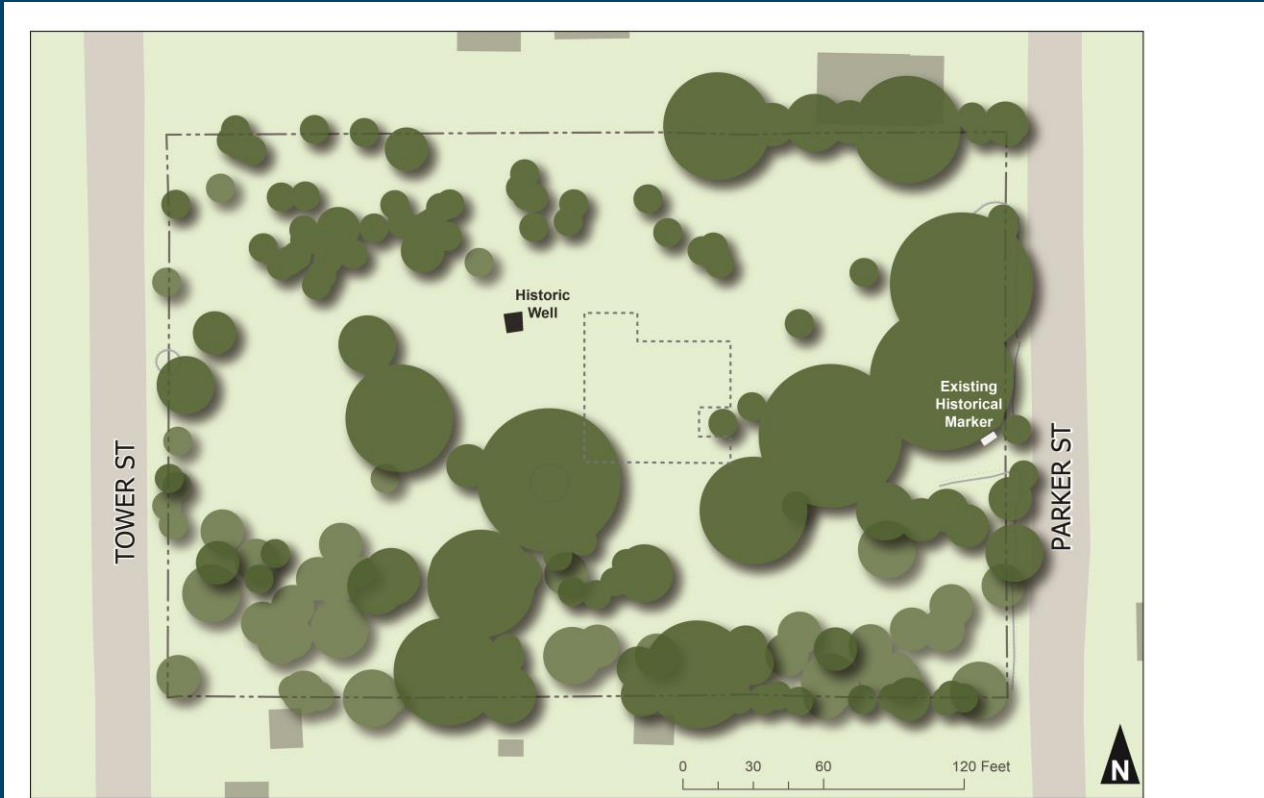

Design A – Enhance & Inspire

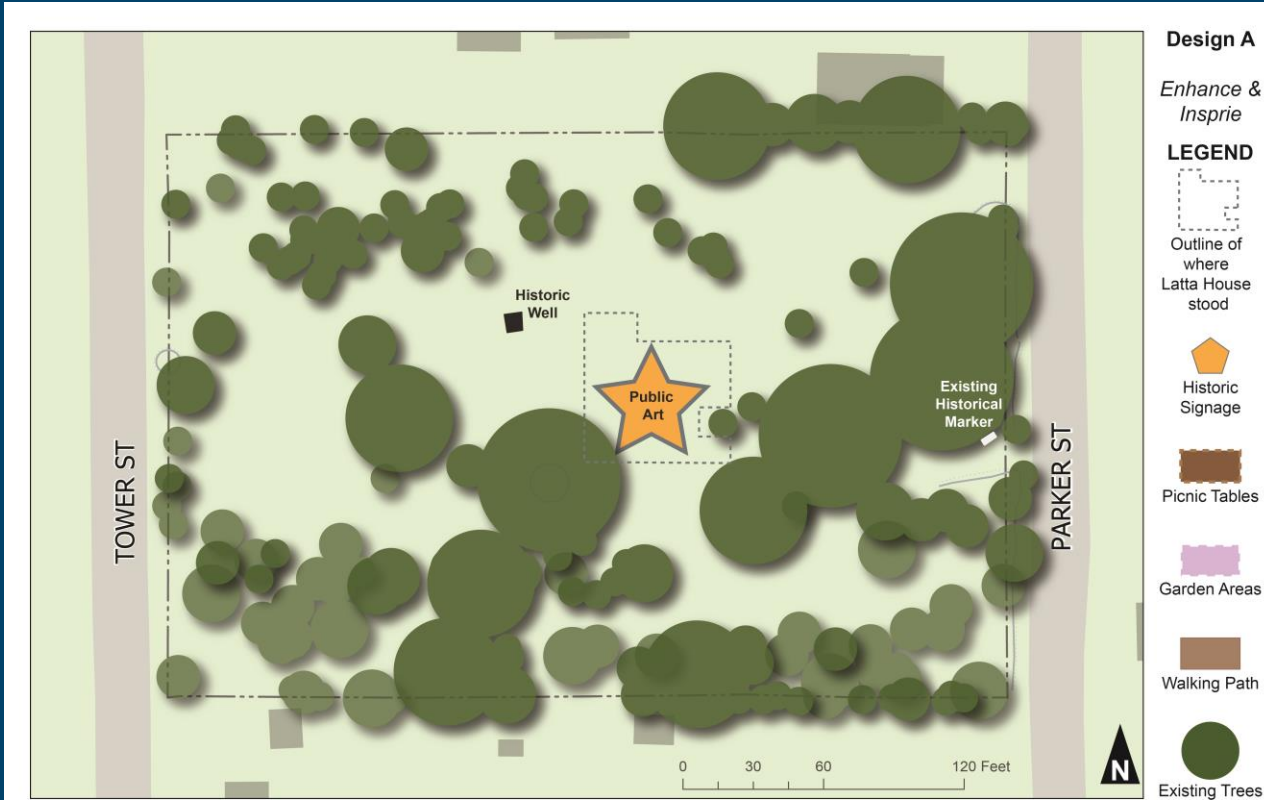

Design A – Enhance & Inspire

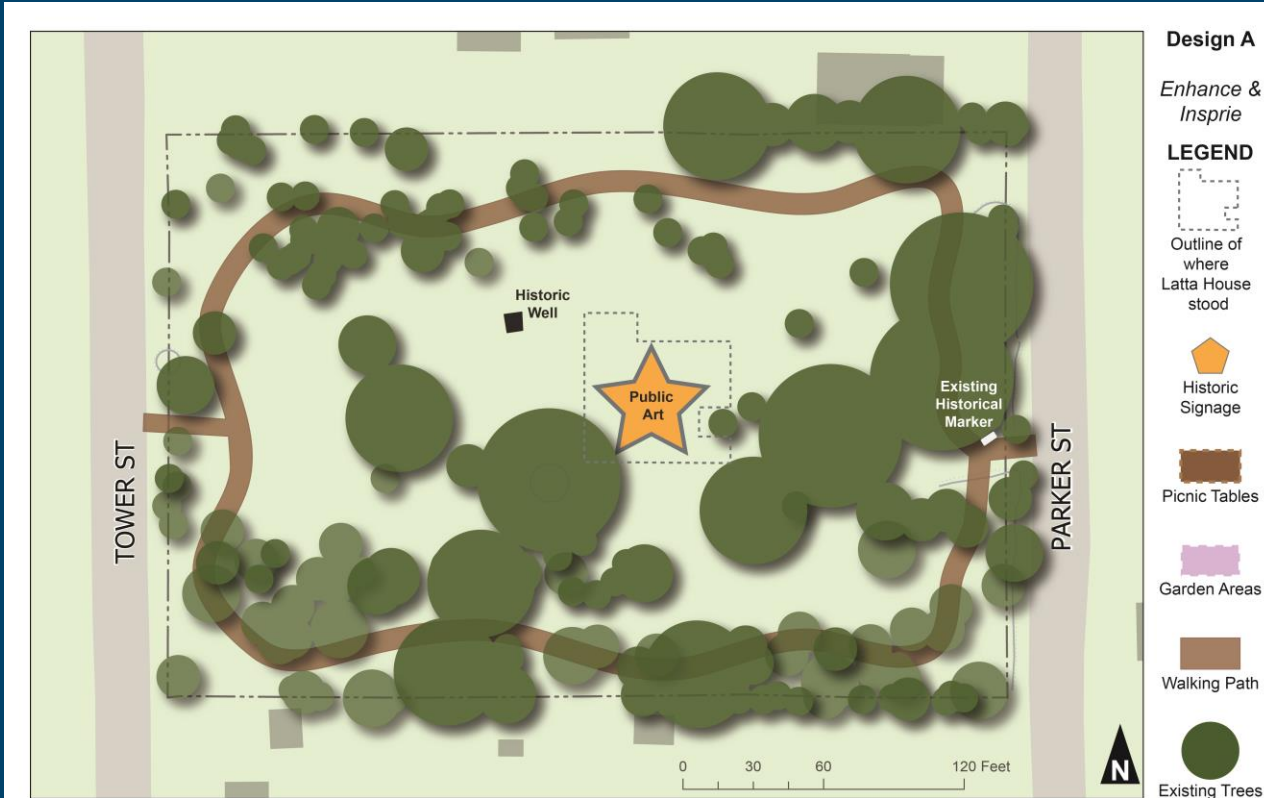

Design A – Enhance & Inspire



Design A – Enhance & Inspire



Design A – Enhance & Inspire



Design B – *Gather & Engage*

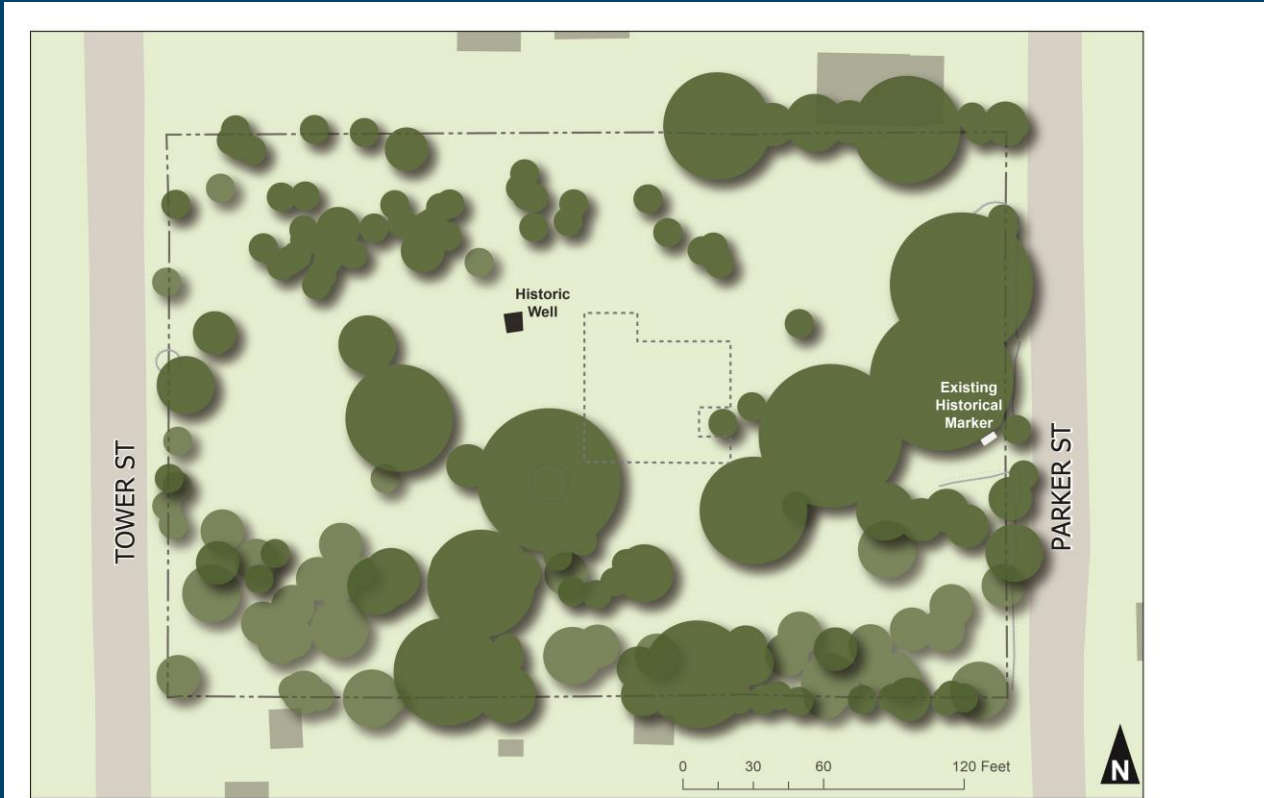

Design B – *Gather & Engage*



Design B – *Gather & Engage*



Design B – *Gather & Engage*

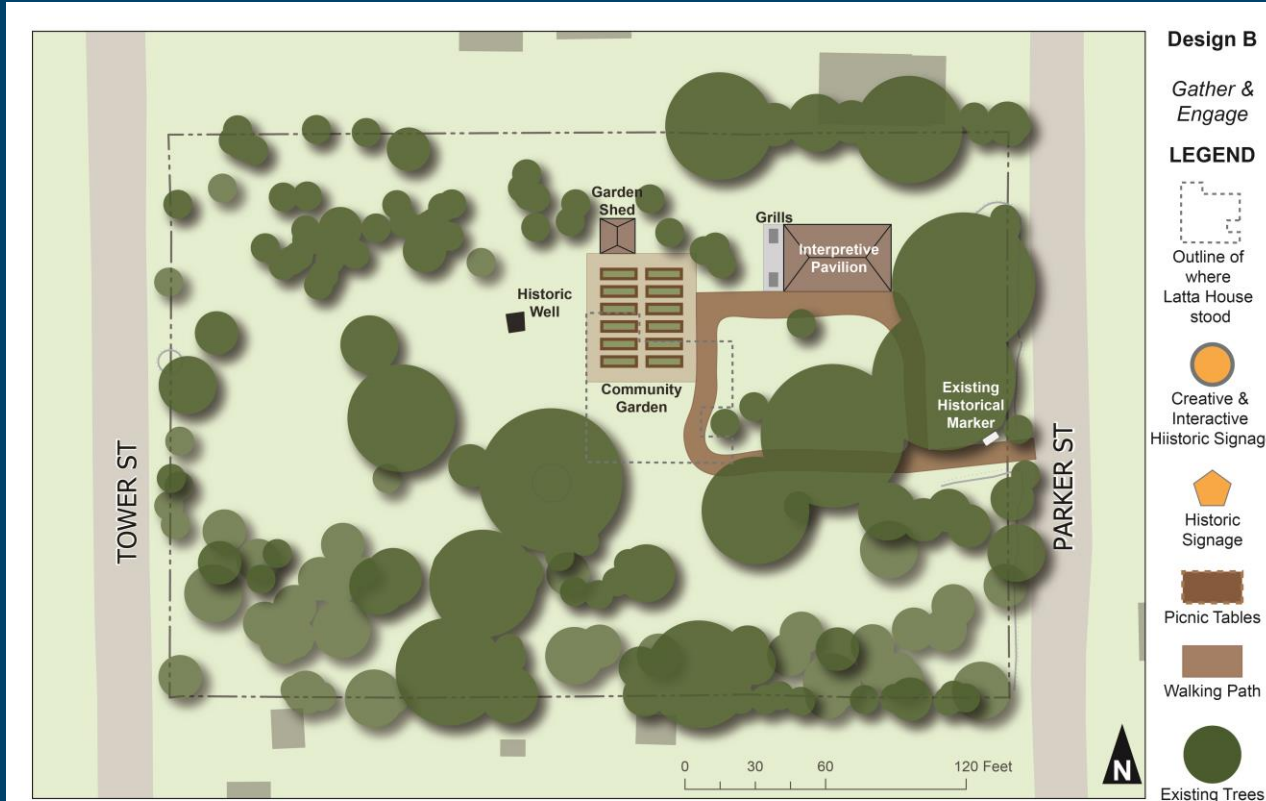

Design B – *Gather & Engage*



Design C – *Educate & Preserve*

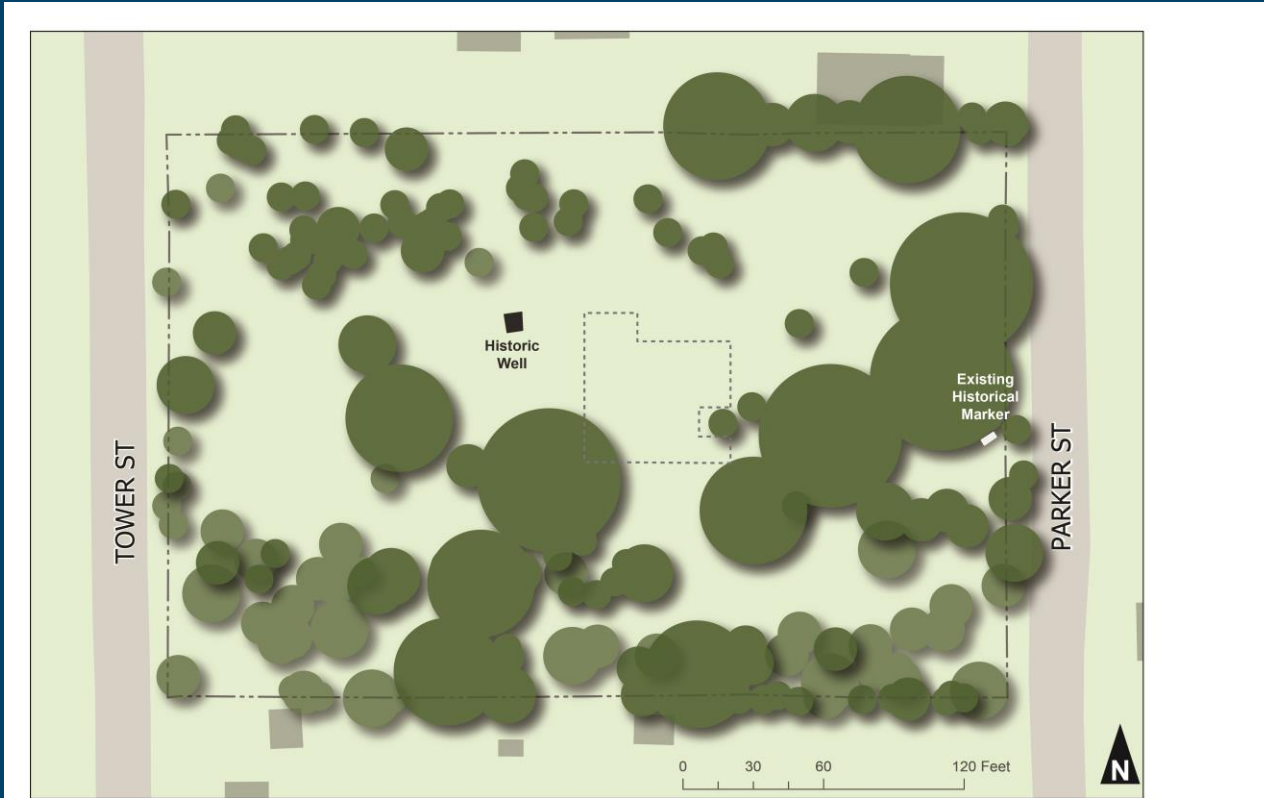

Design C – *Educate & Preserve*

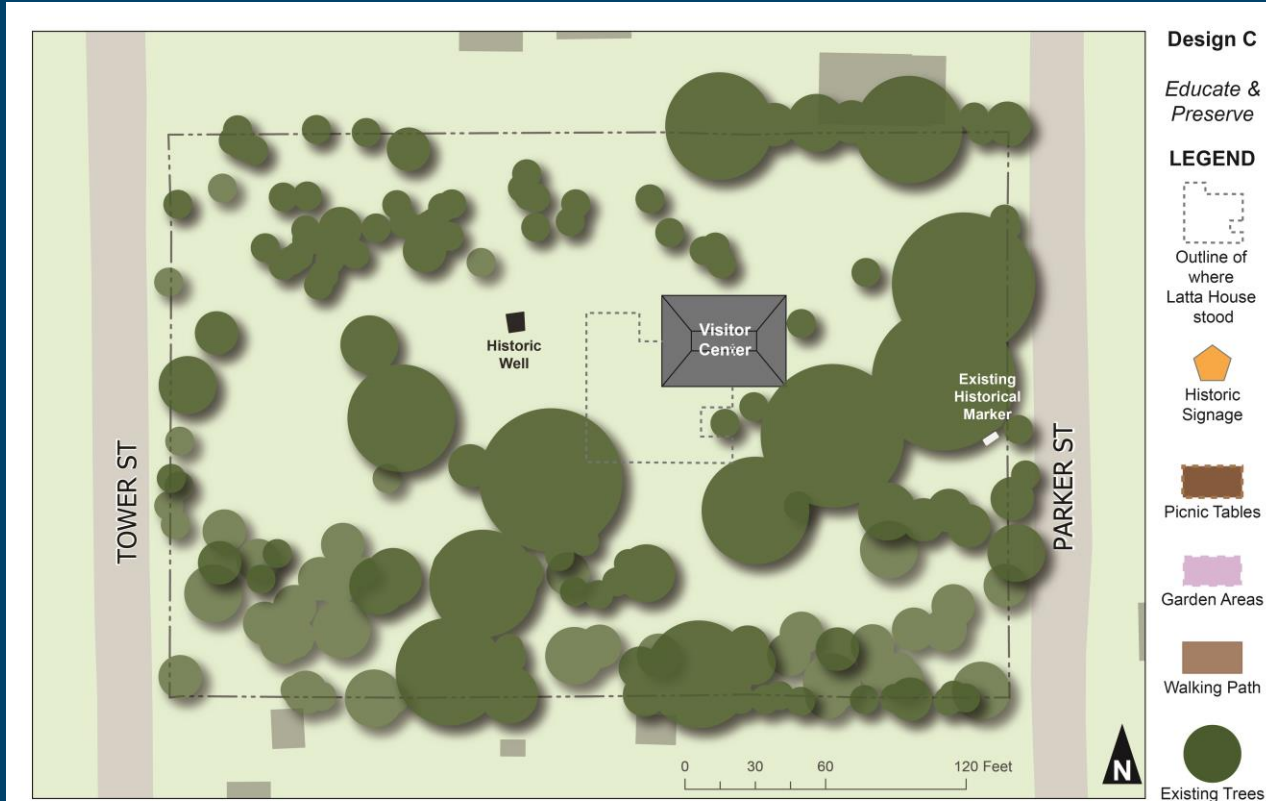

Design C – *Educate & Preserve*

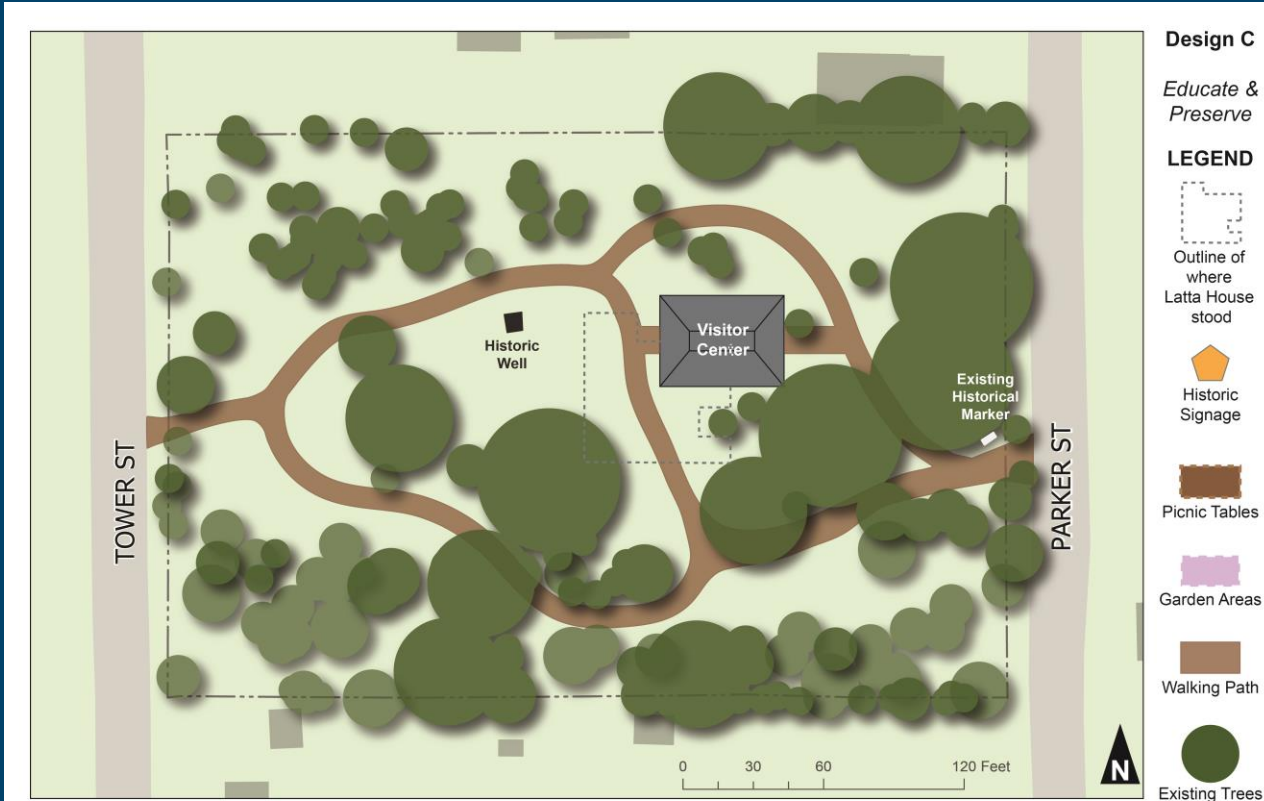

Design C – *Educate & Preserve*

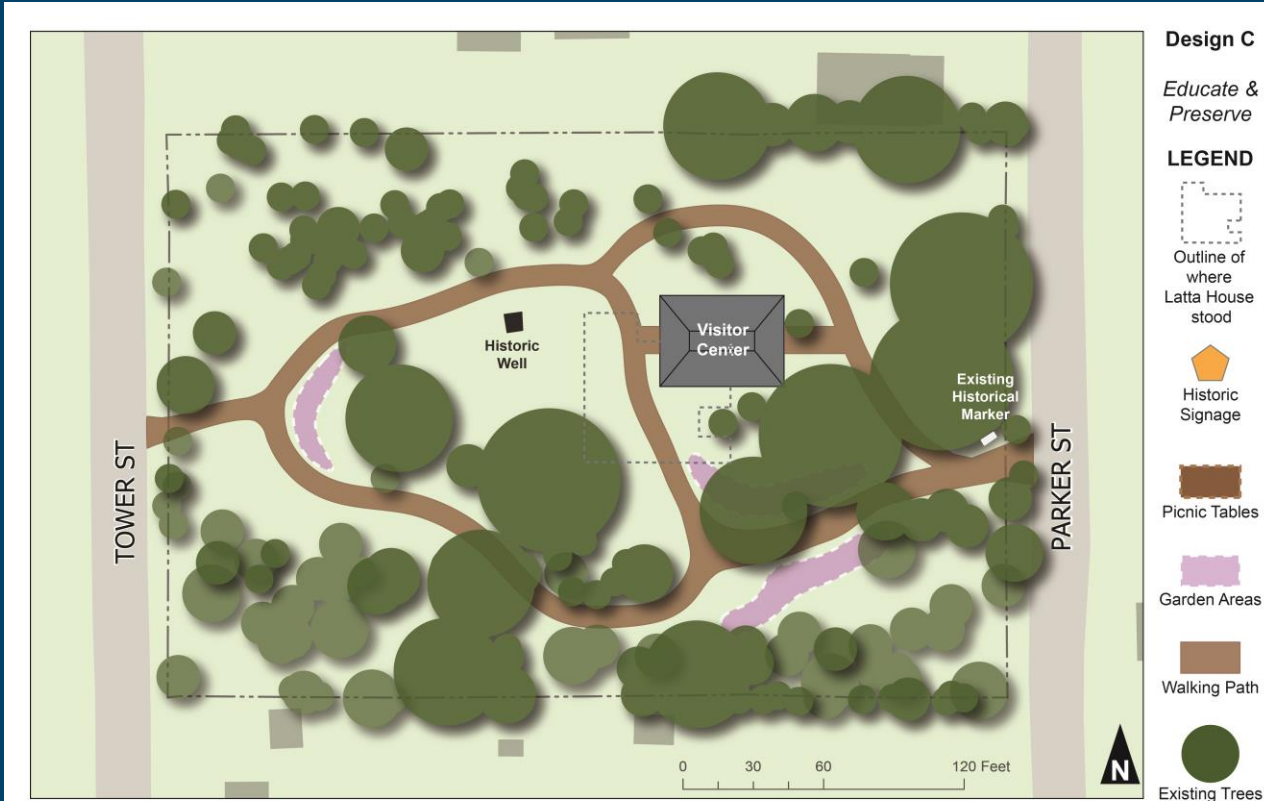

Design C – *Educate & Preserve*

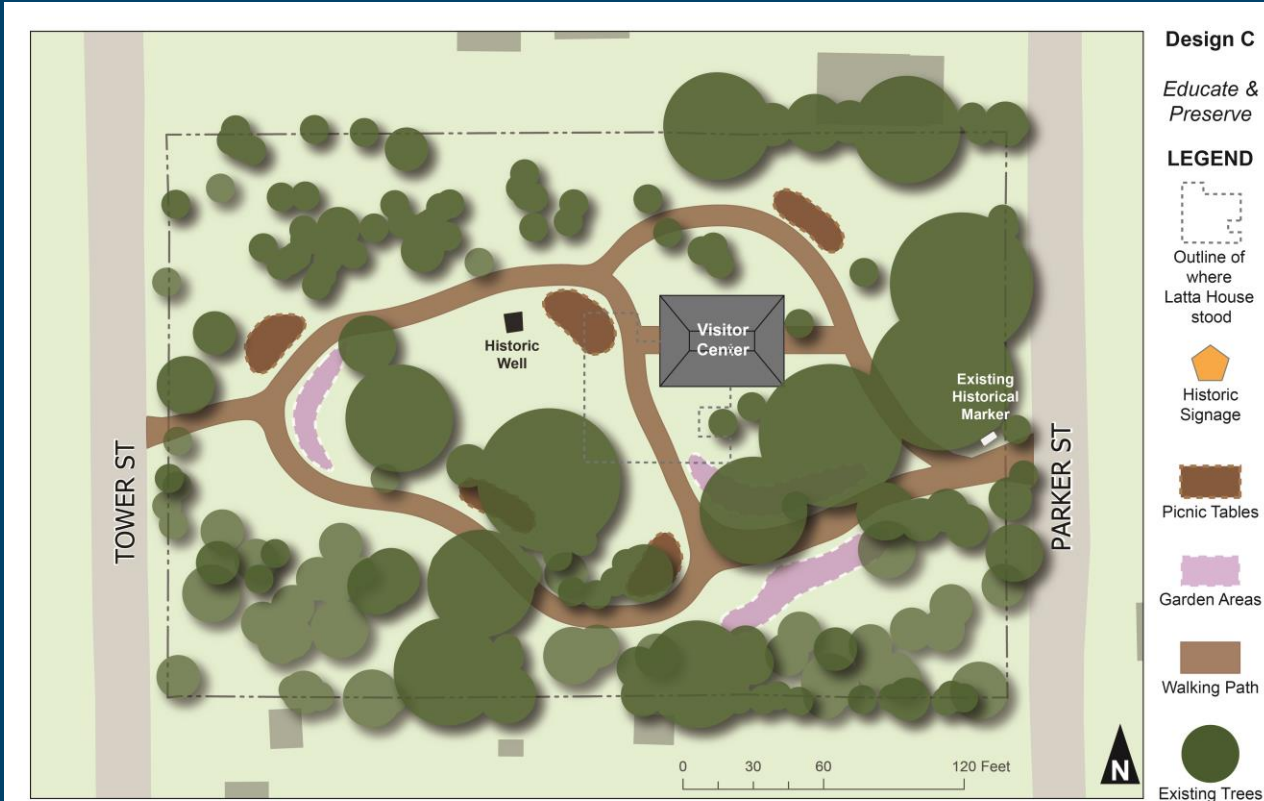

Design C – *Educate & Preserve*

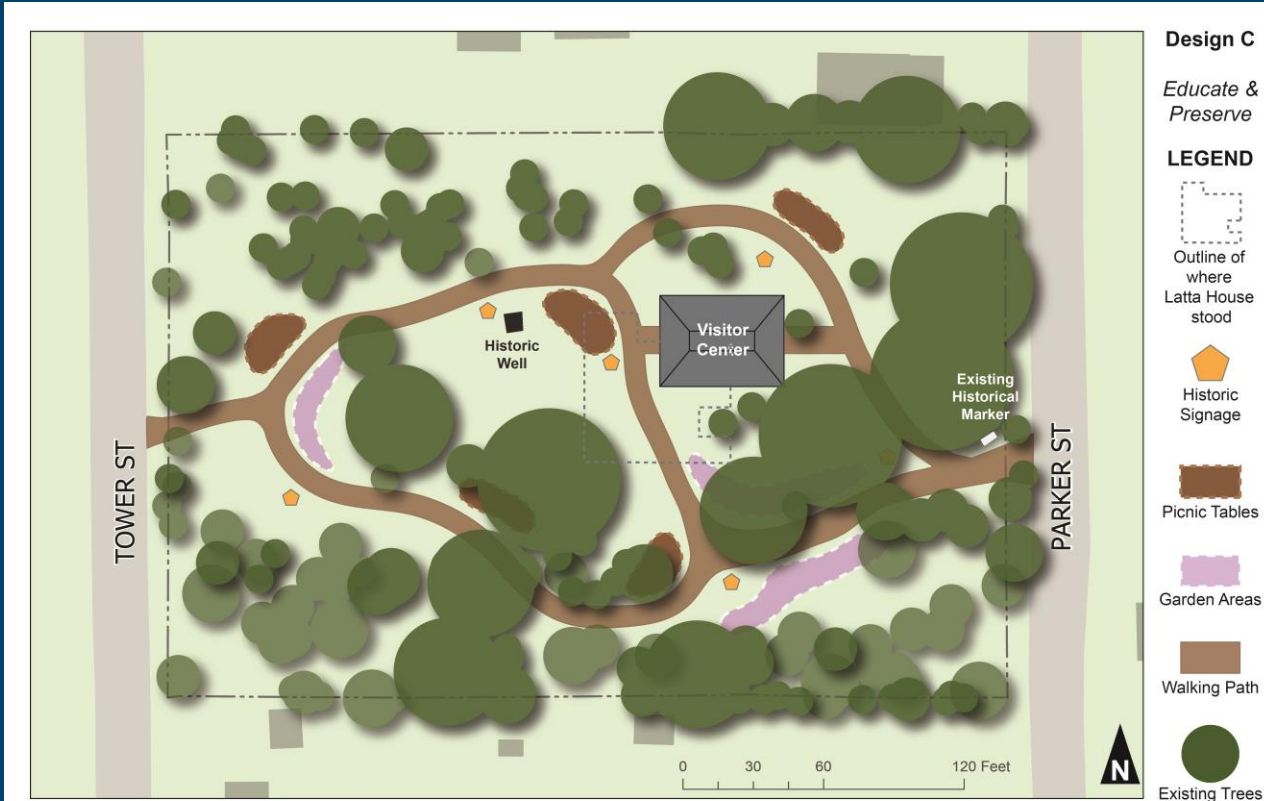



Raleigh

Small Group Workshop

Public Interpretation Questions

1. Are the maps & brochure clear & easy to understand?
2. Do these alternatives adequately reflect the public input?
3. What elements are missing; Which Design Alternative should they go into?

Design Alternative Questions

1. Which elements should stay and which should go?
2. Do elements need to move to a different part of the site?



Next Steps

June 8th

Public Input Meeting #2

Oberlin Baptist Church

9:30 am – Noon

July 26th

CPC Meeting #3

Jaycee Community Center

4 – 5:30 pm