

Parks, Recreation and  
Cultural Resources

*Mine Creek Trail  
Improvement Project  
Update*

District A Town Hall  
October 25, 2023



Raleigh





Raleigh

## Items to Be Reviewed

- **Project Background**
  - Project Location
  - Project History
  - Engagement Efforts
- **Alignment Options Reviewed**
  - Option 1: Replace Structures and Trail
  - Option 2: Realign Trail along North-West side of Mine Creek  
(Option 2 Recommended to proceed to 60% Design)
- **Next Steps**



# Project Vicinity Map and Project Location

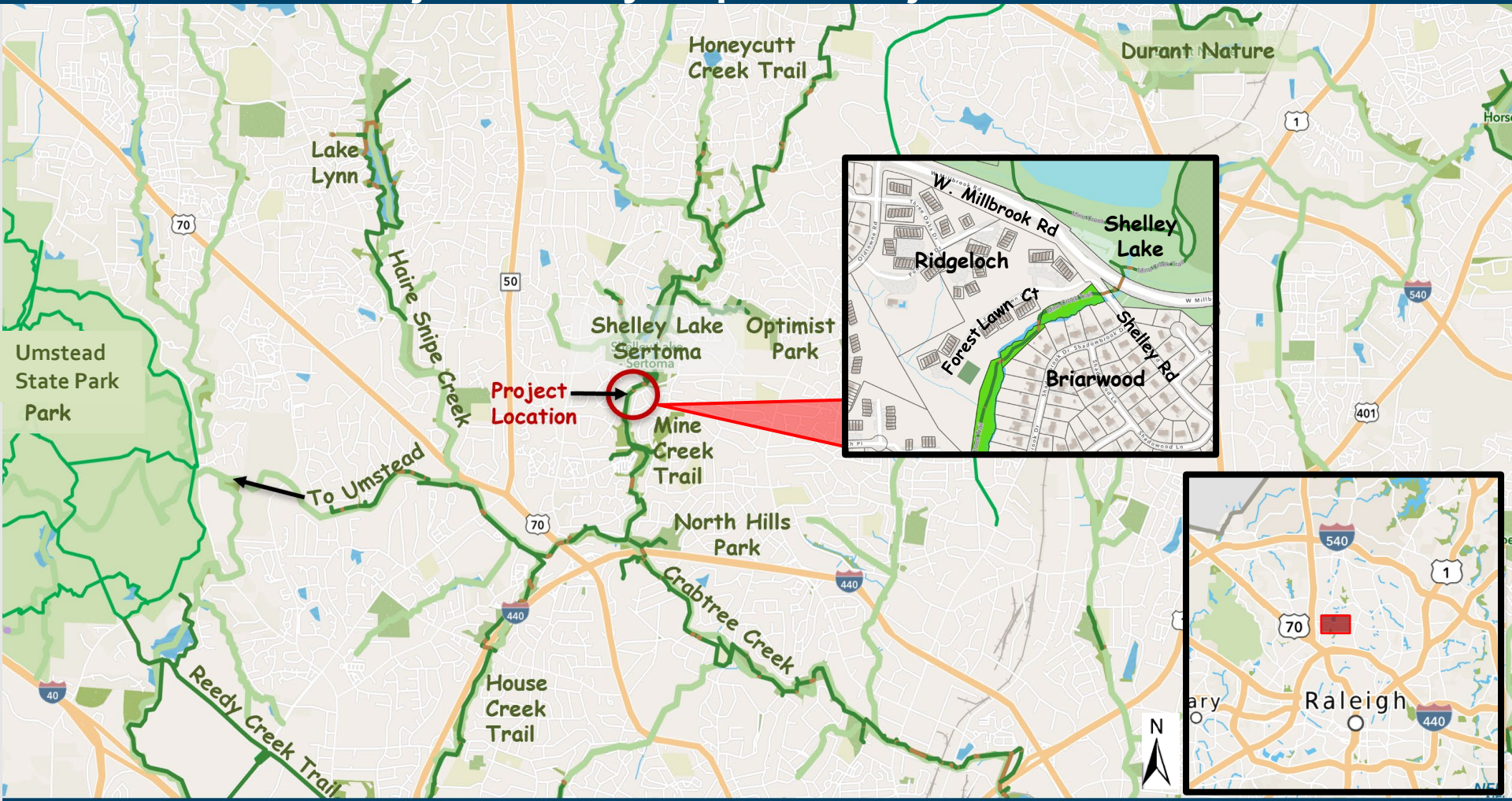



Raleigh

# Community Engagement Efforts

<b>2009, 2015</b>	Engagement - resulted in decision to maintain current alignment
<b>2014 Parks Bond</b>	Funding - \$210,000
<b>2022-2023</b>	Public Engagement, PRGAB Review/Recommendation and City Council Update

## Events that Guided 2022-2023 Efforts to Realign the Trail

- Major Weather Events (2016 & 2018)
- System Resiliency and Sustainability
- Adoption of Design Guidelines (2014)
- Adoption of Greenway Master Plan (2022)
  - ❖ System Resiliency
  - ❖ Safety
- Floodplain Regulation Changes



# Alignment Options 1 and 2 (Recommended)

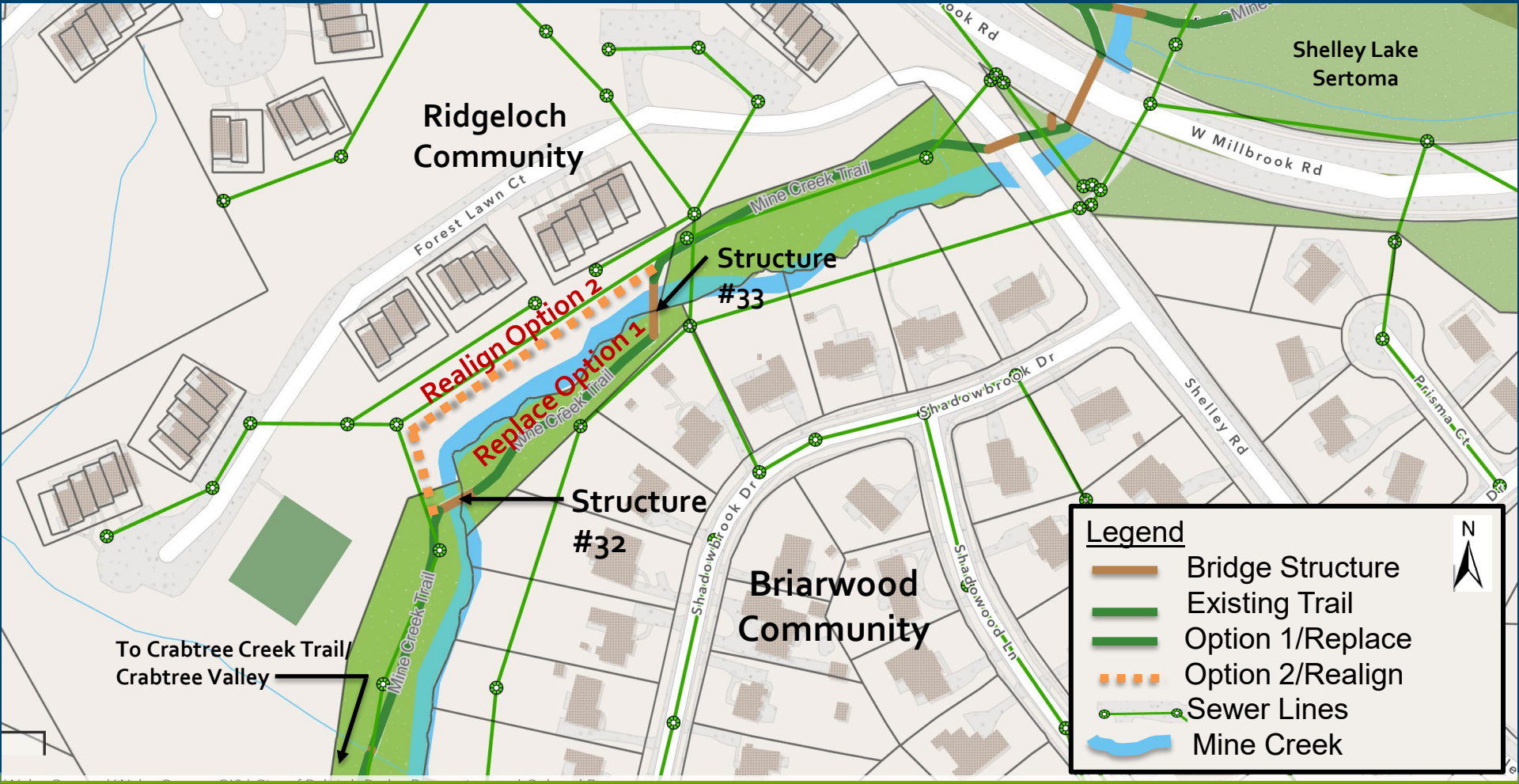





Existing Trail



Mine Creek adjacent to Trail



Existing Trail



Mine Creek adjacent to Trail



Existing Structure #32



Existing Structure #33



# Option 2 Realignment



Proposed Location of Realignment Looking North



Proposed Location of Realignment Looking South



Proposed Location of Realignment Looking South



Proposed Location of Realignment Looking South

Existing Sewer Easement Location of Realignment Looking North





Raleigh

# Alignment Comparison

## Option 1 – Replace

## Option 2 – Realign (Recommended) West Side

**Easement Acquisition**

Yes

Yes

**User Safety/Experience**

Sightline Issue

No Issue

**Tree Removal**

Major (30+ > 8" dbh)

Minor (4 trees total)

**Steam Impact**

Major

Minor/Enhance

**Permitting**

Extensive

Minor

**Long-Term Maintenance**

Medium

Low

**Maintenance Access**

Good

Good

**Project Cost**

\$1.5M - \$1.75M

\$525k - \$600k





# Community Feedback

- Safety and Security
- Visual Aesthetics (i.e. Fencing)
- Maintenance & Operation
- Community Expense
- Greenway Acquisition
- Property Impacts
- Environmental Impacts



# Proposed Considerations

## Safety, Security, Visual Aesthetics

- Delineate between public and private property with the use of fencing, landscaping
- Controlled access
- Implement clear sight lines
- Signage (Enforcement)

## Maintenance & Operation, Community Expense

## Greenway Acquisition, Property Impacts

- Easement Acquisition - fair market value
- Improve drainage

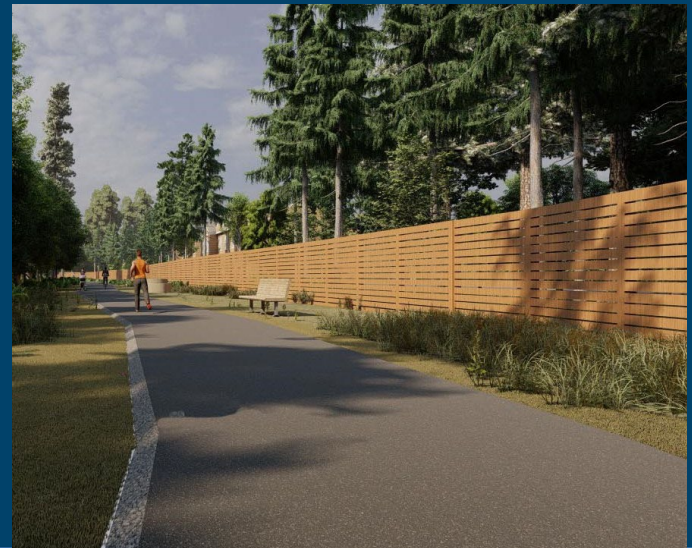





## Next Steps

- Advance Design for Alignment Option 2 to 60%.
  - Work with the adjacent community and address fencing placement, design, landscape features, signage, and easement acquisition.
- 
- November 30, 2023      Community meeting for design update
  - Late Fall 2023      Survey and easement acquisition/negotiations
  - Early 2024      City Council review and approval on the 60% project design and easement acquisition.





# Thank You

David P. Bender

Capital Projects Manager

Raleigh Parks

[david.bender@raleighnc.gov](mailto:david.bender@raleighnc.gov)